

POSTED 12-11-86 KX

D-1417 - University Congregational Church grants a utility easement located south of 29th Street North and west of Webb Road.

ACTION

COMMITTEE	<u>approved</u>	DATE	<u>12-18-86</u>
M.A.P.C.	<u>approved</u>		<u>12-22-86</u>
R.C.C./B. CO. C.	<u>accept</u>		<u>1-20-87</u>

DEDICATION REPORT AND PROGRESS

MAP NO. 6050 A
SEC. NO. 5
TWP. NO. 27S
RANGE 2E

CASE NO.: D-1417

ASSOCIATED CASE:

1. OFFER TO DEDICATE: Utility easement.

GENERALLY LOCATED: South of 29th Street North and west of Webb Road.

LEGALLY DESCRIBED AS:

That part of Lot 1, University Congregational Church Addition, Wichita, Kansas, described as commencing at the northwest corner thereof; thence S 00° 54' 07" E, along the west line of said Lot 1, 228 feet for a true place of beginning; thence N 89° 05' 53" E, 40 feet; thence N 00° 54' 07" W, 15 feet; thence S 89° 05' 53" W, 40 feet; thence S 00° 54' 07" E, 15 feet to the place of beginning.

DEDICATED BY: University Congregational Church

PURPOSE OF DEDICATION:

II. SKETCH.

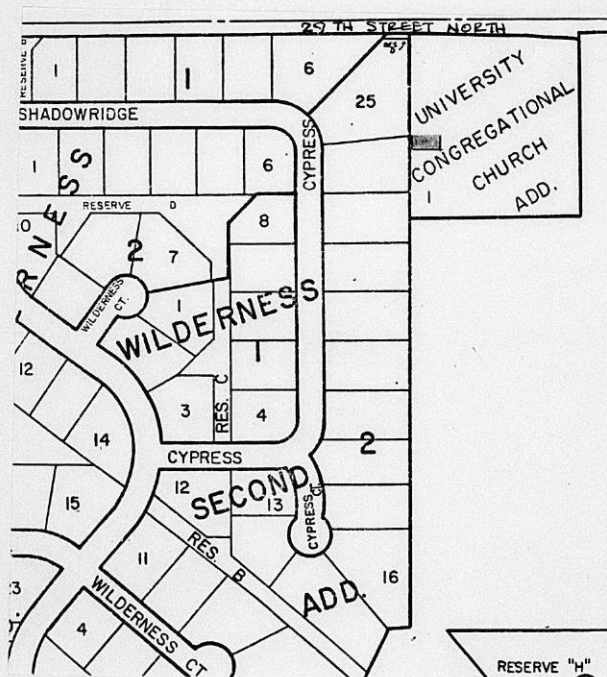

111. FILED 11/18/86
POSTED TO ATLAS
S/D COMM. ACTION 12/18/86 approved
M.A.P.C. ACTION 12/22/86 approved

B.C.C. ACTION 1-20-87
PLACED ON RECORD
CITY CLERKS NO.

Planning Agenda Item # _____

City of Wichita
City Commission Meeting
January 20, 1987

Agenda Report # _____

TO: Mayor and City Commissioners

SUBJECT: D-1417 - DEDICATION OF UTILITY EASEMENT, LOCATED SOUTH
OF 29TH STREET NORTH AND WEST OF WEBB ROAD.

INITIATED BY: Metropolitan Area Planning Department

AGENDA ACTION: Planning

MAPC Recommendation: Accept the dedication.

Background: University Congregational Church is dedicating this utility easement for a sanitary sewer project.

Financial Considerations: Bill the recording costs to:

468-76-245-81586-000-000-001

Recommendations/Actions: Accept the dedication and record document.

Lot 1, UIC
460-21582-001

EASEMENT

THIS EASEMENT made this 18th day of November,
1986, by and between William Smith, President and Joan Middlemast,
Clerk of University Congregational Church

of the first part and the City of Wichita, of the second part.

WITNESSETH: That the said first party, in consideration of the sum of One Dollar (\$1.00) and other valuable consideration, the receipt whereof is hereby acknowledged, does hereby grant and convey unto the said second party a perpetual right-of-way and easement for the purpose of constructing, maintaining, and repairing sewer and all other public utilities, over, along and under the following described real estate situated in Sedgwick County, Kansas, to wit:

That part of Lot 1, University Congregational Church Addition, Wichita, Kansas, described as commencing at the N.W. Corner thereof; thence S 00°54'07" E, along the west line of said Lot 1, 228 feet for a true place of beginning; thence N 89°05'53" E, 40 feet; thence N 00°54'07" W, 15 feet; thence S 89°05'53" W, 40 feet; thence S 00°54'07" E, 15 feet to the place of beginning.

And said second party is hereby granted the right to enter upon said premises at any time for the purpose of constructing, operating, maintaining, and repairing such sewer and all other public utilities.

IN WITNESS WHEREOF: The said first party has signed these presents the day and year first written.

University Congregational Church William Smith President
William Smith

Joan Middlemast Clerk
Joan Middlemast

NOTARY
PUBLIC
STATE OF KANSAS)
SEDGWICK COUNTY) SS

Be it remembered that on this 18th day of November,
1986, before me, a notary public in and for said County and State,
came William Smith and Joan Middlemast
to me personally known to be the same person(s) who executed the
foregoing instrument of writing and duly acknowledged the execution
of same. In testimony whereof I have hereunto set my hand and af-
fixed my notarial seal the day and year above written.

SEAL

Patricia Platt
Notary Public
Patricia Platt

My Commission expires: October 27, 1987

THE CITY OF WICHITA

OFFICE OF MAPD - Design Division

DATE November 24, 1986

TO Forrest Nagley, Senior Planner

FROM Mike Lindebak, City Engineer/Acting Director of Planning *ML*

SUBJECT Lateral 91, WIS
468 76 245 81586 000 000 001

Attached is a sewer/utility easement received in connection with the subject project.

Please place the attached instrument on the agenda for Subdivision Committee consideration. Upon approval by the City Commission, I would appreciate a copy of the recorded instrument for our file.

/JLL:ms
Attachment

*University Congregational Church grants a
util. easmt. Generally located south of
29th St. North and west of Webb Rd.*

*6050 A
5
27S
2E*

For 12/18/86 SID mtg.

RECEIVED

NOV 27 1986

METROPOLITAN PLANNING
ROUTE _____

BOUND CARETV AND
LINES CROSSING

29TH

ST.

NORTH

REMOVE AND REPLACE WIRE
FENCE AS NECESSARY FOR CONST.

CONTRACTOR TO REMOVE HEDGE,
ONLY AS NECESSARY FOR CONST.

STATION 2402, CONSTRUCT STD
TYPE, P' OR C' MANHOLE, TOP
210.0 CONNECT TO EXIST 4"
SERVICE LINE FROM NE 1/4"
LINE SE.

ADDITION
40' DRAINAGE
EASEMENT
HEIR PERSON

10' UTILITY EASEMENT
CARETV LINE

SECOND
LOT LINE
201.5' ELEC. STUB

UTILITY EASEMENT

OR TO PROTECT EXISTING
FROM DAMAGE DURING
ITION.

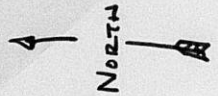

UNIVERSITY
CONGREGATIONAL
CHURCH ADDITION
LOT 1

15' X 45' UTILITY EASEMENT
(BY SEPARATE INSTRUMENT)

CONTRACTOR TO EXPOSE &
VERIFY SERVICE LINE ROW
ELEVATION PRIOR TO CONST.