

# ACTION

	DATE
S/D COMMITTEE	<u>1/29/87</u>
M.A.P.C.	<u>2-5-87</u>
B.C.C./B.O.C.	<u>3-3-87</u>

approved

approved

Approved

D-1424 - Lakepoint Company grants utility easements located in an area west of Webb Road and north of Central.

Posted 1-25-87 WJ ✓

## ACTION

	DATE
S/D COMMITTEE	<u>approved</u> <u>1/29/87</u>
M.A.P.C.	<u>approved</u> <u>2-5-87</u>
B.C.C./B.CO.C.	<u>Approved</u> <u>3-3-87</u>

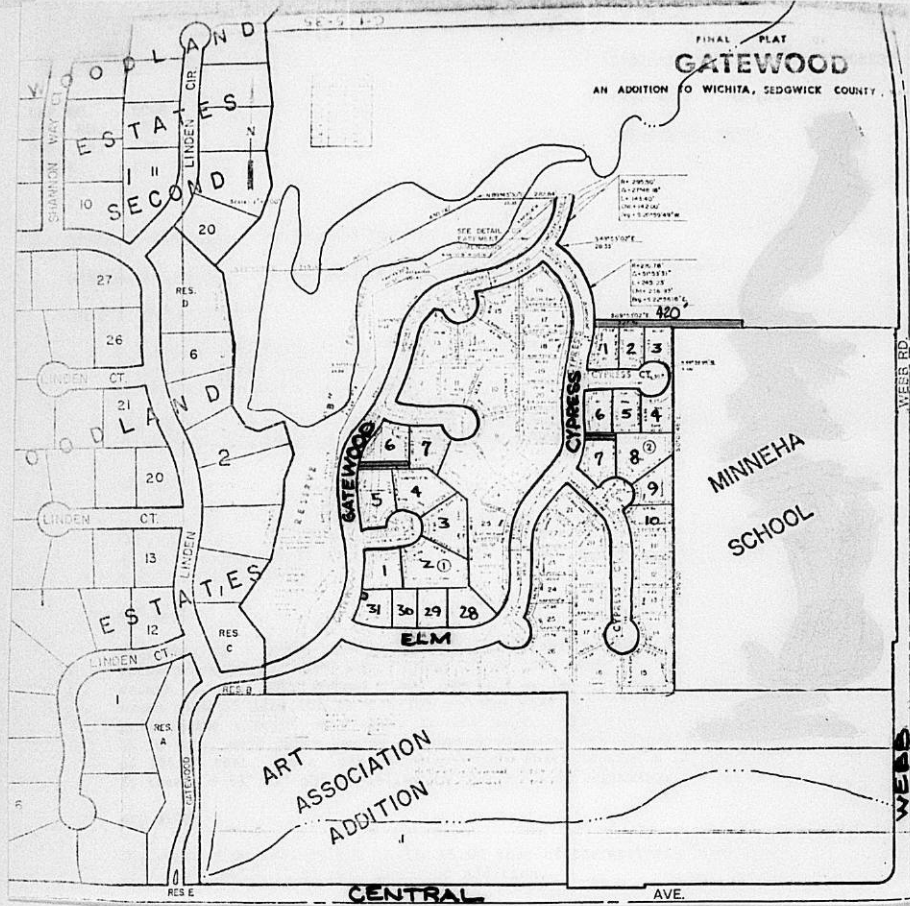

DEDICATED BY: Lakepoint Company  
 PURPOSE OF DEDICATION:

II. SKETCH.

III. FILED 1/9/87  
 POSTED TO ATLAS  
 S/D COMM. ACTION 1/29/87 approved  
 M.A.P.C. ACTION 2-5-87 approved

B.C.C. ACTION 3-3-87 Approved  
 PLACED ON RECORD \_\_\_\_\_  
 CITY CLERKS NO. \_\_\_\_\_

MAP NO. 6048 B  
SEC. NO. 17  
TWP. NO. 27S  
RANGE 2E

CASE NO.: D-1424

ASSOCIATED CASE:

1. OFFER TO DEDICATE: Utility easements.

GENERALLY LOCATED: In an area west of Webb Road and north of Central.

LEGALLY DESCRIBED AS:

A tract of land lying in the Southeast Quarter of Section 17, Township 27 South, Range 2 East of the 6th P.M., Sedgwick County, Kansas, more particularly described as follows:

The south 3.00 feet of the north 13.00 feet of Lot 7, Block 2, Gatewood, an addition to Wichita, Sedgwick County, Kansas.

AND ALSO:

A 20.00 foot strip of land lying north of and adjacent to the following described line: beginning at the northwest corner of Lot 1, Block 2, of said Gatewood Addition, thence S 89° 53' 02" E, 420.00 feet to the point of termination.

AND ALSO:

Beginning at a point on the east line of Lot 6, Block 1, of said Gatewood Addition, said point lying 10.00 feet north of the southeast corner of said lot; thence N 89° 53' 02" W, 145.70 parallel with the south line of said lot to a point on the west line of said lot, said point being a point on a curve to the right; thence along said curve 16.96 feet, said curve having a central angle of 05° 16' 05", a radius of 184.50 feet, and a long chord of 16.96 feet, bearing N 16° 29' 44" E; thence S 83° 17' 53" E, 141.86 to the point of beginning.

AND ALSO:

The south 5.00 feet of the north 15.00 feet of the westerly 5.00 feet of Lot 31, Block 1, of said Gatewood Addition.

DEDICATED BY: Lakepoint Company

PURPOSE OF DEDICATION:

II. SKETCH.

III. FILED 1/9/87  
POSTED TO ATLAS  
S/D COMM. ACTION 1/29/87 *approved*  
M.A.P.C. ACTION 2-5-87 *approved*

B.C.C. ACTION 3-3-87 *Approved*  
PLACED ON RECORD  
CITY CLERKS NO.

Planning Agenda Item # \_\_\_\_\_

City of Wichita  
City Commission Meeting  
March 3, 1987

Agenda Report # \_\_\_\_\_

TO: Mayor and City Commissioners

SUBJECT: D-1424 - DEDICATION OF ADDITIONAL UTILITY EASEMENTS, LOCATED  
IN AN AREA WEST OF WEBB ROAD, NORTH OF CENTRAL.

INITIATED BY: Metropolitan Area Planning Department

AGENDA ACTION: Planning

-----  
MAPC Recommendation: Accept the dedication.

Background: Lakepoint Company is dedicating these additional utility easements for a sanitary sewer project.

Financial Considerations: Bill the recording costs to:  
468-76-245-81648-000-000-001

Recommendations/Actions: Accept the dedication and record document.

PL/6205/5

EASEMENT

Lot 7, Block 2, Gatewood  
Sub 76-245-81678-000-000-001  
D-1424

THIS EASEMENT made this 9<sup>th</sup> day of January, 1987, by and between Lakepoint Company, a Kansas general partnership, of the first part and the City of Wichita, of the second part.

WITNESSETH: that the said first party, in consideration of the sum of One Dollar (\$1.00) and other valuable consideration, the receipt whereof is hereby acknowledged, do hereby grant and convey unto the said second party a perpetual right of way and easement for the purpose of constructing, maintaining and repairing their utility over, along and under the following described real estate situated in Sedgwick County, Kansas, to wit:

A tract of land lying in the Southeast Quarter of Section 17, Township 27 South, Range 2 East of the 6th P.M., Sedgwick County, Kansas, more particularly described as follows:

The South 3.00 feet of the North 13.00 feet of Lot 7, Block 2, Gatewood, an addition to Wichita, Sedgwick County, Kansas.

AND ALSO:

A 20.00 foot strip of land lying North of and adjacent to the following described line: Beginning at the Northwest corner of Lot 1, Block 2, of said Gatewood addition, thence S 89° 53' 02" E, 420.00 feet to the point of termination.

AND ALSO:

Beginning at a point on the East line of Lot 6, Block 1, of said Gatewood addition, said point lying 10.00 feet North of the Southeast corner of said lot; thence N 89° 53' 02" W, 145.70 parallel with the South line of said lot to a point on the West line of said lot, said point being a point on a curve to the right; thence along said curve 16.96 feet, said curve having a central angle of 05° 16' 05", a radius of 184.50 feet, and a long chord of 16.96 feet, bearing N 16° 29' 44" E; thence S 83° 17' 53" E, 141.86 to the point of beginning.

AND ALSO:

The South 5.00 feet of the North 15.00 feet of the Westerly 5.00 feet of Lot 31, Block 1, of said Gatewood addition.

And said second party is hereby granted the right to enter upon said premises at any time for the purpose of constructing, operating, maintaining and repairing their utilities.

IN WITNESS WHEREOF: The said first party has signed these presents the day and year first written.

LAKEPOINT COMPANY,  
A Kansas general partnership,  
by Ritchie Associates, Inc.,  
managing partner of said partnership

By: Kevin M. Mullen  
Kevin M. Mullen, Vice-President

STATE OF KANSAS  
SS:  
SEDGWICK COUNTY

Personally appeared before me a notary public in and for the County and State aforesaid came Kevin M. Mullen, Vice-President, Ritchie Associates, Inc., to me personally known to be the same person who executed the foregoing instrument of writing and said person duly acknowledged the execution thereof.

Dated at Wichita this 9<sup>th</sup> day of January, 1987.

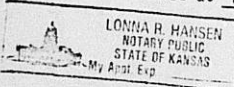

Lonna R. Hansen  
Notary Public  
Lonna R. Hansen

My Appointment Expires: August 25, 1990

**THE CITY OF WICHITA**

**OFFICE OF** MAPD - Design Division **DATE** January 13, 1987

**TO** Forrest Nagley, Senior Planner

**FROM** Mike Lindebak, City Engineer *ML*

**SUBJECT** Lateral 4, Main 24,  
War Industries Sewer  
468 76 245 81648 000 000 001

Attached is a utility easement received in connection with the subject project.

Please place the attached instrument on the agenda for Subdivision Committee consideration. Upon approval by the City Commission, I would appreciate a copy of the recorded instrument for our file.

*Lakepoint Company grants utility easements,  
west of Webb Rd.  
in an area east of Express and north of Central.*

/JLL:ms  
Attachment

6048 B  
17  
7275  
RJE

**RECEIVED**

JAN 15 1987

METROPOLITAN PLANNING

ROUTE  \_\_\_\_\_  
 \_\_\_\_\_

*FOR 1/29/87*

*SID mtg.*