

D-1432 - Wichita Board of Park Commissioners grants a utility easement located in an area east of Oliver and north of 29th Street North.

Pasted 2-11-87 K&S

5851

ACTION

	DATE
S/D COMMITTEE	<u>approved</u> <u>2/26/87</u>
M.A.P.C.	<u>approved</u> <u>3/5/87</u>
B.C.C./B.O.C.	<u>Accept</u> <u>3/31/87</u>

DEDICATION REPORT AND PROGRESS

MAP NO. 5851 C  
SEC. NO. 36  
TWP. NO. 26S  
RANGE 1E

CASE NO.: D-1432

ASSOCIATED CASE:

1. OFFER TO DEDICATE: Utility easement.

GENERALLY LOCATED: In an area east of Oliver and north of 29th Street North.

LEGALLY DESCRIBED AS:

The east 20 feet of the west 50 feet of the north 20 acres of the south 1798.25 feet of the west half of the Southwest Quarter of Section 36, Township 26 South, Range 1 East of the 6th P.M.

DEDICATED BY: Wichita Board of Park Commissioners

PURPOSE OF DEDICATION:

II. SKETCH.

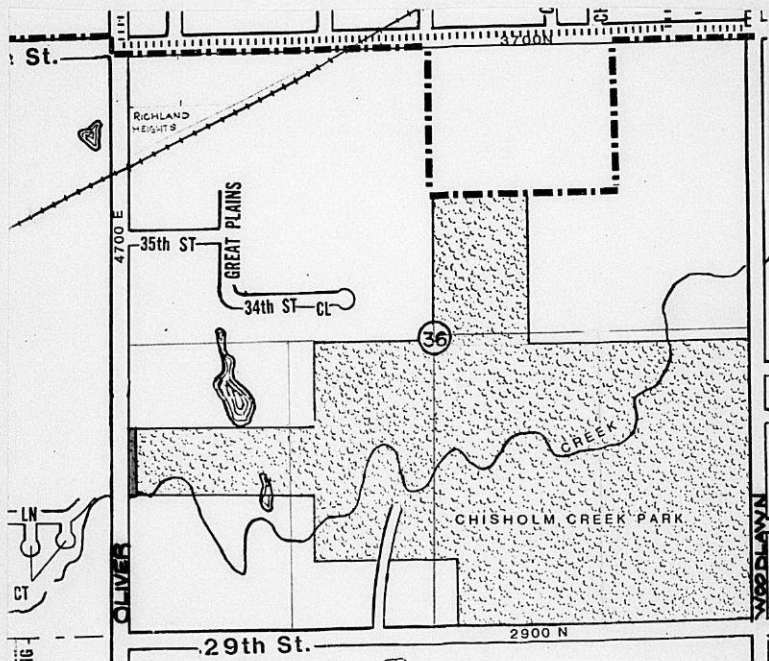

III. FILED 1/26/87  
POSTED TO ATLAS  
S/D COM. ACTION 2/26/87 *approval*  
M.A.P.C. ACTION 3-5-87 *approval*

B.C.C. ACTION 3-31-87 *Accept*  
PLACED ON RECORD  
CITY CLERKS NO.

Planning Agenda Item # \_\_\_\_\_

City of Wichita  
City Commission Meeting  
March 31, 1987

Agenda Report # \_\_\_\_\_

TO: Mayor and City Commissioners

SUBJECT: D-1432 - DEDICATION OF UTILITY EASEMENT, LOCATED IN AN  
AREA EAST OF OLIVER AND NORTH OF 29TH STREET NORTH.

INITIATED BY: Metropolitan Area Planning Department

AGENDA ACTION: Planning

-----  
MAPC Recommendation: Accept the dedication.

Background: Wichita Board of Park Commissioners are granting this utility  
easement for a storm water sewer project.

Financial Considerations: Bill the recording costs to:  
468-76-245-81650-000-000-001

Recommendations/Actions: Accept the dedication and record document.

PL/6356/5

Chisholm Creek Park  
DEDICATION

KNOW ALL MEN BY THESE PRESENTS:

That for and in consideration of the sum of One Dollar (\$1.00) and other good and valuable considerations, the receipt of which is hereby acknowledged, the undersigned, Board of Park Commissioners

being the owner of the following described real estate in Sedgwick County, Kansas, to wit:

The east 20 ft. of the west 50 ft. of the north 20 acres of the south 1798.25 ft. of the west half of the Southwest Quarter of Section 36, Township 26 South, Range 1 East of the 6th P.M..

do es hereby dedicate the above described real estate to the public for Underground Utility & Temporary Construction Easement purposes.

Executed this 26th day of January 19 87.

ATTEST:

Lucille Brierly  
Lucille Brierly, Park Board Clerk

Keith Stevens  
Keith Stevens, President  
Board of Park Commissioners of  
the City of Wichita, Kansas.

STATE OF KANSAS )  
SEDGWICK COUNTY ) ss

BE IT REMEMBERED, that on this 26th day of January, 1987,  
came Keith Stevens, President of the Board of Park Commissioners

to me personally known to be the same person who executed the foregoing instrument and duly acknowledged the execution of the same.

IN WITNESS WHEREOF, I have hereunto subscribed my name and affixed my official seal, the day and year last above written.

Submitted to the Wichita-Sedgwick County Metropolitan Area Planning Commission and the Board of Commissioners of the City of Wichita, Kansas, and approved by said Board of Commissioners of the City of Wichita, Kansas,

this \_\_\_\_\_

City Clerk

Donna M. Middleton  
Notary Public  
Donna N. Middleton  
My Commission Expires: 11-3-87

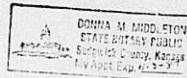

5851C  
36  
265  
1E

**THE CITY OF WICHITA**

**OFFICE OF** MAPD - Design Division **DATE** January 29, 1987

**TO** Forrest Nagley, Senior Planner

**FROM** Mike Lindebak, City Engineer *ML*

**SUBJECT** Aurora Park Outfall Sewer  
Reconstruction  
468 76 245 81650 000 000 001

Attached is an underground utility and temporary construction ease-  
ment received in connection with the subject project.

Please place the attached instrument on the agenda for Subdivision  
Committee consideration. Upon approval by the City Commission, I  
would appreciate a copy of the recorded instrument for our file.

/JLL:ms  
Attachment

**RECEIVED**

FEB 02 1987

METROPOLITAN PLANNING

ROUTE