

D-1434 - Lakepoint Company grants a utility easement located east of Cypress in an area north of Central.

POSTED 2-11-87 ✓
102

6048

ACTION

	DATE
SID COMMITTEE	<u>approved</u> 2/26/87
M.A.P.C.	<u>approved</u> 3-5-87
B.C.C./B.E.O. C.	<u>Accepted</u> 3-31-87

DEDICATION REPORT AND PROGRESS

MAP NO. 6048 B
SEC. NO. 17
TWP. NO. 27S
RANGE 2E

CASE NO.: D-1434

ASSOCIATED CASE:

1. OFFER TO DEDICATE: Utility easement.

GENERALLY LOCATED: East of Cypress, in an area north of Central.

LEGALLY DESCRIBED AS:

A tract of land located in the Southeast Quarter of Section 17, Township 26 South, Range 2 East of the 6th P.M., Sedgwick County, Kansas, more particularly described as follows:

The east 10.00 feet of Lots 3 and 4, Block 2, Gatewood, an Addition to Wichita, Sedgwick County, Kansas.

DEDICATED BY: Lakepoint Company

PURPOSE OF DEDICATION:

II. SKETCH.

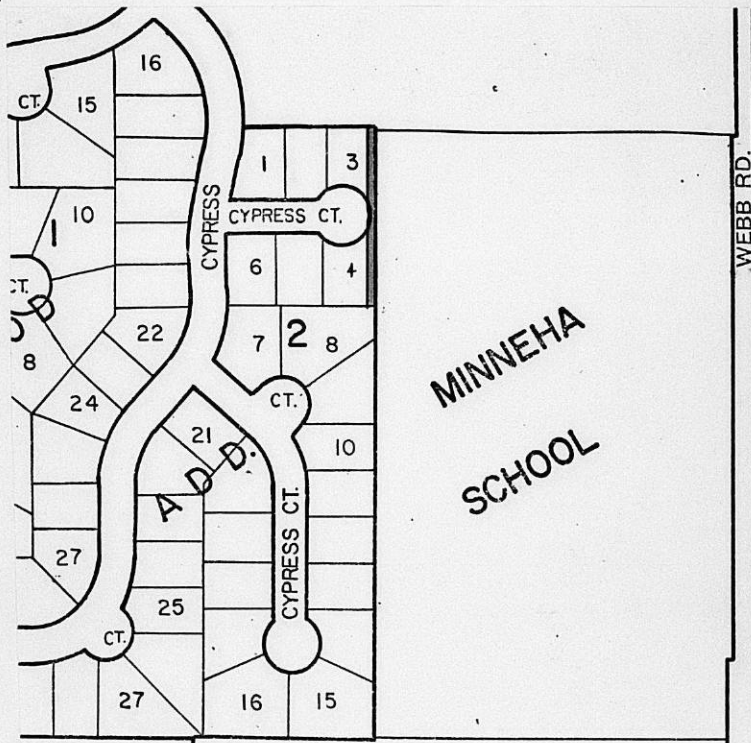

III. FILED 1/20/87
 POSTED TO ATLAS
 S/D COMM. ACTION 2/26/87 *approved*
 M.A.P.C. ACTION 3-5-87 *approved*

B.C.C. ACTION 3-31-87 *Accepted*
 PLACED ON RECORD
 CITY CLERKS NO.

Planning Agenda Item # _____

City of Wichita
City Commission Meeting
March 31, 1987

Agenda Report # _____

TO: Mayor and City Commissioners

SUBJECT: D-1434 - DEDICATION OF UTILITY EASEMENT, LOCATED EAST OF CYPRESS, IN AN AREA NORTH OF CENTRAL.

INITIATED BY: Metropolitan Area Planning Department

AGENDA ACTION: Planning

MAPC Recommendation: Accept the dedication.

Background: Lakepoint Company is granting this utility easement at the request of various utility companies.

Financial Considerations: Bill the recording costs to:

Lakepoint Company
c/o Ritchie Associates
8100 E. 29th Street North, Bldg. 500
Wichita, KS 67226

Recommendations/Actions: Accept the dedication and record document.

EASEMENT

THIS EASEMENT made this 20th day of January, 1987, by and between Lakepoint Company, a Kansas general partnership, of the first part and the City of Wichita, of the second part.

WITNESSETH: that the said first party, in consideration of the sum of One Dollar (\$1.00) and other valuable consideration, the receipt whereof is hereby acknowledged, do hereby grant and convey unto the said second party a perpetual right of way and easement for the purpose of constructing, maintaining and repairing their utility over, along and under the following described real estate situated in Sedgwick County, Kansas, to wit:

A tract of land located in the Southeast Quarter of Section 17, Township 26 South, Range 2 East of the 6th P.M. Sedgwick County, Kansas, more particularly described as follows:

The East 10.00 feet of Lots 3 and 4, Block 2 Gatewood, an addition to Wichita, Sedgwick County, Kansas.

And said second party is hereby granted the right to enter upon said premises at any time for the purpose of constructing, operating, maintaining and repairing their utilities.

IN WITNESS WHEREOF: The said first party has signed these presents the day and year first written.

LAKEPOINT COMPANY,
a Kansas general partnership
by Ritchie Associates, Inc.,
managing partner of said partnership

By: Jack D. Ritchie
Jack D. Ritchie, President

STATE OF KANSAS

ss:

SEDGWICK COUNTY

Personally appeared before me a notary public in and for the County and State aforesaid came Jack D. Ritchie, President, Ritchie Associates, Inc., to me personally known to be the same person who executed the foregoing instrument of writing and said person duly acknowledged the execution thereof.

Dated at Wichita this 20th day of January, 1987.

Joyce L. Kaufman
Notary Public Joyce L. Kaufman

My Appointment Expires: June 8, 1988

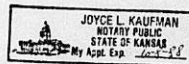



**MID-KANSAS ENGINEERING
CONSULTANTS, P.A.**
3500 N. Rock Road, #800
Wichita, KS 67226

LETTER OF TRANSMITTAL

PROJECT: Gatewood

PROJECT #: _____ DATE: 2/03/87

TO: Mr. Forrest Nagley
Senior Planner
455 N. Main, 10th Floor
Wichita, KS 67202

We are sending you the following items: Attached
 Under separate cover via _____

Prints Specifications Legal Descriptions
 Tracing Petitions Correspondence Other

COMMENTS: Per the request of Southwestern Bell, submitted herewith is a ten (10) foot utility easement for Lots 3 and 4, Block 2, of the referenced addition.

These are transmitted as checked below:

For Your Approval As Requested
 For Your Use For Your Files
 Approved as Noted For Review and Comment

REMARKS:

Signed: Kenneth H. Bengtson
Kenneth H. Bengtson, P.E.

KHB/jlk

cc: Debra Arensman

~~5949~~ 6048 B
17
275
JE

FOR
2/26/87
SID mty.

EAST OF CYPRESS, IN AN AREA
NORTH OF CENTRAL.

Lakeport Company grants a util. easment.