

D-1440 - St. Francis Regional Medical
Center dedicates ~~the~~
utility easement located north of
Murdock and west of Santa Fe.

POSTED 3-26-87 KRP

5548C

ACTION

S/D	COMMITTEE	DATE
	<u>approved</u>	<u>4/9/87</u>
	M.A.P.C.	<u>4/16/87</u>
	<u>approved</u>	
	R.C.C./B-GO.C.	<u>4-20-87</u>
	<u>Approved</u>	

MAP NO. 5548 C
 SEC. NO. 16
 TWP. NO. 27S
 RANGE 1E

DEDICATION REPORT AND PROGRESS

CASE NO.: D-1440

ASSOCIATED CASE:

1. OFFER TO DEDICATE: Right-of-way and utility easement.
 GENERALLY LOCATED: North of Murdock and west of Santa Fe.
 LEGALLY DESCRIBED AS:

The east 20 feet of Lot 1, Block 2, St. Francis Regional Medical Center 2nd Addition.

DEDICATED BY: St. Francis Regional Medical Center

PURPOSE OF DEDICATION:

II. SKETCH.

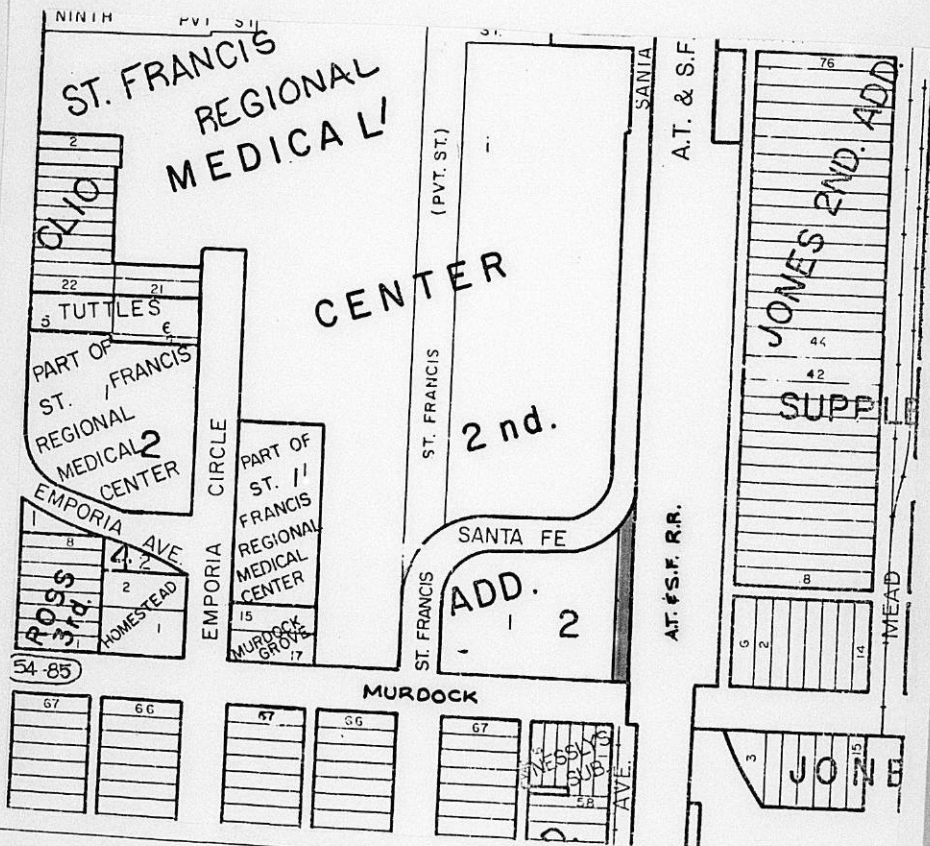

III. FILED 3/6/87
 POSTED TO ATLAS
 S/D COMM. ACTION 4/9/87 *approved*
 M.A.P.C. ACTION 4/16/87 *approved*

B.C.C. ACTION 4-28-87 *Approved*
 PLACED ON RECORD
 CITY CLERKS NO.

Planning Agenda Item # _____

City of Wichita
City Council Meeting
April 28, 1987

Agenda Report # _____

TO: Mayor and City Council Members

SUBJECT: D-1440 - DEDICATION OF UTILITY EASEMENT, LOCATED NORTH
OF MURDOCK AND WEST OF SANTA FE.

INITIATED BY: Metropolitan Area Planning Department

AGENDA ACTION: Planning

MAPC Recommendation: Accept the dedication.

Background: St. Francis Regional Medical Center, Inc. is granting this utility easement for a gas line extension.

Financial Considerations: Bill the recording costs to:

St. Francis Regional Medical Center, Inc.
Attention: Alan McLeod
929 N. St. Francis
Wichita, KS 67214

Recommendations/Actions: Accept the dedication and record document.

PL/6608/5

Dedication file

St Francis Regional Medical
Center, Inc. dedication record
and utility easement in
an area generally located
north of Muldock and
west of Santa Fe

Map # 5548C

16

275

1E

ORIGINAL

EASEMENT

THIS EASEMENT made this 6th day of March, 1987,
by and between St. Francis Regional Medical Center, Inc.
of the first part and the City of Wichita, of the second part.

WITNESSETH: That the said first party, in consideration of the sum of One Dollar (\$1.00) and other valuable consideration, the receipt whereof is hereby acknowledged, do hereby grant and convey unto the said second party a perpetual right of way and easement for the purpose of constructing, maintaining, and repairing all public utilities, over, along and under the following described real estate situated in Sedgwick County, Kansas, to wit:

The east 20' of Lot 1, Block 2, St. Francis Regional Medical Center 2nd Addition.

And said second party is hereby granted the right to enter upon said premises at any time for the purpose of constructing, operating, maintaining, and repairing said public utilities.

IN WITNESS WHEREOF: The said first party has signed these presents the day and year first written.

St. Francis Regional Medical Center, Inc.

Sr. M. Sylvia Egan, President

Sr. M. Sylvia Egan

STATE OF KANSAS)

SEDGWICK COUNTY)

SS

Personally appeared before me a notary public in and for the County and State aforesaid Sr. M. Sylvia Egan, as President and Chief Executive Officer of St. Francis Regional Medical Center, Inc.

to me personally known to be the same person who executed the foregoing instrument of writing and said person duly acknowledged the execution thereof.

at Wichita, Kansas, this 6th day of March 1987.

Andrua L. Orsini
Notary Public

(My Commission expires November 28, 1988)



TRANSMITTAL

TO: <u>Forrest Nagley</u> _____ _____	FROM: <u>Mike Lindebak, City Engineer</u> CITY OF WICHITA CITY ENGINEER'S OFFICE 455 N. MAIN, 7TH FLOOR WICHITA, KANSAS 67202 TELEPHONE: <u>4266</u> or (316) 268-4501
ATTENTION: _____	

PROJECT TITLE:
N/A

PROJECT NUMBER: N/A	DATE: March 18, 1987
------------------------	-------------------------

THE FOLLOWING ITEMS ARE BEING TRANSMITTED TO YOU:

<input type="checkbox"/> Plans, prints or tracings	<input type="checkbox"/> Specifications	<input type="checkbox"/> Certificate of Insurance	<input type="checkbox"/> Petition
<input type="checkbox"/> Change order	<input type="checkbox"/> Correspondence	<input type="checkbox"/> Agreement form	
<input checked="" type="checkbox"/> Other <u>Easement</u>			

THE ITEMS ARE BEING TRANSMITTED FOR THE FOLLOWING PURPOSE:

<input type="checkbox"/> For your approval and signature	<input type="checkbox"/> For your files	<input type="checkbox"/> For your use
<input type="checkbox"/> For your review and resubmittal	<input type="checkbox"/> Returned for revisions	<input type="checkbox"/> To advise of approval
<input type="checkbox"/> Other _____		

COMMENTS:
We have no objection to accepting the attached easement across a portion of St. Francis Regional Medical Center 2nd Addition.

/JLL:ms
Attachment
cc: Carl Gipson, Civil Engineer

RECEIVED
MAR 19 1987
METROPOLITAN PLANNING
ROUTE _____

*Change to -
St. Francis Regional Medical
Center, Inc.
Attn - Alan McLeod*