

This dedication was a requirement
of associated vacation case
V-1448

FEAL

ACTION

COMMITTEE	DATE
M.A.P.C.	_____
R.C.C. <u>ANONA</u>	_____
<u>Langst</u>	<u>5-12-67</u>

D-1445 - Slawson Investment Corp. dedicates utility easement along Lots 3 & 4, Block 1, BRIARWOOD ESTATES 5TH ADDITION, located in an area south of 13th St. N. and east of 119th Street West.

POSTED 4-9-87 KCS

This dedication was a requirement
of associated vacation case
V-144B
FEN

ACTION

COMMITTEE _____ DATE _____

M.A.P.C. _____

B.C.C. ANONIA Langst 5-12-87

D-1445 - Slawson
cates utility ad
Block 1, BRIARWOOD
located in an area
and east of 119th

DEDICATION REPORT AND PROGRESS

MAP NO. 4748 D
SEC. NO. 18
TWP. NO. 27S
RANGE 1W

CASE NO.: D-1445

ASSOCIATED CASE: V-1448

1. OFFER TO DEDICATE: Utility easement.

GENERALLY LOCATED: In an area south of 13th Street North and east of 119th Street West.

LEGALLY DESCRIBED AS:

The south 8 feet of the north 18 feet of Lots 3 and 4, Block 1, Briarwood Estates 5th Addition.

DEDICATED BY: Slawson Investment Corporation

PURPOSE OF DEDICATION:

II. SKETCH.

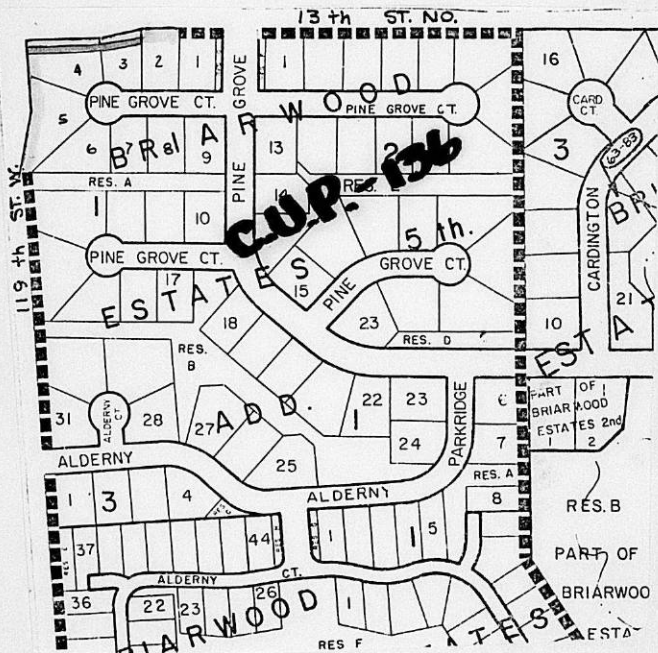

III. FILED _____ 3/31/87 _____
 POSTED TO ATLAS _____
 S/D COMM. ACTION _____
 M.A.P.C. ACTION _____

B.C.C. ACTION 5-12-87 Accept _____
 PLACED ON RECORD _____
 CITY CLERKS NO. _____

D-1445

EASEMENT

THIS EASEMENT made this 30th day of March, 1987,
by and between SLAWSON INVESTMENT CORPORATION
of the first part and the City of Wichita, of the second part.

WITNESSETH: That the said first party, in consideration of the sum of One Dollar (\$1.00) and other valuable consideration, the receipt whereof is hereby acknowledged, do hereby grant and convey unto the said second party a perpetual right of way and easement for the purpose of constructing, maintaining, and repairing all public utilities, over, along and under the following described real estate situated in Sedgwick County, Kansas, to wit:

The south 8 feet of the north 18 feet of Lots 3 and 4, Block 1, Briarwood Estates 5th Addition.

And said second party is hereby granted the right to enter upon said premises at any time for the purpose of constructing, operating, maintaining, and repairing said public utilities.

IN WITNESS WHEREOF: The said first party has signed these presents the day and year first written.

SLAWSON INVESTMENT CORPORATION
Larry A. Chambers
Larry A. Chambers, Vice President

STATE OF KANSAS) SS
SEDGWICK COUNTY)

Personally appeared before me a notary public in and for the County and State aforesaid SLAWSON INVESTMENT CORPORATION by Larry A. Chambers, Vice President

to me personally known to be the same person who executed the foregoing instrument of writing and said person duly acknowledged the execution thereof.

Dated at Wichita, Kansas, this 31st day of March, 1987.



Linda S. Graham
Notary Public Linda S. Graham

(My Commission expires 2/9/90)