

6050A

ACTION

S/D COMMITTEE	<u>approved</u>	D.:	<u>5/17/87</u>
M.A.P.C.	<u>approved</u>		<u>5/14/87</u>
B.C.C./B.C.C.C.	<u>Approved</u>		<u>5/26/87</u>

D-1448 - Slawson Investment Co. grants a utility easement in Lot 1, Block 2, of WOODSPRING 3RD ADDITION, located in an area south of 29th Street North and east of Webb Road.

PSED 4-23-87 ✓
KW

6050A

ACTION

SID COMMITTEE	<u>approved</u>	^{D.} 5/7/87
M.A.P.C.	<u>approved</u>	5/14/87
B.C.C./B.C.C.C.	<u>Approved</u>	5/26/87

D-1448 - Slaw
a utility eas
WOODSPRING 3R
area south of
of Webb Road.

DEDICATION REPORT AND PROGRESS

MAP NO. 6050 A
 SEC. NO. 5
 TWP. NO. 27S
 RANGE 2E

CASE NO.: D-1448

ASSOCIATED CASE:

1. OFFER TO DEDICATE: Utility easement.

GENERALLY LOCATED: In an area south of 29th Street North and east of Webb Road.

LEGALLY DESCRIBED AS: (See drawing)

A strip of land located in Lot 1, Block 2, Woodspring 3rd, an addition to Wichita, Sedgwick County, Kansas, more particularly described as follows: Commencing from the southwest point of curvature on said Lot 1, Block 2; thence N 0° 54' 44" W, 27.00 feet along the west line of said Lot 1, Block 2; thence N 89° 05' 16" E, 15.00 feet to the point of beginning; thence N 0° 54' 44" W, 20.00 feet; thence N 89° 05' 16" E, 20.00 feet; thence S 0° 54' 44" E, 20.00 feet; thence S 89° 05' 16" W, 20.00 feet to the point of beginning.

DEDICATED BY: Slawson Investment Corporation

PURPOSE OF DEDICATION:

II. SKETCH.

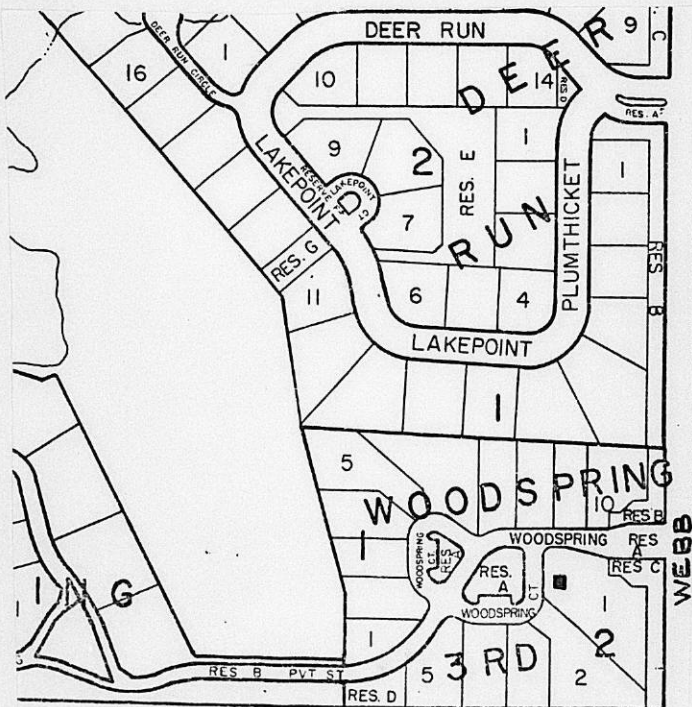

III. FILED 4/9/87
 POSTED TO ATLAS
 S/D COMM. ACTION 5/7/87 *approved*
 M.A.P.C. ACTION 5/14/87 *approved*

B.C.C. ACTION 5/26/87 *Approved*
 PLACED ON RECORD
 CITY CLERKS NO.

Planning Agenda Item # _____

City of Wichita
City Council Meeting
May 26, 1987

Agenda Report # _____

TO: Mayor and City Council Members

SUBJECT: D-1448 - DEDICATION OF UTILITY EASEMENT, LOCATED IN AN AREA SOUTH OF 29TH STREET NORTH AND EAST OF WEBB ROAD.

INITIATED BY: Metropolitan Area Planning Department

AGENDA ACTION: Planning

MAPC Recommendation: Accept the dedication.

Background: Slawson Investment Company is granting this utility easement for a sanitary sewer project.

Financial Considerations: Bill the recording costs to:
468-76-245-81270-000-000-001

Recommendations/Actions: Accept the dedication and record document.

PL/6777/5

Lot 26, Blk 2, W 15
228-72-245-0120-000-000-001

EASEMENT

THIS EASEMENT made this 9th day of April, 1987, by and between Slawson Investment Corporation of the first part and the City of Wichita, of the second part.

WITNESSETH: that the said first party, in consideration of the sum of One Dollar (\$1.00) and other valuable consideration, the receipt whereof is hereby acknowledged, do hereby grant and convey unto the said second party a perpetual right of way and easement for the purpose of constructing, maintaining and repairing their UTILITY over, along and under a portion of:

A strip of land located in Lot 1, Block 2, Woodspring 3rd, an addition to Wichita, Sedgwick County, Kansas, more particularly described as follows: Commencing from the Southwest point of curvature on said Lot 1, Block 2; thence N 0° 54' 44" W, 27.00 feet along the West line of said Lot 1, Block 2; thence N 89° 05' 16" E, 15.00 feet to the point of beginning; thence N 0° 54' 44" W, 20.00 feet; thence N 89° 05' 16" E, 20.00 feet; thence S 0° 54' 44" E, 20.00 feet; thence S 89° 05' 16" W, 20.00 feet to the point of beginning;

And said second party is hereby granted the right to enter upon said premises at any time for the purpose of constructing, operating, maintaining and repairing their UTILITY.

IN WITNESS WHEREOF: The said first party has signed these presents the day and year first written.

SLAWSON INVESTMENT CORPORATION

By: Larry A. Chambers
Larry A. Chambers, Vice President

STATE OF KANSAS
ss:
SEDGWICK COUNTY

Personally appeared before me a notary public in and for the County and State aforesaid came Larry A. Chambers, Vice President, on behalf of Slawson Investment Corporation, to me personally known to be the same person who executed the foregoing instrument of writing and said person duly acknowledged the execution thereof.

Dated at Wichita, KS this 9th day of April, 1987.

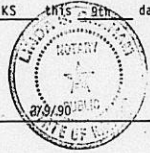

Linda S. Graham
Notary Public Linda S. Graham

My Appointment Expires: 07/31/90

WOODSPRING 3RD
LAT. 21, MAIN 22 W.I.S.
PROJ. NO. 468-76-245-81270-00



SCALE:
1" = 40', Horiz.
1" = 5', Vert.

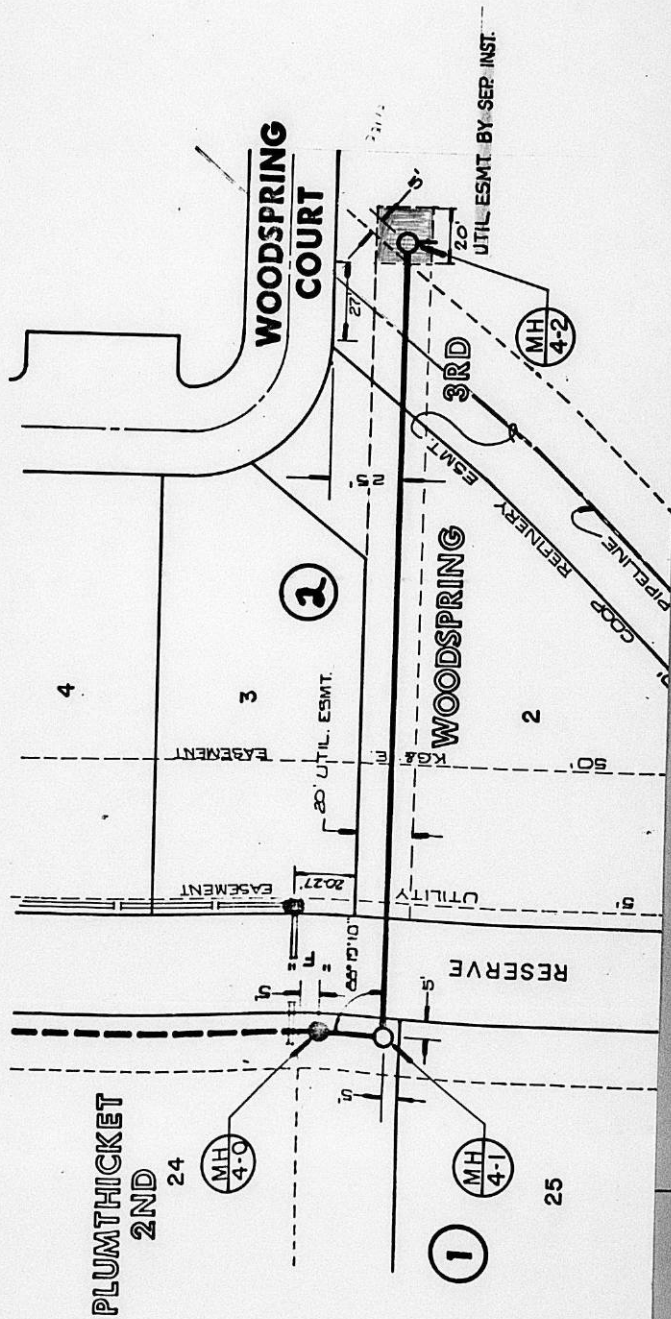

THE CITY OF WICHITA

OFFICE OF Public Works - Engineering

DATE April 16, 1987

TO Forrest Nagley, Senior Planner

FROM Mike Lindebak, City Engineer *ML*

SUBJECT Lateral 21, Main 22, WIS
468 76 245 81270 000 001

Attached are a utility easement and a location sketch received in connection with the subject project.

Please place the attached instrument on the agenda for Subdivision Committee consideration. Upon approval by the City Commission, I would appreciate a copy of the recorded instrument for our file.

RECEIVED

APR 20 1987

METROPOLITAN

ROUTE Nagley

/JLL:ms
Attachments
cc: Carl Gipson, Subdivision Engineer

WOODSPRING 3RD
 LAT. 21, MAIN 22 W.I.
 PROJ. NO. 468-76-245-81270-00



SCALE:
 1" = 40' Horiz.
 1" = 5' Vert.

