

D-1452 - Adams Homes, Inc. grants a utility easement located in an area east of Woodlawn and north of 40th St. North

Posted 5-14-87
K&V

5/21/87

ACTION

	DATE
S/D COMMITTEE	<u>5/21/87</u>
M.A.P.C.	<u>5/28/87</u>
B.C.C./B. CO. C.	<u>6/9/87</u>

approved

approved

accept

DEDICATION REPORT AND PROGRESS

MAP NO. 5952 D
SEC. NO. 30
TWP. NO. 26S
RANGE 2E

CASE NO.: D-1452

ASSOCIATED CASE:

1. OFFER TO DEDICATE: Utility easement.

GENERALLY LOCATED: In an area east of Woodlawn and north of 40th Street North.

LEGALLY DESCRIBED AS:

Beginning at the southerly most southwest corner of Lot 3, Northbrook 2nd Addition, Wichita, Kansas; thence northwesterly along the front line of said Lot 3, (said line being a curve having a radius of 50 feet) 34.08 feet; thence northeasterly along the northwesterly line of said Lot 3, 30 feet; thence southerly to the place of beginning.

DEDICATED BY: Adams Homes, Inc.

PURPOSE OF DEDICATION:

II. SKETCH.

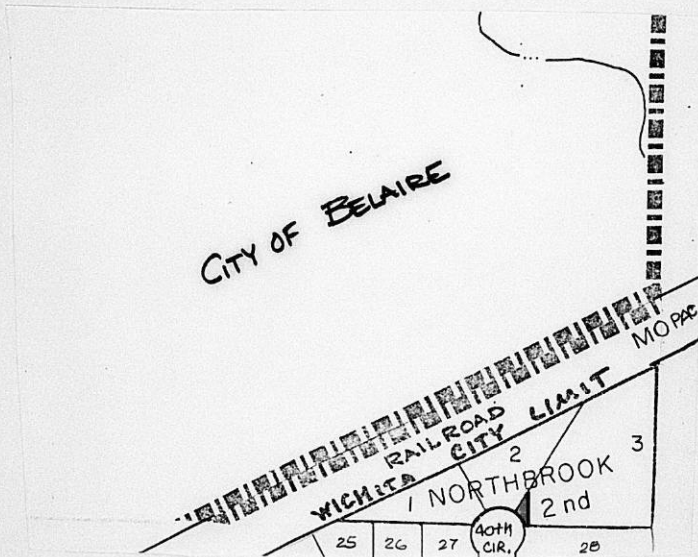

III. FILED 4/13/87
POSTED TO ATLAS
S/D COMM. ACTION 5/21/87 *approved*
M.A.P.C. ACTION 5/22/87 *approved*

B.C.C. ACTION 6-9-87
PLACED ON RECORD
CITY CLERKS NO.

Planning Agenda Item # _____

City of Wichita
City Council Meeting
June 9, 1987

Agenda Report # _____

TO: Mayor and City Council Members

SUBJECT: D-1452 - DEDICATION OF UTILITY EASEMENT, LOCATED IN AN AREA
EAST OF WOODLAWN AND NORTH OF 40TH STREET NORTH.

INITIATED BY: Metropolitan Area Planning Department

AGENDA ACTION: Planning

MAPC Recommendation: Accept the dedication. (unanimous)

Background: Adams Homes, Inc. is granting this utility easement for a sanitary sewer project.

Financial Considerations: Bill the recording costs to:
468-76-245-81336-000-000-001

Recommendations/Actions: Accept the dedication and record document.

PL/6830/5

Lot. B. Map. 9-55-25
400-76-295-81536-300-000

EASEMENT

THIS EASEMENT made this 13th day of April,
1987, by and between Adams Homes, Inc.

of the first part and the City of Wichita, of the second part.

WITNESSETH: That the said first party, in consideration of the sum of One Dollar (\$1.00) and other valuable consideration, the receipt whereof is hereby acknowledged, does hereby grant and convey unto the said second party a perpetual right-of-way and easement for the purpose of constructing, maintaining, and repairing sewer and all other public utilities, over, along and under the following described real estate situated in Sedgwick County, Kansas, to wit:

Beginning at the southerly most S.W. Corner of Lot 3, Northbrook 2nd. Addition, Wichita, Kansas; thence northwesterly along the front line of said Lot 3, (said line being a curve having a radius of 50 feet) 34.08 feet; thence northeasterly along the northwesterly line of said Lot 3, 30 feet; thence southerly to the place of beginning.

And said second party is hereby granted the right to enter upon said premises at any time for the purpose of constructing, operating, maintaining, and repairing such sewer and all other public utilities.

IN WITNESS WHEREOF: The said first party has signed these presents the day and year first written.

Bob Adams President
Bob Adams
Bob Adams

STATE OF KANSAS)
SEDGWICK COUNTY) SS

Be it remembered that on this 13th day of April, 1987, before me, a notary public in and for said County and State, came Bob Adams, President of Adams Homes, Inc. to me personally known to be the same person(s) who executed the foregoing instrument of writing and duly acknowledged the execution of same. In testimony whereof I have hereunto set my hand and affixed my notarial seal the day and year above written.

SEAL

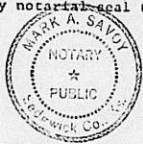

Mark A. Savoy
Notary Public
Mark A. Savoy

My Commission expires: 12 May 1988

THE CITY OF WICHITA

OFFICE OF Public Works - Engineering

DATE April 24, 1987

TO Forrest Nagley, Senior Planner

FROM Mike Lindebak, City Engineer

SUBJECT

Lateral 8, Main 9, S.S. #23
468 76 245 81336 000 000 001

Attached is a utility easement received in connection with the subject project.

Please place the attached instrument on the agenda for Subdivision Committee consideration. Upon approval by the City Commission, I would appreciate a copy of the recorded instrument for our file.

/JLL:ms
Attachment
cc: Carl Gipson, Subdivision Engineer

RECEIVED
APR 28 1987
METROPOLITAN PLANNING
ROUTE _____
