

1259

# ACTION

	DATE
S/D COMMITTEE	<u>6/18/87</u>
M.A.P.C.	<u>6/25/87</u>
B.O.C./B.O.C.	<u>7/7/87</u>

D-1457 - Wilbur F. Kruse, etux grants a utility easement located in an area east of McLean and north of 13th St. North.

Posted 6-5-87  
Kc

6529

ACTION

	DATE
S/D COMMITTEE	6/18/87
M.A.P.C.	6/25/87
S.C.C./B.C.C.	7/7/87

approved  
approved  
Approved

D-1457  
a utility  
east of  
North.

DEDICATION REPORT AND PROGRESS

MAP NO. 5349  
 SEC. NO. 7  
 TWP. NO. 27S  
 RANGE 1E

CASE NO.: D-1457

ASSOCIATED CASE: 4/S-0709

1. OFFER TO DEDICATE: ~~Utility and drainage easement and access control.~~  
 GENERALLY LOCATED: In an area east of McLean and north of 13th Street North.  
 LEGALLY DESCRIBED AS:

UTILITY EASEMENT

Commencing at the southwest corner of Lot 9, Hawkins Addition to Wichita, Sedgwick County, Kansas; thence east along the southerly line of said Lot 9, 5.23 feet to the P.C. of a curve to the right having a radius of 114.31 feet; thence easterly along said curve an arc distance of 58.11 feet for a true place of beginning; thence northerly parallel with the westerly line of said Lot 9, 10 feet; thence westerly at right angles to the last described line, 10 feet; thence southerly at right angles to the last described line, to a point on the south line of said Lot 9, thence easterly along the south line of said Lot 9 to the place of beginning.

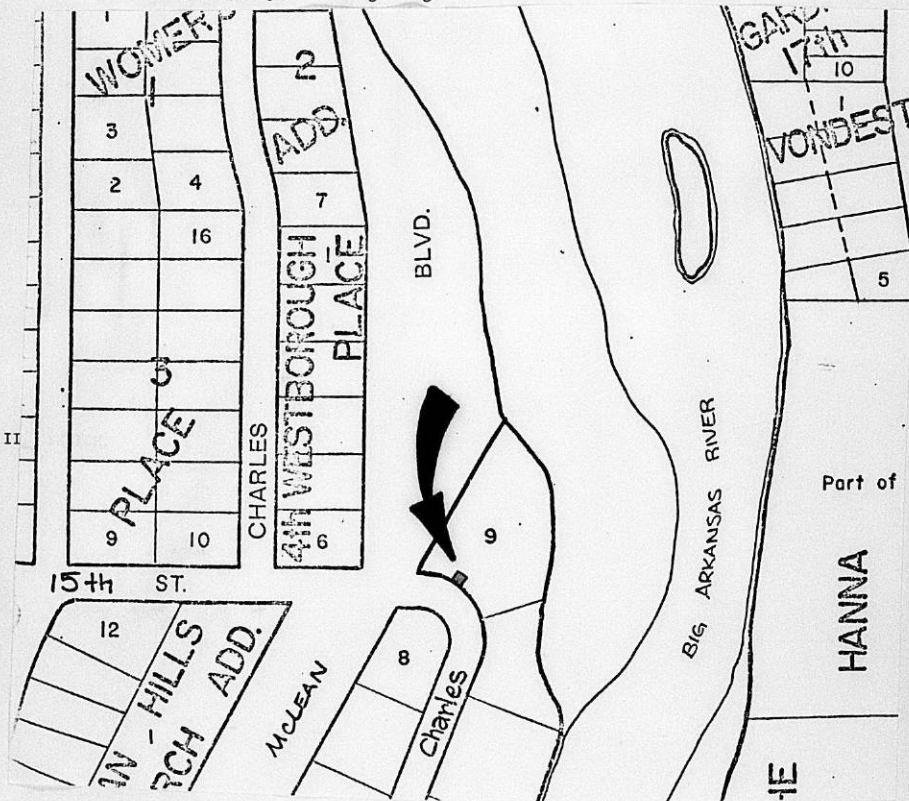

III. FILED 4/29/87  
 POSTED TO ATLAS \_\_\_\_\_  
 S/D COMM. ACTION 6/18/87 *approved*  
 M.A.P.C. ACTION 6/25/87 *approved*

B.C.C. ACTION 7-7-87 *Approved*  
 PLACED ON RECORD \_\_\_\_\_  
 CITY CLERKS NO. \_\_\_\_\_

Planning Agenda Item # \_\_\_\_\_

City of Wichita  
City Council Meeting  
July 7, 1987

Agenda Report # \_\_\_\_\_

TO: Mayor and City Council Members

SUBJECT: D-1457 - DEDICATION OF UTILITY EASEMENT, LOCATED IN AN AN AREA EAST OF MCLEAN BOULEVARD NORTH OF 13TH STREET NORTH.

INITIATED BY: Metropolitan Area Planning Department

AGENDA ACTION: Planning

-----  
MAPC Recommendation: Accept the dedication. (unanimous)

Background: Wilbur Kruse is granting this utility easement to satisfy a condition of lot split approval.

Financial Considerations: Bill the recording costs to:  
755-68-360-50000-295-000-000

Recommendations/Actions: Accept the dedication and record document.

PL/7019/5/LE

EASEMENT

THIS EASEMENT made this \_\_\_\_\_ day of \_\_\_\_\_  
19 \_\_, by and between Wilbur F. Kruse and Mary T. Kruse

of the first part and the City of Wichita, of the second part.

WITNESSETH: That the said first party in consideration of the sum of One Dollar (\$1.00) and other valuable consideration, the receipt whereof is hereby acknowledged, does hereby grant and convey unto the said second party a perpetual right-of-way and easement for the purpose of constructing, maintaining, and repairing sewer and all other public utilities, over, along and under the following described real estate situated in Sedgwick County, Kansas, to wit:

Commencing at the S.W. Corner of Lot 9, Hankins Addition to Wichita, Sedgwick County, Kansas; thence east along the southerly line of said Lot 9, 5.23 feet to the P.C. of a curve to the right having a radius of 114.31 feet; thence easterly along said curve an arc distance of 58.11 feet for a true place of beginning; thence northerly parallel with the westerly line of said Lot 9, 10 feet; thence westerly at right angles to the last described line, 10 feet; thence southerly at right angles to the last described line, to a point on the south line of said Lot 9; thence easterly along the south line of said Lot 9 to the place of beginning.

And said second party is hereby granted the right to enter upon said premises at any time for the purpose of constructing, operating, maintaining, and repairing such sewer and all other public utilities.

IN WITNESS WHEREOF: The said first party has signed these presents the day and year first written.

Wilbur F. Kruse  
Wilbur F. Kruse

Mary T. Kruse  
Mary T. Kruse

STATE OF KANSAS) SS  
SEDGWICK COUNTY)

Be it remembered that on this 29th day of April,  
19 87 before me, a notary public in and for said County and State,  
came Wilbur F. Kruse and Mary T. Kruse

to me personally known to be the same person(s) who executed the foregoing instrument of writing and duly acknowledged the execution of same. In testimony whereof I have hereunto set my hand and affixed my notarial seal the day and year above written.

SEAL

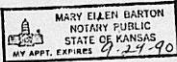

Mary Ellen Barton  
Notary Public

My Commission Expires: September 29, 1990