

D-1459 - Wilbur F. Kruse, etux, grants a drainage easement located in an area east of McLean and north of 13th Street North.

Posted 6-5-87 K.C.

### ACTION

	DATE
S/D COMMITTEE	<u>6/18/87</u>
M.A.P.C.	<u>6/25/87</u>
B.C.C./B.CO.C.	<u>7/7/87</u>

DEDICATION REPORT AND PROGRESS

MAP NO. 5349  
 SEC. NO. 7  
 TWP. NO. 27S  
 RANGE 1E

CASE NO.: D-1459

ASSOCIATED CASE:

1. OFFER TO DEDICATE: Utility easement.

GENERALLY LOCATED: In an area east of McLean and north of 13th Street North.

LEGALLY DESCRIBED AS:

A 20-foot wide easement being 10 feet to the right and left of the following described centerline: Commencing at the southwest corner of Lot 9, Hawkins Addition to Wichita, Sedgwick County, Kansas; thence northerly along the westerly line of said Lot 9, 306 feet for a true place of beginning; thence easterly with a deflection angle to the right of  $72^{\circ} 42' 27''$ , to a point on the east line of said Lot 9.

DEDICATED BY: Wilbur F. Kruse, etux

PURPOSE OF DEDICATION:

II. SKETCH.

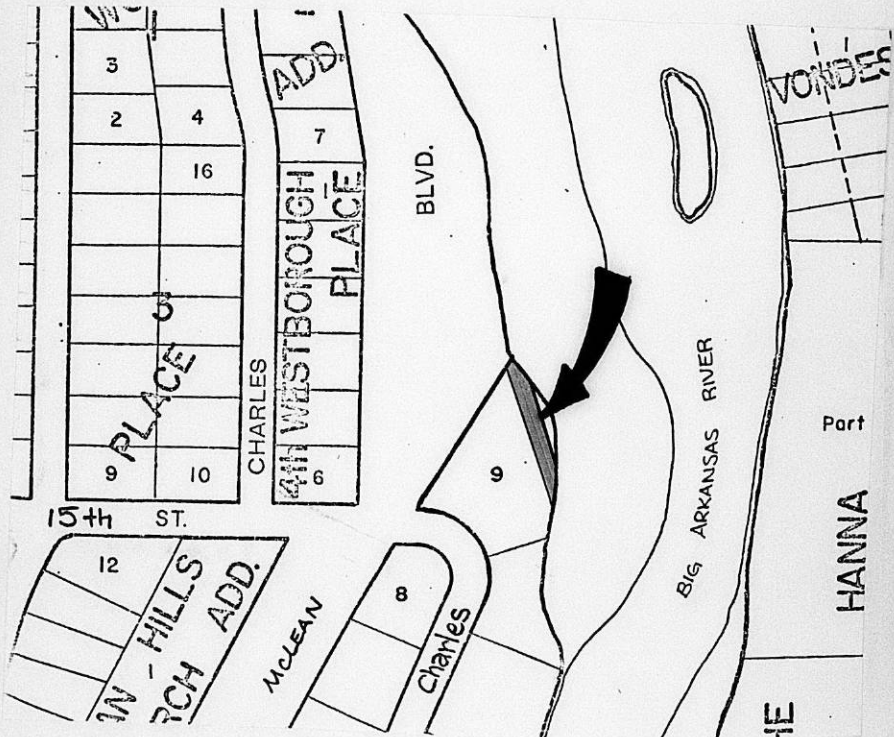

III. FILED 4/29/87  
 POSTED TO ATLAS  
 S/D COMM. ACTION 6/18/87 *approved*  
 M.A.P.C. ACTION 6/25/87 *approved*

B.C.C. ACTION 7-7-87 *Approved*  
 PLACED ON RECORD  
 CITY CLERKS NO.

Planning Agenda Item # \_\_\_\_\_

City of Wichita  
City Council Meeting  
July 7, 1987

Agenda Report # \_\_\_\_\_

TO: Mayor and City Council Members

SUBJECT: D-1459 - DEDICATION OF DRAINAGE EASEMENT, LOCATED IN AN AREA EAST OF MCLEAN BOULEVARD NORTH OF 13TH STREET NORTH.

INITIATED BY: Metropolitan Area Planning Department

AGENDA ACTION: Planning

-----  
MAPC Recommendation: Accept the dedication. (unanimous)

Background: Wilbur Kruse is granting this drainage easement to satisfy a condition of lot split approval.

Financial Considerations: Bill the recording costs to:  
755-68-360-50000-295-000-000

Recommendations/Actions: Accept the dedication and record document.

PL/7020/5/LE

DRAINAGE EASEMENT

THIS EASEMENT made this \_\_\_\_\_ day of \_\_\_\_\_, 19\_\_\_\_,  
by and between Wilbur F. Kruse and Mary T. Kruse of the first part  
and the City of Wichita of the second part.

WITNESSETH: That the said first part \_\_\_\_\_, in consideration of the sum of One Dollar (\$1.00) and other valuable consideration, the receipt whereof is hereby acknowledged, do hereby grant and convey unto the said second party a perpetual right-of-way and easement for the purpose of constructing, maintaining, and repairing a drainage system over, along, and under the following described real estate situated in Sedgwick County, Kansas; to wit:

A 20 foot wide easement being 10 feet to the right and left of the following described center line: Commencing at the S.W. Corner of Lot 9, Hankins Addition to Wichita, Sedgwick County, Kansas; thence northerly along the westerly line of said Lot 9, 306 feet for a true place of beginning; thence easterly with a deflection angle to the right of 72°42'27", to a point on the east line of said Lot 9.

And said second party is hereby granted the right to enter upon said premises at any time for the purpose of constructing, operating, maintaining, and repairing such drainage system.

IN WITNESS WHEREOF: The said first part Wilbur F. Kruse and Mary T. Kruse, signed these presents the day and year first written.

Wilbur F. Kruse  
Wilbur F. Kruse  
Mary T. Kruse  
Mary T. Kruse

STATE OF KANSAS) SS  
SEDGWICK COUNTY)

Personally appeared before me, a notary public in and for the County and State aforesaid, Wilbur F. Kruse and Mary T. Kruse to me personally known to be the same persons who executed the foregoing instrument of writing and said person duly acknowledged the execution thereof.

Dated at Wichita, Kansas, this 29th day of April, 1979.

MARY ELLEN BARTON  
NOTARY PUBLIC  
STATE OF KANSAS  
MY COM. EXPIRES 9-29-90

Mary Ellen Barton  
Notary Public

My Commission Expires September 29, 1990