

SCALE - 1" = 200 FEET
 DATE JAN. 1964

WICHITA-SECGWICK COUNTY METROPOLITAN AREA PLANNING COMMISSION
 PREPARED BY GIBLINGER & SMITH, PLANNING CONSULTANTS AND G. TAYLOR - CIVIL ENGINEER

THE PREPARATION OF THIS MAP WAS FINANCIALLY AIDED THROUGH A FEDERAL GRANT FROM THE URBAN RENEWAL ADMINISTRATION OF THE HOUSING AND HOME FINANCE AGENCY, UNDER THE URBAN PLANNING ASSISTANCE PROGRAM AUTHORIZED BY SECTION 701 OF THE HOUSING ACT OF 1954 AS AMENDED.

DR 70-1
 62 47
 S22 T 27 S R 2 E

FILMED FROM THE BEST AVAILABLE COPY

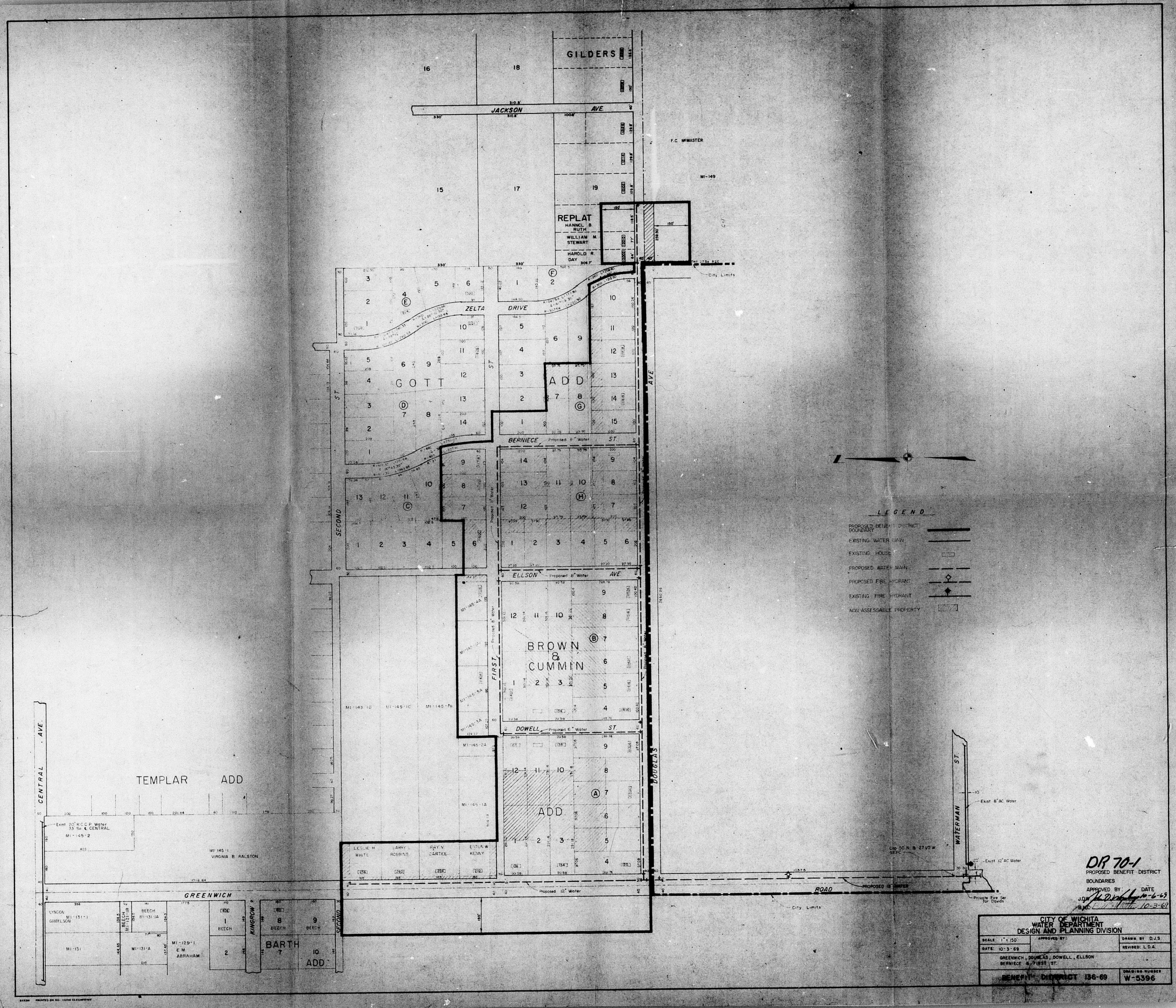

LEGEND

- PROPOSED BENEFIT DISTRICT BOUNDARY
- EXISTING WATER MAIN
- EXISTING HOUSE
- PROPOSED WATER MAIN
- PROPOSED FIRE HYDRANT
- EXISTING FIRE HYDRANT
- NON ASSESSABLE PROPERTY

DR 70-1
 PROPOSED BENEFIT DISTRICT BOUNDARIES
 APPROVED BY: [Signature] DATE: 10-3-69
 DRAWN BY: [Signature] DATE: 10-3-69

CITY OF WICHITA WATER DEPARTMENT DESIGN AND PLANNING DIVISION	
SCALE: 1" = 100'	APPROVED BY: [Signature]
DATE: 10-3-69	DRAWN BY: D.J.S.
GREENWICH, BROWN, DOWELL, ELLSON, BERNIECE & FIRST ST.	
BENEFIT DISTRICT 126-69	DRAWING NUMBER: W-5396