

PLAT NO. S/D 71-27 MAP NO. 5743
J-7-C

NAME SOPJES ADDITION

LOCATION At the northeast corner of K-15 Highway
and MacArthur Road

ENGINEER Baughman Company

OWNER DeBoer Building Systems Corp.

APPLICATION FILED 4-26-71

SKETCH PLAT FILED none submitted

PRELIMINARY FILED 4-26-71

S/D ACTION 5-6-71 Approve

FINAL FILED 10-13-71

S/D ACTION 10-21-71 Approve

MAPC ACTION 10-28-71 Approve

BCC ACTION 4-18-72 Approve

RECORDED 6-16-72

REMARKS _____

S/D 71-27 - SOPJES ADDITION -
At the NE corner of K-15 Highway
and MacArthur Road
Baughman Co.

ACTION

DATE
5-16-71
10-21-71
10-28-71
4-18-72

S/D COMMITTEE (Presm) Approve
" (Fincl) Approve
M.A.P.C. Approve
B.C.C. ~~Approve~~ Approve

Map No. 5743
J-7-C
Sec. No. 11
Twp. No. 28 S
Range 1 E

Subdivision Report and Progress
S/D No.: 71-27

Name: SOPJES ADDITION

General Location: At the northeast corner of K-15 Highway and MacArthur RD.

Owner: DeBoer Building Systems, Corp. Attn: Jimmie E. Grey
Address: 202 South Rock Road 67207 Phone: 685-2381 685-8261
Subdivider: Same & Consolidated American Industries, Inc.
Address: 622 East 3rd Street 67202 Phone: _____
Engineer/Surveyor: Baughman Company
Address: 2522 East Kellogg 67211 Phone: 683-7431

Application Received 4-26-71
Conf. with Applicant none
Sketch Plat Received none submitted
Present Zoning "E"
Proposed Zoning "E"
Letter of Intent none

FINAL PLAT RECEIVED 10-12-71
S/D Comm. Action 10-21-71 Approve

PREL. PLAT RECEIVED 4-26-71
S/D Comm. Action 5-6-71 Approve
Dept. Report on Prel. 5-11-71

Dept. Report on Final 10-22-71
M.A.P.C. ACTION 10-28-71 Approve
Dept. Report on Final 10-29-71
Letter on Irons Received N/A
Title/Taxes Rec'd & Reviewed 10-17-71
Final Review 4-12-72
Referral to B.C.C. 4-12-72

TRACING PROGRESS:
Received 12-20-71
Released 6-7-72
Received _____
Released _____

B.C.C. ACTION 4-14-72 Approve
Recorded 6-16-72

Comments:

NOTE: also send correspondence to C. Robert Bell

SOPJES ADDITION

Loren L. VanPetten, Supt.
Unified School District 260
120 E. Washington, Derby, Ks., 67037

James E. Fleming, Trustee
Riverside Township
6135 S. Hydraulic, 67216

- County Zoning Administrator
- Soil Conservation Service

THE **BOEING** COMPANY
WICHITA DIVISION

J. O. MITCHELL

R. J. Janning

PUBLIC AFFAIRS MANAGER (318) 687-2606 WICHITA, KANSAS 67210

REGISTER OF DEEDS *F*
SEDGWICK COUNTY, KANSAS

SOPJES _____ ADDITION was

filed for record on June 16, 1972

S-2 4-20
80
vh

John Hale

Register Of Deeds

T9-328

RECOMMENDATION FROM METROPOLITAN AREA PLANNING COMMISSION TO
BOARD OF CITY COMMISSIONERS

SUBDIVISION APPROVAL

S/D Number	71-27	Name	SOPJES ADDITION
Application Filed:	4-26-71	Sketch Filed:	None Submitted
Preliminary Plat Filed:	4-26-71	Approved by S/D:	5-6-71
Final Plat Filed:	10-12-71	Approved by S/D:	10-21-71
Approved by Metropolitan Area Planning Commission:			10-28-71

DESCRIPTION

General Location: Northeast corner of K-15 Highway
and MacArthur Road

Surveyor or Engineer: Baughman Company
Owner: DeBoer Building Systems Corp.
Address: 202 South Rock Road

1. Gross Acreage of Plat	29.8	5. Lineal Feet of New Streets:
2. Number of Lots:		a. 50 R/W 778 ft.
Residential		b. R/W ft.
Commercial		c. R/W ft.
Industrial	3	d. R/W ft.
Other		e. R/W ft.
Total Number of Lots:	3	TOTAL 778 ft.
3. Minimum Lot Frontage:	205 ft.	6. Existing Zoning: "E"
4. Minimum Lot Area	220,397 sq.ft.	

A valid petition has been submitted guaranteeing the paving of the service road to the west and the paving of Turnpike Drive to the north of subject property. A certificate has also been submitted certifying the petition.

Planning Commission Recommendation:

TAYLOR moved and KAMEN seconded that the Planning Commission recommend to the City Commission that this plat be approved, subject to recording of the plat within 30 days after approval by the Board of City Commissioners.

Vote of Planning Commission: Unanimous.

ACTION: Approve the petition and instruct the Director of Law to prepare the necessary resolution, instruct the City Clerk to file the certificate with the Register of deeds, the publication and filing costs of which shall be billed to the applicant, and approve the plat as approved by the Metropolitan Area Planning Commission and authorize the Mayor to sign.

CERTIFICATE

City of Wichita)
Sedgwick County) ss
State of Kansas)

We X, DeBoer Building Systems Corporation, owner and plat-
tor of SOPJES Addition, do hereby
certify that petitions for the following improvements have been
submitted to the Board of Commissioners of the City of Wichita,
Kansas:

1. Paving Petition
That there be constructed pavement on Frontage Road along east
side of K-15 from the north line of MacArthur road to the north
2. line of Turnpike Drive and on Turnpike Drive from the east line
of K-15 Highway to the east line of Block A, Sopjes Addition.
- 3.
- 4.
- 5.
- 6.
- 7.

As a result of the above-mentioned petitions for im-
provements, lots within SOPJES Addition
may be subject to special assessments assessed thereto for the
cost of constructing the above-described improvements.

Signed this 14th day of March, 19 72.

DeBOER BUILDING SYSTEMS CORPORATION

Frederick J. Sopjes, President

City of Wichita)
Sedgwick County) ss
State of Kansas)

Be it remembered that on this 14th day of March,
19 72, before me, a notary public in and for said County and State,
came Frederick J. Sopjes, Pres. of DeBoer Building Systems Corporation, to me personally
known to be the same person who executed the fore-going instrument
of writing and duly acknowledged the execution of same, for and on
behalf of said corporation.

In Testimony Whereof, I have hereunto set my hand and
affixed my notarial seal the day and year above written.

Edgar R. Maske
Notary Public

My Commission Expires:

December 31, 1975

T9-128

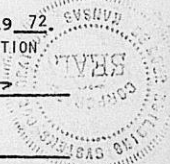

City of Wichita)
Sedgwick County) ss
State of Kansas)

We X, Consolidated American Industries, Inc., owner and plat-
tor of SOPJES Addition, do hereby
certify that petitions for the following improvements have been
submitted to the Board of Commissioners of the City of Wichita,
Kansas:

1. Paving Petition
That there be constructed pavement on Frontage Road along east
side of K-15 from the north line of MacArthur road to the north
line of Turnpike Drive and on Turnpike Drive from the east line
of K-15 Highway to the east line of Block A, Sopjes Addition.
- 2.
- 3.
- 4.
- 5.
- 6.
- 7.

As a result of the above-mentioned petitions for im-
provements, lots within SOPJES Addition
may be subject to special assessments assessed thereto for the
cost of constructing the above-described improvements.

Signed this 24th day of March, 19 72.
CONSOLIDATED AMERICAN INDUSTRIES, INC.

George J. Ablah
George J. Ablah - President

* Reginald V. Bortch, Not. Pub.

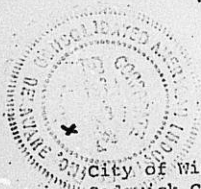

City of Wichita)
Sedgwick County) ss
State of Kansas)

Be it remembered that on this 24th day of March,
19 72, before me, a notary public in and for said County and State,
came George J. Ablah - Pres. of Consolidated American Industries, Inc.
known to be the same person who executed the fore-going instrument
of writing and duly acknowledged the execution of same, for and on
behalf of said corporation.

In Testimony Whereof, I have hereunto set my hand and
affixed my notarial seal the day and year above written.

Reginald V. Bortch
Notary Public

My Commission Expires:
Sept. 22, 1973



THE LAW COMPANY

(316) 265 8584 - 313 S. MARKET P.O. BOX 1139 WICHITA, KANSAS 67201

February 17, 1972

City Engineer
City Annex Building
104 South Main
Wichita, Kansas 67202

Attention: Mr. Dick Lynn

Re: Manufacturing Facilities
for DeBoer Building Systems Corp.
Wichita, Kansas

Gentlemen:

Enclosed is a copy of a letter dated February 10, 1972, from the Army Corps of Engineers granting right-of-way for installation of a rail spur, sewer line, and gas line.

It is my understanding that this will now allow the new sewer line to be tied into the existing. Please advise.

Very truly yours,

THE LAW COMPANY

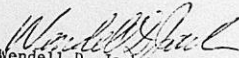
Wendell D. Jack
Project Coordinator
Construction Division

WDJ/cb

Enclosure

cc: Mr. Bob Friesen
Mr. Morris Perkins



DEPARTMENT OF THE ARMY
 KANSAS CITY DISTRICT, CORPS OF ENGINEERS
 700 FEDERAL BUILDING
 KANSAS CITY, MISSOURI 64106

IN REPLY REFER TO
 MRKRE-MI (AF Plt 13)

TLC/DD		REC'D FEB 15 1972	
BY	DATE	BY	DATE
MLF	1/13/72	MLF	1/13/72
LLT	1/14/72	LLT	1/14/72
LAR	1/15/72	LAR	1/15/72
REP	1/16/72	REP	1/16/72
IC	10 February 1972	IC	10 February 1972
JCD		JCD	
P.G.	✓	REP	✓
COPY TO: LAB			

RECEIVED FEB 14 1972

DeBoer Building Systems Corporation
 240 North Rock Road
 P. O. Box 18387
 Wichita, Kansas 67214

Gentlemen:

Reference is made to letter of your Corporation dated 17 January 1972, indicating acceptance of the terms and conditions of License No. DACA41-3-72-513 and of Consent to Cross No. DACA41-3-72-606, copies inclosed, both instruments pertaining to construction and installation of a rail spur, and of sewer and gas lines on and across property under the jurisdiction of Air Force Plant 13.

Immediate right-of-entry is hereby granted to proceed with the work involved, subject to all the terms and conditions contained in the instruments referenced above. This right-of-entry is granted, pending execution of these instruments in the Office, Secretary of the Air Force.

If this right-of-entry is acceptable, please sign one copy in the space provided, and return it to this office, together with a check in the amount of \$1,300, made payable to the Treasurer of the United States.

Upon receipt of the instruments executed in behalf of the Government, copies will be furnished for your file.

Sincerely yours,

Gilbert P. Mullen

GILBERT P. MULLEN
 Chief, Real Estate Division

2 Incl
 As stated

Right-of-entry accepted, subject to terms and conditions of License No. DACA41-3-72-513 and of Consent to Cross No. DACA41-3-72-606.

DE BOER BUILDING SYSTEMS CORPORATION

Fredrick J. Jozis

February 14, 1972

DATE

1971 REAL ESTATE TAX

SEDGWICK COUNTY
WICHITA KANSAS 67203

COUNTY TREASURER

PLEASE INDICATE ANY CHANGE OF ADDRESS

PROPERTY IDENTIFICATION	VALUATION	GENERAL TAX	H.A.L.F.		TOTAL TAX
			FIRST	SECOND	
RI-192-3 CONSOLIDATED AMER. INDUST INC 622 E 3RD WICHITA KS 67202 U-260-6 E 1/2 SW 1/4 SEC 11 LY 6 OF RR SPUR TO BOEING EXC E 525 FT IMPROV 11-28-1E	2420	174.16	87.08	87.08	174.16
MAKE CHECKS PAYABLE TO RONALD G. MILLER, COUNTY TREASURER					
INTEREST PAID RECEIPT NO.					

RONALD G. MILLER

COUNTY TREASURER SEDGWICK COUNTY

WICHITA, KANSAS 67203

MAKE CHECKS PAYABLE TO
RONALD G. MILLER,
COUNTY TREASURER

↑
SEE INSTRUCTIONS ON
REVERSE SIDE OF THIS CHECK

PLEASE CONTACT
COUNTY ASSESSOR ON
QUESTIONS ABOUT
ASSESSED VALUATION

IF THIS STATEMENT IS \$10.00 OR LESS
IT MUST BE PAID IN FULL

Taxes paid by DeBor Building Systems Corp check 71-2274



on 12-21-71
up-dated tax
opinion



1971 REAL ESTATE TAX

SEDDON, KANSAS COUNTY
 WICHITA, KANSAS 67203

Ronald G. Miller COUNTY TREASURER
Mario Warden COUNTY CLERK

PLEASE INDICATE ANY CHANGE OF ADDRESS

VALUATION	GENERAL TAX	SPECIAL TAX	HALF SECOND	TOTAL TAX
RI-192-3A DE BOER BUILDING SYSTEMS CORP. 2850	205.11		10256	205.11
U-260-6 E 525 FT E 1/2 SW 1/4 LY 5 RR 384 R 2 BOEING SEC 11-28-1E	205.11	1.72	206.83	343.110

IMPORTANT: THIS STATEMENT IS \$10.00 OR LESS IT MUST BE PAID IN FULL

MAKE CHECKS PAYABLE TO: RONALD G. MILLER, COUNTY TREASURER

INTEREST: 1.72

PAID: 206.83

RECEIPT NO. 206

2



October 29, 1971

Baughman Company
2522 East Kellogg
Wichita, Kansas 67211

Re: S/D 71-27 - Final Plat of
SOPJES ADDITION

Gentlemen:

At the regular meeting of the Metropolitan Area Planning Commission on October 28, 1971, the above-captioned plat was considered. The action of the Planning Commission was to recommend that the plat be approved as recommended by the Subdivision Committee, subject to the conditions stated in our letter of October 22, 1971.

In addition to complying with those conditions, it is necessary that you meet the following requirements before this plat can be forwarded to the Board of City Commissioners for consideration:

1. Compliance with the requirements of the Metropolitan Area Planning Commission.
2. Submission of the fully completed and signed tracing of the subdivision to the Metropolitan Area Planning Department.

If you have any questions concerning this matter, please call our office.

Sincerely,

Jack H. Galbraith
Chief Planner

JHG:ber

cc: Jimmie E. Grey, DeBoer Bldg. Systems, Corp., 202 S. Rock Road
Consolidated American Industries, Inc., 622 East 3rd 67202

October 22, 1971

Baughman Company
2522 East Kellogg
Wichita, Kansas 67211

Subject: S/D 71-27 - Final Plat
of SOPJES ADDITION

Gentlemen:

At the regular meeting of the Subdivision Committee of the Metropolitan Area Planning Commission, October 21, 1971, the above captioned plat was considered. The action of the Committee was to recommend that this plat be approved, subject to:

~~ok~~ Since this plat does not lie within the corporate limits of the City of Wichita, the title shall be changed to reflect that said plat is an addition to Sedgwick County.

~~ok~~ The limits of the dimension indicated along the north line of the plat shall be further defined by the use of arrows as it is not an overall dimension.

~~ok~~ The applicant's title and tax opinion for subject property reflects one additional mortgage involved, and the appropriate texts for consent and notary thereof shall be added to the final plat.

~~P~~ 4. In accordance with review of State Highway plans for K-15 Highway, the westerly line of subject property is 223 feet east of the center line of K-15, and this plat drawing needs to be checked by the applicant's surveyor accordingly.

~~P~~ 5. Indicating 75 feet of half street right-of-way for MacArthur Road, and the service road on the east side of K-15, back a distance of 350 feet from the intersecting center lines of each street. The Engineering Division of the Department of Public Works shall be contacted regarding the exact geometrics for

→ amended to satisfaction
of the Engineering Division
of the Dept. of Public Works (D)

Page 2
October 22, 1971

same, as well as in regard to the geometrics of a radial right-of-way line that is to be provided at the northwest corner of Lot 3 (intersection of K-15 service road and Turnpike Drive).

OK The applicant shall furnish to the Planning Department, a copy of an agreement or letter of confirmation which grants permission from the Department of Defense to the applicant, to allow the connection to the private sanitary sewer line which serves the Boeing Company to the east.

OK The applicant shall install or guarantee the installation for paving of the service road to the west, and Turnpike Drive to the north of subject property. The Engineering Division of the Department of Public Works shall be contacted regarding this matter. *need petition returned*

8. Recording of the plat within 30 days after approval by the Board of City Commissioners.

It was pointed out at the meeting by a representative of the Soil Conservation Service, that the applicant should be cautious of the soil conditions in that area. It was felt that severe erosion could definitely occur if too much of the soil was exposed at any one time during construction and development of the property.

Enclosed with the applicant's copy of this letter is a list of the five methods which have been adopted as being acceptable for guaranteeing improvements required in the approval of plats. Forms for the bond and irrevocable letter of credit are available from this office.

The enclosed "marked" copy of the final plat is for your information and files.

This matter will be forwarded to the Planning Commission for its consideration on Thursday, October 28, 1971, at 1:30 p.m. If you should have any questions concerning this matter, please call.

Very truly yours,

John D. Gist
Principal Planner

Page 3
October 22, 1971

JDG:rme

Enclosure

cc: Deboer Building Systems, Corp.
Attn: Jimmie E. Grey
202 South Rock Road, 67207

Consolidated American Industries, Inc.
622 East 3rd Street
Wichita, Kansas 67202

CITY OF WICHITA, KANSAS

APPLICATION AND PERMIT
FOR SEWERAGE SERVICE FOR PROPERTY
LOCATED OUTSIDE THE CORPORATE LIMITS OF THE CITY OF WICHITA

Application is hereby made to the City of Wichita for sewerage service to serve the following described property:

The east 525 feet of all that of the east one-half (E 1/2) of the southwest quarter (SW 1/4) of Section 11, Township 28 South, Range 1E of the 6th P.M. and lying south of Railroad R.O.W. and lying east of east R.O.W. line of K-15 Highway in Sedgwick County, Kansas.

Owner: DeBoer Building Systems Corp.

The primary use of the above-described property is of the type or types indicated below:

- Residential property (buildings used as dwellings only)
Number of families living in above residential property ()
- Commercial property (non-residential buildings used for other than the manufacturing of salable products)
- Industrial property (buildings used for the manufacture and processing of salable products)
- Other property (explain): _____

The undersigned covenants and agrees as follows:

1. To connect to the sewer system of the City at a point or points designated by the City in accordance with plans and specifications approved by the City Engineer and the current sewer ordinances of the City and subject to inspection by the City Engineer.
2. To discharge into the City sanitary sewer system only ordinary sanitary wastes and not to discharge any chemicals, radio-active materials, corrosive or abrasive matter, mineral oil or any of its derivatives, by-products or wastes from the manufacture of salable products, air-conditioning water, water from roofs and downspouts, or any other or different type of sewage than that being discharged at the time of this application without the written consent of the City.
3. It is further stipulated and agreed that all sewer lines on said land and all connections to the sanitary sewer system of the City shall be maintained in good repair throughout the life of this permit and that the City will not be responsible for maintaining said private sewer facilities serving the above-described property - but should the services of the City be desired and the City consents to perform such services, it is agreed that the applicant will pay for all materials and the City shall be paid at a rate of Fifteen Dollars (\$15.00) per hour for the time spent performing such services.
4. The undersigned hereby releases, indemnifies, and agrees to hold harmless the said City and any and all its agents and employees from any claim for damages to persons or property of every kind of character arising or claimed to arise by reason of this application and permit.
5. The undersigned agrees not to transfer title to the above premises or any portion thereof without notifying the Clerk of the City of Wichita, and notifying the purchaser of the existence of this application and permit, but failures of purchasers of above-described property or any portion thereof to have actual notice of this application and permit shall not entitle such purchasers to any greater rights than the undersigned shall have hereunder.

CITY OF WICHITA, KANSAS

APPLICATION AND PERMIT
FOR SEWERAGE SERVICE FOR PROPERTY
LOCATED OUTSIDE THE CORPORATE LIMITS OF THE CITY OF WICHITA

Application is hereby made to the City of Wichita for sewerage service to serve the following described property:

The east 525 feet of all that of the east one-half (E 1/2) of the southwest quarter (SW 1/4) of Section 11, Township 28 South, Range 1E of the 6th P.M. and lying south of Railroad R.O.W. and lying east of east R.O.W. line of K-15 Highway in Sedgwick County, Kansas.

Owner: DeBoer Building Systems Corp.

The primary use of the above-described property is of the type or types indicated below:

- Residential property (buildings used as dwellings only)
Number of families living in above residential property ()
- Commercial property (non-residential buildings used for other than the manufacturing of salable products)
- Industrial property (buildings used for the manufacture and processing of salable products)
- Other property (explain): _____

The undersigned covenants and agrees as follows:

1. To connect to the sewer system of the City at a point or points designated by the City in accordance with plans and specifications approved by the City Engineer and the current sewer ordinances of the City and subject to inspection by the City Engineer.
2. To discharge into the City sanitary sewer system only ordinary sanitary wastes and not to discharge any chemicals, radio-active materials, corrosive or abrasive matter, mineral oil or any of its derivatives, by-products or wastes from the manufacture of salable products, air-conditioning water, water from roofs and downspouts, or any other or different type of sewage than that being discharged at the time of this application without the written consent of the City.
3. It is further stipulated and agreed that all sewer lines on said land and all connections to the sanitary sewer system of the City shall be maintained in good repair throughout the life of this permit and that the City will not be responsible for maintaining said private sewer facilities serving the above-described property - but should the services of the City be desired and the City consents to perform such services, it is agreed that the applicant will pay for all materials and the City shall be paid at a rate of Fifteen Dollars (\$15.00) per hour for the time spent performing such services.
4. The undersigned hereby releases, indemnifies, and agrees to hold harmless the said City and any and all its agents and employees from any claim for damages to persons or property of every kind of character arising or claimed to arise by reason of this application and permit.
5. The undersigned agrees not to transfer title to the above premises or any portion thereof without notifying the Clerk of the City of Wichita, and notifying the purchaser of the existence of this application and permit, but failures of purchasers of above-described property or any portion thereof to have actual notice of this application and permit shall not entitle such purchasers to any greater rights than the undersigned shall have hereunder.

6. The undersigned agrees that upon failure to comply with the terms of this permit, sewerage service may be denied to the property above described and said property may be disconnected without notice all in accordance with the ordinances and regulations of the City.

7. The undersigned agrees to annexation of the above-described property by the City of Wichita if and when said property is legally annexable.

Executed at Wichita, Kansas, this 18th day of October, 1971.

THE UNDERSIGNED: (Fill in lines applicable)

(If an individual, application must be signed by husband and wife, if there be such.)

(Co-partners - must be signed by at least one partner.)

Frederick J. Sopjes, President (Corporation - must be signed by an executive officer.)
DeBoer Building Systems Corp.
Frederick J. Sopjes

APPROVED BY Robert A. Sakur Director of Planning
RWB Muggenyan Director of Public Works
Robert H. Hess Director of Water and Water Pollution Control

In consideration of the above and foregoing application, and pursuant to the terms of such application and by virtue of the authority granted by ordinances of the City of Wichita, Kansas, the applicant is hereby granted a revocable permit to discharge sewage into the sanitary sewer system of the City of Wichita for a period not to exceed five (5) years commencing _____, 19____, and the fee shall be as set forth in Sections 6 and 7 of Ordinance No. 26-571.

EXECUTED at Wichita, Kansas, this _____ day of _____, 19____, by authority of the Board of Commissioners of the City of Wichita.

CITY OF WICHITA, KANSAS

By: _____
City Manager

DEPARTMENT OF THE AIR FORCE
LICENSE
AIR FORCE PLANT 13, WICHITA, KANSAS

NO. DACA41-3-72-513

THE SECRETARY OF THE AIR FORCE, under the authority vested in him by Title 10, United States Code, Sections 2663 and 2669, hereby grants to DeBOER BUILDING SYSTEMS CORPORATION, organized under the laws of the State of Kansas, with principal place of business at 240 North Rock Road, P. O. Box 18387, Wichita, Kansas, a license for a period of 20 years commencing on 1 August 1971 and ending 31 July 1991, but revocable at the will of the Secretary of the Air Force, for: (1) The use of certain Government-owned fee and easement lands as a right-of-way for a rail spur, and the right to connect to the Government-owned rail line; (2) the use in common of the Government-owned rail line; (3) the connection of an 8" sewerline to the existing Government-owned sewerline; and (4) the use in common of the Government-owned sewerline; located substantially as shown on Exhibit "A", and more particularly described on Exhibit "B", attached hereto and made parts hereof.

THIS LICENSE is granted subject to the following conditions:

1. That the licensee shall pay to the United States compensation in the amount of: ONE THOUSAND THREE HUNDRED and NO/100 Dollars (\$1,300.00) per annum, payable in advance. Payments shall be forwarded directly to the Finance and Accounting Office, Omaha District, Corps of Engineers, ATTN: MRODC-F, 7410 USPO and Courthouse, 215 N. 17th Street, Omaha, Nebraska 68102.
2. That the exercise of the privileges hereby granted shall be without cost or expense to the United States, under the general supervision and subject to the approval of the officer having immediate jurisdiction over the property, hereinafter referred to as "said officer", and subject also to such regulations as may be prescribed by him from time to time, to properly protect the interest of the Government.
3. That any property of the United States damaged or destroyed by the licensee incident to the exercise of the privileges herein granted shall be promptly repaired or replaced by the licensee to the satisfaction of the said officer, or in lieu of such repair or replacement the licensee shall, if so required by the said officer, pay to the United States money in an amount sufficient to compensate for the loss sustained by the United States by reason of damage to or destruction of Government property.

4. That the United States shall not be responsible for damages to property or injuries to persons which may arise from or be incident to the exercise of the privileges herein granted, or for damages to the property of the licensee, or for injuries to the person of the licensee, or for damages to the property or injuries to the person of the licensee's officers, agents, servants, or employees or others who may be on said premises at their invitation or the invitation of any one of them, arising from governmental activities on the said premises, and the licensee shall hold the United States harmless from any and all such claims.

5. The United States shall in no case be liable for any damages or injuries to the said railroad spur or sewer connection which may be caused by or result from any operations undertaken by the Government, and no claim or right to compensation shall accrue from such damages or injuries.

6. That, on or before the date of expiration of this license or its relinquishment by the licensee, the licensee shall vacate the said Government premises, remove all property of the licensee therefrom, and restore the premises to a condition satisfactory to the said officer, damages beyond the control of the licensee and due to fair wear and tear excepted. If, however, this license is revoked, the licensee shall vacate the premises, remove said property therefrom, and restore the premises as aforesaid within such time as the Secretary of the Air Force may designate. In either event, if the licensee shall fail or neglect to remove said property and so restore the premises, then, at the option of the Secretary of the Air Force, said property shall either become the property of the United States without compensation therefor, or the Secretary of the Air Force may cause the property to be removed and the premises to be so restored at the expense of the licensee, and no claim for damages against the United States or its officer or agent shall be created by or made on account of such removal and restoration work.

7. That the licensee shall pay the cost, as determined by the said officer, of producing and/or supplying any utilities and other services furnished by the Government or through Government-owned facilities for the use of the licensee, including the licensee's proportionate share of the cost of operation and maintenance of the Government-owned facilities by which such utilities or services are produced or supplied. The Government shall be under no obligation to furnish utilities or services. Payment shall be made in the manner prescribed by the said officer upon bills rendered monthly.

8. That the United States shall not be responsible for damages to property or injuries to persons which may arise from or be incident to the construction, maintenance, and use of the facilities constructed by the licensee on the said premises.

9. That this license may be terminated by the licensee at any time by giving to the Secretary of the Air Force, through the said officer, at least ten (10) days' notice in writing; provided that, in case of such termination, no refund by the United States of any compensation theretofore paid shall be made, and provided further, that in the event of said notice is not given at least ten (10) days prior to date compensation is due the United States hereunder, the licensee shall be required to pay the compensation for the period or term shown in Condition No. 1 hereof.

10. The rights and privileges contained herein involves the use of existing facilities, construction, maintenance, and repair work on lands wherein the Government retains an easement estate; and it is understood that this license is effective only insofar as the rights of the United States in the property involved are concerned, and that the licensee shall obtain such permission as may be necessary on account of any other existing rights.

11. That the licensee shall comply with all applicable laws, ordinances, and regulations of the States, county, and municipality with regard to construction, sanitation, licenses or permits to do business, and all other matters.

12. That the licensee's use of that portion of the Government-owned rail line described as Parcel C on Exhibit "B", shall be in common, and on a noninterference basis, with the needs of Air Force Plant 13, the Boeing Company, McConnell Air Force Base, and their licensees, permittees, and contractors.

13. That the Government assumes no obligation to continue to operate the Government-owned rail line or sewer line, or appurtenances thereto, in the event Air Force Plant 13 or McConnell Air Force Base should be closed.

14. That the Government-owned rail line is being maintained under contract between the Santa Fe Railroad Company, and the Boeing Company. The licensee agrees to pay a proportionate share of the costs of maintenance and repairs of the Government-owned line used by the licensee in common with others. To this end, the licensee will enter into a maintenance and repair agreement with the Boeing Company. The proportionate share will be based upon that proportion which the number of cars or other vehicles of the licensee utilizing the Government-owned track bears to the total number of cars or vehicles utilizing the Government-owned track during each month. Payment shall be made in the manner prescribed by and as billed by the Boeing Company. The licensee shall be solely responsible for the costs of maintaining and repairing that portion of the spur track connection located on described Parcels A and B.

15. That the spur track to be constructed under this license shall be used solely for the purpose of serving the DeBoer plant to be constructed adjacent to the spur track. No other person, company, corporation or business other than DeBoer Building Systems Corporation and its related corporations and its parent corporation, Jack P. DeBoer Associates, Inc., shall be permitted

to use the said spur, nor shall any additional spur or trackage be connected thereto.

16. The initial hook-up of connection to the Government-owned sewerline shall conform to Code Standards of the Industry, and thereafter shall be inspected at reasonable intervals and any defects found shall be promptly repaired. Upon completion of repairs, the premises shall be restored, at the licensee's expense, to the same condition as that existing prior to commencement of such repair work.

17. The licensee's use of the Government-owned sewerline described as Parcel D on Exhibit "B", shall be in common with Air Force Plant 13 and the Boeing Company, and their licensees, permittees, and contractors.

18. The licensee shall pay a proportionate share of the costs for maintenance and repair of the Government-owned sewerline as determined by the Air Force officer-in-charge at the Boeing Plant.

19. That the licensee shall not introduce any industrial waste into the sewerline.

20. That the exercise of the privileges herein granted shall be performed in a nondiscriminatory manner to the end that no person shall, on the ground of race, color, religion, sex, or national origin, be excluded from using the facilities or obtaining the services provided thereon or otherwise be subjected to discrimination under any program or activities provided thereon.

This License is not subject to Title 10, United States Code, Section 2562.

IN WITNESS WHEREOF, I have hereunto set my hand by authority of the Secretary of the Air Force this _____ day of _____, 1971.

This above instrument, together with all the conditions thereof, is hereby accepted this 7th day of September, 1971.

DeBOER BUILDING SYSTEMS CORPORATION

By: Stanley J. Lippis *resident*

CERTIFICATE OF AUTHORITY

I, Jimmie E. Grey, hereby certify that I
am the Secretary of Decker Rollins Systems
Corporation, the corporation described in and which executed the
foregoing agreement with the United States of America; that said corporation
is organized under the laws of the State of Kansas; that the
corporate seal affixed to said instrument is the seal of said corporation;
that Frederick J. Soples, who executed said agreement as
President of said corporation was then President
of said corporation and has been duly authorized to
execute said instrument on behalf of said corporation; that I know the
signature of said Frederick J. Soples; and that the
signature affixed to subject instrument is genuine.

IN WITNESS WHEREOF, I have hereunto set my hand and affixed the
corporate seal of said corporation, this 7th day of September
19 71.

SEAL

Jimmie E. Grey
Secretary

Frederick J. Soples
President

Sec 11, T-28-S, R-1-E

POINT OF CONNECTION

137.62'

970'

59° 20'

SEE INSET

129.12'

122'

R=603.91'
L=75.38'

VT OWNED TRACK
40'
60'

GOV'T PROPERTY LINE

R=284.48'
L=260.24'

DE BOER SPUR TRACK

124'

Track Easement

INSET

POINT OF SEWERY CONNECTION

13 E

1

17 P

- == Rail Spur
- ◆ Sewer Line Connection
- Rail Line - Use In Common
- Sewer Line - Use In Common

AIR FORCE PLANT 13
 License DACA41-3-72-513
 Jack P. DeBoer Associates, Inc.
 Sedgwick County
 Wichita, Kansas

EXHIBIT "A"

11/72

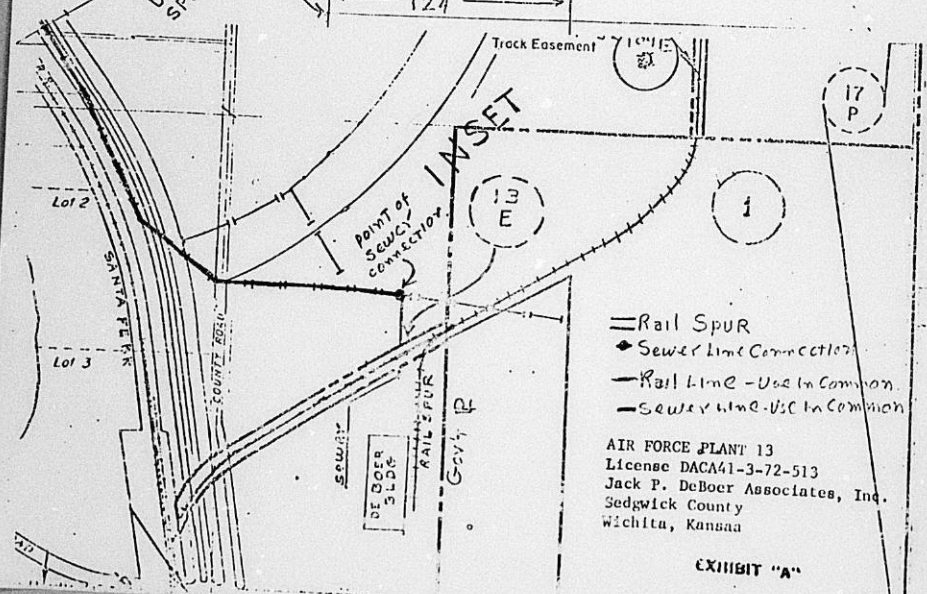

FINAL PLAT
SUBDIVISION REPORT

SUBDIVISION COMMITTEE
METROPOLITAN AREA
PLANNING COMMISSION

S/D NO. 71-27 Name SOPJES ADDITION
Date Application Rec'd. 4-26-71 Preliminary Approval 5-6-71
Scheduled S/D Meeting 10-21-71

DESCRIPTION

General Location At the northeast corner of K-15 Highway and MacArthur Road.

Owner DeBoer Building Systems, Corp., Attn: Jimmie E. Grey
Surveyor/Engineer Baughman Company
Address 2522 East Kelloqq 67211 Phone 683-7431

- | | |
|--|---------------------------------|
| 1. Gross Acreage of Plat <u>29.8</u> | 7. Lineal Feet of New Streets: |
| 2. Number of Lots: | a. <u>50</u> R/W <u>778</u> ft. |
| Residential _____ | b. _____ R/W _____ ft. |
| Commercial _____ | c. _____ R/W _____ ft. |
| Industrial <u>3</u> | d. _____ R/W _____ ft. |
| Other _____ | e. _____ R/W _____ ft. |
| Total Number of Lots <u>3</u> | TOTAL <u>778</u> ft. |
| 3. Minimum Lot Frontage <u>205</u> ft. | 8. Sidewalk adjacent to all |
| 4. Minimum Lot Area <u>220,397</u> sq. ft. | streets? <u>yes</u> <u>X</u> no |
| 5. Existing Zoning <u>"E"</u> | |
| 6. Proposed Zoning <u>"E"</u> | |
| 9. Public Water Supply _____ (Yes-No), Name _____ | |
| 10. Public Sanitary Sewers <u>yes</u> (Yes-No), Name <u>Boeing</u> | |
| 11. Health Department Approval (where applicable) _____ (Yes-No) | |
| 12. City of Wichita _____ : Three-Mile Area <u>X</u> | |

STAFF COMMENTS:

1. Since this plat does not lie within the corporate limits of the City of Wichita, the title shall be changed to reflect that said plat is an addition to Sedgwick County.
2. The limits of the dimension indicated along the north line of the plat shall be further defined by the use of arrows as it is not an overall dimension.
3. The applicant's title and tax opinion for subject property reflects one additional mortgage involved, and the appropriate texts for consent and notary thereof shall be added to the final plat.
4. The final plat reflects a different amount of right-of-way for MacArthur Road than presented on the preliminary plat drawing. If this plat affectuates the dedication of a portion of said right-of-way, then such shall be graphically reflected on the face of the plat and with the appropriate wording in the plat's text.
5. Prior to the development of subject property, the applicant and/or developer should contact the Southwestern Bell Telephone Company relative to the granting easement(s) which will appear to be necessary to serve subject and adjacent properties.
6. The applicant shall furnish to the Planning Department, a copy of an agreement or letter of confirmation which grants permission from the Department of Defense to the applicant, to allow the connection to the private sanitary sewer line which serves the Boeing Company to the east.
7. The applicant has completed arrangements and has entered into a contract with the Wichita Water Department for the extension of a 12-inch water main to serve subject property.

8. The applicant shall install or guarantee the installation of all utilities and facilities which are applicable and described in Article 8 of the MAPC Subdivision Regulations.
9. Recording of the plat within 30 days after approval by the Board of City Commissioners.

THE CITY OF WICHITA
OFFICE OF WATER DEPARTMENT

DATE October 15, 1971



Cur

TO Jack Galbraith, Chief Planner
FROM Bill H. Otten, Design & Planning Superintendent
SUBJECT -- SOPJES ADDITION

The DeBoer Building Systems Corporation has made satisfactory arrangements with the Water Department for a water main extension to serve this plat.

Bill H. Otten

Bill H. Otten
Design & Planning Superintendent

BHO/jds

cc: John D. Wynkoop, Operations Chief Engineer



WICHITA-SEDGWICK COUNTY
METROPOLITAN AREA PLANNING DEPARTMENT

6114

October 18, 1971

TO: Mr. [Name] Director of Public Works
FROM: Mr. [Name] Director of Planning
SUBJECT: [Subject]

COPY

[Faded body text of the letter, including a subject line and several paragraphs of text.]



deboer building systems corporation 719 East Tenth Wichita, Kansas 67214 (316) 865-4271

October 7, 1971

City of Wichita
Director of Planning
Planning Department
104 South Main Street
Wichita, Kansas

RE: Sewer permit, new plant site, McArthur at K-15

Gentlemen:

Enclosed herewith are three executed copies of "Application and Permit for Sewerage Service for property located outside the corporate limits of the City of Wichita", as requested by your office.

We have taken the liberty of deleting paragraph No. 7 which intended that we give our consent to annexation of the subject property to the City of Wichita. Due to the relationship which we have with the City of Derby in the matter of our industrial revenue bonds, we are advised by our counsel that we are unable to give such consent at this time.

I am hopeful that our inability to comply with the intent of paragraph 7 will not delay approval of our sewer permit.

Sincerely,

DeBOER BUILDING SYSTEMS CORP.

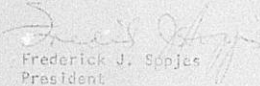
Frederick J. Spjies
President

jw

Enclosure

cc: Mr. Jack DeBoer
Mr. Bob Eflin
Mr. Glenn Ihde
Mr. Jimmie Grey
Mr. Mansell Jack



October 14, 1971

Ray Bruggeman, Director of Public Works
Robert H. Hess, Director of Water
Robert A. Lakin, Director of Planning

Sewer Application - Out of City
DeBoer Corporation

Attached is a letter which we received containing an application permit for sewer service for the DeBoer Building Systems Corporation. This involves the Sopjes Addition and it is a requirement to provide sanitary sewer facilities.

The DeBoer letter indicates that their counsel says they may not now sign an agreement to annexation inasmuch as they are utilizing City of Derby industrial revenue bonds. Deferred at last week's City Commission meeting was the same request from DeBoer for water in which they had agreed to annexation.

It is my opinion that annexation should be a part of providing city service. I know these agreements are not legally binding, but if sewer service is to be provided without such a statement, I believe this is a major deviation from policy which the City Commission should answer.

Would you please provide this to the Manager's office for inclusion on the agenda for October 19.

RAL:ber

Attachment

cc: Ralph Wulz, City Manager
John D. Gist, Principal Planner

THE CITY OF WICHITA
OFFICE OF Water Department

DATE September 16, 1971

TO Robert Lakin, Director of Planning
FROM John D. Wynkoop, Operations Chief Engineer

SUBJECT Application for Water Service Outside
the Corporate Limits.

Attached for your consideration and approval is an application for water service outside the corporate limits to serve the properly designated on the accompanying map and described on the application.

A 12-inch water main will be run in MacArthur Road east from K-15 Highway on a customer deposit basis to serve this property.

Please return the application to this office.

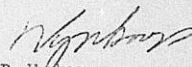

John D. Wynkoop
Operations Chief Engineer

cc: Robert H. Hess, Director of Water



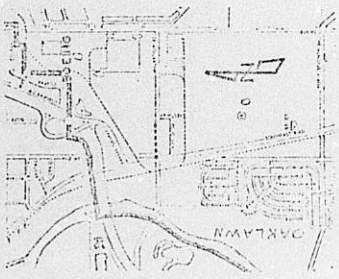

AREA MAP

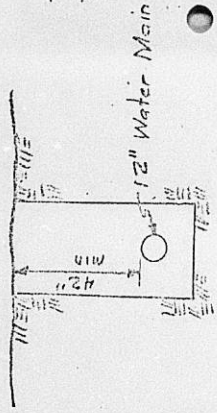

SECTION

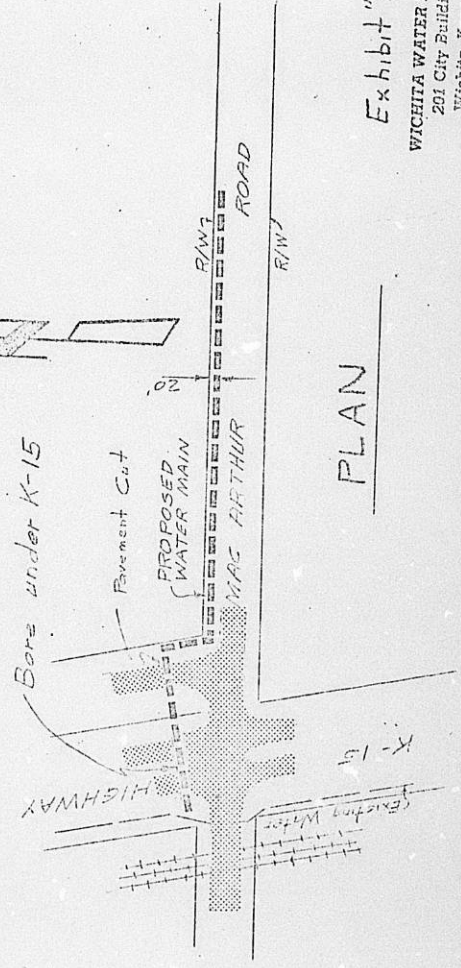

PLAN

Exhibit "A"

WICHITA WATER DEPARTMENT
 201 City Building Annex
 Wichita, Kansas 67202

APPLICATION FOR WATER SERVICE
OUTSIDE THE CORPORATE LIMITS OF
THE CITY OF WICHITA

The Governing Body of the City of Wichita, Kansas, this _____ day of _____, 19____, approves and files the application of DeBoer Building Systems Corp., Inc. for water service to the following property:
(See attached description of property)

at an estimated cost of \$24,850.00, with the Water Department paying \$ 9,973.60, of the estimated cost. This property is located outside of the corporate limits of the City of Wichita, and the applicant agrees to annexation by the City of Wichita if and when said property is legally annexable, and also agrees to abide by the established rules and regulations of the Wichita Water Department now in force, or which may hereafter be enacted or adopted by said Department or the City of Wichita, Kansas, and to pay for service at the established rate, in accordance with the City of Wichita Code 17.12.090, or as amended. The applicant further agrees to acquire a plumbing permit from the City of Wichita; to have his service line installed by a plumber licensed by the City using City approved materials and installation methods.

APPLICANT

DeBoer Building Systems Corp., Inc.

Fred Sopjes
Fred Sopjes - President
Director of Planning

APPROVED BY: Robert A. [Signature]

Director of Public Works

Director of Water & Water
Pollution Control

AUTHORIZED BY: _____ MAYOR

Date: _____

ATTEST:

CITY CLERK

Form UL-918

DESCRIPTION OF PROPERTY

The proposed Sopjes Addition described as follows:

Beginning at a point 50 feet north of the southeast corner, Southwest 1/4, Section 11, Township 28 South, Range 1 East; thence north along east side of said Southwest 1/4 Section a distance of 1,401.08 feet to the southerly right-of-way line of the defense right-of-way, Sedgwick County, Kansas; thence southwesterly along south line of said defense right-of-way a distance of 1,484.07 feet to the east line of K-15 State Highway; thence southeasterly along said east line of K-15 a distance of 626 feet more or less to the north line of MacArthur Road; thence east along said north line of MacArthur Road a distance of 382.3 feet; thence south along a line perpendicular to the north line of MacArthur Road a distance of 10 feet; then east along a line parallel to the center line of MacArthur Road a distance of 778 feet more or less to the point of beginning.

LAW OFFICES OF
MORRIS, LAING, EVANS & BROCK
CHARTERED
SUITE 430
200 WEST DOUGLAS
WICHITA, KANSAS 67202

October 12, 1971

LESTER L. MORRIS
1901-1966
VERNE M. LAING
FERD E. EVANS, JR.
RALPH R. BROCK
JOSEPH W. KENNEDY
C. ROBERT BELL
ROBERT I. GUENTHNER
DAVID C. ADAMS

(316) 262-2671

Metropolitan Area Planning Commission
City Annex Building
Wichita, Kansas, 67202

RE Sopjes Addition

Gentlemen:

This is to certify that the following are the owners of portions of the property platted as Sopjes Addition and that together they are the owners of all of the property so platted, to-wit:

1. DeBoer Building Systems Corporation
2. Consolidated American Industries, Inc.

This is to further certify that the following are the persons who have encumbrances on portions of the property encompassed within said plat, to-wit:

First National Bank in Wichita
Kansas State Bank & Trust Company.

This is to further certify that no other persons have an interest in or encumbrance on any of the property included in said plat which is of such a nature that consent of such persons is required to the plat under the law.



Page 2

This is to further certify that all taxes and special assessments due and payable on the property encompassed within said plat have been paid in full.

Very truly yours,

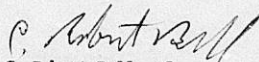

C. Robert Bell, of
MORRIS, LAING, EVANS & BROCK, Chartered

CRB/cs

cc: Jimmie Grey
Bill Korber

May 11, 1971

Baughman Company
2522 East Kellogg
Wichita, Kansas 67211

Subject: S/D 71-27 - Preliminary
Plat of SOPJES ADDITION

Gentlemen:

At the regular meeting of the Subdivision Committee of the Metropolitan Area Planning Commission, May 6, 1971, the above captioned plat was considered. The action of the Committee was to approve the preliminary and authorize preparation of the final plat, subject to the following:

- The street adjacent to the northerly line of Lots 1, 2 and 3 shall be labeled as "Turnpike Drive".
- A block number or letter shall be indicated on the face of the plat.
- A 35 foot building setback from all adjacent streets on Lots 1, 2 and 3, shall be indicated on the plat.
- Prior to the preparation of the final plat, the applicant and/or their surveyor shall contact the Engineering and Traffic Engineering Divisions of the Department of Public Works. The purpose is to see what additional rights-of-way might be needed, if any, relative to reimprovements on K-15 and McArthur Road, and as to indicating appropriate access controls along the south side of subject plat.
- The applicant shall furnish to the Planning Department, a copy of an agreement or letter of confirmation concerning the granting of permission which the applicant is seeking from the Department of Defense to allow their connection to the private sanitary sewer line which serves the Boeing Company to the east.

Page 2
May 11, 1971

6. The applicant shall obtain and furnish to the Planning Department, a letter from the Wichita Water Department that satisfactory arrangements have been made for the extension of City municipal water to serve subject property.
7. Prior to the development of subject property, the applicant and/or developer should contact the Southwestern Bell Telephone Company relative to the granting easement(s) which will appear to be necessary to serve subject and adjacent properties.
8. The applicant shall install or guarantee the installation of all utilities and facilities which are applicable and described in Article 8 of the MAPC Subdivision Regulations.
9. Requirements for a final plat (see pages 20-25, Part 4, Article 5 of the MAPC Subdivision Regulations).

It should be pointed out that even though it is the applicant's intent to connect to Boeing's private sanitary sewer, the City Engineer advised at the Subdivision Committee meeting that it will be necessary to obtain a connection permit from the City since said private sewer empties into the City system.

Enclosed herewith is the "marked" copy of the preliminary plat for your information and files.

If you should have any questions concerning this matter, please call.

Very truly yours,

John D. Gist
Principal Planner

JDG:rme

Enclosure

cc: DeBoer Building Systems, Corp., & Jimmie E. Grey
202 S. Rock Road, 67207
Consolidated American Industries, Inc.
622 East 3rd Street, 67202
C. Robert Bell, Attorney, 200 W. Douglas, 67202

PRELIMINARY PLAT
SUBDIVISION REPORT

SUBDIVISION COMMITTEE
METROPOLITAN AREA
PLANNING COMMISSION

S/D NO. 71-27 Name SOPJES ADDITION
Date Application Rec'd. 4-26-71 Preliminary Approval _____
Scheduled S/D Meeting 5-6-71

DESCRIPTION

General Location At the northeast corner of K-15 Highway and
MacArthur Road.

Owner DeBoer Building Systems, Corp.

Surveyor/Engineer Baughman Company

Address 2522 East Kellogg Phone 683-7431

- | | |
|--|--|
| 1. Gross Acreage of Plat <u>29.8</u> | 7. Lineal Feet of New Streets: |
| 2. Number of Lots: | a. <u>50</u> R/W <u>778</u> ft. |
| Residential _____ | b. _____ R/W _____ ft. |
| Commercial _____ | c. _____ R/W _____ ft. |
| Industrial <u>3</u> | d. _____ R/W _____ ft. |
| Other _____ | e. _____ R/W _____ ft. |
| Total Number of Lots <u>3</u> | TOTAL <u>778</u> ft. |
| 3. Minimum Lot Frontage <u>205</u> ft. | 8. Sidewalk adjacent to all |
| 4. Minimum Lot Area <u>220,397</u> sq. ft. | streets? <u>yes</u> <u>X</u> <u>no</u> |
| 5. Existing Zoning <u>"E"</u> | |
| 6. Proposed Zoning <u>"E"</u> | |
| 9. Public Water Supply _____ (Yes-No), Name _____ | |
| 10. Public Sanitary Sewers <u>Yes</u> (Yes-No), Name <u>Boeing</u> | |
| 11. Health Department Approval (where applicable) _____ (Yes-No) | |
| 12. City of Wichita _____ : Three-Mile Area <u>X</u> | |

STAFF COMMENTS:

1. It should be noted that Lot 2 exceeds the maximum depth standard set forth in the Subdivision Regulations for industrial type lots. The depth standard is based on the proportion of 3 times the lot width, although in this particular case the tract is a "through-lot" and does have a street adjacent to both the north and south sides of the lot.
2. The street adjacent to the northerly line of Lots 1, 2 and 3 shall be labeled as "Turnpike Drive".
3. A block number or letter shall be indicated on the face of the plat.
4. A 35 foot building setback from all adjacent streets on Lots 1, 2 and 3, shall be indicated on the plat.
5. Subject property is bounded on the north by Turnpike Drive, on the south by MacArthur Road and on the west by K-15 Highway. Due to the nature and relationship of these streets to one another, access controls to said streets will be discussed at the Subdivision Committee meeting.
6. Subject property is located in an area where it is expected to, at a point in time, be served with sanitary sewer. The applicant shall petition to the City of Wichita for sanitary sewer to serve subject property. The Engineering Division of the Department of Public Works should be contacted regarding this matter.
7. In the event municipal sewer and water are not immediately available, the applicant shall contact the Wichita-Sedgwick County Environmental Health Department relative to obtaining instructions for conducting percolation tests to determine whether the use of individual private water and septic tank systems can be permitted on subject property. A letter shall be obtained from said Department setting forth approval of such systems which shall be submitted to the Planning Department.

(over)

8. The applicant shall install or guarantee the installation of all utilities and facilities which are applicable and described in Article 8 of the MAPC Subdivision Regulations. The applicant should be prepared to discuss with the Subdivision Committee the manner in which it is proposed to provide for such utilities and facilities, e.g., petition, actual construction, monetary guarantee, etc.
9. Requirements for a final plat (see pages 20-25, Part 4, Article 5 of the MAPC Subdivision Regulations).

Map No.: J-7C
(5743)
Section No.: 11
Twp. No.: 28 S
Range: 1 E

S/D No. 71-27

APPLICATION FOR SUBDIVISION APPROVAL

Name of Subdivision: SOPJES ADDITION

General Location: K-15 & MacArthur Road 7e corner

Name of Property Owner: DeBoer Building Systems Corp. Att: Jimmie E. Gray

Address: 202 S. Rock Road Phone: 685-2381

Name of Subdivider: same & Consolidated American Industries Inc.

Address: 622 E. 3rd St. Phone: _____

Name of Agent/Surveyor: Baughman Co.

Address: _____ Phone: _____

Date of Application: April 26, 1971

SUBDIVISION INFORMATION:

1. Gross Acreage of Plat 29.8 Ac.
2. Number of Lots:
 - Residential _____
 - Commercial _____
 - Industrial _____
 - Other _____Total Number of Lots 3
3. Minimum Lot Frontage 225 ft.
4. Minimum Lot Area 220,397 sq. ft.
5. Existing Zoning E
6. Proposed Zoning E
7. Lineal Feet of New Streets:
 - a. 50 R/W 778 ft.
 - b. _____ R/W _____ ft.
 - c. _____ R/W _____ ft.
 - d. _____ R/W _____ ft.
 - e. _____ R/W _____ ft.TOTAL 778 ft.
8. Sidewalk adjacent to all streets? yes X no
9. Public Water Supply _____ (Yes-No), Name _____
10. Public Sanitary Sewers yes (Yes-No), Name Boeing
11. Health Department Approval (where applicable) _____ (Yes-No)
12. City of Wichita Three-Mile Area X

The owner herein agrees to comply with the Subdivision Regulations for the Wichita-Sedgwick County Metropolitan Area, as approved, and all other pertinent ordinances of the City of Wichita and/or Resolutions of Sedgwick County, Kansas, and Statutes of the State of Kansas. He further agrees that he waives the 60-day statutory period in which the Planning Commission or governing body must act. In addition, it is agreed that all costs of recording the plat and supplemental documents thereto with the Register of Deeds, as well as all costs of publication of initiating resolutions approving any petition for improvements, such as streets, sewer, sidewalks, etc. shall be assumed and paid by the owner when billed. The undersigned further states that he is the owner of the property proposed for platting.

Owner's Signature: Jimmie E. Gray Sec.

Wichita-Sedgwick County Metropolitan Area
Planning Commission, Room 402, City Building
Annex, 104 South Main Street, Wichita, Kansas

Received by Carl Neely
Date 4/26/71
Fee Submitted 59.00

T9-301B
(2-71)

Note: also send
correspondance to
C. Robert Bell.



Form 273-021

PAYMENT NOTICE

City of Wichita

PAY AT TREASURER'S OFFICE - FIRST FLOOR

Bldg & Elev.	Elec.	Elev. Insp.	Exam. Fees
Hse. Mvr.	Hse. Moving	Licse.	Mech.
Oil Well	Pav. Cuts	Plan.	Plbg. Cert.
Sanitation	Sewer	Signs	Sidewalk
Street	Trailer	859.00	

DESCRIPTION	AMOUNT
40 application	

Name

D. Penn. 1111 1/2 W. 10th St. W. 10th St. W. 10th St.

Address

250 E. Hillman

Type

AA-- 407103

Due Date

Comments:

Date

4/22/71

By

Cent. H. H. H.