

S

S AND G INDUSTRIAL ADDITION

TO WICHITA, SEDGWICK COUNTY, KANSAS

REVISED COPY

FINAL PLAT
50 76-49
OFFICE COPY
DO NOT REMOVE

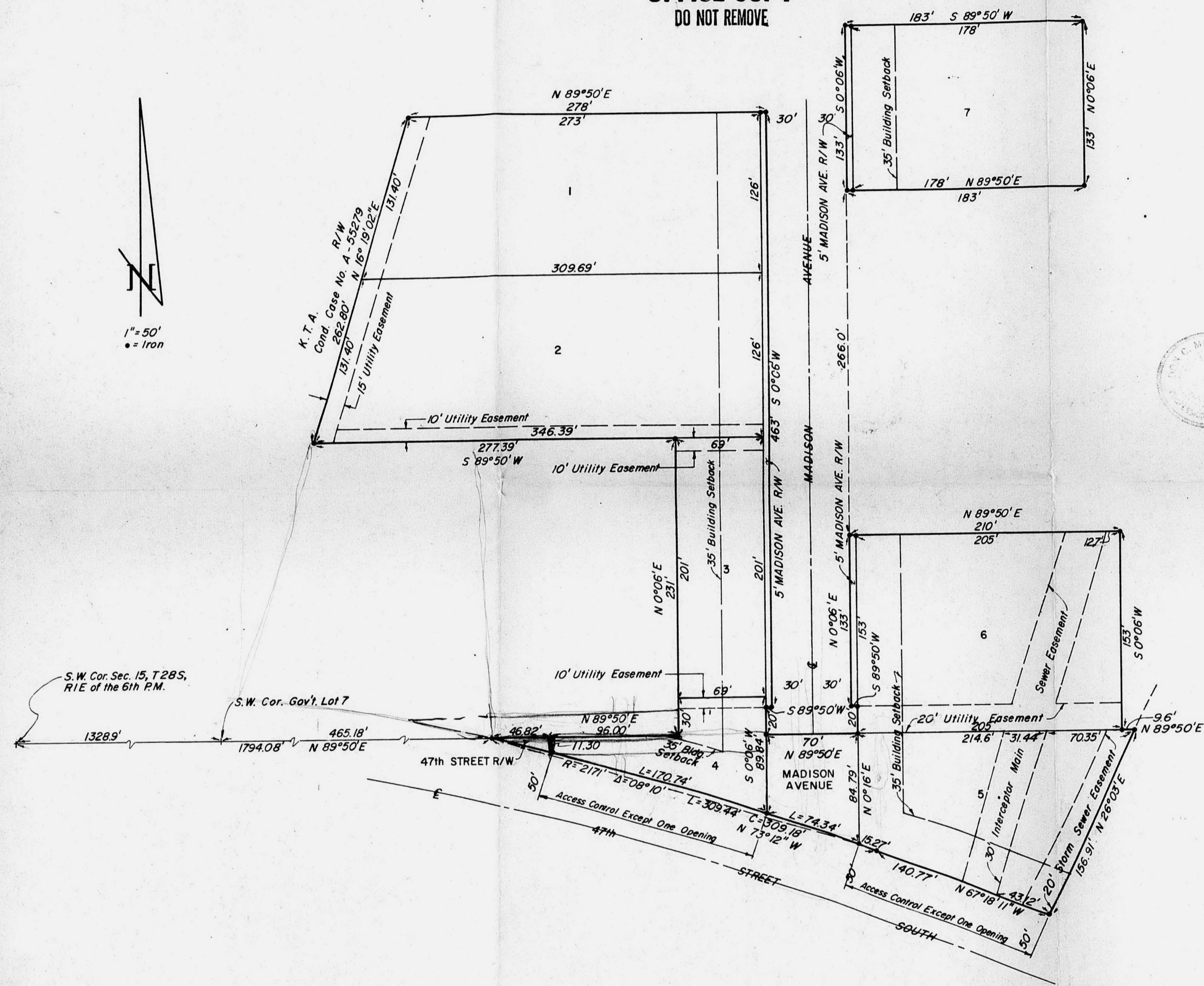

STATE OF KANSAS, COUNTY OF SEDGWICK, SS:

I, Don C. Moehring II, a Civil Engineer in said State and County, do hereby certify that I have surveyed and platted "S AND G INDUSTRIAL ADDITION" to Wichita, Sedgwick County, Kansas, into Lots, Streets, and an Avenue, the same being accurately set forth on the accompanying plat and described as follows: Beginning at a point in the South line of Sec. 15, T28S, R1E of the 6th P.M., said point being 1794.08 feet East of the SW corner of said Section 15; thence N89°50'50"E along the South line of said Section 15, a distance of 142.82 feet; thence W0°06'00"E, a distance of 231.0 feet; thence S89°50'50"E, a distance of 277.39 feet to a point in the East line of the K.T.A. Right-of-way; thence N16°19'02"E along said Right-of-way line, a distance of 272.80 feet; thence N89°50'50"E, a distance of 278 feet; thence S0°06'00"E, a distance of 483.0 feet; thence S89°50'50"E, a distance of 5.0 feet; thence S0°06'00"W, a distance of 20.0 feet; thence N89°50'50"E, a distance of 70.0 feet; thence W0°06'00"E, a distance of 20.0 feet; thence S89°50'50"W, a distance of 5.0 feet; thence N0°06'00"E, a distance of 133.0 feet; thence N89°50'50"E, a distance of 210.0 feet; thence S0°06'00"W, a distance of 153.0 feet; thence S89°50'50"W, a distance of 486.82 feet to the point of beginning.

AND beginning at a point 2070.67 feet N89°50'50"E and 813.0 feet W0°06'00"E from the SW corner of Sec. 15, T28S, R1E of the 6th P.M.; thence N89°50'50"E, a distance of 183.0 feet; thence W0°06'00"E, a distance of 133.0 feet; thence S89°50'50"W, a distance of 183.0 feet; thence S0°06'00"W, a distance of 133.0 feet to the point of beginning.

AND a Replat of Block "G", South Hydraulic Park Second Addition, Sedgwick County, Kansas.

Within the limits of this plat, Ash Street and 47th Street South in Government Lot 7 of Section 15, and Spruce Street North of 47th Street South in Section 22, are being replatted and vacated by virtue of K.S.A. 1971 Supp. 12-512 (b).

Don C. Moehring II
Consulting Engineer
314 Brown Bldg
Wichita, Kansas

Know all men by these presents that we the undersigned, property owners of the land as above set forth in the Civil Engineer's Certificate, have caused the same to be surveyed and platted into Lots, Streets, and an Avenue, the same to be known as "S AND G INDUSTRIAL ADDITION" to Wichita, Sedgwick County, Kansas. The Streets and Avenue are hereby dedicated to and for the use of the public. Easements for the construction and maintenance of public utilities are hereby granted. All abutter's rights of access to and from 47th Street South, over and across the South line of Lots 4 and 5, are hereby granted to the City of Wichita, provided that Lots 4 and 5 shall each have access to 47th Street at one location, to be determined by the City Engineer of the City of Wichita.

D. G. Snyder Erna Snyder
L. Jay Gilbert Marieta A. Gilbert

STATE OF KANSAS, COUNTY OF SEDGWICK, SS:

Be it remembered that on this _____ day of _____, 1972, before me, a Notary Public in and for said State and County, came D. G. Snyder, Erna Snyder, L. Jay Gilbert, and Marieta A. Gilbert, to me personally known to be the same persons who executed the foregoing instrument of writing and duly acknowledged the execution of the same. In testimony whereof I have hereunto set my hand and affixed my notarial seal the day and year above written.

Notary Public
My Commission expires _____

We, the Farmers and Merchants State Bank of Derby, Kansas, mortgagee on part of the above described property, do hereby consent to the plat of "S AND G INDUSTRIAL ADDITION".

Farmers and Merchants State Bank of Derby, Kansas

President
Elwood Jones

Cashier
Donald R. Murphy

STATE OF KANSAS, COUNTY OF SEDGWICK, SS:

Be it remembered that on this _____ day of _____, 1972, before me, a Notary Public in and for said State and County, came the Farmers and Merchants State Bank of Derby, Kansas, by Elwood Jones, President, and Donald R. Murphy, Cashier, to me personally known to be the same persons who executed the foregoing instrument of writing and duly acknowledged the execution of the same. In testimony whereof I have hereunto set my hand and affixed my notarial seal the day and year above written.

Notary Public
Charlotte Stolljes
My Commission expires _____

This plat of "S AND G INDUSTRIAL ADDITION" has been submitted to and approved by the Wichita-Sedgwick County Metropolitan Area Planning Commission, Wichita, Kansas.

Dated this _____ day of _____, 1972.

Wichita-Sedgwick County Metropolitan Area Planning Commission

Chairman
Alvin J. Hennessy

Secretary
Robert A. Lakin

This Plat approved and all dedications shown hereon, if any, accepted by the City Commission of the City of Wichita, Kansas.

Mayor
Glenn J. Shannahan

City Clerk
Ralph C. Eberly

This Plat approved and all dedications shown hereon, if any, accepted by the Board of County Commissioners of Sedgwick County, Kansas.

Chairman
Earl E. Rusk

Commissioner
Elmer S. Peters

Commissioner
Tom Scott

County Clerk
ATTEST: Marie Warden

STATE OF KANSAS, COUNTY OF SEDGWICK, SS:

This is to certify that this instrument was filed for record in the Register of Deeds Office at _____ on the _____ day of _____, 1972.

Register of Deeds
John Hale

Deputy
Pearl B. Gilbert

Entered on Transfer Record this _____ day of _____, 1972.

County Clerk
Marie Warden

SD 70-49
 SKETCH PLAT
 OFFICE COPY
 DO NOT REMOVE

SKETCH
 PRELIMINARY PLAT

S AND G INDUSTRIAL ADDITION
 TO WICHITA, SEDGWICK COUNTY, KANSAS

LEGAL DESCRIPTIONS

- TRACT 1. BLOCK "D", SOUTH HYDRAULIC PARK SECOND ADDITION SEDGWICK COUNTY, KANSAS.
- TRACT 2. BEGINNING AT A POINT 742' E. AND 20' N. OF THE S.W. CORNER OF LOT 7, THENCE E. 210'; THENCE N. 532'; THENCE W. 210'; THENCE S. TO POINT OF BEGINNING, SECTION 15, T. 28S., R. 1E., EXCEPT THE N. 250'.
- TRACT 3. BEGINNING AT A POINT 482' E. AND 357' N. OF THE S.W. CORNER OF GOV'T. LOT 7, THENCE N. 128'; THENCE W. 128'; THENCE E. 148'; THENCE S. TO POINT OF BEGINNING, IN THE E. 1/2 OF THE S.W. 1/4, SECTION 15, T. 28 S., R. 1 E.
- TRACT 4. BEGINNING AT A POINT 231' N. AND 534' E. OF THE S.W. CORNER OF GOV'T. LOT 7, THENCE N. 128'; THENCE E. 148'; THENCE S. 128'; THENCE W. 148' TO THE POINT OF BEGINNING, IN THE E. 1/2 OF THE S.W. 1/4, SECTION 15, T. 28 S., R. 1 E., IN SEDGWICK COUNTY, KANSAS.
- TRACT 5. BEGINNING 386' E. AND 231' N. OF THE S.W. CORNER OF GOV'T. LOT 7, IN THE S.W. 1/4 OF SECTION 15, T. 28 S., R. 1 E., OF THE 6 TH P.M., SEDGWICK COUNTY, KANSAS, FOR THE POINT OF BEGINNING, THENCE E. 148'; THENCE N. 252'; THENCE W. 186'; THENCE S. 252' TO THE POINT OF BEG., EXCEPT THAT PORTION CONDEMNED FOR KANSAS TURNPIKE PROJECT, DESCRIBED AS FOLLOWS: BEGINNING AT THE N.W. CORNER OF THE ABOVE DESCRIBED TRACT, THENCE E. 18'; THENCE S.W. LY 65', MORE OR LESS, TO A POINT ON THE N. LINE OF SAID TRACT, THENCE N. 62' TO THE PLACE OF BEGINNING.
- TRACT 6. BEGINNING 608' E. OF THE S.W. CORNER OF GOV'T. LOT 7, IN THE S.W. 1/4 OF SECTION 15, T. 28 S., R. 1 E. OF THE 6 TH P.M., IN SEDGWICK COUNTY, KANSAS, THENCE N. 231'; THENCE E. 74'; THENCE S. 231'; THENCE W. 74' TO THE PLACE OF BEGINNING.

OTHERS: L. JAY AND MARIETA A. GILBERT, (TRACTS # 2, 3, 4, AND 5, ABOVE)
 D. O. AND ERMA SNYDER, (TRACTS # 1 AND 6, ABOVE)

Don C. Moehring, C.E. CONSULTING CIVIL ENGINEERS
 314 BROWN BUILDING WICHITA, KANSAS
 FILE # 20392 A SEPTEMBER 8, 1970

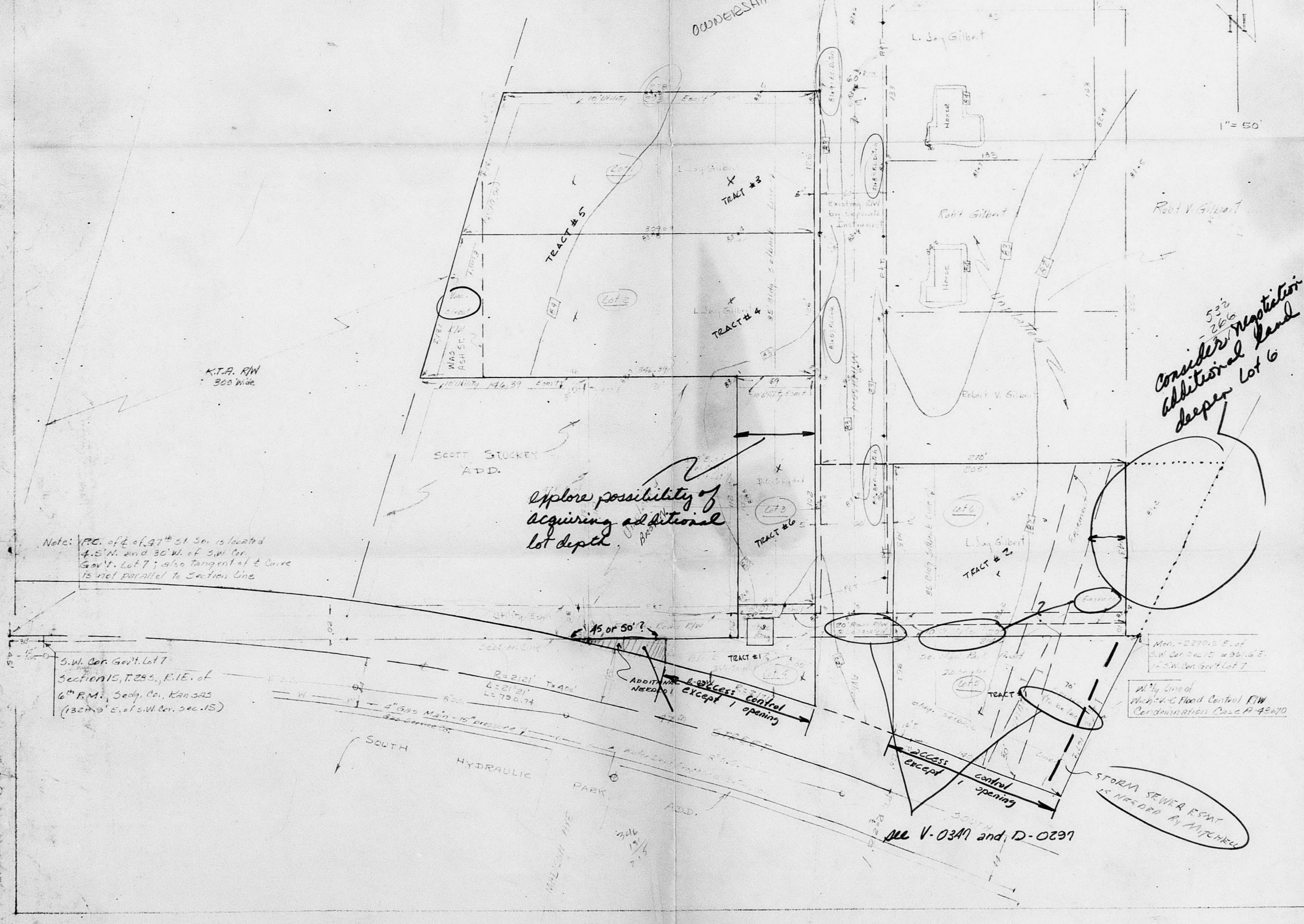
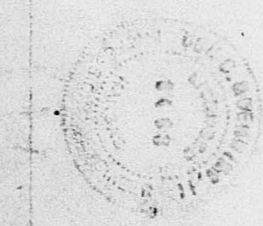

Note: 100' wide of 92' at SW corner of Gov't. Lot 7; also temporary curve to meet parallel to Section Line

SW 1/4 Gov't. Lot 7 Section 15, T. 28S., R. 1E. of 6th P.M., Sedgwick Co., Kan. 325 (Acquired by Section 15)

Consider restriction for additional land to deeper lot 6

Explore possibility of acquiring additional lot depth

ALL V-0341 and D-0231

PRELIMINARY PLAT
SD 70-49
OFFICE COPY
 DO NOT REMOVE

PRELIMINARY PLAT
 S AND G INDUSTRIAL ADDITION
 TO WICHITA, SEDGWICK COUNTY, KANSAS

LEGAL DESCRIPTIONS

TRACT 1. BLOCK "G", SOUTH HYDRAULIC PARK SECOND ADDITION SEDGWICK COUNTY, KANSAS.

TRACT 2. BEGINNING AT A POINT 762' E. AND 20' N. OF THE S.W. CORNER OF LOT 7; THENCE E. 210'; THENCE N. 532'; THENCE W. 210'; THENCE S. TO POINT OF BEGINNING, SECTION 15, T.28S., R.1E.; EXCEPT THE N. 266'.

TRACT 3. BEGINNING AT A POINT 882' E. AND 367' N. OF THE S.W. CORNER OF GOV'T. LOT 7; THENCE N. 148'; THENCE E. 126'; THENCE S. 148'; THENCE W. 126'; THENCE E. 148'; THENCE S. TO POINT OF BEGINNING, IN THE E. 1/2 OF THE S.W. 1/4, SECTION 15, T. 28 S., R. 1 E., IN SEDGWICK COUNTY, KANSAS.

TRACT 4. BEGINNING AT A POINT 231' N. AND 531' E. OF THE S.W. CORNER OF GOV'T. LOT 7; THENCE N. 126'; THENCE E. 148'; THENCE S. 126'; THENCE W. 148' TO THE POINT OF BEGINNING; IN THE E. 1/2 OF THE S.W. 1/4, SECTION 15, T. 28 S., R. 1 E., IN SEDGWICK COUNTY, KANSAS.

TRACT 5. BEGINNING 386' E. AND 231' N. OF THE S.W. CORNER OF GOV'T. LOT 7, IN THE S.W. 1/4 OF SECTION 15, T. 28 S., R. 1 E., OF THE 6 TH P.M., SEDGWICK COUNTY, KANSAS, FOR THE POINT OF BEGINNING, THENCE E. 148'; THENCE N. 252'; THENCE W. 148'; THENCE S. 252' TO THE POINT OF BEG., EXCEPT THAT PORTION CONSUMED FOR KANSAS TURNPIKE PROJECT, DESCRIBED AS FOLLOWS: BEGINNING AT THE N.W. CORNER OF THE ABOVE DESCRIBED TRACT, THENCE E. 18'; THENCE S.W. 1/4 65', MORE OR LESS, TO A POINT ON THE W. LINE OF SAID TRACT, THENCE N. 62' TO THE PLACE OF BEGINNING.

TRACT 6. BEGINNING 408' E. OF THE S.W. CORNER OF GOV'T. LOT 7, IN THE S.W. 1/4 OF SECTION 15, T. 28 S., R. 1 E. OF THE 6 TH P.M., IN SEDGWICK COUNTY, KANSAS, THENCE N. 231'; THENCE E. 74'; THENCE S. 231'; THENCE W. 74' TO THE PLACE OF BEGINNING.

OWNERS: L. JAY AND MARIETA A. GILBERT, (TRACTS 2, 3, 4, AND 5, ABOVE)
 D. O. AND ERMA SNYDER, (TRACTS 1 AND 6, ABOVE)

Don C. Moehring
 DON C. MOHRING, C.E. CONSULTING CIVIL ENGINEERS
 314 BROWN BUILDING WICHITA, KANSAS
 FILE # 20392 A SEPTEMBER 8, 1970

S/D 70-49
 Approval subject to:

- The applicant submitting a letter requesting withdrawal of the 2 associated cases V-0347-Vacation of St. R.O.W and D-0297-dedication of St. A.O.W.
- Label the 20' easement on lot 5 as storm sewer easement.
- Install or guarantee extension of sanitary sewer to serve each lot.
- Make satisfactory arrangements with the Water Dept to serve all lots.
- Contact K.G.F. and Southwest Bell and make satisfactory arrangements for relocation of existing facilities in the old 47th St. R.O.W being vacated by this plat and a letter obtained from each company stating such arrangements have been made, shall be submitted to the Planning Dept.
- Any relocation or abandonment of existing utilities and facilities accepted by this plat, shall be at the sole expense of the applicant without any cost to City, County or any utility Co.
- Reference in the agreement that the streets being vacated by the plat are being vacated by virtue of KSA 1711 Supp. 12-512(B).
- Install or guarantee the installation of all applicable utilities and facilities as described in Art. 8 of the M.A.P.C. Subdivision Regulations.
- Requirements of a final plat of the M.A.P.C. Subdivision Regulations.

Note: see letter dated 4-24-72
 CLN

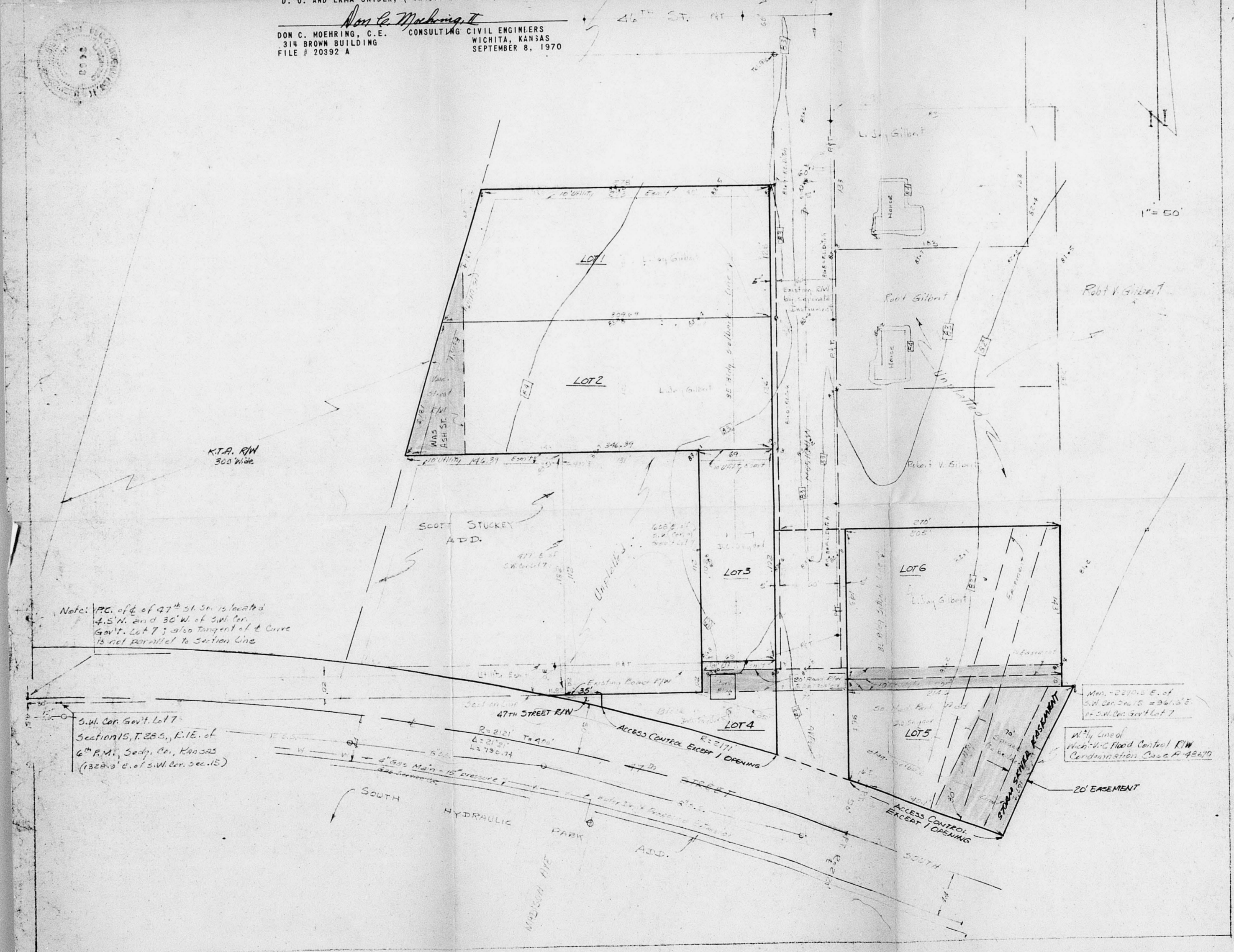

**SANTA FE ORIENT INDUSTRIAL DISTRICT
TO WICHITA, SEDGWICK COUNTY, KANSAS**

SD 72-126
APPROVED FOR RECORDING
RECORDED ON FEBRUARY 4, 1974

STATE OF KANSAS SS
COUNTY OF SEDGWICK

I, CHARLES M. JEFFRIES, A REGISTERED LAND SURVEYOR IN AFORESAID COUNTY AND STATE DO HEREBY CERTIFY THAT ON THIS 22ND DAY OF DECEMBER, 1972, I HAVE SURVEYED AND PLATTED SANTA FE ORIENT INDUSTRIAL DISTRICT TO WICHITA, SEDGWICK COUNTY, KANSAS, INTO A LOT, A BLOCK, A STREET AND AN ALLEY, THE SAME BEING DESCRIBED AS BEGINNING AT A POINT ON THE EAST LINE OF ST. CLAIR AVENUE AND 35 FEET SOUTH OF THE CENTERLINE OF MERTON AVENUE, SAID POINT ALSO BEING 5 FEET SOUTH OF THE NW CORNER OF LOT 1 AS PLATTED IN BLOCK "P", SOUTH UNIVERSITY PLACE ADDITION TO WICHITA, KANSAS; THENCE EAST PARALLEL WITH AND 5 FEET FROM THE SOUTH LINE OF VACATED MERTON AVENUE, BEARING N 89°45'50" E A DISTANCE OF 951.38 FEET TO A POINT 170 FEET NORTHERLY OF AND PERPENDICULAR TO THE CENTERLINE OF ORIENT AVENUE AS DEDICATED BY ORDINANCE 4479 OF MAY 6, 1912; THENCE BEARING S 57°12'10" W ALONG A LINE 170 FEET FROM AND PARALLEL TO THE CENTERLINE OF SAID ORIENT AVENUE A DISTANCE OF 1381.58 FEET TO THE EAST LINE OF A 14.00 FOOT ALLEY BETWEEN SEDGWICK AVENUE AND ST. CLAIR AVENUE AS PLATTED IN BLOCK "J" IN SOUTH UNIVERSITY PLACE ADDITION; THENCE BEARING N 0°00'50" E ALONG THE EAST LINE OF SAID ALLEY A DISTANCE OF 200.10 FEET, TO THE NW CORNER OF LOT 46, BLOCK "D", SOUTH UNIVERSITY PLACE ADDITION TO WICHITA, KANSAS; THENCE BEARING N 89°57'25" E ALONG THE NORTH SIDE OF SAID LOT 46 EXTENDED A DISTANCE OF 200.01 FEET TO THE EAST LINE OF ST. CLAIR AVENUE; THENCE BEARING N 0°00'00" E ALONG THE EAST LINE OF ST. CLAIR AVENUE A DISTANCE OF 545.32 FEET TO THE POINT OF BEGINNING.

Charles M. Jeffries
CHARLES M. JEFFRIES
REG. NO. 555



KNOW ALL MEN BY THESE PRESENTS, THAT WE, THE UNDERSIGNED OWNERS OF THE LAND AS SET FORTH IN THE SURVEYOR'S CERTIFICATE, HAVE CAUSED THE LAND TO BE SURVEYED AND PLATTED INTO A BLOCK, A LOT, A STREET AND AN ALLEY, THE SAME TO BE KNOWN AS SANTA FE ORIENT INDUSTRIAL DISTRICT TO WICHITA, SEDGWICK COUNTY, KANSAS. THE STREET AND ALLEY ARE HEREBY DEDICATED TO AND FOR THE USE OF THE PUBLIC. ALL ABUTTERS' RIGHTS OF ACCESS TO AND FROM ESTIMER AVENUE AND THE ADJOINING ALLEY OVER AND ACROSS THE WEST LINE OF LOT 1, BLOCK A, ARE HEREBY GRANTED TO THE CITY OF WICHITA.

SANTA FE INDUSTRIAL REALTY COMPANY

BY *J. R. Scott*
J. R. SCOTT, PRESIDENT

ATTEST *V. R. Baker* ASSISTANT SECRETARY

STATE OF ILLINOIS
COUNTY OF COOK

BE IT REMEMBERED THAT ON THIS 25TH DAY OF APRIL, 1973, BEFORE ME A NOTARY PUBLIC IN AND FOR SAID COUNTY AND STATE CAME J. R. SCOTT, PRESIDENT, AND J. E. LAHEY, ASSISTANT SECRETARY, OF SANTA FE INDUSTRIAL REALTY COMPANY, TO ME PERSONALLY KNOWN TO BE THE SAME PERSONS WHO EXECUTED THE FOREGOING INSTRUMENT OF WRITING AND DULY ACKNOWLEDGED THE EXECUTION OF SAME FOR AND ON BEHALF, AND AS THE ACT AND DEED OF SAID COMPANY. IN TESTIMONY WHEREOF I HAVE HERETO SET MY HAND AND AFFIXED MY NOTARIAL SEAL THE DAY AND YEAR ABOVE WRITTEN.

John R. Scott NOTARY PUBLIC

MY COMMISSION EXPIRES JANUARY 12, 1977

COPY
DEAD - FILE

THIS PLAT OF SANTA FE ORIENT INDUSTRIAL DISTRICT TO WICHITA, SEDGWICK COUNTY, KANSAS, HAS BEEN SUBMITTED TO AND APPROVED BY THE WICHITA-SEDGWICK COUNTY METROPOLITAN AREA PLANNING COMMISSION, WICHITA, KANSAS.

DATED THIS 11TH DAY OF JANUARY, 1973

Allen J. Hennessey CHAIRMAN
ALLEN J. HENNESSEY

Robert A. Lakin SECRETARY
ROBERT A. LAKIN

THIS PLAT APPROVED AND ALL DEDICATIONS SHOWN HEREON ARE ACCEPTED BY THE CITY COMMISSION OF THE CITY OF WICHITA, KANSAS, THIS 12TH DAY OF May, 1973.

James M. Donnell MAYOR
JAMES M. DONNELL

Ralph C. Eberly CITY CLERK
RALPH C. EBERLY

THIS PLAT APPROVED AND ALL DEDICATIONS SHOWN HEREON ARE ACCEPTED BY THE BOARD OF COUNTY COMMISSIONERS OF SEDGWICK COUNTY, KANSAS, THIS _____ DAY OF _____, 197__.

EARL E. RUSH CHAIRMAN

ELMER S. PETERS COMMISSIONER

ATTEST _____
TOM SCOTT COMMISSIONER

MARIE WARDEN
COUNTY CLERK

ENTERED ON TRANSFER RECORD THIS _____ DAY OF _____, 197__.

MARIE WARDEN COUNTY CLERK

THIS IS TO CERTIFY THAT THIS INSTRUMENT WAS FILED FOR RECORD IN THE REGISTER OF DEEDS OFFICE AT _____, N. ON THE _____ DAY OF _____, 197__.

JOHN HALE REGISTER OF DEEDS

PEARL G. GILBERT DEPUTY

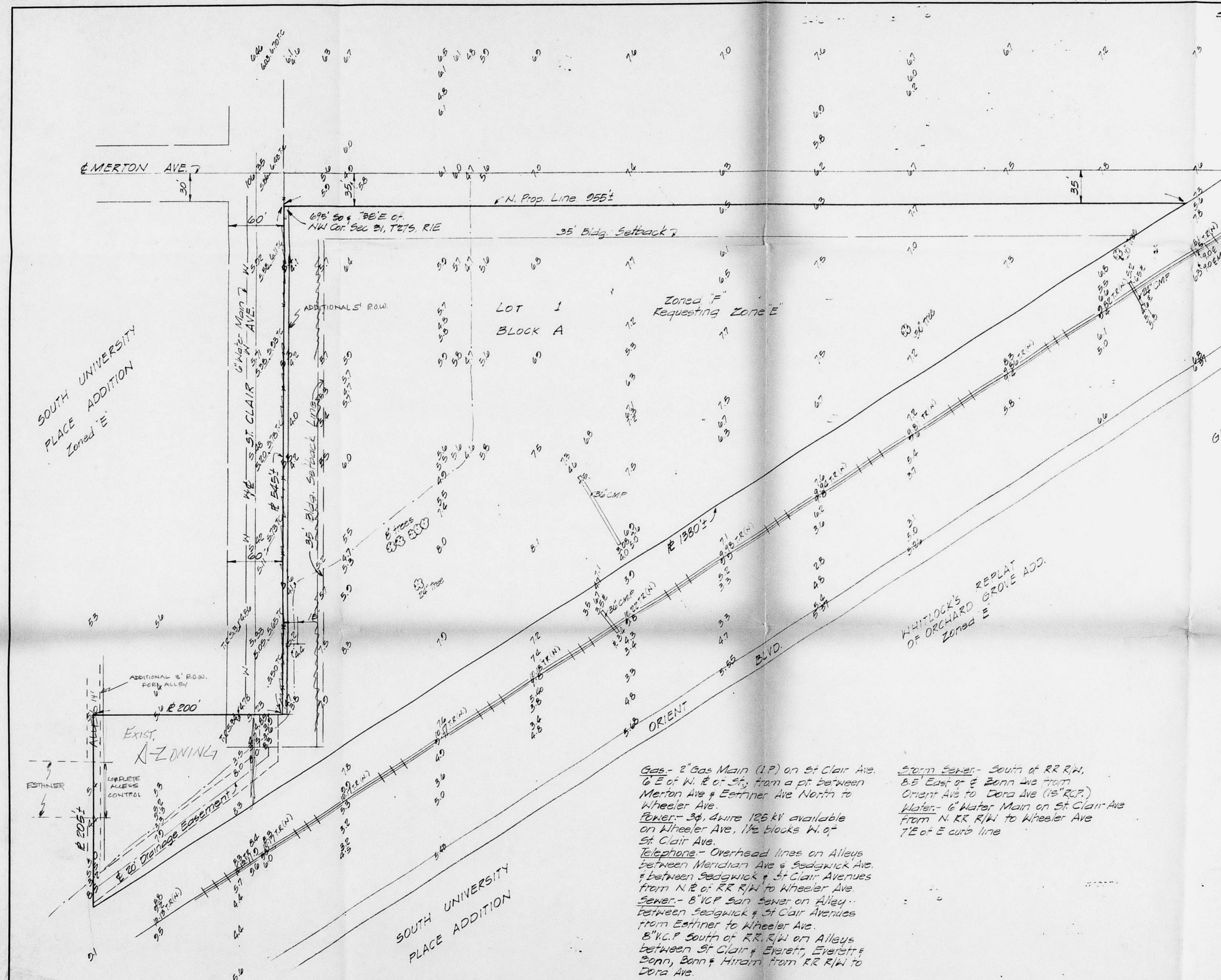

- S/D 72-126 Approved subject to:
- Approval of this plat is subject to the understanding that a zone change request for a change from "F" Heavy Ind. to "E" Light Ind. as previously agreed to by the applicant, will be filed in the future. It should also be pointed out that the SW corner of the plat lying W of the E of St. Clair is zoned the "A" 2 family classification. (It will be the recommendation of the Planning Dept. that a zone change request be filed at least for the area zoned "A" prior to the releasing of the plat for recording).
 - Subject plat proposes to vacate portions of existing platted lots, blocks, easements, etc. Therefore, abandonment or relocation of existing utilities as indicated by this plat shall be at the cost expense of the applicant.
 - An additional 5' of R.O.W. for the E 1/2 of St. Clair Ave. shall be indicated on the plat to meet the west street setback.
 - Complete access control shall be indicated along the W side of the plat on Eastman Ave.
 - Additional R.O.W. in order to provide for 15' for the E 1/2 of St. Clair Ave. adjacent to subject property on the W, shall be indicated on the plat.
 - The applicant may, if he may, shall meet with the City Eng. regarding utility design regulations for the west side of St. Clair Ave.
 - The 35' city setback from St. Clair Ave. indicated on the plat shall be adjusted appropriately from the new R.O.W. line for new street.
 - The applicant may, if he may, shall contact M.E. Mitchell of the Maintenance/Flood Control Office relative to an overall drainage plan for the applicant's entire ownership, which may require adjustments in the location of the drainage easement indicated on the SW corner of the plat.
- Scale 1" = 50'
 B.M. City Steel Brass Cap
 with 6" x 6" Steel Box & Lid at
 NW Cor. of Harry & Meridian
 Elev. 106.74 City Datum.
 Nov. 27, 1972
- The applicant shall be advised that subject property may not be included in the benefit dist. which was drawn for the existing storm sewer in the area. If this is the case subject property would not drain to the existing sewer line & other arrangements would have to be made for draining surface water from subject property.
 - The applicant shall install or guarantee the installation of all utilities and facilities which are applicable and described in Art. 8 of the MAPC Sub Reg. The applicant should be prepared to discuss with the Subdivision Committee the manner in which it is prepared to proceed for such utilities and facilities, e.g., location, actual construction, monetary guarantee, etc.
 - Requirements for a final plat (...)

Gas - 2" Gas Main (I.P.) on St. Clair Ave.
 6' E of N. & E of St. from a pt. between
 Merton Ave & Eastman Ave North to
 Wheeler Ave.
 Sewer - 36" 125 KV available
 on Wheeler Ave. 1 1/2 blocks W. of
 St. Clair Ave.
 Telephone - Overhead lines on Alleys
 between Meridian Ave & Sedgwick Ave.
 & between Sedgwick & St. Clair Avenues
 from N. E. of RR R/W to Wheeler Ave.
 Sewer - 8" VCP San Sewer on Alley
 between Sedgwick & St. Clair Avenues
 from Eastman to Wheeler Ave.
 8" VCP South of RR R/W on Alleys
 between St. Clair & Elliott, Elliott &
 Bonn, Bonn & Hiram from RR R/W to
 Dora Ave.

Storm Sewer - South of RR R/W,
 6' E of E of Bonn Ave from
 Orient Ave to Dora Ave (15" RCP)
 Water - 6" Water Main on St. Clair Ave
 from N. RR R/W to Wheeler Ave
 7' E of E curb line

Owner: Santa Fe Industrial Realty Co.
 800 So. Polk Street
 Amarillo, Texas 79109

OFFICE COPY
 DO NOT REMOVE

PRELIMINARY PLAT
 SD 72-126

PRELIMINARY PLAT
 OF
 SANTA FE ORIENT INDUSTRIAL DISTRICT
 TO
 WICHITA, SEDGWICK COUNTY, KS.

PROFESSIONAL ENGINEERING CONSULTANTS
 ENGINEERS
 WICHITA, KANSAS 1440 ENGLISH ST.

SANTA FE ORIENT INDUSTRIAL DISTRICT
TO WICHITA, SEDGWICK COUNTY, KANSAS

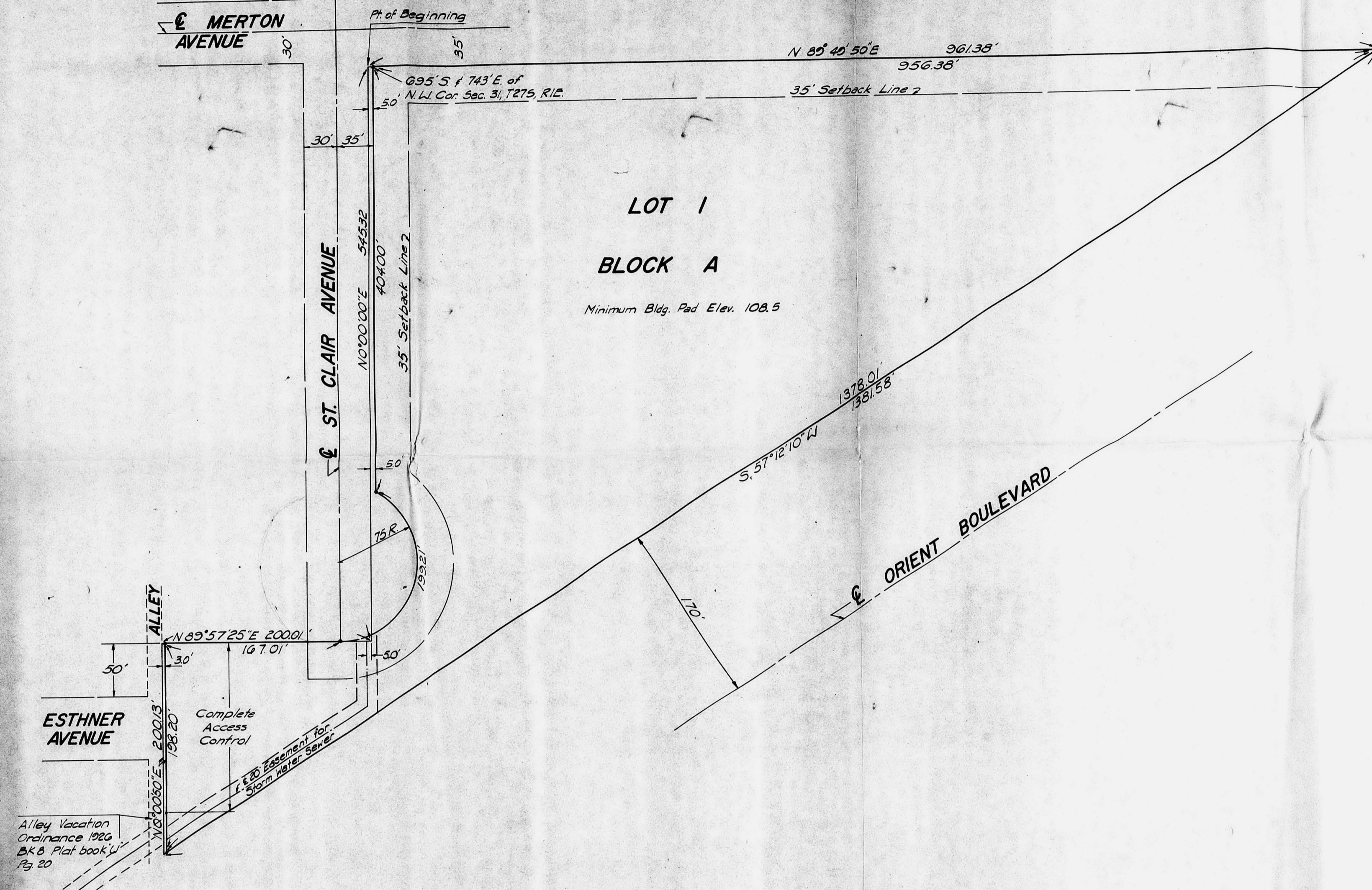

 SCALE 1"=50'
 • = Iron
 B.M. City Std. Brass Cap
 with 6" x 6" steel box & lid at
 N.W. Cor. of Harry & Mendian
 Elevation 106.74 City Datum.

Alley Vacation
 Ordinance 1986
 BK 6 Plat book
 Pg 20

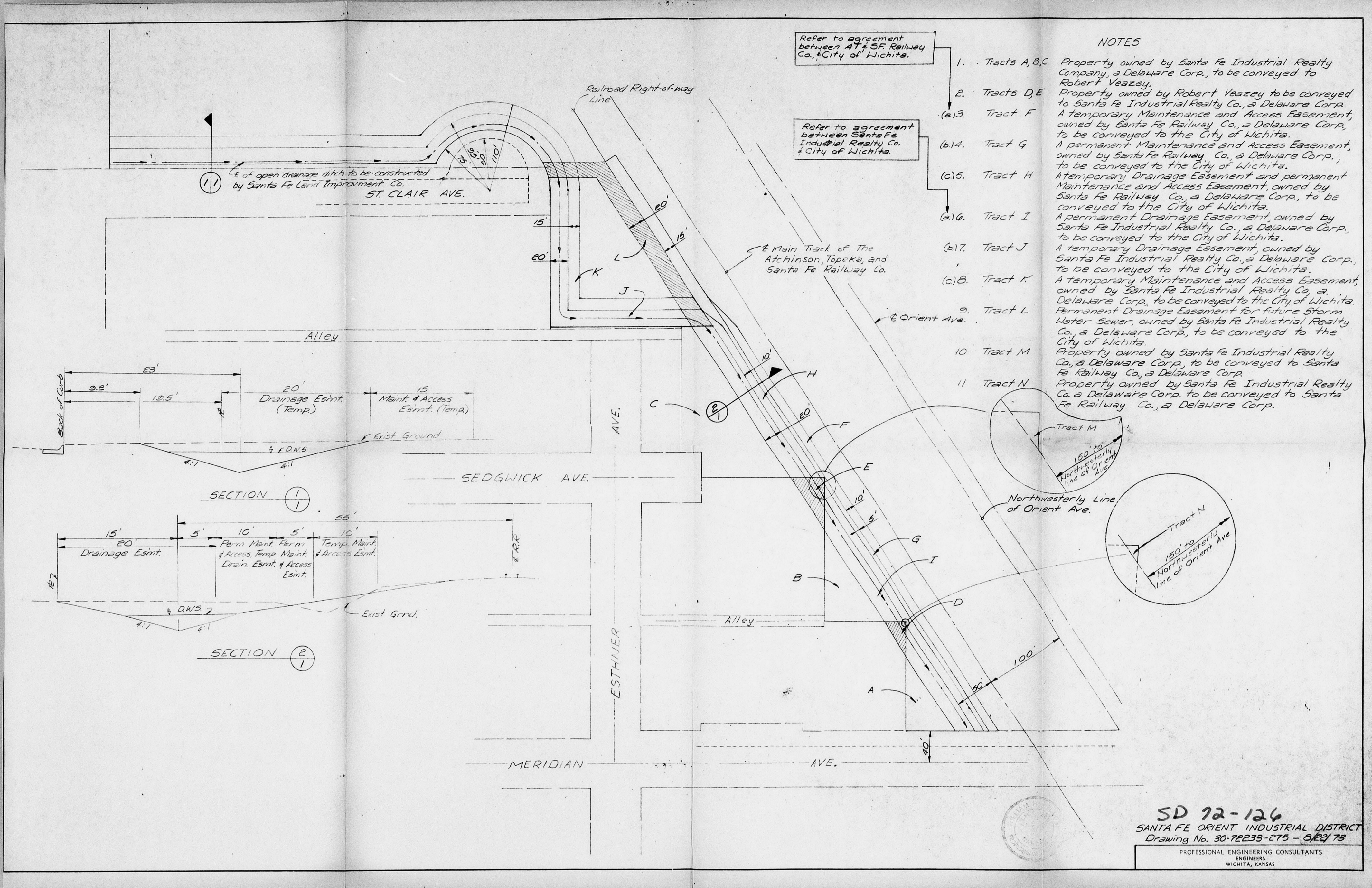

Refer to agreement between AT & SF Railway Co. & City of Wichita.

Refer to agreement between Santa Fe Industrial Realty Co. & City of Wichita.

NOTES

1. Tracts A, B, C Property owned by Santa Fe Industrial Realty Company, a Delaware Corp., to be conveyed to Robert Veazey.
2. Tracts D, E Property owned by Robert Veazey to be conveyed to Santa Fe Industrial Realty Co., a Delaware Corp.
- (a) 3. Tract F A Temporary Maintenance and Access Easement, owned by Santa Fe Railway Co., a Delaware Corp., to be conveyed to the City of Wichita.
- (b) 4. Tract G A permanent Maintenance and Access Easement, owned by Santa Fe Railway Co., a Delaware Corp., to be conveyed to the City of Wichita.
- (c) 5. Tract H A temporary Drainage Easement and permanent Maintenance and Access Easement, owned by Santa Fe Railway Co., a Delaware Corp., to be conveyed to the City of Wichita.
- (a) 6. Tract I A permanent Drainage Easement, owned by Santa Fe Industrial Realty Co., a Delaware Corp., to be conveyed to the City of Wichita.
- (a) 7. Tract J A temporary Drainage Easement, owned by Santa Fe Industrial Realty Co., a Delaware Corp., to be conveyed to the City of Wichita.
- (c) 8. Tract K A temporary Maintenance and Access Easement, owned by Santa Fe Industrial Realty Co., a Delaware Corp., to be conveyed to the City of Wichita.
9. Tract L Permanent Drainage Easement for future Storm Water Sewer, owned by Santa Fe Industrial Realty Co., a Delaware Corp., to be conveyed to the City of Wichita.
10. Tract M Property owned by Santa Fe Industrial Realty Co., a Delaware Corp., to be conveyed to Santa Fe Railway Co., a Delaware Corp.
11. Tract N Property owned by Santa Fe Industrial Realty Co., a Delaware Corp., to be conveyed to Santa Fe Railway Co., a Delaware Corp.

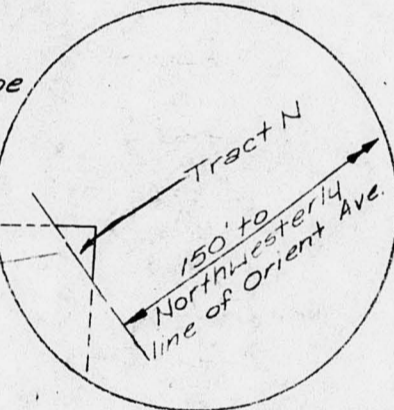
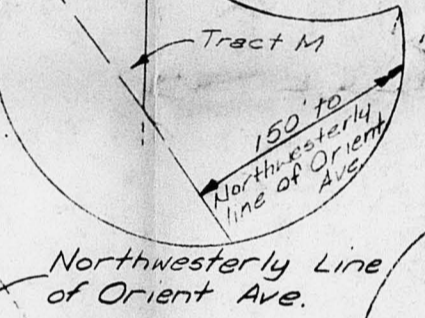

SD 72-126
 SANTA FE ORIENT INDUSTRIAL DISTRICT
 Drawing No. 30-72233-ETS - 3/27/73
 PROFESSIONAL ENGINEERING CONSULTANTS
 ENGINEERS
 WICHITA, KANSAS