

**LANDSCAPE NOTES**

1. ALL LANDSCAPE BED AREAS SHALL BE MULCHED PER LANDSCAPE SPECIFICATIONS.
2. ALL DISTURBED AREAS NOT TO BE PAVED OR MULCHED SHALL BE SEEDED UNLESS OTHERWISE NOTED ON PLAN.
3. ALL DISTURBED AREAS WITHIN THE R.O.W. NOT TO BE PAVED, SHALL BE SEEDED PER THE SPECIFICATIONS.

**LEGEND**  
(SEE SHEET C-001 FOR GENERAL LEGEND)

- EXISTING TREE TO REMAIN
- PROPOSED LANDSCAPE BED EDGE
- PROPOSED TREE
- PROPOSED SHRUB / PERENNIAL
- PROPOSED GRANITE BOULDER, DESERT SAND, 24"-36"
- PROPOSED PLANT QUANTITY AND SYMBOL
- PROPOSED SEEDED LAWN
- PROPOSED SODDED LAWN
- PROPOSED RIVER ROCK MULCH, SEE LANDSCAPE SPECIFICATIONS ON SHEET L-001
- PROPOSED IRRIGATION LIMITS

**LANDSCAPE CALCULATIONS**

CODE OF ORDINANCES, CITY OF WICHITA, KANSAS  
CHAPTER 26.06.030 - (A) REQUIRED LANDSCAPE STREET YARD

CODE REQUIREMENT:  
MULTIPLE STREET FRONTAGES (METHOD 1)  
REQUIRED LANDSCAPED STREET YARD = (TOTAL LN. FT. OF STREET FRONTAGE X SF FACTOR) FROM TABLE 2.1. ON COLLECTOR STREETS WITH INDUSTRIAL ZONING ON BOTH SIDES OF THE STREET, THE REQUIREMENT FOR A LANDSCAPED STREET YARD SHALL BE AUTOMATICALLY WAIVED.

PROVIDED:  
SOUTH ACCESS DR: (WAIVED)  
GREENWICH RD:  
4,950 SQ. FT. OF LANDSCAPED STREET YARD  
29TH ST N:  
3,850 SQ. FT. OF LANDSCAPED STREET YARD

PROJECT REQUIREMENT:  
SOUTH ACCESS DR: (WAIVED)  
GREENWICH RD:  
220 (TOTAL LN. FT. OF STREET FRONTAGE) X 8 (SQ. FT. FACTOR FROM TABLE 2.1) = 1,760 SQ. FT. OF LANDSCAPED STREET YARD  
29TH ST N:  
160 (TOTAL LN. FT. OF STREET FRONTAGE) X 8 (SQ. FT. FACTOR FROM TABLE 2.1) = 1,280 SQ. FT. OF LANDSCAPED STREET YARD

CODE OF ORDINANCES, CITY OF WICHITA, KANSAS  
CHAPTER 26.06.030 - (B) MIN. NUMBER OF TREES WITHIN STREET YARDS

CODE REQUIREMENT:  
THERE SHALL BE A MIN. OF 1 SHADE TREE OR 2 ORNAMENTAL TREES FOR EVERY 500 SQ. FT. OR FRACTION THEREOF OF THE REQUIRED MINIMUM LANDSCAPED STREET YARD.

PROVIDED:  
SOUTH ACCESS DR: (WAIVED)  
GREENWICH RD:  
4 PROPOSED SHADE TREES  
29TH ST N:  
3 PROPOSED SHADE TREES

PROJECT REQUIREMENT:  
SOUTH ACCESS DR: (WAIVED)  
GREENWICH RD:  
1,760 SQ. FT. OF LANDSCAPED STREET YARD / 500 = 3.52  
3.52 X (1) SHADE TREES = 3.52 REQUIRED SHADE TREES OR  
3.52 X (2) ORNAMENTAL TREES = 7.04 ORNAMENTAL TREES  
29TH ST N:  
1,280 SQ. FT. OF LANDSCAPED STREET YARD / 500 = 2.56  
2.56 X (1) SHADE TREES = 2.56 REQUIRED SHADE TREES OR  
2.56 X (2) ORNAMENTAL TREES = 5.12 REQUIRED ORNAMENTAL TREES

CODE OF ORDINANCES, CITY OF WICHITA, KANSAS  
CHAPTER 26.06.050 - PARKING LOT SCREENING AND LANDSCAPING

CODE REQUIREMENT:  
ALL NEW PARKING LOTS SHALL BE CONTINUOUSLY SCREENED TO A MIN. HT. OF 3 FT. WITH FOLLOWING EXEMPTIONS: OPEN PARKING LOTS IN INDUSTRIAL DISTRICTS LOCATED ON COLLECTOR STREETS WITH INDUSTRIAL ZONING ON BOTH SIDES OF THE STREET.  
ON CORNER LOTS WHERE PARKING IS WITHIN 150 FT. OF 2 OR MORE STREETS BUT NOT ALL THE STREET FRONTAGES REQUIRED PARKING LOT SCREENING, THE PARKING LOT SCREENING SHALL WRAP AROUND THE CORNER OF THE LOT FROM THE FRONTAGE WHICH DOES REQUIRE SCREENING.

PROVIDE 1 SHADE TREE OR 2 ORNAMENTAL TREES FOR EACH 20 PARKING SPACES (UP TO 1/2 OF ALL TREES REQUIRED BY THE LANDSCAPED STREET YARD CALCULATIONS MAY BE USED TO SATISFY THESE PARKING LOT LANDSCAPING REQUIREMENTS), THESE TREES SHALL BE LOCATED WITHIN AND AROUND THE PARKING LOT.

PROJECT REQUIREMENT:  
26 PARKING SPACES / 20 = 1.3 REQ. SHADE TREES FOR PARKING LOT (1/2 OF THE STREET YARD TREES MAY BE USED TO FULFILL PARKING LOT TREE REQUIREMENT)  
(HALF OF 7 SHADE TREES=UP TO 3.5 ST. YARD TREES MAY BE COUNTED AS PARKING LOT TREES

CODE OF ORDINANCES, CITY OF WICHITA, KANSAS  
CHAPTER 26.06.060 - PERCENTAGE OF LIVING MATERIALS

CODE REQUIREMENT:  
REQUIRED LANDSCAPE AREA SHALL CONSIST OF A MIN. OF 55% IN GROUND, NO MORE THAN 75% OF LANDSCAPED AREA SHALL BE COVERED BY TURF GRASSES.

PROVIDED:  
PLANT MATERIAL = 3,261 SF OF PLANT MATERIAL (107%) PROVIDED  
GRASS AREA = 8,373 SF (72%)

PROJECT REQUIREMENT:  
REQUIRED LANDSCAPE AREAS = 3,040 SF  
PLANT MATERIAL = 3,040 X 55% = 1,672 SF MIN. PLANT MATERIAL AREA  
TOTAL LANDSCAPED AREA = 11,635 SF X 75% = 8,725 SF MAX

**PLANT LIST**

SYMBOL	BOTANICAL NAME	COMMON NAME	QTY.	MIN. SIZE	CONDITION	REMARKS
Dg	Devilza gracilis	Slender Devilza	21	No. 5, 24" HL Min.	Cont.	4' o/c
Gb	Ginkgo biloba 'Princeton Sentry'	'Princeton Sentry' Ginkgo	2	2" Cal.	B&B	Specimen
Hb	Hemerocallis 'Going Bananas'	'Going Bananas' Daylily	41	No. 2	Cont.	2' o/c
Jc	Juniperus chinensis 'Gold Coast'	'Gold Coast' Juniper	32	No. 5, 24" HL Min.	Cont.	5' o/c
Jp	Juniperus x pfitzeriana 'Pfitzeriana Compacta'	Compact Pfitzer Juniper	4	No. 5	Cont.	5' o/c
Pf	Potentilla fruticosa 'Abbots Wood'	Abbots Wood Potentilla	10	No. 5, 24" HL Min.	Cont.	3.5' o/c
Sa	Spiraea bumalda 'Anthony Waterer'	'Anthony Waterer' Spirea	11	No. 3, 18" HL Min.	Cont.	4' o/c
Sb	Spiraea bumalda 'Goldflame'	'Goldflame' Spirea	46	No. 3, 18" HL Min.	Cont.	3' o/c
Yf	Yucca filamentosa 'Color Guard'	Color Guard Yucca	1	No. 3	Cont.	Per Plan
Zs	Zelkova serrata 'Village Green'	'Village Green' Zelkova	7	2" Cal.	B&B	Specimen

**LANDSCAPE PLAN**

APPROVED 4/20/25 BY [Signature]

P.O.#13 1 of 2

"This submittal is for general informational purposes only and is preliminary in nature. As such, any other use or reliance is strictly prohibited."



520 South Main Street, Suite 2531  
Alton, OH 44311  
330.572.2100 Fax 330.572.2101



DATE	REMARKS

CONTRACT DATE: 1.16.25  
BUILDING TYPE: END. MED 40  
PLAN VERSION: MARCH 2021  
BRAND DESIGNER: WANCHO  
SITE NUMBER: 317766  
STORE NUMBER: 204188.16  
P/PM: AB  
DRAWN BY: JRS  
JOB NO.: 2024188.16

**TACO BELL**  
29TH ST & GREENWICH RD  
WICHITA, KS 67226



**LANDSCAPE PLAN**  
**L-101**

PLOT DATE:

LANDSCAPE NOTES & PLANTING SPECIFICATIONS

**SCOPE OF WORK**

- THIS WORK SHALL CONSIST OF PERFORMING CLEARING AND GRUBBING, SOIL PREPARATION, FINISH GRADING, PLANTING AND DRAINAGE, INCLUDING ALL LABOR, MATERIALS, TOOLS, EQUIPMENT, AND ANY OTHER APPURTENANCES NECESSARY FOR THE COMPLETION OF THIS PROJECT.
- QUANTITY TAKEOFF IS SUPPLIED FOR CONTRACTOR'S ASSISTANCE ONLY. CONTRACTOR IS RESPONSIBLE FOR SUPPLYING ALL PLANT MATERIALS AS PER PLAN.
- NO ADDITIONAL COMPENSATION SHALL BE PAID TO THE CONTRACTOR FOR DAMAGE AND REPAIR WITHIN EASEMENT OR RIGHT-OF-WAY LIMITS.

**PRESERVATION/PROTECTION (IF APPLICABLE)**

- CONTRACTOR SHALL MAINTAIN AND PRESERVE TREES AND SHRUBS NOT BEING REMOVED, INCLUDING THEIR ROOTS. TREE PROTECTION FENCING SHALL BE USED AT THE DRIP LINE OF ALL TREES AND SHRUBS WITHIN 50 FEET OF CONSTRUCTION EXCEPT AS SHOWN ON PLAN. FENCING SHALL REMAIN IN PLACE UNTIL FINAL PLANT INSPECTION FOLLOWING CONSTRUCTION. MATERIALS SHALL NOT BE STOCKPILED WITHIN THIS DEFINED AREA AND VEHICLES AND OTHER EQUIPMENT SHALL BE OPERATED TO AVOID SOIL COMPACTION.
- FEEDER ROOTS SHOULD NOT BE CUT IN AN AREA EQUAL TO TWICE THE TREE CIRCUMFERENCE (MEASURED 6" ABOVE THE GROUND LINE IN INCHES) EXPRESSED IN FEET. (EXAMPLE: A CIRCUMFERENCE OF 10" WOULD HAVE A 'NO CUT' ZONE OF 20 FEET IN ALL DIRECTIONS FROM THE TREE). THIS SHOULD APPLY TO UTILITY SERVICES, IF FEASIBLE. THE ONLY EXCEPTION TO THIS REQUIREMENT WILL BE THOSE SPECIFICALLY ALLOWED BY THE LANDSCAPE ARCHITECT, SPECIFICATIONS OR AS INDICATION ON THE PLANS.
- TREE TRUNKS AND EXPOSED ROOTS DAMAGED DURING EQUIPMENT OPERATIONS SHALL BE TREATED IN ACCORDANCE WITH THE ARBOR CULTURAL STANDARDS OF THE CITY.

**PLANT MATERIALS**

- GENERAL - ALL MATERIALS SHALL BE OF ITS KIND AVAILABLE AND SHALL HAVE BEEN GROWN IN A CLIMATE SIMILAR TO THAT ON SITE.
- PLANTS - ALL PLANTS SHALL BE HEALTHY, OF NORMAL GROWTH, WELL ROOTED, FREE FROM DISEASE AND INSECTS. QUALITY AND SIZE OF PLANT MATERIAL SHALL CONFORM TO ANSI Z60.1 "AMERICAN STANDARDS FOR NURSERY STOCK".
- VARIETIES AND SIZES OF PLANTS SHALL BE AS SHOWN ON DRAWINGS.
- PLANTS SHALL BE IN A HEALTHY, VIGOROUS CONDITION, FREE OF DEAD OR BROKEN BRANCHES, SCARS THAT ARE NOT COMPLETELY HEALED, FROST CRACKS, DISFIGURING KNOTS, BROKEN OR ABRADED BARK, REDUNDANT LEADERS OR BRANCHES, OR ABERATIONS OF ANY KIND. PLANTS SHALL NOT HAVE MULTIPLE LEADERS, UNLESS THIS IS THE NATURAL FORM.
- BALLED AND BURLAPPED (B&B) PLANTS SHALL BE DUG WITH A FIRM ROOT BALL OF NATURAL EARTH, OF A SIZE IN PROPORTION TO THE PLANTS SIZE, AS MEASURED BY CALIPER, HEIGHT, OR SPREAD. BALLED AND BURLAPPED PLANTS SHALL BE HANDLED ONLY BY THE ROOT BALL, NOT BY THE TRUNK OR BRANCHES, AS THIS MAY BREAK OR LOOSEN THE ROOT BALL AND DAMAGE THE ROOT SYSTEM. CONTAINER PLANTS SHALL HAVE BEEN ESTABLISHED FOR A MINIMUM OF ONE FULL GROWING SEASON IN THEIR CONTAINERS BEFORE INSTALLATION. CONTAINER PLANTS SHALL BE HANDLED ONLY BY THE CONTAINER, NOT BY THE STEMS OR BRANCHES, AS THIS MAY PULL THE PLANT OUT OF THE CONTAINER AND BREAK OR LOOSEN THE ROOT BALL AND DAMAGE THE ROOT SYSTEM.
- PLANTS SHALL BE PROTECTED FROM DRYING OUT DURING SHIPPING WITH TARPULLINS OR OTHER COVERINGS. PLANTS SHALL BE PROTECTED FROM DRYING OUT AFTER DELIVERY BY PLANTING IMMEDIATELY; IF THIS IS NOT POSSIBLE, THE ROOT BALL SHALL BE COVERED WITH PEAT MOSS OR EARTH, AND WATERED FREQUENTLY TO KEEP IT MOIST UNTIL PLANTING.
- DO NOT HANDLE, MOVE, BIND, TIE OR OTHERWISE TREAT PLANTS SO AS TO DAMAGE THE ROOT BALL, ROOTS, TRUNK, OR BRANCHES IN ANY WAY.

**TOPSOIL**

- TOPSOIL HAS BEEN (OR WILL BE) STOCKPILED FOR REUSE IN LANDSCAPE WORK. IF QUANTITY OF STOCKPILED TOPSOIL IS INSUFFICIENT, PROVIDE ADDITIONAL TOPSOIL AS REQUIRED TO COMPLETE LANDSCAPE WORK. IMPORTED TOPSOIL SHALL CONSIST OF LOOSE, FRIABLE, LOAMY TOPSOIL WITHOUT ADMIXTURE OF SUBSOIL OR REFUSE. ACCEPTABLE TOPSOIL SHALL CONTAIN NOT LESS THAN 3 PERCENT NOR MORE THAN 20 PERCENT ORGANIC MATTER.
- PLANTING BACKFILL FOR PARKING LOT ISLANDS SHALL CONSIST OF A HOMOGENEOUS MIXTURE OF 3 PARTS TOPSOIL TO ONE PART SPAGNUM PEAT INSTALLED OVER A 6" THICKNESS OF NO. 57 AGGREGATE.

**SOIL CONDITIONING**

- OBTAIN LABORATORY ANALYSIS OF STOCKPILED AND IMPORTED TOPSOIL COMPLETE WITH RECOMMENDATIONS FOR SOIL AMENDMENT.
- BEFORE MIXING, CLEAN TOPSOIL OF ROOTS, PLANTS, SOD, STONES, CLAY LUMPS, AND OTHER EXTRANEOUS MATERIALS HARMFUL OR TOXIC TO PLANT GROWTH.
- MIX SPECIFIED SOIL AMENDMENTS AND FERTILIZERS WITH TOPSOIL AT RATES SPECIFIED BY THE LAB REPORT. DELAY MIXING OF FERTILIZER IF PLANTING WILL NOT FOLLOW PLACING OF PLANTING SOIL WITHIN A FEW DAYS.
- FOR PLANTING BEDS AND LAWNS, MIX PLANTING SOIL EITHER PRIOR TO PLANTING OR APPLY ON SURFACE OF TOPSOIL AND MIX THOROUGHLY BEFORE PLANTING. MIX LIME WITH DRY SOIL PRIOR TO MIXING OF FERTILIZER.
- PREVENT LIME FROM CONTACTING ROOTS OF ACID-LOVING PLANTS.
- APPLY PHOSPHORIC ACID FERTILIZER (OTHER THAN THAT CONSTITUTING A PORTION OF COMPLETE FERTILIZERS) DIRECTLY TO SUBGRADE BEFORE APPLYING PLANTING SOIL AND TILLING.

**PLANTING SOIL**

- PLANTING SOIL MIX SHALL BE CLEAR OF ALL STONES AND DEBRIS 1" OR LARGER, AND CONSIST OF THE FOLLOWING: 25% ORGANIC COMPOST, 75% ACCEPTABLE TOPSOIL.

**OTHER MATERIALS**

- BED EDGING - EDGING SHALL BE 4" STEEL EDGING WITH THREE (3) METAL ANCHOR STAKES PER 20 FOOT SECTION. ALL MASS PLANTING BEDS SHALL HAVE EDGING PLACED BETWEEN MULCH AND ANY ADJACENT LAWN.
- MULCH: ORGANIC MULCH FREE FROM DELETERIOUS MATERIALS AND SUITABLE FOR TOP DRESSING OF TREES, SHRUBS, OR PLANTS AND CONSISTING OF THE FOLLOWING:
  - RIVER ROCK MULCH: AGGREGATE MULCH, 3/4"-2" IN SIZE, WASHED AND ROUNDED, SHALL BE INSTALLED PER PLAN. RIVER ROCK MULCH SHALL BE INSTALLED AT 3" INCHES DEPTH.
  - NON-DYED, DOUBLE SHREDDED HARDWOOD SHALL BE INSTALLED IN ALL OTHER LANDSCAPE BEDS OUTSIDE OF THE RIVER ROCK MULCH AREA AT A DEPTH OF 3 INCHES.
  - WEED BARRIER - POLYETHYLENE FILTER FABRIC DESIGNED TO PERMIT WATER INFILTRATION WHILE PREVENTING WEED GROWTH TO BE INSTALLED IN ALL PLANTING BEDS.

**GENERAL WORK PROCEDURES**

- LANDSCAPE WORK SHALL BE ACCORDING TO THE WORKMANLIKE STANDARDS ESTABLISHED FOR LANDSCAPE CONSTRUCTION AND PLANTING IN THE KANSAS STANDARDIZED LANDSCAPE SPECIFICATIONS (ASLA) AND ANY LOCAL LANDSCAPE ORDINANCES.
- CONTRACTOR SHALL OBTAIN A COPY OF LOCAL ORDINANCES REGARDING ACCEPTABLE PLANT AND PLANTING DETAILS AND ABIDE BY THOSE ORDINANCES AND DETAILS.
- ENGINEER RESERVES THE RIGHT TO REJECT ALL PLANT MATERIAL DEEMED NOT ACCEPTABLE.
- ANY PROPOSED PLANT SUBSTITUTIONS SHALL BE EQUIVALENT IN FORM, HABIT, STRUCTURE, BRANCHING AND LEAF TYPE AND MUST BE ISSUED TO THE LANDSCAPE ARCHITECT FOR APPROVAL, IN WRITING, PRIOR TO INSTALLATION.

**WEEDING**

- BEFORE AND DURING PRELIMINARY GRADING AND FINISH GRADING, ALL WEEDS AND GRASSES SHALL BE DUG OUT BY THE ROOTS AND DISPOSED OF AT THE CONTRACTOR'S EXPENSE.

**PLANTING**

- POSITION TREES AND SHRUBS AT THEIR INTENDED LOCATIONS AS PER THE PLANS AND SECURE THE APPROVAL OF THE OWNER BEFORE EXCAVATING PITS, MAKING NECESSARY ADJUSTMENTS AS DIRECTED.
- PLANTING PITS SHALL BE AS PER DETAILS.
- PREPARED SOIL SHALL BE TAMPED FIRMLY AT BOTTOM OF PIT, FILL WITH PLANTING SOIL AROUND BALL OF PLANT. COMPLETE BACKFILLING AND WATER THOROUGHLY.
- EACH TREE AND SHRUB SHALL RECEIVE THE LANDSCAPER'S BIO-NUTRITION (3-0-3) GRANULAR WITH MYCORRHIZAL TECHNOLOGY FERTILIZER OR APPROVED OTHER. APPLY FERTILIZER PER MANUFACTURER'S SPECIFICATIONS.
- WATER IMMEDIATELY AFTER PLANTING. WATER SHALL BE APPLIED TO EACH TREE AND SHRUB IN SUCH MANNER AS NOT TO DISTURB BACKFILL AND TO THE EXTENT THAT ALL MATERIALS IN THE PLANTING HOLE ARE THOROUGHLY SATURATED.
- INSTALL BED EDGING AND MULCH PER MATERIALS SPECIFICATION AND DETAILS.
- REMOVE ALL SALES TAGS, STRINGS, STRAPS, WIRE, ROPE OR OTHER MATERIALS THAT MAY INHIBIT PLANT GROWTH BOTH ABOVE AND BELOW THE SURFACE OF THE SOIL.
- REMOVE ANY BROKEN, SUCKERING, DISEASED, CRISSCROSSED OR AESTHETICALLY DISPLEASING BRANCHES BACK TO LIVE LEADER OR SIDE LATERAL WITH A FLUSH CUT.

**FINISH GRADING**

- ALL AREAS WILL BE GRADED BY THE CONTRACTOR TO SUBSTANTIALLY PLUS/MINUS 0.1 FOOT OF FINISH GRADE.
- ALL LAWN AND PLANTING AREAS SHALL BE GRADED TO A SMOOTH, EVEN, UNIFORM PLANE WITH NO ABRUPT CHANGE OF SURFACE. SOIL AREAS ADJACENT TO THE BUILDINGS SHALL SLOPE AWAY FROM THE BUILDINGS.
- ALL PLANTING AREAS SHALL BE GRADED AND MAINTAINED TO ALLOW FREE FLOW OF SURFACE WATER.
- PARKING LOT ISLAND SHALL BE BACKFILLED AS PART OF THIS CONTRACT.

**GUARANTEE**

- CONTRACTOR SHALL GUARANTEE ALL PLANTS FOR A PERIOD OF ONE (1) YEAR FROM DATE OF PROJECT ACCEPTANCE BY THE OWNER.

**CLEANUP**

- UPON THE COMPLETION OF ALL PLANTING WORK AND BEFORE FINAL ACCEPTANCE, THE CONTRACTOR SHALL REMOVE ALL MATERIAL, EQUIPMENT, AND DEBRIS RESULTING FROM HIS WORK. AN 'ACCEPTABLE CONDITION' SHALL BE AS DEFINED AND APPROVED BY THE OWNER'S AUTHORIZED REPRESENTATIVE.

**IRRIGATION**

- CONTRACTOR SHALL PROVIDE & INSTALL AN IRRIGATION SYSTEM TO PROVIDE 100% COVERAGE OF THE PROPOSED IRRIGATION LIMITS PER PLAN.
- IRRIGATED AREAS WITHIN 5 FEET OF BUILDING WALLS SHALL BE IRRIGATED BY DRIP IRRIGATION OR SIMILAR. CONTRACTOR SHALL ENSURE BUILDING WALLS AND WINDOWS WILL NOT BE DAMAGED OR STAINED BY IMPROPER IRRIGATION INSTALLATION OR POOR SELECTION OF FIXTURES.
- SYSTEM SHALL INCLUDE ALL SPRINKLER FIXTURES, DRIP TUBING, PIPING, VALVES, WIRING AND CONTROLS TO PROVIDE A COMPLETE FUNCTIONAL SYSTEM THAT SHALL COMPLY WITH CITY CODE.
- IRRIGATION CONTRACTOR SHALL PROVIDE A METHOD FOR WINTERIZATION. WINTERIZATION SHALL BE PERFORMED BY CONTRACTOR UPON COMPLETION IF SYSTEM IS INSTALLED BETWEEN NOVEMBER 1 AND MARCH 31.
- PRIOR TO UPDATING THE IRRIGATION SYSTEM, A CERTIFIED IRRIGATION DESIGNER SHALL PROVIDE SHOP DRAWINGS TO ENGINEER FOR APPROVAL.
- UPON APPROVAL OF SHOP DRAWINGS, THE UPDATED IRRIGATION SYSTEM SHALL BE APPROVED BY OWNER FOR FINAL ACCEPTANCE.

**MAINTENANCE**

(MAINTENANCE PERIOD TO COMMENCE AFTER FINAL INSPECTION.)

- MAINTENANCE PERIOD FOR THIS CONTRACT SHALL BE 90 CALENDAR DAYS COMMENCING AFTER FINAL INSPECTION OF CONSTRUCTION.
- MAINTAIN TREES, SHRUBS AND OTHER PLANTS BY PRUNING, CULTIVATING AND WEEDING AS REQUIRED FOR HEALTHY GROWTH. RESTORE PLANTING SAUCERS, RESET TREES AND SHRUBS TO PROPER GRADES OR VERTICAL POSITION AS REQUIRED.
- MAINTAIN LAWNS BY WATERING, MOWING, TRIMMING, AND OTHER OPERATIONS SUCH AS ROLLING, REGRADING AND REPLANTING AS REQUIRED TO ESTABLISH A SMOOTH, ACCEPTABLE LAWN, FREE OF ERODED OR BARE AREAS.
- MAINTAIN THE LANDSCAPING BY KEEPING ALL PLANTS DISEASE-FREE AND PLANTING BEDS GROOMED, EXCEPT IN NATURALLY OCCURRING VEGETATION AREAS.
- REPLACE ANY REQUIRED PLANTING(S), WHICH SEVERELY DECLINE OR DIE AFTER THE DATE OF PLANTING. SUCH REPLACEMENT SHALL OCCUR DURING THE NEXT APPROPRIATE PLANTING SEASON.

**SODDING**

- SOD SHALL BE FIRST GRADE APPROVED CERTIFIED TALL FESCUE BLEND OF THE FOLLOWING CONTAINING NOT MORE THAN 30 PERCENT OF OTHER GRASSES AND CLOVERS, AND FREE FROM ALL NOXIOUS WEEDS.
- SOD SHALL BE RECENTLY MOWED TO A HEIGHT OF NOT LESS THAN 1.5 INCHES. IT SHALL BE CUT INTO STRIPS OF NOT LESS THAN 3 FEET AND NOT OVER 6 FT. WITH A UNIFORM WIDTH OF NOT OVER 24 INCHES.
- SOD SHALL BE CUT TO A DEPTH EQUAL TO THE GROWTH OF THE FIBROUS ROOTS BUT IN NO CASE LESS THAN 1 INCH.
- SOD SHALL BE DELIVERED TO THE JOB WITHIN 24 HOURS AFTER BEING CUT AND SHALL BE INSTALLED WITHIN 48 HOURS AFTER BEING CUT.
- BEFORE SOD IS PLACED, THE SOD BED WILL HAVE BEEN EXCAVATED TO SUCH A DEPTH THAT WHEN THE SOD IS IN PLACE THE TOP OF THE SOD WILL BE FLUSH WITH THE SURROUNDING GRADE.
- NO SOD SHALL BE PLACED WHEN THE TEMPERATURE IS BELOW 32 DEGREES F. NO FROZEN SOD SHALL BE PLACED NOR SHALL ANY SOD BE PLACED ON FROZEN SOIL. WHEN SOD IS PLACED BETWEEN THE DATES OF JUNE 1ST AND OCTOBER 15TH, IT SHALL BE COVERED IMMEDIATELY WITH A STRAW MULCH 1 INCH THICK (LOOSE MEASUREMENT).
- AFTER LAYING, THE SOD SHALL BE WATERED THOROUGHLY AND TAMPED WITH APPROVED SOD TAMPERS SUFFICIENTLY TO BRING THE SOD INTO CLOSE CONTACT WITH THE SOD BED AND INSURE TIGHT JOINTS BETWEEN THE SECTIONS OR STRIPS.
- LAY SOD WITH STAGGERED JOINTS AND WITH SEAMS TIGHTLY FITTED TOGETHER. DO NOT COVER ANY UTILITIES.
- STAKE SOD ON GRADES EXCEEDING 4:1 AND IN DRAINAGE CHANNELS. STAKE EACH ROLL AT 2 FOOT INTERVALS OR AS REQUIRED TO PREVENT MOVEMENT DURING RAIN EVENTS.
- THE CONTRACTOR SHALL KEEP ALL SODDED AREAS INCLUDING SUBGRADE, THOROUGHLY MOIST FOR 30 DAYS AFTER SODDING.
- THE CONTRACTOR SHALL REPAIR ANY AREAS DAMAGED FOLLOWING INSTALLATION AS DIRECTED BY THE ENGINEER. SOD SHALL BE IN PLACE AT LEAST 30 DAYS BEFORE FINAL ACCEPTANCE.

**SEEDING**

- GRASS SEED SHALL BE FRESH, CLEAN, DRY, NEW-CROP SEED COMPLYING WITH THE ASSOCIATION OF OFFICIAL SEED ANALYSTS "RULES FOR TESTING SEEDS" FOR PURITY AND GERMINATION TOLERANCES.
- ALL AREAS TO BE SEEDED SHALL RECEIVE NO LESS THAN 5 - 8 POUNDS OF SEED PER ONE THOUSAND SQUARE FEET. APPLY SEED AND PROTECT WITH STRAW MULCH AS REQUIRED FOR NEW LAWNS.
- GRASS SEED MIX SHALL CONSIST OF THREE VARIETIES OF TALL FESCUE GRASS (FESTUCA ARUNDINACEA).

**GENERAL NOTE**

- ALL AREAS DISTURBED BY CONSTRUCTION THAT ARE WITHIN THE RIGHT-OF-WAY SHALL BE FINE GRADED TO MAINTAIN POSITIVE DRAINAGE. HAVE A 6" LAYER OF TOPSOIL APPLIED AND BE SEEDED ACCORDING TO SPECIFICATIONS ON THIS SHEET.

**PLANTING SCHEDULE**

- ALL PLANTING IS RECOMMENDED TO BE DONE WITHIN THE FOLLOWING DATES. WHEN PLANTING OUTSIDE THESE DATES, WRITTEN DOCUMENTATION SHALL BE PROVIDED THAT SURVIVAL OR REPLACEMENT WILL BE ENSURED. NO PLANTING SHALL BE DONE IN FROZEN SOIL.

NORMAL PLANTING SEASONS	SPRING	FALL
ALL TREES AND SHRUBS	MARCH 15 - MAY 15	SEPT. 15 - DEC. 1
EVERGREENS	APRIL 1 - MAY 15	SEPT. 15 - NOV. 15
GROUNDCOVERS	APRIL 1 - JUNE 1	WHEN SOO IS WORKABLE
SEED AND MULCH	APRIL 1 - MAY 15	SEPT. 15 - NOV. 15

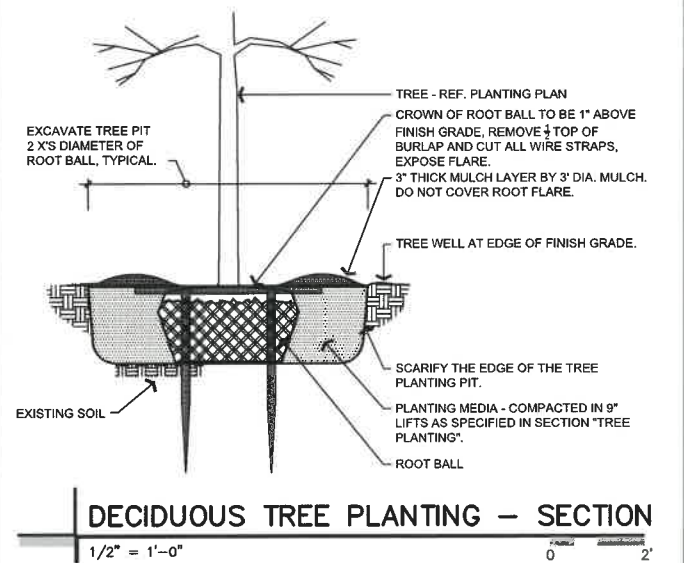
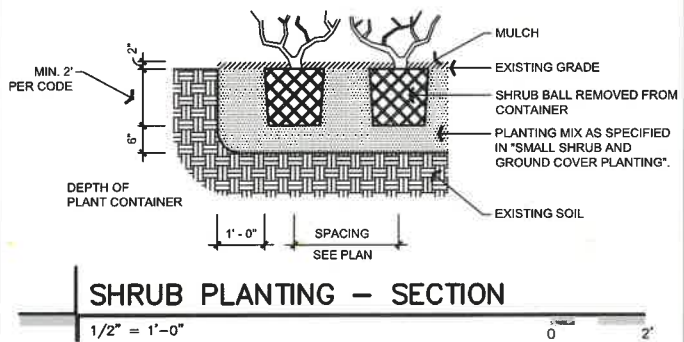
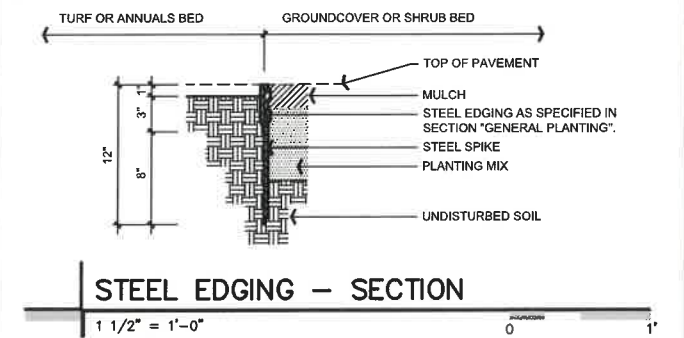
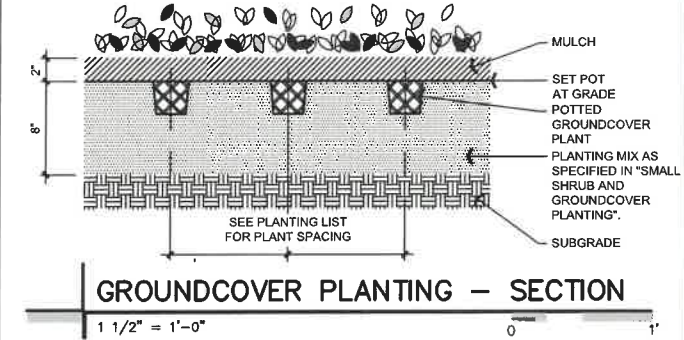

LANDSCAPE PLAN

APPROVED 4/28/25  
P.O.#13 2-12

"This submittal is for general informational purposes only and is preliminary in nature. As such, any other use or reliance is strictly prohibited."



DATE	REMARKS

CONTRACT DATE:	1.16.25
BUILDING TYPE:	END. MED 40
PLAN VERSION:	MARCH 2021
BRAND DESIGNER:	WANCHO
SITE NUMBER:	317766
STORE NUMBER:	204188.16
PA/PM:	AB
DRAWN BY:	JRS
JOB NO.:	2024188.16

TACO BELL  
29TH ST & GREENWICH RD  
WICHITA, KS 67226



LANDSCAPE NOTES & DETAILS  
L-001

PLOT DATE: