

E. KELLOGG DRIVE
PUBLIC - CONCRETE ROADWAY - VARIABLE R/W

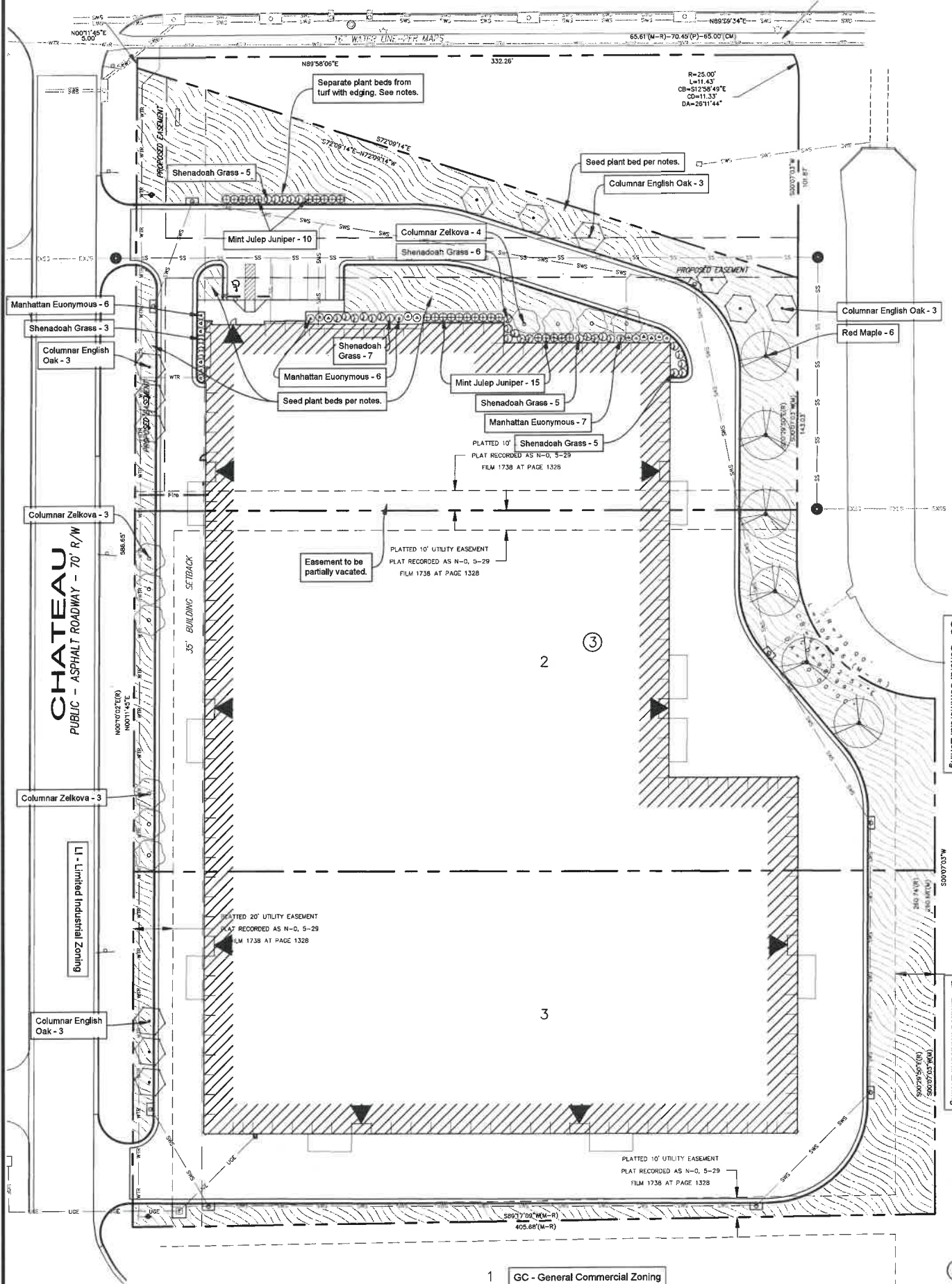

LEGAL DESCRIPTION

Lots 1, 2, and 3, Block 3, K.T. Wiedemann Business Park, Wichita, Sedgwick County, Kansas.

SITE INFORMATION

Total Area: ±216,993 sq. ft. (4.98 acres)
Disturbed Area: ±197,261 sq. ft. (4.53 acres)
Impervious Area, pre-const: ±0 sq. ft. (0.00 acres)
Impervious Area, post-const: ±156,432 sq. ft. (3.59 acres)

KANSAS ONE CALL

Contractor shall be required to provide notice to Kansas One Call at 287-2470 a minimum of three (3) working days prior to any excavation or work adjacent to utilities.
Kansas One Call 1-800-DIG-SAFE

LANDSCAPE CALCULATIONS

Note: CUP DP-88 applies to this site.

STREET YARD: KELLOGG DRIVE & CHATEAU STREET

Total Street Frontage: 938 LF
Avg. Lot Depth: 435
Street Yard Factor: 20 SF/LF
STREET YARD CALCULATIONS
Frontage minus dist. to building:
939 - 111 = 828
828 x 20 = 16,560 SF of street yard required.

Street Yard Provided: 19,836 SF
STREET YARD TREES
Shade Trees Required: 16,540 / 500 = 33.1 (34)
Provided: 28 Shade Trees and 60 Shrubs

CUP DP-3000 88
LANDSCAPE PLAN
APPROVED
5/16/26
Greg Sheehan

LANDSCAPE NOTES

- All landscape work shall be done in accordance with industry standards.
- All areas called out as seeded shall be seeded with buffalograss at 2.5 to 3 lbs per 1,000 sq ft and fertilized at 40 lbs per acre (or other per owner).
- Trees with broken leaders or no central leader will not be accepted.
- All planting beds shall be prepared by killing all existing vegetation with Round-Up (or equal) according to label directions. A Pre-emergent herbicide such as Treflan (5%) (or equal) shall be applied per label directions. All planting beds to receive 2" organic matter (such as cotton bur mulch, compost, or humus) and shall be rototilled in to a depth of 10-12".
- Mulch all planting beds with min. 3" of mulch. Mulch all tree saucer wells with min. 3" of mulch. Mulch material to be premium cedar mulch of uniform consistency.
- Metal edging shall be used to separate all turf areas from planting beds. Edging shall be 10 gauge thickness, commercial grade, or approved equal.
- General Contractor to supply and place at a depth of 4", all topsoil on site within the Limits of Construction.
- Topsoil hauled onto site shall be fertile, friable, natural loam topsoil, of uniform quality characteristic of representative local soils which produce heavy growth of crops, grass, or other vegetation. It shall be free of trash, or other matter toxic to plant growth.
- Topsoil shall be delivered in an unfrozen and non-muddy condition and shall be subject to approval by the Landscape Architect.
- Prior to any excavation for landscaping purposes the location of underground utilities shall be determined by calling Kansas One Call at 877-2470/1-800-344-7233. Contractor shall be responsible for any damage done to existing utilities.
- Report any discrepancies in the planting plan to the Landscape Architect, prior to starting construction.
- The Landscape Contractor shall coordinate with the G.C. to gain site access to install the plants and maintain grounds, until final acceptance from owner. Upon final acceptance, the one (1) year guarantee period will begin.
- The Landscape Contractor shall coordinate with the G.C. to install the plants and maintain grounds, until final acceptance from owner.
- The Landscape Contractor shall submit bid with unit prices for all plants, including mulch, installation, 1 year guarantee, bed preparation, fertilizer, etc.
- The Landscape Contractor is responsible for any damage done to the exterior of the building or any part of the parking lot when installing or maintaining the plantings before final acceptance.
- Fall planting season shall be September 1 thru October 31. Spring planting season shall be April 1 thru June 30. For grass seeding, fall season shall be September 1 thru mid October. Spring season for seeding shall be from March 15 thru mid May.
- Landscape to be watered manually. If automatic system is requested by owner, contractor to consult irrigation notes below.

IRRIGATION NOTES

- All irrigation work is to be installed in compliance with all local codes and regulations.
- Irrigation Contractor shall design system so turf heads are on separate zones from shrub spray heads.
- The Irrigation Contractor does not start irrigation construction until final shop drawings are submitted and approved to the Landscape Architect and/or Owner prior to construction for final approval which: Use Rainbird, Toro, Hunter products, or approved equal, which will illustrate type of head, head coverage, valve location, piping and accessories, and main line location. Included in shop drawings show zone pressure, valve size, GPM requirements and pipe sizing. Also specify a rain switch or moisture sensing device per City Codes.
- Prior to construction, Irrigation Contractor to locate all existing and proposed utilities and electrical wiring.
- Contractor shall not install irrigation system when any obstructions in the field exist. Contact the Landscape Architect for clarification before proceeding around obstructions.
- All irrigated turf areas shall be head-to-head coverage with triangle spacing where possible. Contractor is responsible for adequate coverage in shrub bed zones using drip system and/or spray heads.
- Heads to be adjusted to not spray on buildings, walks, or drives. Spray Heads will be located nearest to planting bed edge using funny pipe and fittings. Spray Heads to be located and sized so not to be susceptible to damage by automobile overhangs.
- Irrigation Contractor shall coordinate with Paving Contractor to locate and install required irrigation lines sleeving prior to any paving. Combine piping when possible to save on sleeving material. Sleeves to be min. 20" below finish grade. Verify final depth w/ Paving Contractor for adequate coverage.
- Automatic drainage valves to be located at the ends of lines and at the lowest points on the lines.
- Irrigation Contractor to verify location of water supply with GC prior to installation of system. Irrigation Contractor shall verify static pressure.
- Locate Irrigation Controller per Owner's direction.

PLANT SCHEDULE

TREES	QTY	BOTANICAL NAME	COMMON NAME	CONT.
	6	ACER RUBRUM 'FRANK JR.'™	REDPOINTE RED MAPLE	2" CALIPER MIN.
	12	QUERCUS ROBUR 'FASTIGIATA'	COLUMNAR ENGLISH OAK	2" CALIPER MIN.
	10	ZELKOVA SERRATA 'MUSASHINO'	MUSASHINO COLUMNAR ZELKOVA	2" CALIPER MIN.
SHRUBS	QTY	BOTANICAL NAME	COMMON NAME	CONT.
	25	JUNIPERUS CHINENSIS 'MINT JULEP'	MINT JULEP JUNIPER	18" TALL / 2 GAL. MIN.
	31	PANICUM VIRGATUM 'SHENANDOAH'	SHENANDOAH SWITCH GRASS	18" TALL / 2 GAL. MIN.
	19	EUONYMUS KIALUTSCHOVICUS 'MANHATTAN'	MANHATTAN EUONYMUS	18" TALL / 2 GAL. MIN.
TURF				
			BUFFALO GRASS SEED (OR OTHER PER OWNER)	

GC - General Commercial Zoning

U - Limited Industrial Zoning

2

SHRUB PLANTING DETAIL

5 Gallon and Smaller

TREE PLANTING & STAKING DETAIL

No Stake

TREE PLANTING & STAKING DETAIL

Discard Trees Larger than 2" Dia.
Evergreen Trees Larger than 6' Height

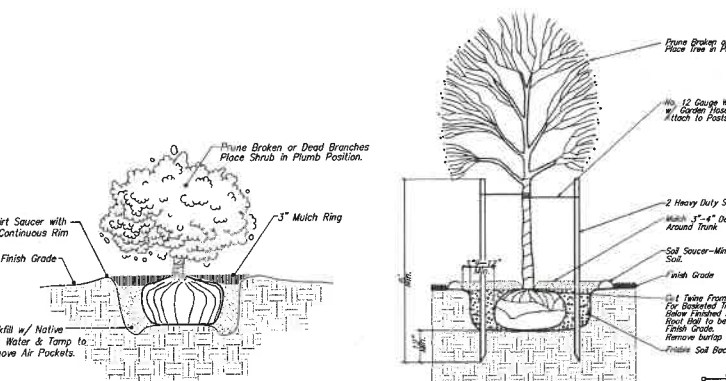

LANDSCAPE PLAN

SCALE 30 0 30
BAUGHMAN
315 S. Ellis, Wichita, KS 67211 (316) 262-7271
BaughmanCo.com

ISSUE DATE
100% 04/24/26

VERDAD
SELF STORAGE
E KELLOGG at SOUTH CHATEAU
WICHITA, KANSAS



Kaufman Design Group ARCHITECTURE
8415 E. HARRY ST.
SUITE 405
WICHITA, KS 67207
(316) 618-0448
sally@kdginc.co

SHEET TITLE

LANDSCAPE PLAN

SHEET NUMBER

L1.0

OF SHEETS