



Wichita-Sedgwick County Metropolitan Area Planning Department

October 11, 2001

MKEC Engineering Consultants, Inc.
411 N. Webb Road
Wichita, KS 67226

RE: SUB 2001-97 -- One-Step Final Plat of Wilson Farms Third Addition

At the regular meeting of the Metropolitan Area Planning Commission on October 11, 2001, the above captioned plat was considered. The action of the Planning Commission was to approve the plat as recommended by the Subdivision Committee, subject to the conditions stated in our letter dated September 28, 2001.

In addition to complying with those conditions, it is necessary that you meet the following requirements before this plat can be forwarded to the City Council and/or County Commission for consideration:

1. Submission of the fully completed and signed tracing of the subdivision, along with four (4) copies, to the Metropolitan Area Planning Department.
2. Submission of a check, made out to the Register of Deeds, covering the costs of any documents to be recorded as a requirement of platting.
3. Subdivision regulations now require a detailed Lot Grading Plan be submitted to Engineering prior to the tracing being released. This applies to all multi-lot, residential developments.
4. Submission of a disk to the Planning Department detailing the final plat in digital format in Autocad. This will be used by the City and County GIS Departments.

If you have any questions concerning this matter, please call.

A handwritten signature in black ink that reads 'Neil Evan Strahl'.

Neil Evan Strahl, Senior Planner
Current Plans Division

NES:ch

City Hall • 10th Floor • 455 North Main • Wichita, Kansas 67202-1688

T 316.268.4421 F 316.268.4390

www.wichitagov.org



Wichita-Sedgwick County Metropolitan Area Planning Department

September 28, 2001

MKEC Engineering Consultants, Inc.
411 N. Webb Road
Wichita, KS 67226

RE: SUB 2001-97 -- One-Step Final Plat of Wilson Farms Third Addition

At the regular meeting of the Subdivision Committee of the Metropolitan Area Planning Commission on Thursday, September 27, 2001, the above captioned plat was considered. The action of the Committee was to approve the final plat, subject to the following:

STAFF COMMENTS:

- A. City Engineering needs to comment on the need for guarantees or a respread agreement for existing special assessments. *A respread agreement is needed in addition to new petitions.*
- B. If improvements are guaranteed by petition, a notarized certificate listing the petitions shall be submitted to the Planning Department for recording.
- C. City Engineering needs to comment on the status of the applicant's drainage plan. *The drainage plan is approved. A drainage guarantee is required.*
- D. The applicant shall guarantee the installation of the proposed interior private streets to the equivalent standard of a public street, but as private improvements such guarantees cannot be provided through the use of petitions.
- E. A CUP adjustment may be needed. The Applicant shall contact MAPD Zoning staff to determine if the parcel boundaries of the CUP need to be adjusted to correspond with the lot layout being platted.
- F. The applicant shall submit a covenant which provides for four (4) off-street parking spaces per dwelling unit on each lot which abuts a 58-foot or 32-foot street. The covenant shall inventory the affected lots by lot and block number and shall state that the covenant runs with the land and is binding on future owners and assigns.

City Hall • 10th Floor • 455 North Main • Wichita, Kansas 67202-1688

T 316.268.4421 F 316.268.4390

www.wichitagov.org

- G. Since this plat proposes the platting of narrow street right-of-way with adjacent "15-foot street drainage and utility easements", a restrictive covenant shall be submitted which calls out restrictions for lot-owner use of these easements. Retaining walls and change of grade shall be prohibited within these easements as well as fences, earth berms and mass plantings.
- H. Provisions shall be made for ownership and maintenance of the proposed reserves. The applicant shall either form a lot owners' association prior to recording the plat or shall submit a covenant stating when the association will be formed, when the reserves will be deeded to the association and who is to own and maintain the reserves prior to the association taking over those responsibilities.
- I. For those reserves being platted for private streets and drainage purposes, the required covenant which provides for ownership and maintenance of the reserves shall grant, to the City, the authority to maintain the private streets and drainage reserves in the event the owner(s) fail to do so. The covenant shall provide for the cost of such maintenance to be charged back to the owner(s) by the governing body.
- J. Since this is a replat of a previous Addition involved with the ownership and maintenance of reserves for that Addition, but not being replatted by this Addition, the above covenants and/or other legal documents shall be provided which provides for this Addition to continue to share in the ownership and maintenance responsibilities of any such previously platted reserves.
- K. The Subdivision Regulations limit cul-de-sacs to 600 feet in length and a modification will need to be approved by the Subdivision Committee. **A modification has been approved.**
- L. An emergency access easement has been platted extending from the turnaround of the Shadybrook cul-de-sac to Red Brush Street. The paving guarantee shall provide for construction of an all weather surface within the emergency access easement along with an appropriate barrier that will prevent non-emergency traffic from using the emergency access drive.
- M. The applicant shall submit an avigational easement covering all of the subject plat and a restrictive covenant assuring that adequate construction methods will be used to minimize the effects of noise pollution in the habitable structures constructed on subject property.
- N. On the final plat tracing, a note shall be placed on the face of the plat indicating that this Addition is subject to the conditions of the Wilson Estates Residential CUP (DP-201).
- O. Approval of this plat will require a waiver of the lot depth to width ratio for Lot 18, Block 1. The Subdivision Regulations state that the maximum depth of all residential lots shall not exceed 2.5 times the width.
- P. The **City Fire Department /GIS** needs to comment on the plat's street names. **GIS has requested that Shadybrook / Paddock Green Circle be renamed as one street name.**
- Q. Based upon the platting binder, property taxes are still outstanding. Before the plat is scheduled for City Council consideration, proof shall be provided indicating that all applicable property taxes have been paid.

- R. The platting binder indicates a party holding a mortgage on the site. This party's name must be included as a signatory on the plat, or else documentation provided indicating that such mortgage has been released.
- S. On the final plat tracing, the MAPC signature block needs to reference "J.D. Michaelis, Chair".
- T. The platting text shall include language that a drainage plan has been developed for the plat and that all drainage easements, rights-of-way, or reserves shall remain at established grades or as modified with the approval of the applicable City or County Engineer, and unobstructed to allow for the conveyance of stormwater.
- U. The applicant shall install or guarantee the installation of all utilities and facilities which are applicable and described in Article 8 of the MAPC Subdivision Regulations. (Water service and fire hydrants required by Article 8 for fire protection shall be as per the direction and approval of the Chief of the Fire Department.)
- V. The applicant's engineer is advised that the Register of Deeds is requiring the name(s) of the notary public, who acknowledges the signatures on this plat, to be printed beneath the notary's signature.
- W. To receive mail delivery without delay, and to avoid unnecessary expense, the applicant is advised of the necessity to meet with the U.S. Postal Service Growth Management Coordinator (Phone 316-946-4556) prior to development of the plat so that the type of delivery, and the tentative mailbox locations can be determined.
- X. The applicant is advised that various State and Federal requirements (specifically but not limited to the Army Corps of Engineers, Kanopolis Project Office, Rt. 1, Box 317, Valley Center, KS 67147) for the control of soil and wind erosion and the protection of wetlands may impact how this site can be developed. It is the applicant's responsibility to contact all appropriate agencies to determine any such requirements.
- Y. The owner of the subdivision should be aware of the fact that the development of any subdivision greater than five (5) acres in size may require an NPDES Storm Water Discharge Permit from the Kansas Department of Health and Environment in Topeka. Further, on all construction sites, the City of Wichita requires that best management practices be used to reduce pollutant loadings in storm water runoffs.
- Z. Perimeter closure computations shall be submitted with the final plat tracing.
- AA. Recording of the plat within thirty (30) days after approval by the City Council and/or County Commission.
- BB. The representatives from the utility companies should be prepared to comment on the need for any additional utility easements to be platted on this property. **KGE and Southwestern Bell have requested additional easements.**
- CC. The applicant is reminded that a disk shall be submitted with the final plat tracing to the Planning Department detailing this plat in digital format in AutoCAD. This will be used by the City and County GIS Department.

SUB 2001-97 -- One-Step Final Plat of Wilson Farms Third Addition
September 28, 2001
Page 4

This case will be forwarded to the Planning Commission on Thursday, October 11, 2001, at 1:30 p.m.

The enclosed "marked" copy of the plat is for your information and files.

If you have any questions concerning this matter, please call.

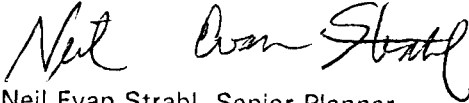

Neil Evan Strahl, Senior Planner
Current Plans Division

NES:ch

Enclosure: Marked Copy of Plat

Copies to: Wilson Residential Company, LLC., 8100 E. 22nd Street North, Bldg. 1000, Wichita, KS 67266
Barbara Waddell, 3306 Diablo Way, Castle Rock, CO 80104
Mike Lindebak, City Engineering, Mail Stop (1-71)
Jim Weber, PE-Director, Sewer Operations & Maintenance Department, Bureau of Public Services, 1144 S. Seneca, Wichita, KS 67213

STAFF REPORT
(One-Step Final Plat Approved 9/27/01)

CASE NUMBER: SUB 2001-97 -- WILSON FARMS THIRD ADDITION

OWNER/APPLICANT: Wilson Residential Company, LLC, 8100 E. 22nd St. N., Bldg. 1000, Wichita, KS 67226; Barbara Waddell 3306 Diablo Way, Castle Rock, CO 80104

SURVEYOR/ENGINEER: MKEC Engineering Consultants, Inc., 411 N. Webb Rd., Wichita, KS 67206

LOCATION: South side of 21st St. N., West of Webb Road

SITE SIZE: 25.41 Acres

NUMBER OF LOTS	
Residential:	27
Office:	
Commercial:	
Industrial:	
Total:	<u>27</u>

MINIMUM LOT AREA: 11,000 Sq. Ft.

CURRENT ZONING: SF-6, Single-Family Residential

PROPOSED ZONING: Same

VICINITY MAP

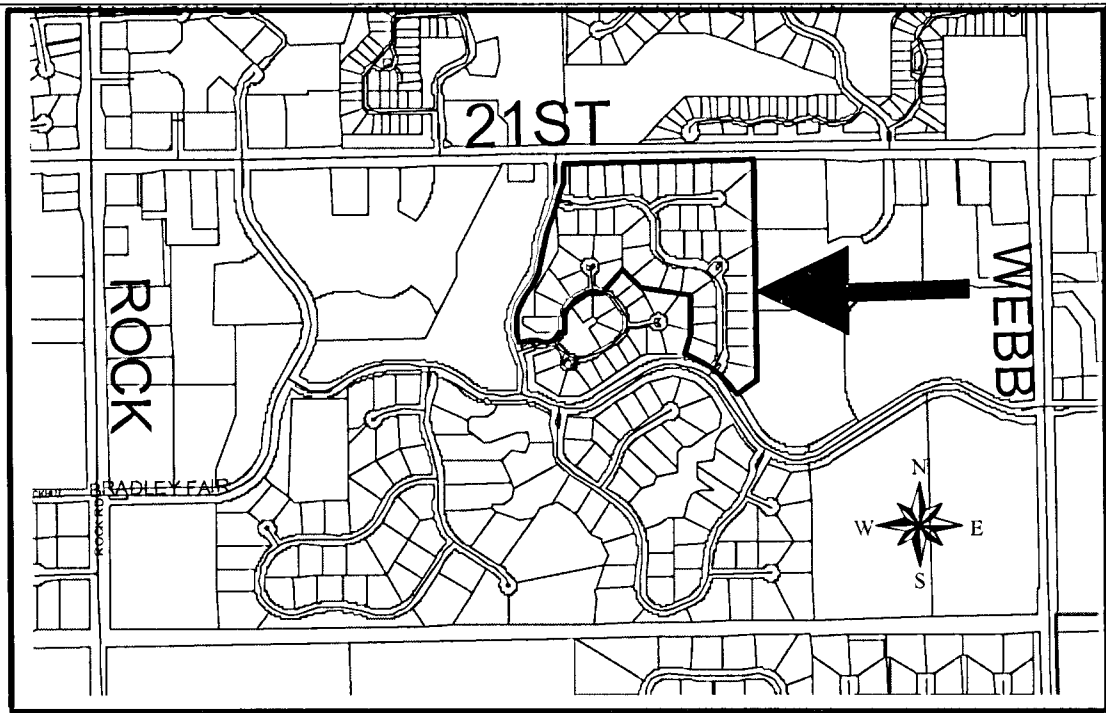

NOTE: This is a replat of Wilson Farms 2nd Addition. The street configuration has been revised to create a cul-de-sac for Shadybrook/ Paddock Green. The lot layout has been revised to create 18 fewer lots. The site encompasses Parcels 5 and 6 of the Wilson Estates Residential CUP (DP-201).

STAFF COMMENTS:

- A. **City Engineering** needs to comment on the need for guarantees or a respread agreement for existing special assessments. **A respread agreement is needed in addition to new petitions.**
- B. If improvements are guaranteed by petition, a notarized certificate listing the petitions shall be submitted to the Planning Department for recording.
- C. **City Engineering** needs to comment on the status of the applicant's drainage plan. **The drainage plan is approved. A drainage guarantee is required.**
- D. The applicant shall guarantee the installation of the proposed interior private streets to the equivalent standard of a public street, but as private improvements such guarantees cannot be provided through the use of petitions.
- E. A CUP adjustment may be needed. The Applicant shall contact MAPD Zoning staff to determine if the parcel boundaries of the CUP need to be adjusted to correspond with the lot layout being platted.
- F. The applicant shall submit a covenant which provides for four (4) off-street parking spaces per dwelling unit on each lot which abuts a 58-foot or 32-foot street. The covenant shall inventory the affected lots by lot and block number and shall state that the covenant runs with the land and is binding on future owners and assigns.
- G. Since this plat proposes the platting of narrow street right-of-way with adjacent "15-foot street drainage and utility easements", a restrictive covenant shall be submitted which calls out restrictions for lot-owner use of these easements. Retaining walls and change of grade shall be prohibited within these easements as well as fences, earth berms and mass plantings.
- H. Provisions shall be made for ownership and maintenance of the proposed reserves. The applicant shall either form a lot owners' association prior to recording the plat or shall submit a covenant stating when the association will be formed, when the reserves will be deeded to the association and who is to own and maintain the reserves prior to the association taking over those responsibilities.
- I. For those reserves being platted for private streets and drainage purposes, the required covenant which provides for ownership and maintenance of the reserves shall grant, to the City, the authority to maintain the private streets and drainage reserves in the event the owner(s) fail to do so. The covenant shall provide for the cost of such maintenance to be charged back to the owner(s) by the governing body.
- J. Since this is a replat of a previous Addition involved with the ownership and maintenance of reserves for that Addition, but not being replatted by this Addition, the above covenants and/or other legal documents shall be provided which provides for this Addition to continue to share in the ownership and maintenance responsibilities of any such previously platted reserves.

- K. The Subdivision Regulations limit cul-de-sacs to 600 feet in length and a modification will need to be approved by the Subdivision Committee. **A modification has been approved.**
- L. An emergency access easement has been platted extending from the turnaround of the Shadybrook cul-de-sac to Red Brush Street. The paving guarantee shall provide for construction of an all weather surface within the emergency access easement along with an appropriate barrier that will prevent non-emergency traffic from using the emergency access drive.
- M. The applicant shall submit an avigational easement covering all of the subject plat and a restrictive covenant assuring that adequate construction methods will be used to minimize the effects of noise pollution in the habitable structures constructed on subject property.
- N. On the final plat tracing, a note shall be placed on the face of the plat indicating that this Addition is subject to the conditions of the Wilson Estates Residential CUP (DP-201).
- O. Approval of this plat will require a waiver of the lot depth to width ratio for Lot 18, Block 1. The Subdivision Regulations state that the maximum depth of all residential lots shall not exceed 2.5 times the width.
- P. The **City Fire Department /GIS** needs to comment on the plat's street names. **GIS has requested that Shadybrook / Paddock Green Circle be renamed as one street name.**
- Q. Based upon the platting binder, property taxes are still outstanding. Before the plat is scheduled for City Council consideration, proof shall be provided indicating that all applicable property taxes have been paid.
- R. The platting binder indicates a party holding a mortgage on the site. This party's name must be included as a signatory on the plat, or else documentation provided indicating that such mortgage has been released.
- S. On the final plat tracing, the MAPC signature block needs to reference "J.D. Michaelis, Chair".
- T. The platting text shall include language that a drainage plan has been developed for the plat and that all drainage easements, rights-of-way, or reserves shall remain at established grades or as modified with the approval of the applicable City or County Engineer, and unobstructed to allow for the conveyance of stormwater.
- U. The applicant shall install or guarantee the installation of all utilities and facilities which are applicable and described in Article 8 of the MAPC Subdivision Regulations. (Water service and fire hydrants required by Article 8 for fire protection shall be as per the direction and approval of the Chief of the Fire Department.)
- V. The applicant's engineer is advised that the Register of Deeds is requiring the name(s) of the notary public, who acknowledges the signatures on this plat, to be printed beneath the notary's signature.
- W. To receive mail delivery without delay, and to avoid unnecessary expense, the applicant is advised of the necessity to meet with the U.S. Postal Service Growth Management Coordinator (Phone 316-946-4556) prior to development of the plat so that the type of delivery, and the tentative mailbox locations can be determined.

SUB 2001-97 -- One-Step Final Plat of WILSON FARMS THIRD ADDITION
October 11, 2001 - Page 4

- X. The applicant is advised that various State and Federal requirements (specifically but not limited to the Army Corps of Engineers, Kanopolis Project Office, Rt. 1, Box 317, Valley Center, KS 67147) for the control of soil and wind erosion and the protection of wetlands may impact how this site can be developed. It is the applicant's responsibility to contact all appropriate agencies to determine any such requirements.
- Y. The owner of the subdivision should be aware of the fact that the development of any subdivision greater than five (5) acres in size may require an NPDES Storm Water Discharge Permit from the Kansas Department of Health and Environment in Topeka. Further, on all construction sites, the City of Wichita requires that best management practices be used to reduce pollutant loadings in storm water runoffs.
- Z. Perimeter closure computations shall be submitted with the final plat tracing.
- AA. Recording of the plat within thirty (30) days after approval by the City Council and/or County Commission.
- BB. The representatives from the utility companies should be prepared to comment on the need for any additional utility easements to be platted on this property. ***KGE and Southwestern Bell have requested additional easements.***
- CC. The applicant is reminded that a disk shall be submitted with the final plat tracing to the Planning Department detailing this plat in digital format in AutoCAD. This will be used by the City and County GIS Department.