



**Wichita-Sedgwick County Metropolitan Area Planning Department**

April 8, 2010

Newspring Church, Inc.  
Attn: Dan Kubish, Pastor, and Billy Poore, Treasurer  
12200 E. 21<sup>st</sup> Street North  
Wichita, KS 67206

Metro Sign Corporation  
Attn: David Bish, President, and Kristina Williamson, Permit Acquisitions  
401 N. Ann Arbor  
Oklahoma City, OK 73127

**RE: BZA2010-00014: Sign Code Adjustment to permit an electronic message sign for an institutional use on property zoned SF-5 Single-Family Residential ("SF-5").**

**Legal Description: Lot 1, Block A, Messiah Baptist Church 4<sup>th</sup> Addition to Wichita, Sedgwick County, Kansas. Generally located on the northeast corner of K-96 and 21<sup>st</sup> Street North (12200 East 21<sup>st</sup> Street North).**

Dear Applicants:

We have reviewed your request for a Sign Code Adjustment to permit an electronic message sign for an institutional use on the aforementioned property. From reviewing your application, we understand that you propose a 4'9" x 9'5" LED sign within a larger sign, on a property used as a church, New Spring Church. The new ground sign will replace the existing sign.

Section 24.04.251.2.i. of the Sign Code allows an adjustment to permit an electronic message sign for institutional uses located in SF-5 Single-Family Residential ("SF-5") zoning when the three conditions required by Section 24.04.251.6 of the Sign Code are met. We find that allowing the electronic message sign as proposed meets the three conditions required by Section 24.04.251.6 of the Sign Code as set out below:

- 1) Impact on existing uses in surrounding areas: Existing uses in the surrounding area include a shopping center on property zoned LC Limited Commercial ("LC") and a high school on property zoned SF-5 to the south, an expressway to the west (K-96) and another larger church on

property zoned SF-5 to the east. No residential dwellings are located near the proposed sign and the street is a major arterial with heavy traffic volumes.

- 2) Compatibility with existing or permitted uses on abutting sites: Adding electronic message capability to the sign should not reduce compatibility of the sign with surrounding uses, as the sign will not be permitted to flash or display moving images, and graphics changes will be restricted to one change per second or slower.
- 3) Effect on public health, safety or welfare: There will be no encroachment into public right-of-way; therefore, there should not be a negative impact on the public health, safety or welfare nor will properties or improvements in the vicinity be materially injured.

Our signatures below indicate that a Sign Code Adjustment to permit an electronic message sign for a church on the aforementioned property is hereby granted, subject to the following conditions:

- 1) The sign shall be in conformance with the approved elevation.
- 2) No animated, flashing or moving images or text shall be displayed on the sign; the sign shall not make copy or graphics changes faster than once per second.
- 3) Portable signage shall not be permitted on the subject property.
- 4) If the Zoning Administrator finds that there is a violation of any of the conditions of the Zoning Adjustment, the Zoning Administrator, in addition to enforcing the other remedies set forth in the Unified Zoning Code, may, with the concurrence of the Planning Director, declare that the Zoning Adjustment is null and void.

The development application sign should now be removed from the property.

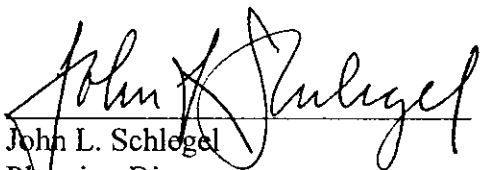
  
John L. Schlegel  
Planning Director

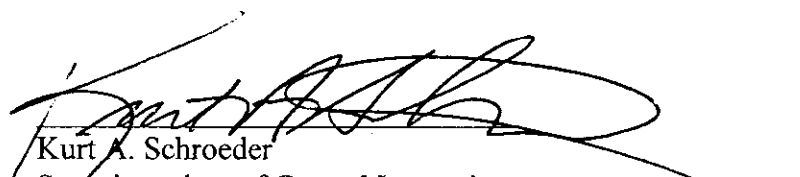
  
Kurt A. Schroeder  
Superintendent of Central Inspection

cc: Kurt Schroeder, Office of Central Inspection  
JR Cox, Office of Central Inspection  
Sue Schlapp, CM District II

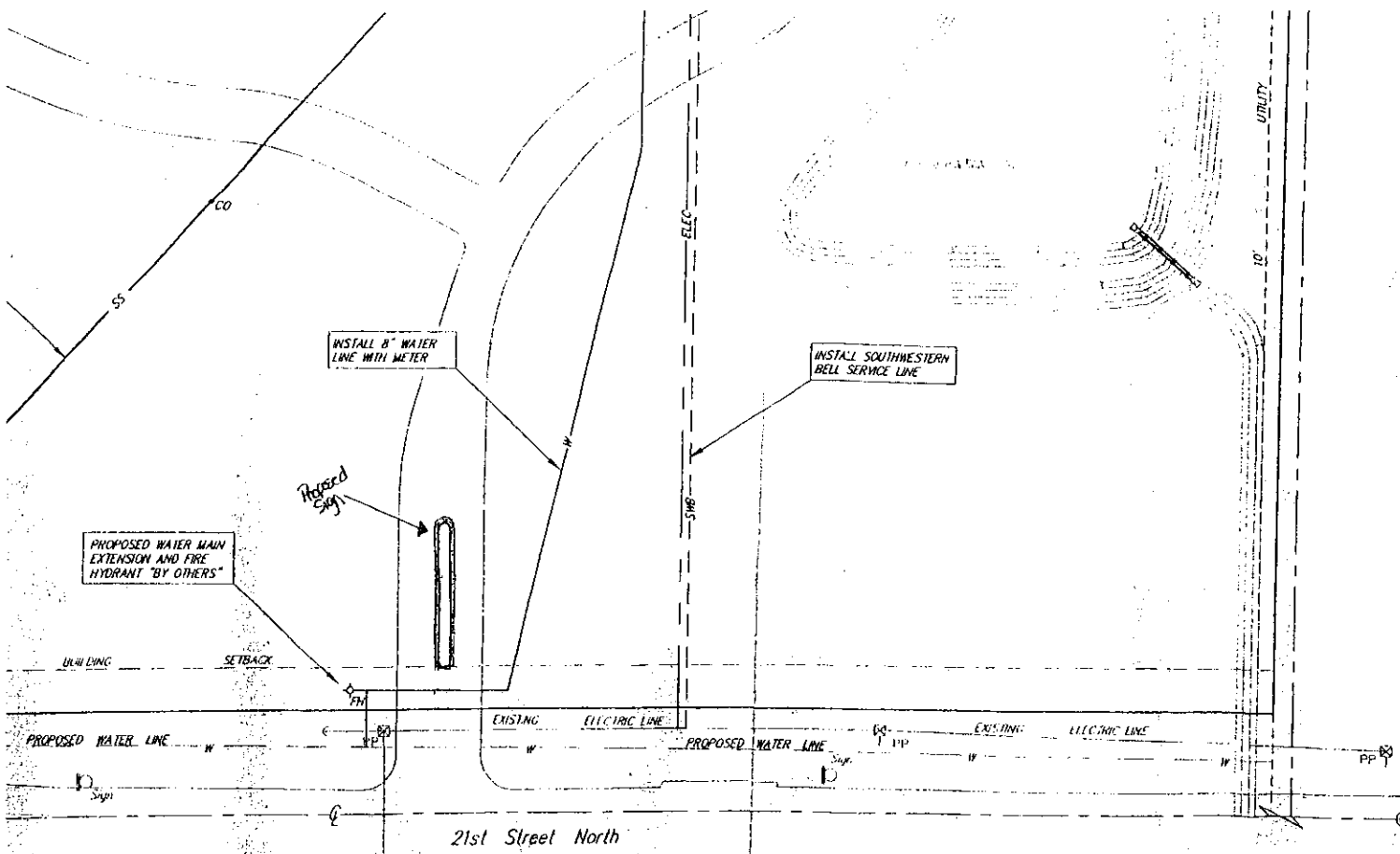

Contractor will be required to work around existing utilities which do not conflict with proposed construction.

3. The Contractor to verify utility locations prior to construction on this project.
4. Gas service tie-ins to new meter per City code. Tie-ins are to be above ground at meter.
5. Contractor shall be responsible for coordination and of all utility service connections.
6. Utility service connections are to be installed per applicable City codes.

**LEGEND:**

- W — FIRE SERVICE LINE
- SWU — SMOKE SERVICE LINE
- SS — SANITARY SEWER SERVICE LINE
- ELEC — KORE ELECTRIC SERVICE LINE

NOT FOR CONSTRUCTION

|  |           |          |         |       |
|--|-----------|----------|---------|-------|
| <b>MESSIAH BAPTIST CHURCH</b>                      |           |          |         |       |
| <b>UTILITY PLAN</b>                                |           |          |         |       |
| <b>BAUGHMAN COMPANY P.A.</b>                       |           |          |         |       |
| ENGINEERING, SURVEYING, & PLANNING                 |           |          |         |       |
| 518-262-2221 • 315 E. 11th • WICHITA, KANSAS 67211 |           |          |         |       |
| PROJECT NUMBER                                     |           |          |         |       |
| DESIGN   | TRAMM JAB | APPROVED | DATE    | SCALE |
|  |           | NSW      | 7/29/01 | SHOWN |

fabricate and install two message centers to existing monument sign...

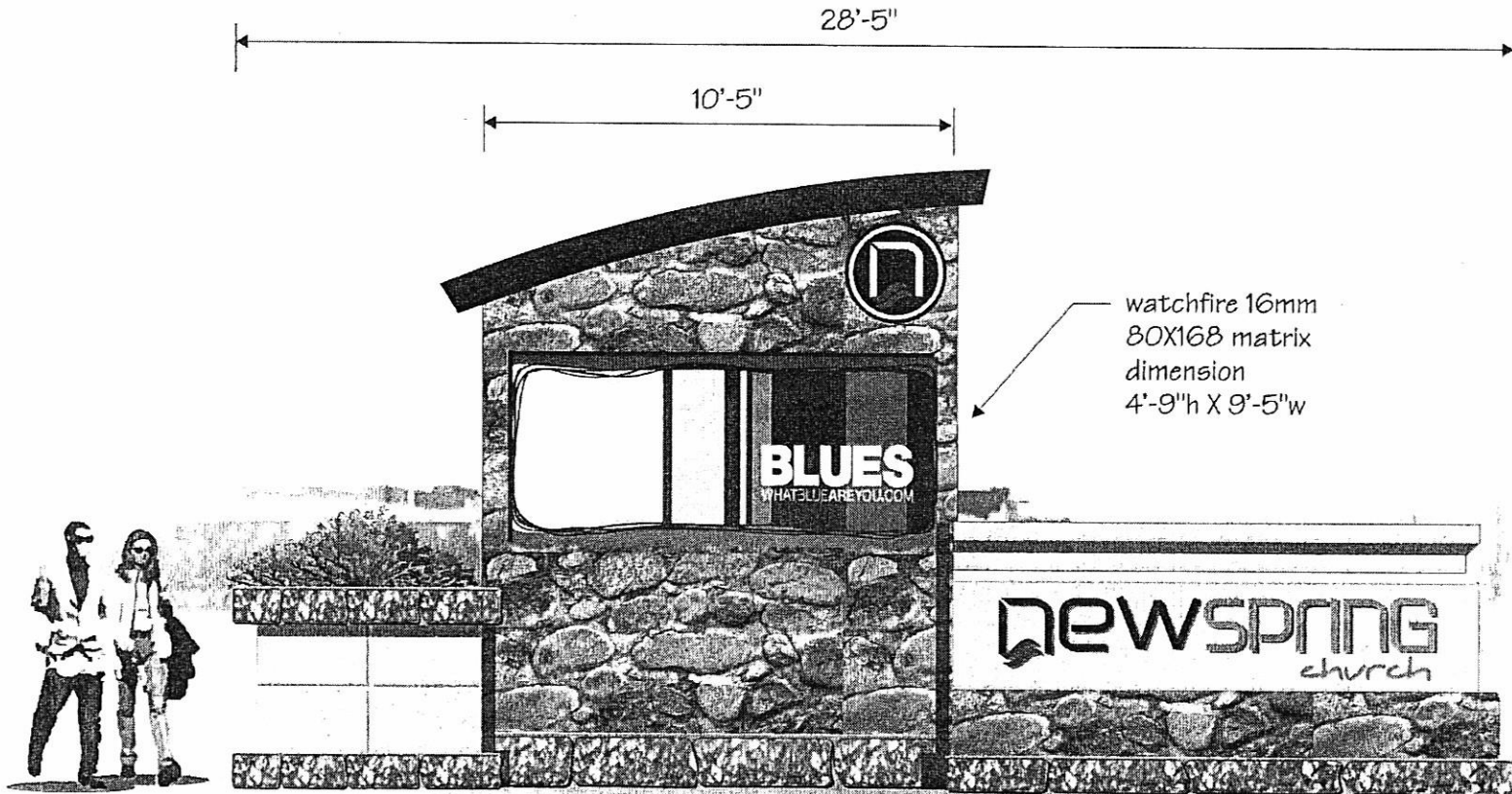

CLIENT New Spring Church

SALESMAN Jess

SCALE 1/8" = 1'

DESIGNER AJ

APPROVAL

\\Designar\Corel\_2010\Jess\New Spring church.cdr  
Wednesday, February 24, 2010 11:31:24 AM

**MetroSign**  
Corporation