



Wichita-Sedgwick County Metropolitan Area Planning Department

March 11, 2010

Cornerstone Christian Church
Attn: Larry Pope
5531 E. 37th Street North
Wichita, Kansas

Trimark Signworks
Attn: Ryan Bond
319 N Oak
Wichita, KS 67213



RE: BZA2010-09: Sign Code Adjustment to permit an electronic message sign for an institutional use on property zoned SF-5 Single-family Residential.

Legal Description: Lot 1 except the South 396 feet, Town and Country Church Addition to Wichita, Sedgwick County, Kansas. Generally located on the southeast corner of 37th Street North and Ridgewood Street (5331 E. 37th Street North).

Dear Applicants:

We have reviewed your request for a Sign Code Adjustment to permit an electronic message sign for an institutional use on the aforementioned property. From reviewing your application, we understand that you propose a 2'9" by 8' LED sign within a larger sign, replacing an existing sign on the site.

Section 24.04.251.2.i. of the Sign Code allows an adjustment to permit an electronic message sign for institutional uses located in SF-5 Single-Family Residential ("SF-5") zoning when the three conditions required by Section 24.04.251.6. of the Sign Code are met. We find that allowing the electronic message sign as proposed meets the three conditions required by Section 24.04.251.6. of the Sign Code as set out below:

- 1) Impact on existing uses in surrounding areas: Existing uses in the surrounding area are office warehouse uses on property zoned LI Limited Industrial ("LI") to the west and south and a large church property to the east, similar to use and with the same SF-5 zoning of this site. The proposed electronic message sign is across the 37th Street North from one single-family residence

located along 37th Street North. One residence is located directly to the north, separated by 37th Street North, which is a principal arterial street.

- 2) Compatibility with existing or permitted uses on abutting sites: Adding electronic message capability to the sign should not reduce compatibility of the sign with surrounding uses, as the sign will not be permitted to flash or display moving images, and graphics changes will be restricted to one change per second or slower.
- 3) Effect on public health, safety or welfare: There will be no encroachment into public right-of-way; therefore, there should not be a negative impact on the public health, safety or welfare nor will properties or improvements in the vicinity be materially injured.

Our signatures below indicate that a Sign Code Adjustment to permit an electronic message sign for a church on the aforementioned property is hereby granted, subject to the following conditions:

- 1) The sign shall be in conformance with the approved elevation.
- 2) No animated, flashing or moving images or text shall be displayed on the sign; the sign shall not make copy or graphics changes faster than once per second.
- 3) Portable signage shall not be permitted on the subject property.
- 4) If the Zoning Administrator finds that there is a violation of any of the conditions of the Zoning Adjustment, the Zoning Administrator, in addition to enforcing the other remedies set forth in the Unified Zoning Code, may, with the concurrence of the Planning Director, declare that the Zoning Adjustment is null and void.

The development application sign should now be removed from the property.

John L. Schlegel
Planning Director

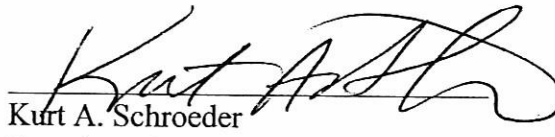
Kurt A. Schroeder
Superintendent of Central Inspection

cc: Kurt Schroeder, Office of Central Inspection
JR Cox, Office of Central Inspection
Lavonta Williams, CM District I

Parks

Streets

Crime

Flood Zone

Custom

▲ NORTH ▲

E 37TH ST N

315'

sign 1

5531

N RIDGEWOOD ST

N EDGEWOOD DR

5531

▼ SOUTH ▼

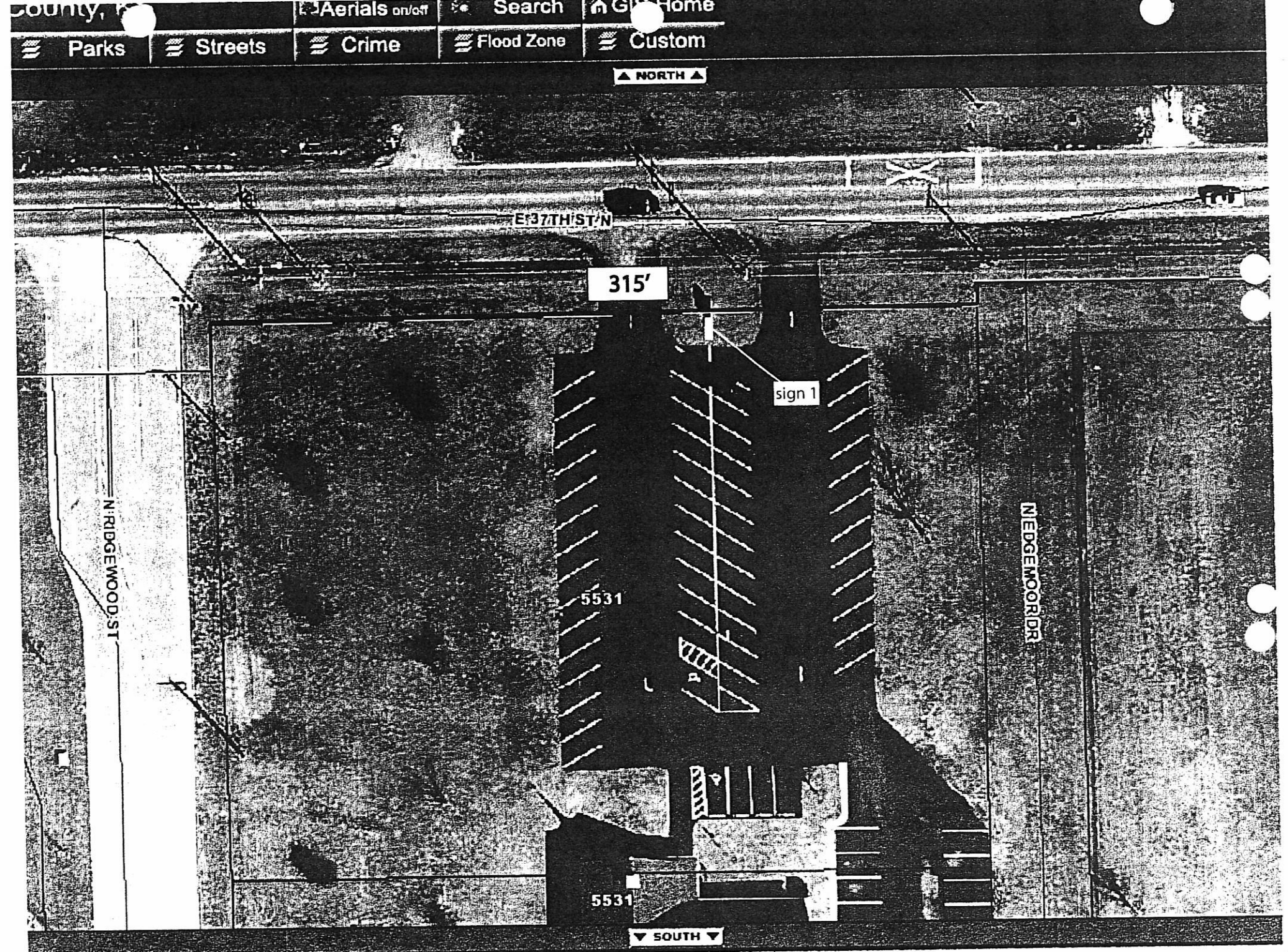



REMOVE THE EXISTING SIGN AND STONE BASE.
 FAB AND INSTALL (1) NEW D/F MONUMENT SIGN WITH CABINET SIGN AND EMC UNITS AS SHOWN.
 CABINET IS A 24" WIDEBODY PAINTED BLACK WITH FLAT WHITE PLEX FACES AND FIRST SURFACE
 OPAQUE BLACK AND OPAQUE WHITE VINYL.
 FLUORESCENT ILLUMINATION, 120 VOLTS.
 EMC UNITS: DAKTRONICS AF-3500-32 X 112-20-A-2V.
 2'9" X 7'10" X 8" CABINET SIZE. 4 LINES OF CHARACTERS. 5"-25" TALL.
 ALUMINUM CROWN TOP PAINTED WHITE.
 16" DEEP ALUMINUM SURROUNDING STRUCTURE/POLE COVER PAINTED WHITE
 WITH 6" BLACK VINYL ADDRESS NUMERALS.
 6" DEEP CONCRETE MOW STRIP.

INSTALL SITE:
 5531 E. 37TH N. OPAQUE BLACK VINYL OPAQUE WHITE VINYL
 JIM RACKHAM
 686-0208

NE

VINYL DETAIL.

GAP BETWEEN VINYL
 GLOWS AT NIGHT.
GAP AMOUNT TBA

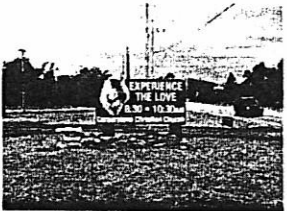
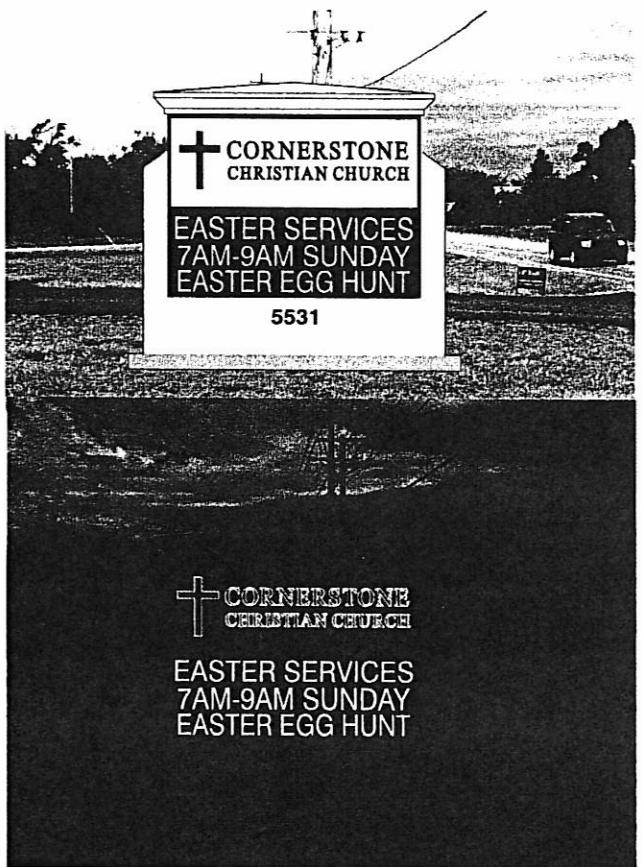

EXISTING SIGN



319 S. OAK
 WICHITA, KANSAS
 (316) 263-2224
 FAX (316) 263-1463

Job Name:
 Cornerstone Christian Church

Job Location:
 Wichita, KS

Layout:
 cornerchri01.cdr

Production File:
 cornerchri01.plt

Sales Contact:
 Lori Devaney

Scale:
 3/8"=1'

Dwg.#
 906795-3

Drawn By:
 G.Claussen

Date:
 6-6-08

Revisions: 6-19-08, 11-17-0
 12-17-08, 2-12-10
 2-19-10

This design is the property of
 TRIMARK SIGNWORKS

It cannot be used or duplicated by
 anyone without the prior approval of
 said company.

Colors shown on this print are used for
 representation purposes only, and are
 not completely accurate. Colors are to
 be determined by customer. Work on
 this job cannot start until drawing is
 signed and returned to Trimark Signworks.



Approved By _____ Date _____ Marketing Approval _____

Please review this drawing carefully.
 By signing this you verify the accuracy of all graphics shown with respect to form and content. The specifications are correct and represent our order requirements exactly.