



Wichita-Sedgwick County Metropolitan Area Planning Department

October 1, 2010

Sandra Morris
8510 E 29th St N, Apt #517
Wichita, KS 67226

RE: CON2010-00032 - City Conditional Use request for an accessory apartment on property zoned SF-5 Single-Family Residential, generally located midway between Pawnee Avenue and Wassall Street, west of Hillside Avenue, on the north side of Range Road.

Dear Ladies and Gentlemen:

At its regular meeting on **September 9, 2010**, the Wichita - Sedgwick County Metropolitan Area Planning Commission considered the above captioned request. The action of the MAPC was to **APPROVED** the request, subject to the conditions on the attached resolution.

If you have any questions concerning this application, please contact our office at 268-4421.

Sincerely,

A handwritten signature in black ink, appearing to read 'Derrick K. Slocum', written over a horizontal line.

Derrick K. Slocum
Associate Planner
Current Plans Division

DKS:mc
Attachment

Copies to: Victor Hammond, 3168 E. Range Rd., Wichita, KS 67216
K-15 Organization, John Kemp, 3000 E. Dunham, Wichita, KS 67216
Mead, Connie Rosenkrans, 1636 S. Green St., Wichita, KS 67211
Planeview, Rob Snyder, 3620 Sunnybrook, Wichita, KS 67210
Riverside Township, Dale V Kuhn, 6051 Southeast Blvd, Derby, KS 67037
WCC III, Jim Skelton, Mail Stop 1-13
N.A. III, Janet Johnson, Mail Stop 1-135
Julianne Kallman, Engineering, Mail Stop 1-71

CONDITIONAL USE RESOLUTION NO. CON2010-00032

WHEREAS, Sandra Morris, (Owner) and Victor Hammond (Contract Purchaser/Applicant); pursuant to Section V-D of the Wichita-Sedgwick County Unified Zoning Code (herein referred to as Unified Zoning Code), requests a Conditional Use for an Accessory Apartment on 0.15 acres zoned SF-5 Single-family Residential (“SF-5”) described as:

Lot 33, Block 13, Replat of Part of Pawnee Ranch, Sedgwick County, Kansas; generally located on the north side of Range Road, just west of South Hillside Avenue, midway between Pawnee Avenue and 31st Street South. (3168 Range Road)

WHEREAS, proper notice as required by the Unified Zoning Code and by the policy of the Metropolitan Area Planning Commission (hereinafter referred to as MAPC) has been given; and

WHEREAS, the MAPC did, at the meeting of September 9, 2010, consider said application; and

WHEREAS, the MAPC has authority to permit a Conditional Use, subject to any special conditions deemed appropriate in order to assure full compliance with the criteria of the Unified Zoning Code.

NOW, THEREFORE, BE IT RESOLVED by the Metropolitan Area Planning Commission that this application be approved to allow a Conditional Use for an Accessory Apartment on 0.15 acres zoned SF-5 Single-family Residential (“SF-5”) described as:

Lot 33, Block 13, Replat of Part of Pawnee Ranch, Sedgwick County, Kansas; generally located on the north side of Range Road, just west of South Hillside Avenue, midway between Pawnee Avenue and 31st Street South. (3168 Range Road)

Approved subject to the following conditions:

1. The accessory apartment shall be subject to all requirements of Section III-D.6.a of the Unified Zoning Code.
2. The applicant shall obtain all applicable permits, including but not limited to: building, health, and zoning.
3. The site shall be developed in general conformance with the approved site plan.
4. Construction of improvements shall be completed within one year of approval of the Conditional Use.
5. If the Zoning Administrator finds that there is a violation of any of the conditions of the Conditional Use, the Zoning Administrator, in addition to enforcing the other remedies set forth in the Unified Zoning Code, may, with the concurrence of the Planning Director, declare the Conditional Use null and void.

Adopted this 9th Day of September 2010

METROPOLITAN AREA PLANNING COMMISSION

Debra Miller Stevens
Debra Miller Stevens, Chair MAPC

ATTEST:

John L. Schlegel
John L. Schlegel, Secretary

STAFF REPORT

MAPC: September 9, 2010
Tentative City Council Date: October 19, 2010
(If protests are received)

-
- CASE NUMBER:** CON2010-00032
- APPLICANT/OWNER:** Sandra Morris (Owner)
Victor Hammond (Contract Purchaser)
- REQUEST:** Conditional Use for an accessory apartment
- CURRENT ZONING:** SF-5 Single-family Residential ("SF-5")
- SITE SIZE:** 0.15 acres
- LOCATION:** Generally located on the north side of Range Road, just west of South Hillside Avenue, midway between Pawnee Avenue and 31st Street South (3168 Range Road)
- PROPOSED USE:** Accessory Apartment

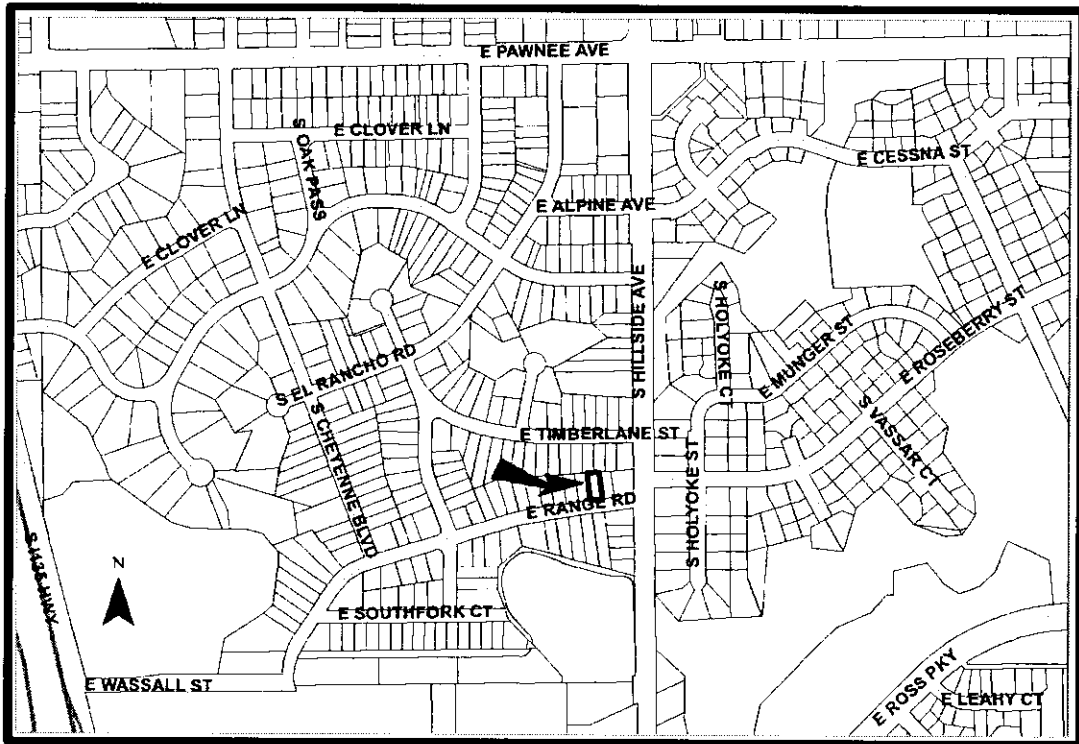

BACKGROUND: The applicant requests a Conditional Use to allow an accessory apartment on a 0.15-acre platted lot zoned SF-5 Single-family Residential (“SF-5”), and located on the north side of Range Road, just west of South Hillside Avenue, midway between Pawnee Avenue and 31st Street South (3168 Range Road). The applicant proposes to utilize the existing detached accessory structure at the rear of the lot as an accessory apartment. The character of the surrounding area is residential. All properties surrounding the subject property are zoned SF-5, and are developed with single-family residences.

An accessory apartment is defined as a dwelling unit that may be wholly within or detached from a principal single-family dwelling unit. A dwelling unit includes provisions for sleeping, cooking, eating and sanitation. A Conditional Use is required to permit an accessory apartment in the SF-5 zoning district. Article III, Section D.6 (a) of the Unified Zoning Code (UZC) has the following requirements for an accessory apartment:

- (1) A maximum of one accessory apartment may be allowed on the same lot as a single-family dwelling unit and may be within the main building, within an accessory building or constructed as an accessory building;
- (2) The appearance of an accessory apartment shall be compatible with the main dwelling and with the character of the neighborhood;
- (3) The accessory apartment shall remain accessory to and under the same ownership as the principal single-family dwelling unit, and the ownership shall not be divided or sold as a condominium; and
- (4) The water and sewer service provided to the accessory structure shall not be provided as separate service from the main dwelling. Electric, gas, telephone and cable television utility service may be provided as separate utility services.

The applicant submitted the attached site plan illustrating the location of the proposed accessory apartment (accessory structure). The applicant indicates on the site plan that the accessory apartment would be located north of the existing house, in the existing accessory structure. The residence and proposed apartment will continue to utilize the existing driveway for access.

CASE HISTORY: The property was platted as Lot 33, Block 13, Replat of Part of Pawnee Ranch; Wichita, Sedgwick County, Kansas in February 16, 1950.

ADJACENT ZONING AND LAND USE:

NORTH:	SF-5	Single-family residences
SOUTH:	SF-5	Single-family residences
EAST:	SF-5	Single-family residences
WEST:	SF-5	Single-family residences

PUBLIC SERVICES: The subject property, currently, has access to East Range Road. Range Road is a paved residential street with a 60-foot right-of-way. The subject property is connected to public water and sewer. No negative impacts on public services are anticipated.

CONFORMANCE TO PLANS/POLICIES: The Wichita Land Use Guide of the
CON2010-00032

Comprehensive Plan designates this area as appropriate “urban residential” development. The one dwelling unit on the application area and the residential development surrounding the subject site would be considered “urban residential.” The policies of the Unified Zoning Code (UZC) allow one accessory apartment to be associated with a principle dwelling as a “Conditional Use” if the proposed use is compatible with the principle dwelling, is in character with the surrounding residential development, is accessory to the main structure, remains in a single ownership, and obtains water and sewer service from the main dwelling hook-up. As recommended for approval, the subject property conforms to adopted policies.

RECOMMENDATION: The application area is zoned SF-5, as is the surrounding residential neighborhood. The supplementary conditions of the UZC, along with building code requirements should ensure that the proposed accessory apartment is compatible with the surrounding residential neighborhood. Based upon information available prior to the public hearing, staff recommends that the request be **APPROVED**, subject to the following conditions:

1. The accessory apartment shall be subject to all requirements of Section III-D.6.a of the Unified Zoning Code.
2. The applicant shall obtain all applicable permits, including but not limited to: building, health, and zoning.
3. The site shall be developed in general conformance with the approved site plan.
4. Construction of improvements shall be completed within one year of approval of the Conditional Use.
5. If the Zoning Administrator finds that there is a violation of any of the conditions of the Conditional Use, the Zoning Administrator, in addition to enforcing the other remedies set forth in the Unified Zoning Code, may, with the concurrence of the Planning Director, declare the Conditional Use null and void.

The staff’s recommendation is based on the following findings:

1. **The zoning, uses and character of the neighborhood:** The character of the surrounding area is residential. All properties surrounding the subject property are zoned SF-5 and are developed as single-family residences. Given the size of the subject property, the proposed accessory apartment is compatible with the zoning, uses, and character of the neighborhood.
2. **The suitability of the subject property for the uses to which it has been restricted:** The site could continue to be used for a single-family residence. Accessory apartments are allowed as a “Conditional Use” in SF-5 provided the applicant and the site meet the specified criteria. The applicant and the site meet the criteria so long as the accessory apartment remains subordinate in size and remains as a single hook-up for water and sewer services.

3. **Extent to which removal of the restrictions will detrimentally affect nearby property:** Provided that the existing accessory apartment meets all applicable codes, the accessory use should have little to no affect on the surrounding properties.
4. **Conformance of the requested change to adopted or recognized Plans/Policies:** The Wichita Land Use Guide of the Comprehensive Plan designates this area as appropriate “urban residential” development. The two dwelling units on the application area are considered “low density residential.” The Unified Zoning Code makes specific provision for accessory apartments in SF-5. This application as recommended for approval complies with all the provisions outlined in the UZC for accessory apartments.
5. **Impact of the proposed development on community facilities:** The request should have a minimal impact on community facilities.



924 NORTH MAIN
WICHITA, KANSAS 67203

315-264-8008
FAX 264-4821

SAVOY, RUGGLES & BOHM, P. A. ENGINEERING & SURVEYING

Page 2 of 2

MORTGAGEE TITLE INSPECTION
(This Does Not Constitute A Boundary Survey)
Note: Positional tolerance of setback and offside
dimensions is 0.5± unless otherwise noted.)

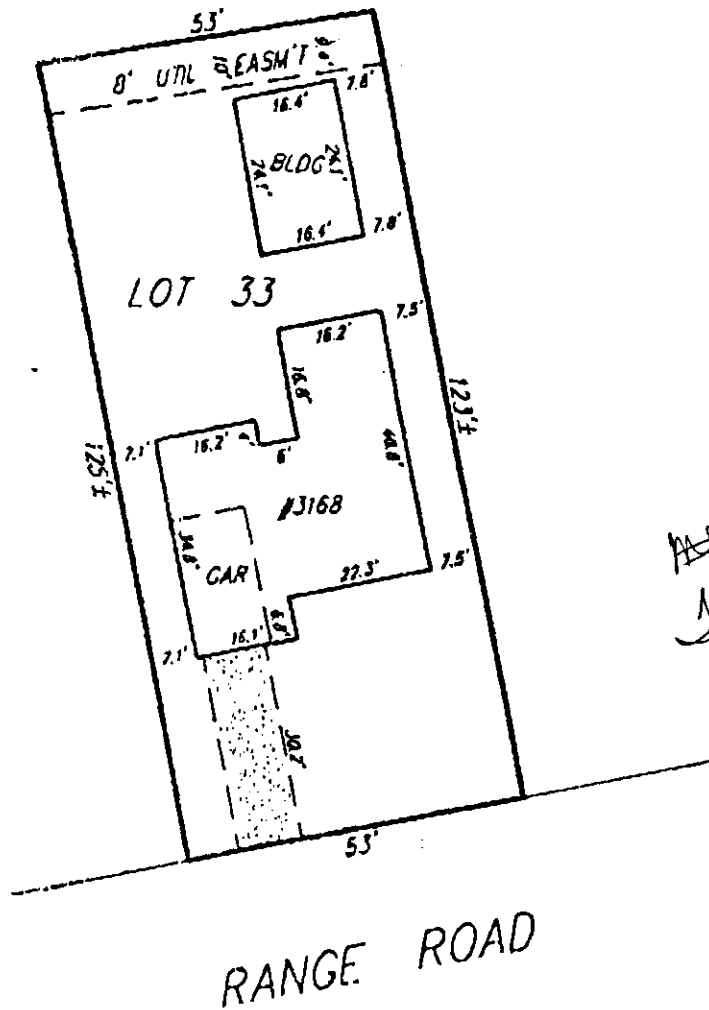

All the inches are in 104ms



DWG FILE: 051160-R.L.A.
PROJECT NO. 94J051160
PLA/PA FIRM 200328 0025 (3)
MAY 15, 1986
ZONE B

UTILITY

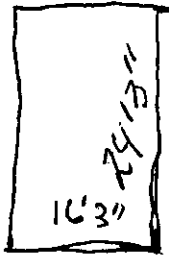

11'10"

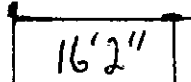

16'2"

47'8"

GAS

1/6" < 38 >



PORCH

0 WATER