

GENERAL NOTES

- Utility service lines, poles, valve boxes, meters, and etceteras are to be adjusted as necessary by others prior to construction unless the plans specifically call for their adjustment by the Contractor or unless the plans specifically identify a utility to be adjusted by its owner during construction. Existing utilities and their location, as shown on the plans, represent the best information obtainable for design. The Contractor will be required to work around existing utilities within the right-of-way which do not conflict with proposed construction.
- The Contractor will be required to provide a minimum advance notice of two (2) working days to utility companies prior to excavation or working adjacent to utilities.
 - Kansas One-Call 687-2470
 - Wichita Water Department (For Private City Utilities) 268-4555
 - Wichita Park Maintenance Department (For Irrigation) 350-3171
- Rubble from the removal of miscellaneous structures and excess excavation which is to be wasted shall be disposed of on sites to be provided by the Contractor. These sites shall be approved by the Engineer as to suitability, appearance and site location. Locations that, in the opinion of the Engineer, will leave an unsightly appearance will not be approved. All disposal sites must be approved by the Kansas Department of Health and Environment. Material either stockpiled or disposed of in a flood plain would require a Kansas State Board of Agriculture permit. Any material dumped in waters of the United States or wetlands is subject to U.S. Corps of Engineers permitting regulations. Any material buried or stockpiled beyond approved construction limits would require additional archaeological investigations unless buried in a previously approved borrow location.
- Contractor shall be responsible for implementing erosion control methods during construction to prevent unnecessary silt/sediment discharge through downstream properties and/or sewer systems. Contractor shall install and maintain erosion controls as needed during construction. These controls may include but not be limited to: straw wattles (fiber roll), silt fences, temporary mulching or other controls necessary to inhibit sediment runoff during construction.
- Unless otherwise noted, all work and materials shall conform to the appropriate sections of the 2015 edition "Standard Specifications for the State Road and Bridges Construction" by the Kansas Department of Transportation.
- Prior to bidding the project, each bidder shall visit the site and satisfy himself of surface & subsurface conditions. Each bidder shall also fully inform himself as to the extent of the scope of work to be performed.
- The Contractor shall comply with all applicable safety regulations.
- Temporary seeding shall be done using 4lbs/1,000 sq. ft. annual rye (PLS), variety to be approved by Park Department. The cost of seeding shall be SUBSIDIARY to "Seeding".
- All Elevations shown are based on NAVD 88 Datum.
- Proposed Paths to be Constructed Flush w/ Existing Surface Unless Otherwise Noted on Plans. Path Cross Slope to Match Existing Runoff Direction as Shown on Plans and at 2% Max.
- Excess Excavation to be Spread on Site as wall backfill while maintaining Positive Drainage throughout the Project Site.
- Excavation & Fill Required for Construction of the Proposed Sidewalks.
- Contractor shall be required to provide notice to Kansas One Call at 687-2470 a minimum of two (2) working days prior to any excavation or work adjacent to utilities.
- Existing utilities and their locations, as shown on the plans, represent the best information obtainable for design. Location information has been obtained from the various utility companies and is either from company record drawings or company provided field locations. The Contractor will be required to work around existing utilities which do not conflict with proposed construction.
- Traffic affected by the construction on this project shall be handled in accordance with the latest edition of the Local Manual on Uniform Traffic Control Devices.
- The Contractor shall verify all utility locations prior to construction of this project.
- Signing and striping shall be installed in accordance with Local City Specifications and Codes. Striping shall be painted markings in conformance with the latest edition of the Standard Specifications for State Road and Bridge Construction by the Kansas Department of Transportation.
- The Contractor shall receive written approval from adjacent landowners prior to proceeding with any construction work on landowner's property.
- The Contractor shall be responsible for all traffic control measures to facilitate construction. All Construction Zone markings and signage shall conform to the latest version of the Manual on Uniform Traffic Control Devices (MUTCD) as published by the US Dept. of Transportation, Federal Highway Administration. All costs associated with construction markings and signage shall be SUBSIDIARY to the lump sum Bid Item "Traffic Control".
- Existing trees are to remain. Do not stockpile materials or park vehicles under the drip line.

ARKANSAS RIVER EAST BANK RESTORATION PROJECT

CITY OF WICHITA, KANSAS

Paul Gunzelman, P.E. City Engineer

Project Number: 482-11090

Org Code Number: 44004424

Munis Number: R4010-2024 Park Facility Enhancement

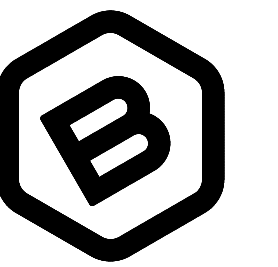

BAUGHMAN COMPANY

315 Ellis St.
Wichita, KS 67211
316-262-7271
BaughmanCo.com

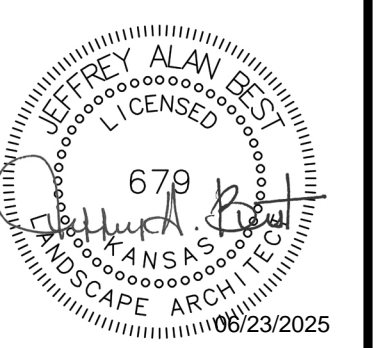

SHEET INDEX:

Cover Sheet	1
Demo Plan	2
Site Dimension Plan	3-5
Site Grading Plan	6-8
Site Erosion Control Plan	9
Details	10-11
Irrigation Plan	12
Landscape Plan	13

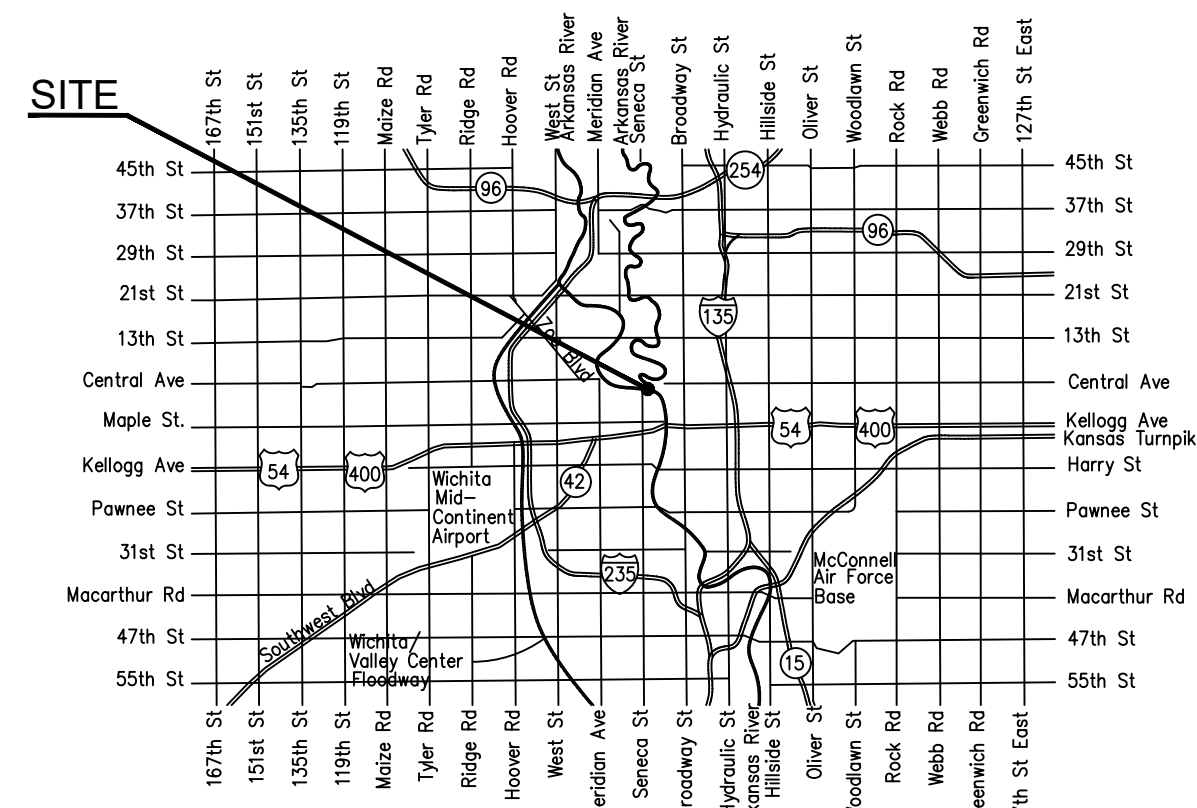
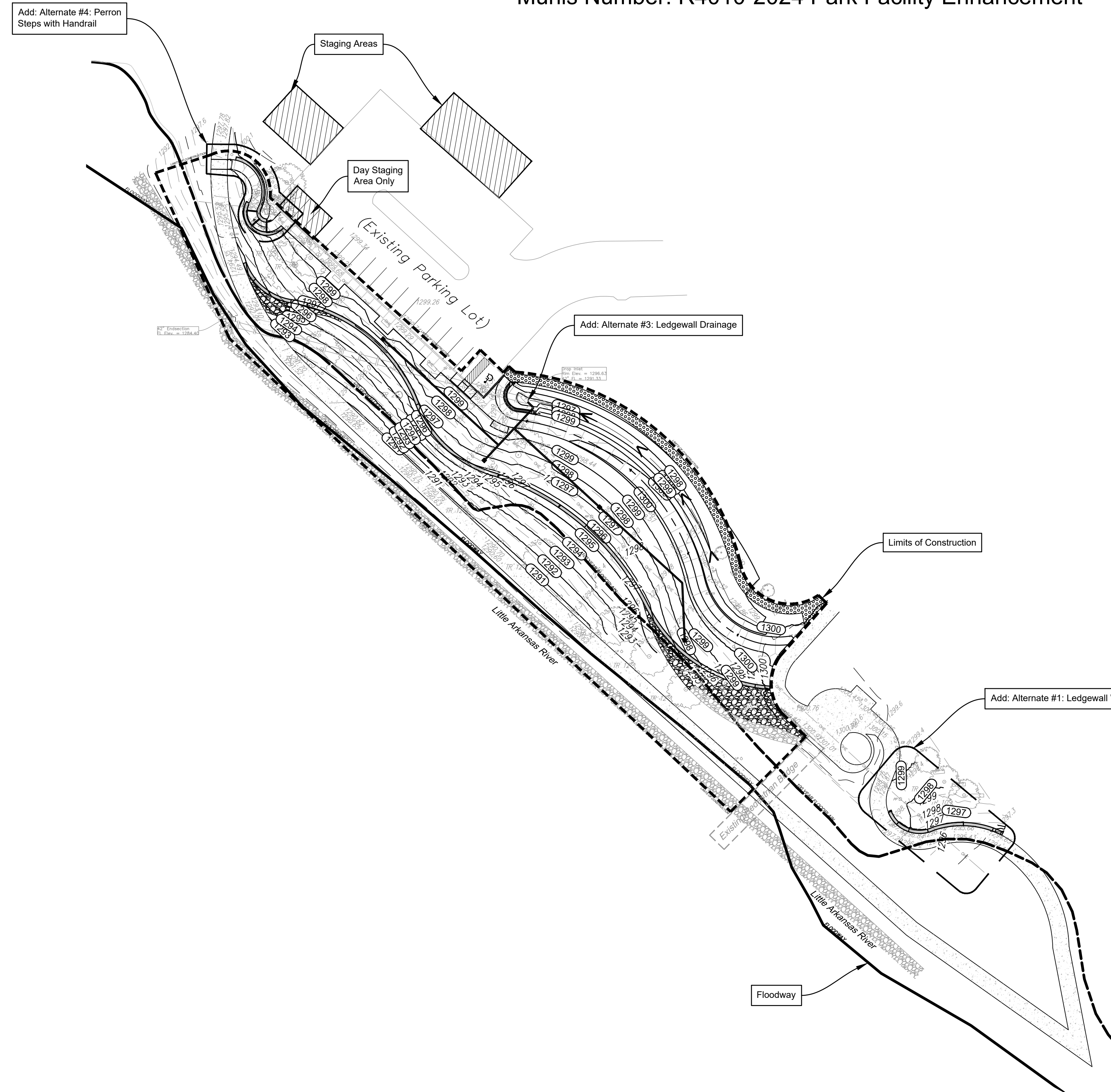
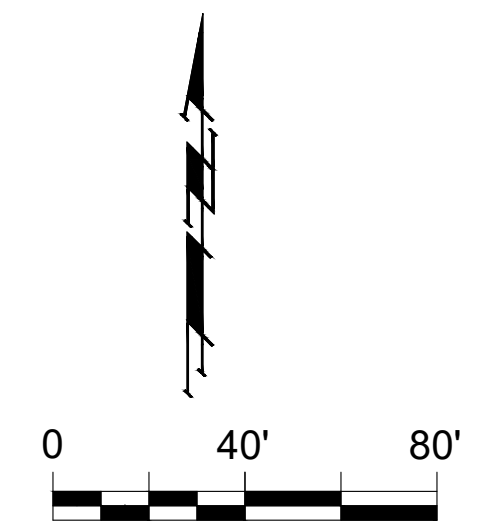

VICINITY MAP



CITY OF WICHITA
ARKANSAS RIVER EAST BANK RESTORATION PROJECT
Wichita, KS 67202
PROJ. NO: 472-2024-482-11090

REVISION: DATE:

PROJECT NUMBER:
24-10-E916

DESIGN: JAB DRAWN: JSG
DATE: 06/23/2025

COVER SHEET

SHEET **1** OF **13**

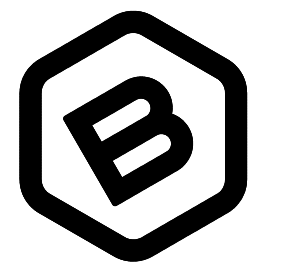

BAUGHMAN COMPANY

315 Ellis St.
Wichita, KS 67211
316-262-7271
BaughmanCo.com

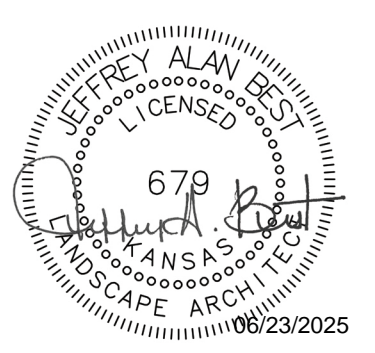

CITY OF WICHITA
ARKANSAS RIVER EAST BANK RESTORATION PROJECT
Wichita, KS 67202
PROJ. NO. 472-2024-482-11090

REVISION: DATE:

PROJECT NUMBER:
24-10-E916

DESIGN: JAB DRAWN: JSG
DATE: 06/23/2025

SITE DEMOLITION PLAN

SHEET **2** OF **13**

File: E:\Projects\County Acres 2nd Lot 481k 5_23-08-E572\Engineering

DEMOLITION NOTES

- Existing utilities and their locations, as shown on the plans, represent the best information obtainable for design. Location information has been obtained from the various utility companies and is either from company record drawings or company provided field locations. The Contractor will be required to work around existing utilities which do not conflict with proposed construction.
 - Traffic affected by construction on this project shall be handled in accordance with the latest edition of the Manual on Uniform Traffic Control Devices (MUTCD).
 - The Contractor shall provide appropriate signage throughout the sequence of construction clearly stating where construction entrances are.
 - The Contractor shall take all necessary precautions to protect the general public during the construction and demolition process. This may include the use of fences and signage.
 - The Contractor shall notify adjacent landowners prior to proceeding with any construction work on landowner's property.
- DEMOLITION**
- The Contractor shall dispose of all site debris and trash in addition to all removed materials in a safe, legal, and responsible manner.
 - The contractor shall remove all existing private signs and footings located on site as necessary for construction.
 - All existing pavement on site shall be removed shall be removed and disposed of in a safe, legal, and responsible manner. Removal shall include base course and sub grade as necessary.
 - The Contractor shall coordinate with local utility company on the removal of electric service lines, meters and poles located on site. Contractor shall ensure that all services are located and accounted for before disconnections begin to ensure that adjacent businesses are not affected.
 - The Contractor shall coordinate with local gas utility on the removal of gas services and meters located on site. Contractor shall ensure that all services are located and accounted for before disconnections begin to ensure that adjacent businesses are not affected.
 - The Contractor shall coordinate with AT&T and any other on-site telecommunications providers on the removal of telecommunications services on site if called for. Contractor shall ensure that all services are located and accounted for before disconnections begin to ensure that adjacent businesses are not affected.

LEGAL DESCRIPTION

A portion of Lot 1, Block 3, PARK PLAZA FIRST ADDITION, Wichita, Sedgwick County, Kansas.

SITE INFORMATION

Total Area: ±50,740.37 sq. ft. (1.16 acres)
 Disturbed Area: ±43,560.00 sq. ft. (1.00 acres)
 Impervious Area, pre-const: ± 6,833.52 sq. ft. (0.16 acres)
 Impervious Area, post-const: ±10,078.21 sq. ft. (0.23 acres)

BENCHMARKS

Site Benchmark - 1
 □ chiseled on top of NW edge of Power Pole Base
 Elevation = 1299.46 (NAVD 88)

KANSAS ONE CALL

Contractor shall be required to provide notice to Kansas One Call at 287-2470 a minimum of three (3) working days prior to any excavation or work adjacent to utilities.
 Kansas One Call 1-800-DIG-SAFE

UTILITY CONTACTS

The Contractor must notify the following in case of an emergency:

Kansas Gas Service (Gas).....1-888-482-4950
 Black Hills Energy (Gas).....1-800-303-0357
 Eergy (Electric).....383-8650
 Cox Communications (Telecommunication).....262-4270
 AT&T (Telecommunication).....268-2759
 City of Wichita Water Dept. (Water).....268-4563
 or 268-4908
 City of Wichita Sewer Maint. (San. Sewer).....268-4024
 or 262-6000
 City of Wichita Storm Sewer Maint. (Storm Sewer).....268-4090
 City of Wichita Traffic Maint. (Traf. Control).....268-4034
 or 268-4203
 Conoco Pipeline Co. (Petroleum).....1-800-231-2551
 Williams Pipeline Co. (Petroleum).....529-6600
 or 1-800-324-9696
 Phillips Pipeline Co. (Petroleum).....1-800-766-8230

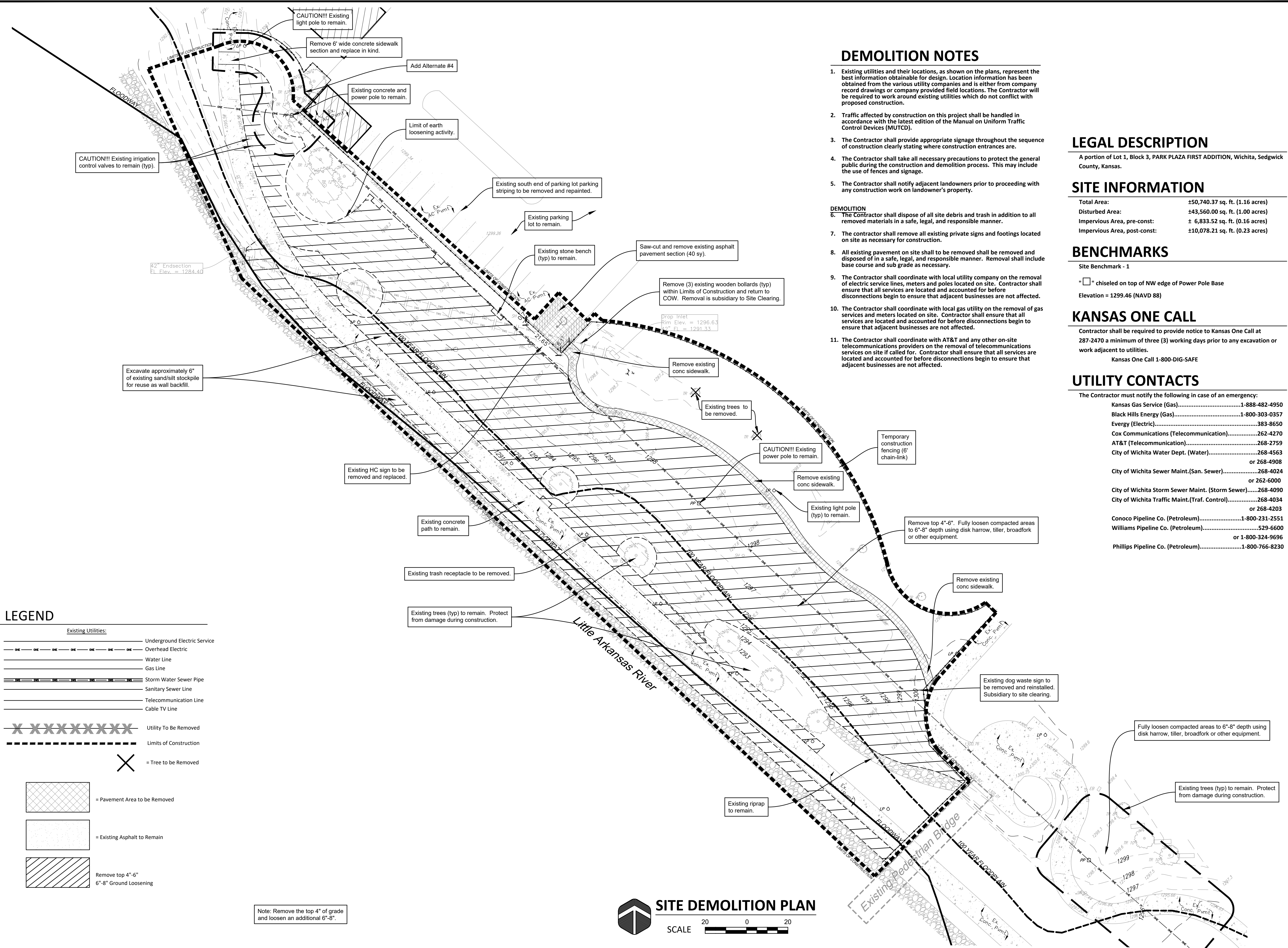

LEGEND

- Existing Utilities:**
- Underground Electric Service
 - Overhead Electric
 - Water Line
 - Gas Line
 - ==== Storm Water Sewer Pipe
 - Sanitary Sewer Line
 - Telecommunication Line
 - Cable TV Line
- X X X X X X X X X X Utility To Be Removed
 - - - - - Limits of Construction
 X = Tree to Be Removed
- [Cross-hatched] = Pavement Area to be Removed
 [Diagonal lines] = Existing Asphalt to Remain
 [Diagonal lines] Remove top 4"-6" 6"-8" Ground Loosening

Note: Remove the top 4" of grade and loosen an additional 6"-8".

SITE DEMOLITION PLAN

SCALE 20 0 20

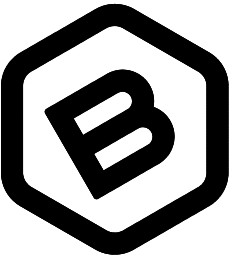

**BAUGHMAN
COMPANY**

315 Ellis St.
Wichita, KS 67211
316-262-7271
BaughmanCo.com

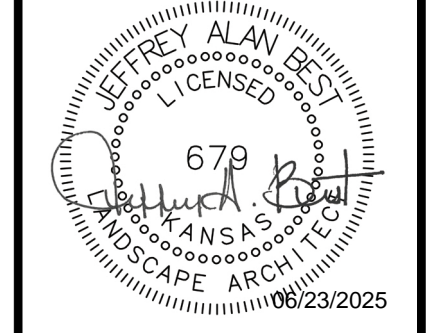

CITY OF WICHITA
ARKANSAS RIVER EAST BANK RESTORATION PROJECT
Wichita, KS 67202
PROJ. NO: 472-2024-482-11090

REVISION: DATE:

PROJECT NUMBER:
24-10-E916

DESIGN: JAB DRAWN: JSG

DATE: 06/23/2025

**SITE
DIMENSION
PLAN**

SHEET **3** OF **13**

File: E:\Projects\Country Acres 2nd Lot 4-Bk C_23-08-E916\Engineering

SITE NOTES

- Existing utilities and their locations, as shown on the plans, represent the best information obtainable for design. Location information has been obtained from the various utility companies and is either from company record drawings or company provided field locations. The Contractor will be required to work around existing utilities which do not conflict with proposed construction.
- Traffic affected by construction on this project shall be handled in accordance with the latest edition of the Manual on Uniform Traffic Control Devices (MUTCD).
- The Contractor shall provide appropriate signage throughout the sequence of construction clearly stating where construction entrances are.
- The Contractor shall take all necessary precautions to protect the general public during the construction and demolition process. This may include the use of fences and signage.
- The Contractor shall notify adjacent landowners prior to proceeding with any construction work on landowner's property.
- Signage and striping shall be installed in accordance with Local City Specifications and Codes. Striping shall be painted markings in conformance with the latest edition of the Standard Specifications for State Road and Bridge Construction by the Kansas Department of Transportation.
- Dimensions shown are to face of curb or edge of pavement unless otherwise noted.

LEGAL DESCRIPTION

A portion of Lot 1, Block 3, PARK PLAZA FIRST ADDITION, Wichita, Sedgwick County, Kansas.

SITE INFORMATION

Total Area: ±50,740.37 sq. ft. (1.16 acres)
Disturbed Area: ±43,560.00 sq. ft. (1.00 acres)
Impervious Area, pre-const: ± 6,833.52 sq. ft. (0.16 acres)
Impervious Area, post-const: ±10,078.21 sq. ft. (0.23 acres)

BENCHMARKS

Site Benchmark - 1
" " chiseled on top of NW edge of Power Pole Base
Elevation = 1299.46 (NAVD 88)

KANSAS ONE CALL

Contractor shall be required to provide notice to Kansas One Call at 287-2470 a minimum of three (3) working days prior to any excavation or work adjacent to utilities.
Kansas One Call 1-800-DIG-SAFE

UTILITY CONTACTS

The Contractor must notify the following in case of an emergency:

Kansas Gas Service (Gas).....	1-888-482-4950
Black Hills Energy (Gas).....	1-800-303-0357
Energry (Electric).....	383-8650
Cox Communications (Telecommunication).....	262-4270
AT&T (Telecommunication).....	268-2759
City of Wichita Water Dept. (Water).....	268-4563
or 268-4908	
City of Wichita Sewer Maint.(San. Sewer).....	268-4024
or 262-6000	
City of Wichita Storm Sewer Maint. (Storm Sewer).....	268-4090
City of Wichita Traffic Maint.(Traf. Control).....	268-4034
or 268-4203	
Conoco Pipeline Co. (Petroleum).....	1-800-231-2551
Williams Pipeline Co. (Petroleum).....	529-6600
or 1-800-324-9696	
Phillips Pipeline Co. (Petroleum).....	1-800-766-8230

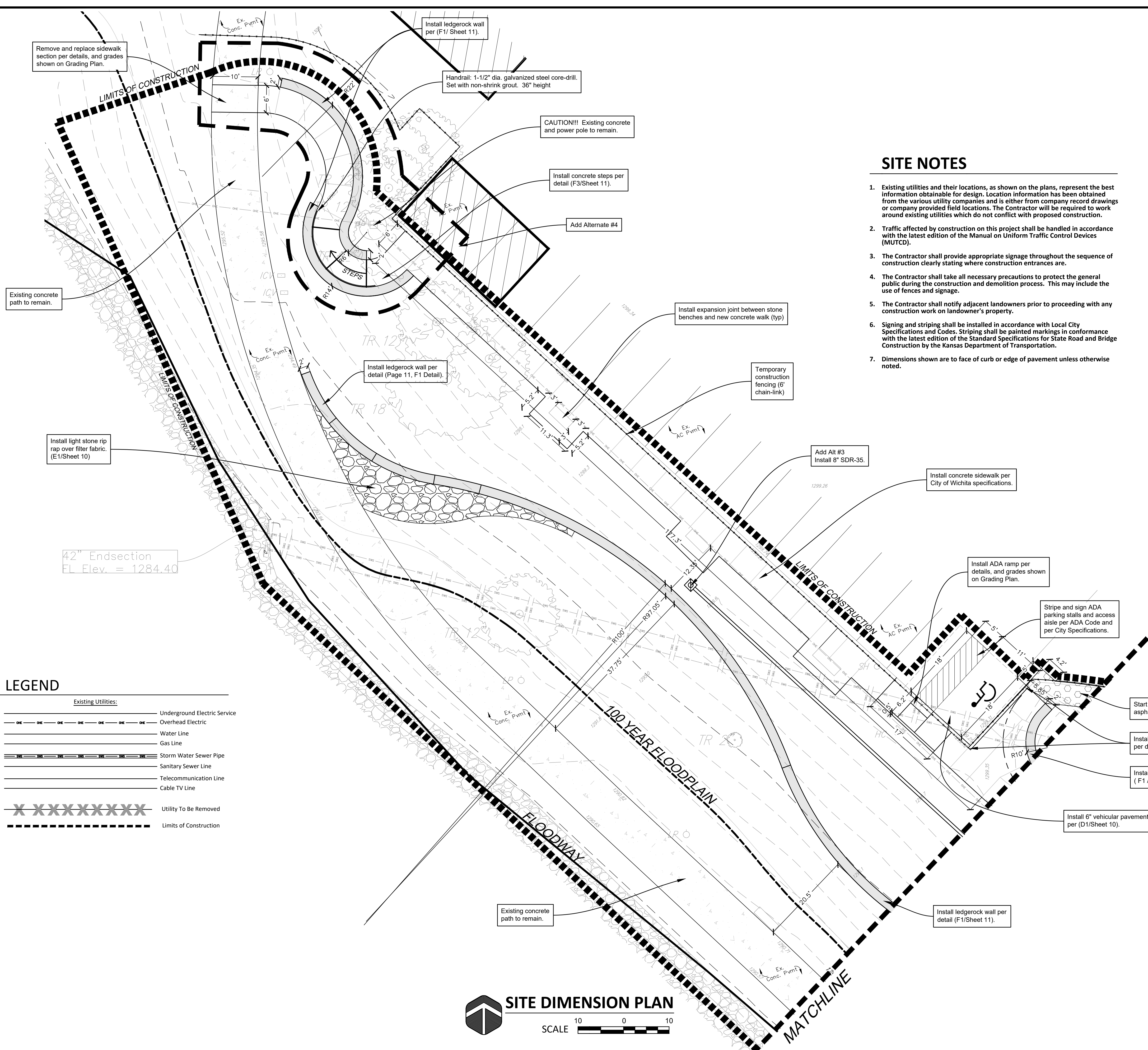

LEGEND

<u>Existing Utilities:</u>	
	Underground Electric Service
	Overhead Electric
	Water Line
	Gas Line
	Storm Water Sewer Pipe
	Sanitary Sewer Line
	Telecommunication Line
	Cable TV Line
	Utility To Be Removed
	Limits of Construction

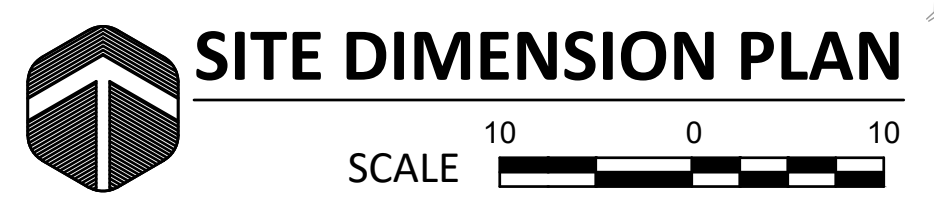

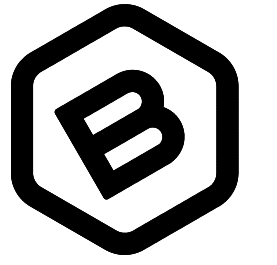

**BAUGHMAN
COMPANY**

315 Ellis St.
Wichita, KS 67211
316-262-7271
BaughmanCo.com

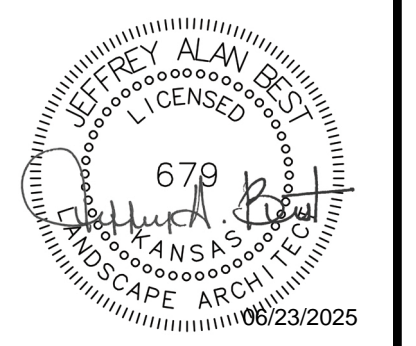

CITY OF WICHITA
ARKANSAS RIVER EAST BANK RESTORATION PROJECT
Wichita, KS 67202
PROJ. NO: 472-2024-482-11090

REVISION: DATE:

PROJECT NUMBER:
24-10-E916

DESIGN: JAB DRAWN: JSG

DATE: 06/23/2025

**SITE
DIMENSION
PLAN**

SHEET **4** OF **13**

File: E:\Projects\County Acres 2nd Lot 4-BK 5_23-08-ES72\Engineering

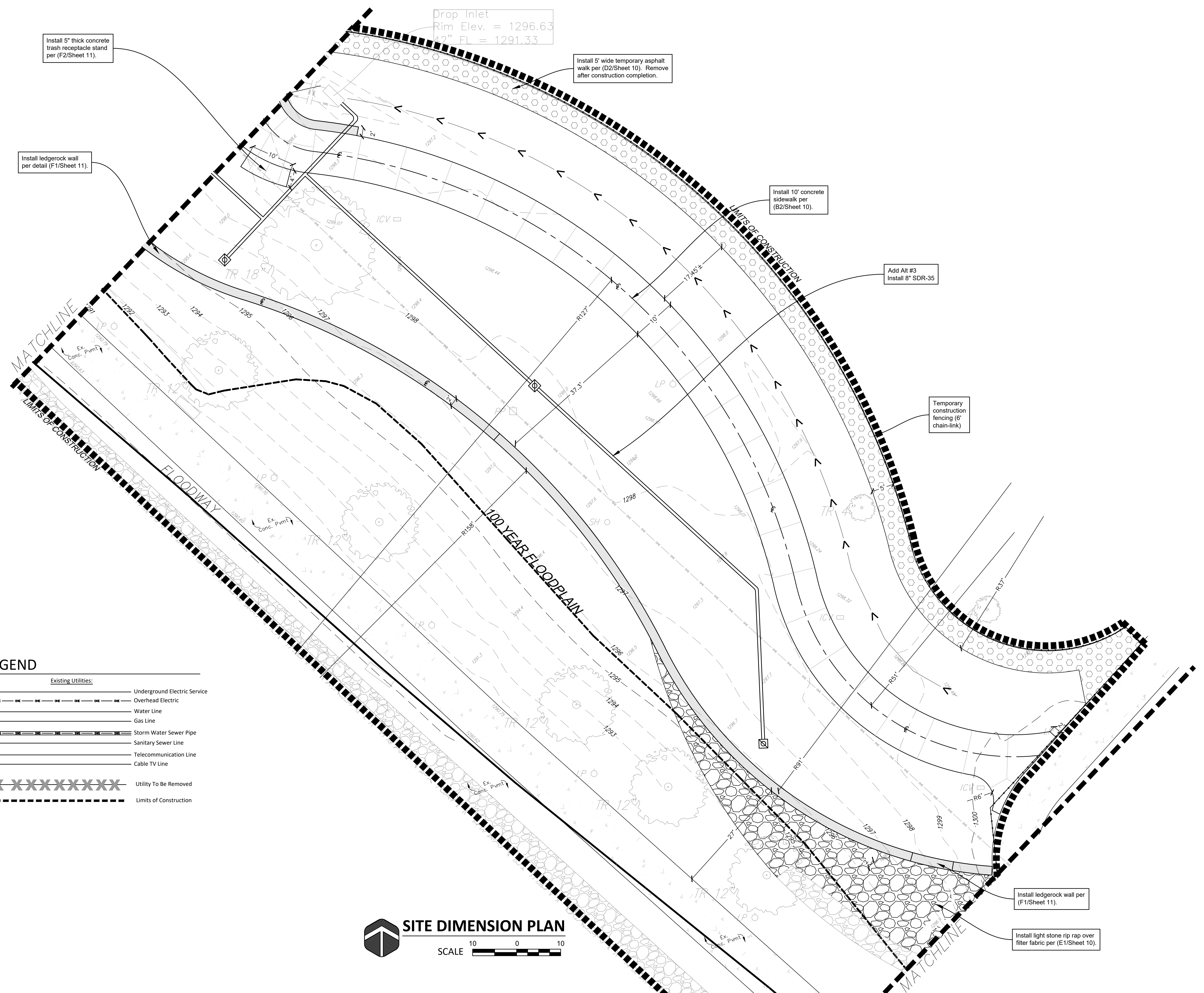

LEGEND

Existing Utilities:

	Underground Electric Service
	Overhead Electric
	Water Line
	Gas Line
	Storm Water Sewer Pipe
	Sanitary Sewer Line
	Telecommunication Line
	Cable TV Line
	Utility To Be Removed
	Limits of Construction

SITE DIMENSION PLAN
SCALE 10 0 10

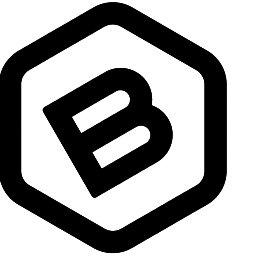

**BAUGHMAN
COMPANY**

315 Ellis St.
Wichita, KS 67211
316-262-7271
BaughmanCo.com

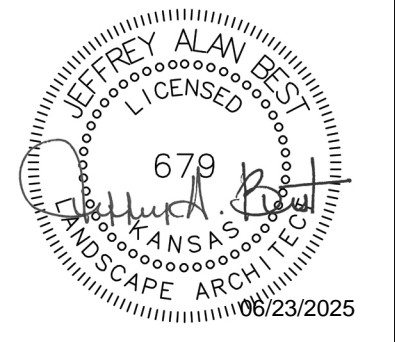

CITY OF WICHITA
ARKANSAS RIVER EAST BANK RESTORATION PROJECT
Wichita, KS 67202
PROJ. NO: 472-2024-482-11090

REVISION: DATE:

PROJECT NUMBER:
24-10-E916

DESIGN: JAB DRAWN: JSG

DATE: 06/23/2025

**SITE
DIMENSION
PLAN**

SHEET **5** OF **13**

File: E:\Projects\Country Acres 2nd Lot 4-BLK 5_23-08-ES77\Engineering

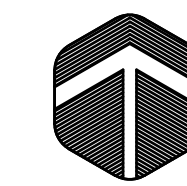
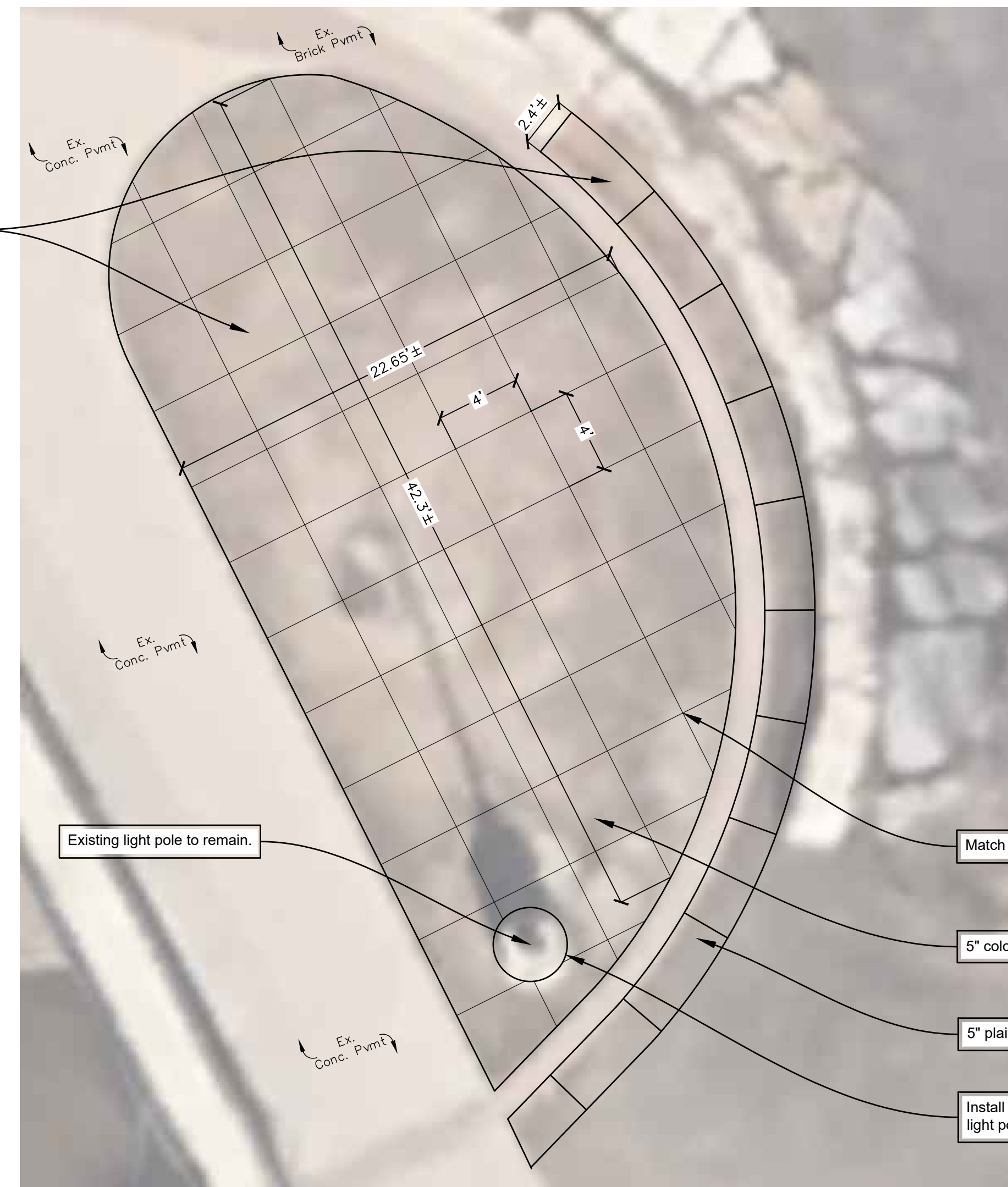

ADD ALTERNATE #2

SCALE 5 0 5

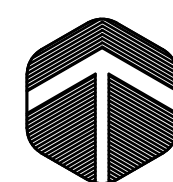

SITE DIMENSION PLAN

SCALE 10 0 10

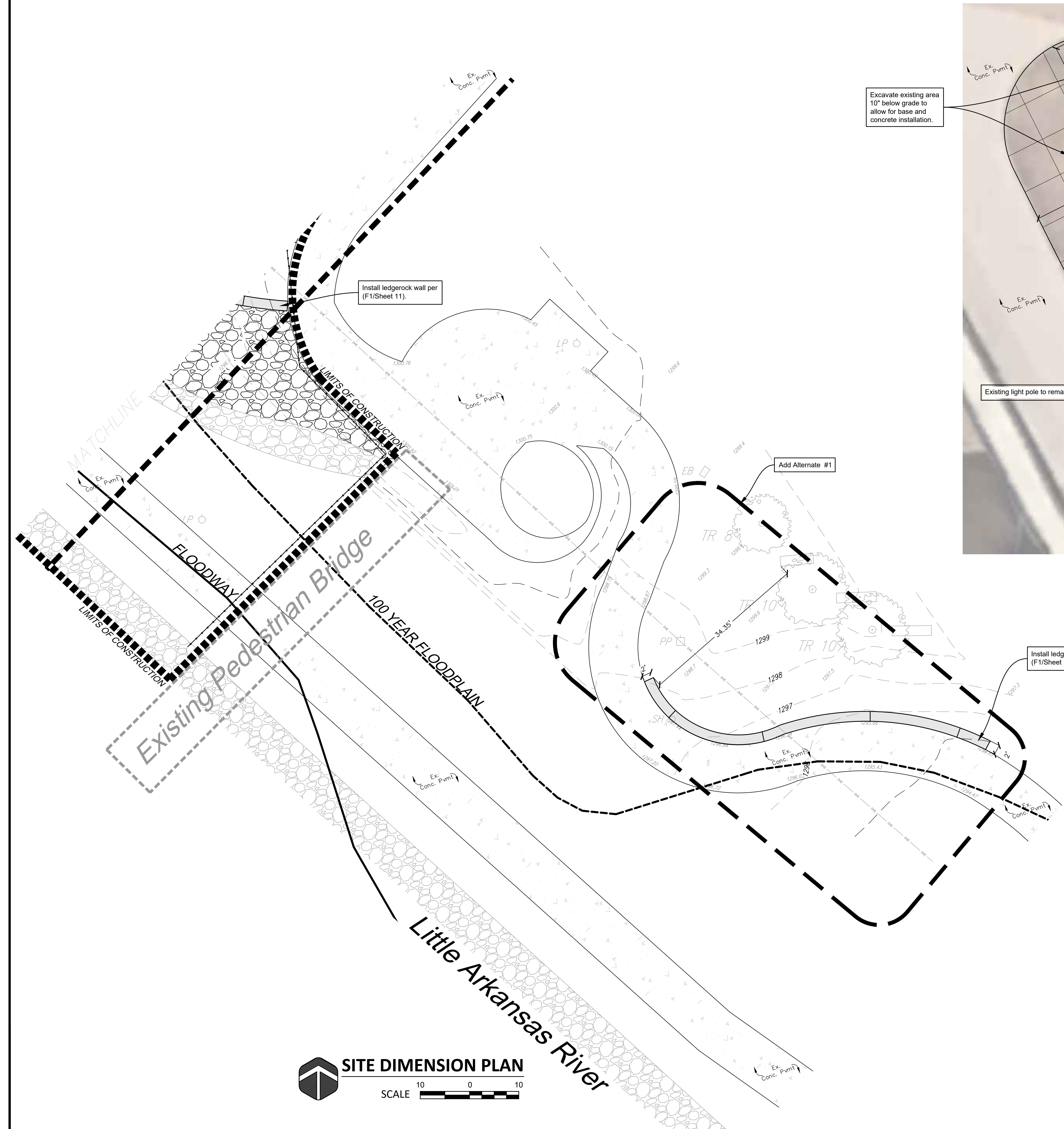

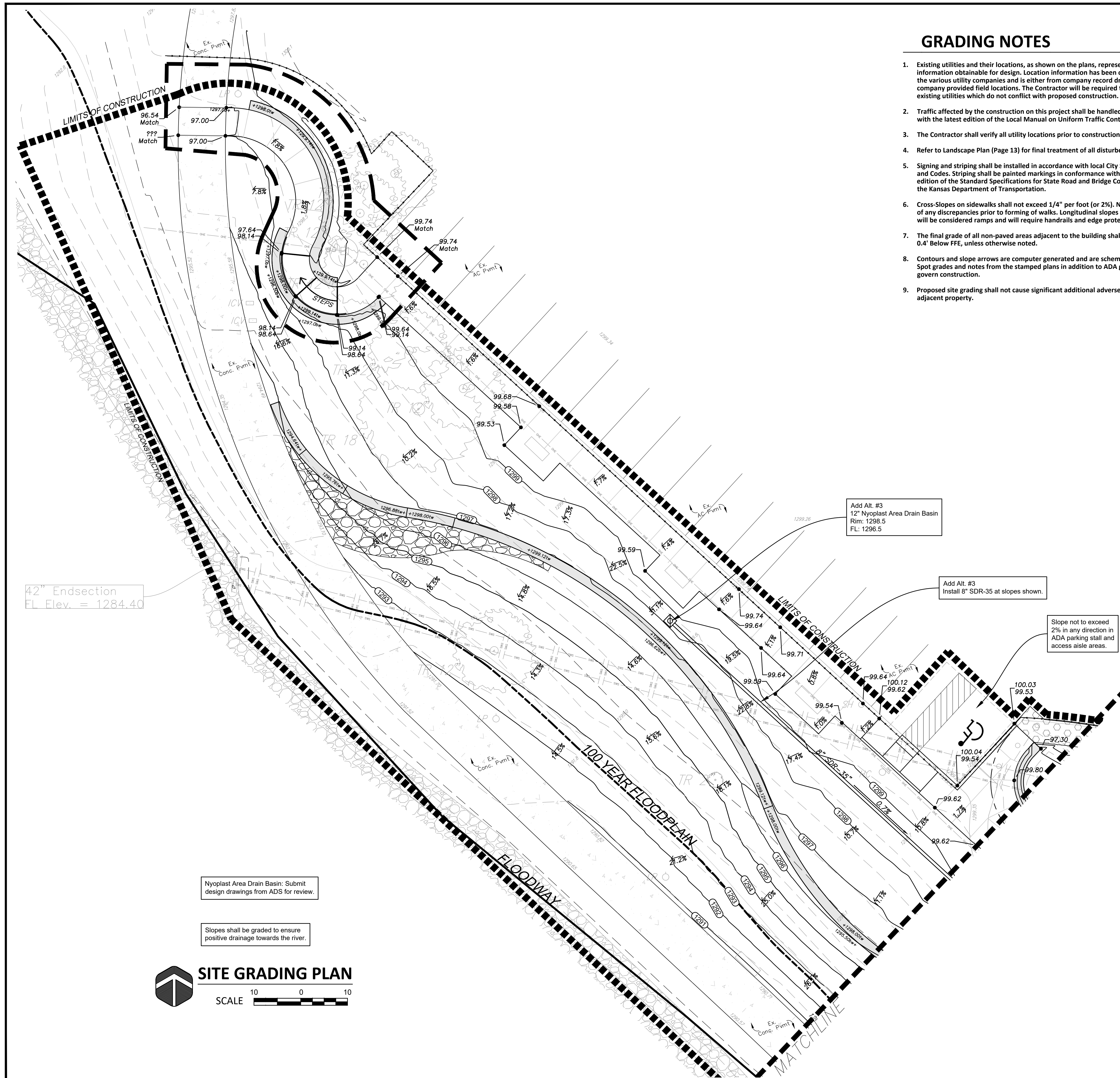

GRADING NOTES

- Existing utilities and their locations, as shown on the plans, represent the best information obtainable for design. Location information has been obtained from the various utility companies and is either from company record drawings or company provided field locations. The Contractor will be required to work around existing utilities which do not conflict with proposed construction.
- Traffic affected by the construction on this project shall be handled in accordance with the latest edition of the Local Manual on Uniform Traffic Control Devices.
- The Contractor shall verify all utility locations prior to construction of this project.
- Refer to Landscape Plan (Page 13) for final treatment of all disturbed areas.
- Signing and striping shall be installed in accordance with local City Specifications and Codes. Striping shall be painted markings in conformance with the latest edition of the Standard Specifications for State Road and Bridge Construction by the Kansas Department of Transportation.
- Cross-Slopes on sidewalks shall not exceed 1/4" per foot (or 2%). Notify Engineer of any discrepancies prior to forming of walks. Longitudinal slopes that exceed 5% will be considered ramps and will require handrails and edge protection per ADA.
- The final grade of all non-paved areas adjacent to the building shall be set at least 0.4' Below FFE, unless otherwise noted.
- Contours and slope arrows are computer generated and are schematic in nature. Spot grades and notes from the stamped plans in addition to ADA guidelines shall govern construction.
- Proposed site grading shall not cause significant additional adverse impacts on adjacent property.

LEGAL DESCRIPTION

A portion of Lot 1, Block 3, PARK PLAZA FIRST ADDITION, Wichita, Sedgwick County, Kansas.

SITE INFORMATION

Total Area:	±50,740.37 sq. ft. (1.16 acres)
Disturbed Area:	±43,560.00 sq. ft. (1.00 acres)
Impervious Area, pre-const:	± 6,833.52 sq. ft. (0.16 acres)
Impervious Area, post-const:	±10,078.21 sq. ft. (0.23 acres)

BENCHMARKS

Site Benchmark - 1
 chiseled on top of NW edge of Power Pole Base
 Elevation = 1299.46 (NAVD 88)

KANSAS ONE CALL

Contractor shall be required to provide notice to Kansas One Call at 287-2470 a minimum of three (3) working days prior to any excavation or work adjacent to utilities.
 Kansas One Call 1-800-DIG-SAFE

UTILITY CONTACTS

The Contractor must notify the following in case of an emergency:

Kansas Gas Service (Gas)	1-888-482-4950
Black Hills Energy (Gas)	1-800-303-0357
Every (Electric)	383-8650
Cox Communications (Telecommunication)	262-4270
AT&T (Telecommunication)	268-2759
City of Wichita Water Dept. (Water)	268-4563 or 268-4908
City of Wichita Sewer Maint. (San. Sewer)	268-4024 or 262-6000
City of Wichita Storm Sewer Maint. (Storm Sewer)	268-4090
City of Wichita Traffic Maint. (Traf. Control)	268-4034 or 268-4203
Conoco Pipeline Co. (Petroleum)	1-800-231-2551
Williams Pipeline Co. (Petroleum)	529-6600 or 1-800-324-9696
Phillips Pipeline Co. (Petroleum)	1-800-766-8230

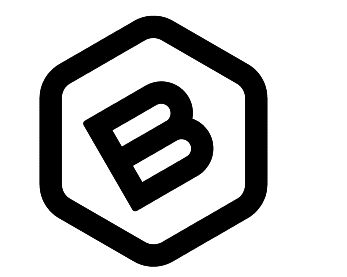

BAUGHMAN COMPANY
 315 Ellis St.
 Wichita, KS 67211
 316-262-7271
 BaughmanCo.com

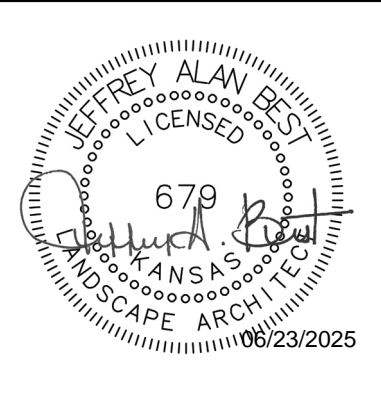

CITY OF WICHITA
 ARKANSAS RIVER EAST BANK RESTORATION PROJECT
 Wichita, KS 67202
 PROJ. NO. 472-2024-482-11090

REVISION: DATE:

PROJECT NUMBER:
 24-10-E916
 DESIGN: JAB DRAWN: JSG
 DATE: 06/23/2025

SITE GRADING PLAN

SHEET **6** OF **13**

File: E:\Projects\County Areas 2nd Lot 4\Bk 5_23-08-E572\Engineering

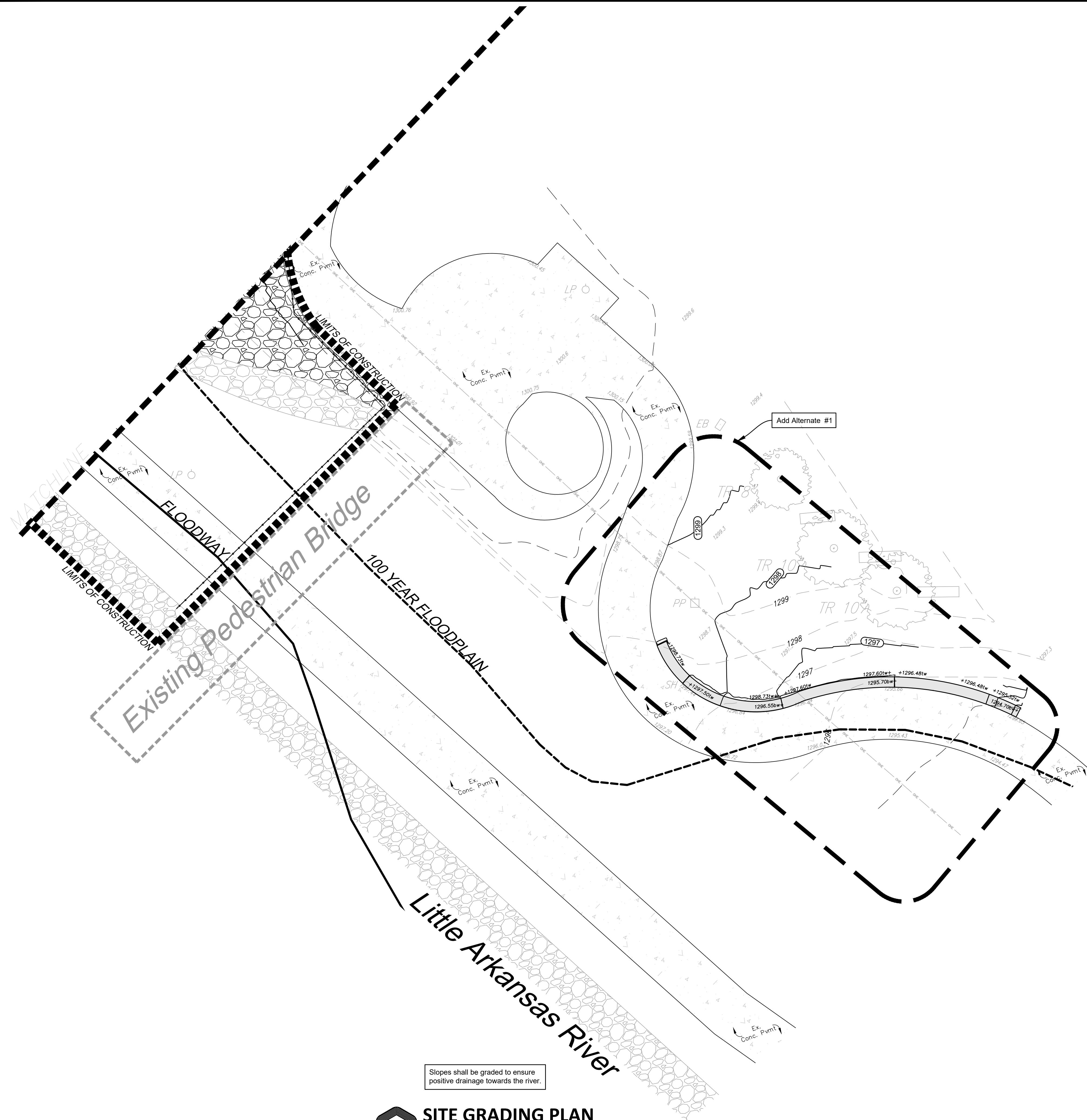

Slopes shall be graded to ensure positive drainage towards the river.

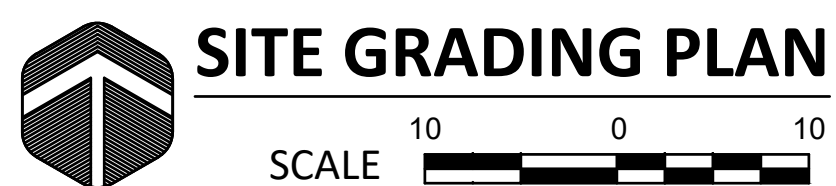

LEGAL DESCRIPTION

A portion of Lot 1, Block 3, PARK PLAZA FIRST ADDITION, Wichita, Sedgwick County, Kansas.

SITE INFORMATION

Total Area: ±50,740.37 sq. ft. (1.16 acres)
 Disturbed Area: ±43,560.00 sq. ft. (1.00 acres)
 Impervious Area, pre-const: ± 6,833.52 sq. ft. (0.16 acres)
 Impervious Area, post-const: ±10,078.21 sq. ft. (0.23 acres)

BENCHMARKS

Site Benchmark - 1
 "□" chiseled on top of NW edge of Power Pole Base
 Elevation = 1299.46 (NAVD 88)

KANSAS ONE CALL

Contractor shall be required to provide notice to Kansas One Call at 287-2470 a minimum of three (3) working days prior to any excavation or work adjacent to utilities.

Kansas One Call 1-800-DIG-SAFE

UTILITY CONTACTS

The Contractor must notify the following in case of an emergency:

- Kansas Gas Service (Gas).....1-888-482-4950
- Black Hills Energy (Gas).....1-800-303-0357
- Evergy (Electric).....383-8650
- Cox Communications (Telecommunication).....262-4270
- AT&T (Telecommunication).....268-2759
- City of Wichita Water Dept. (Water).....268-4563
or 268-4908
- City of Wichita Sewer Maint.(San. Sewer).....268-4024
or 262-6000
- City of Wichita Storm Sewer Maint. (Storm Sewer).....268-4090
- City of Wichita Traffic Maint.(Traf. Control).....268-4034
or 268-4203
- Conoco Pipeline Co. (Petroleum).....1-800-231-2551
- Williams Pipeline Co. (Petroleum).....529-6600
or 1-800-324-9696
- Phillips Pipeline Co. (Petroleum).....1-800-766-8230

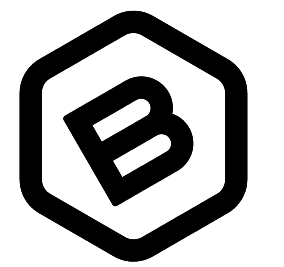

**BAUGHMAN
COMPANY**

315 Ellis St.
Wichita, KS 67211
316-262-7271
BaughmanCo.com

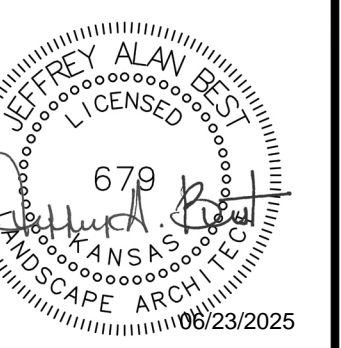

CITY OF WICHITA
 ARKANSAS RIVER EAST BANK RESTORATION PROJECT
 Wichita, KS 67202
 PROJ. NO. 472-2024-482-11090

REVISION: DATE:

PROJECT NUMBER:
24-10-E916

DESIGN: JAB DRAWN: JSG

DATE: 06/23/2025

**SITE
GRADING
PLAN**

SHEET **8** OF **13**

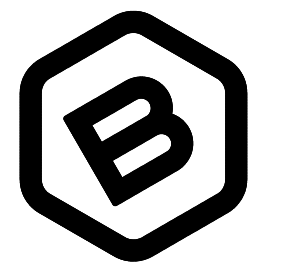

BAUGHMAN COMPANY

315 Ellis St.
Wichita, KS 67211
316-262-7271
BaughmanCo.com



CITY OF WICHITA
ARKANSAS RIVER EAST BANK RESTORATION PROJECT
Wichita, KS 67202
PROJ. NO: 472-2024-482-11090

REVISION: DATE:

PROJECT NUMBER:
24-10-E916

DESIGN: JAB DRAWN: JSG
DATE: 06/23/2025

EROSION CONTROL PLAN

SHEET **9** OF **13**

File: E:\Projects\County Areas 2nd Lot 4\Bk 5_23-08-E916\Engineering

LEGAL DESCRIPTION

A portion of Lot 1, Block 3, PARK PLAZA FIRST ADDITION, Wichita, Sedgwick County, Kansas.

SITE INFORMATION

Total Area: ±50,740.37 sq. ft. (1.16 acres)
Disturbed Area: ±43,560.00 sq. ft. (1.00 acres)
Impervious Area, pre-const: ± 6,833.52 sq. ft. (0.16 acres)
Impervious Area, post-const: ±10,078.21 sq. ft. (0.23 acres)

BENCHMARKS

Site Benchmark - 1
" " chiseled on top of NW edge of Power Pole Base
Elevation = 1299.46 (NAVD 88)

KANSAS ONE CALL

Contractor shall be required to provide notice to Kansas One Call at 287-2470 a minimum of three (3) working days prior to any excavation or work adjacent to utilities.
Kansas One Call 1-800-DIG-SAFE

UTILITY CONTACTS

The Contractor must notify the following in case of an emergency:
Kansas Gas Service (Gas).....1-888-482-4950
Black Hills Energy (Gas).....1-800-303-0357
Energry (Electric).....383-8650
Cox Communications (Telecommunication).....262-4270
AT&T (Telecommunication).....268-2759
City of Wichita Water Dept. (Water).....268-4563
or 268-4908
City of Wichita Sewer Maint. (San. Sewer).....268-4024
or 262-6000
City of Wichita Storm Sewer Maint. (Storm Sewer).....268-4090
City of Wichita Traffic Maint. (Traf. Control).....268-4034
or 268-4203
Conoco Pipeline Co. (Petroleum).....1-800-231-2551
Williams Pipeline Co. (Petroleum).....529-6600
or 1-800-324-9696
Phillips Pipeline Co. (Petroleum).....1-800-766-8230

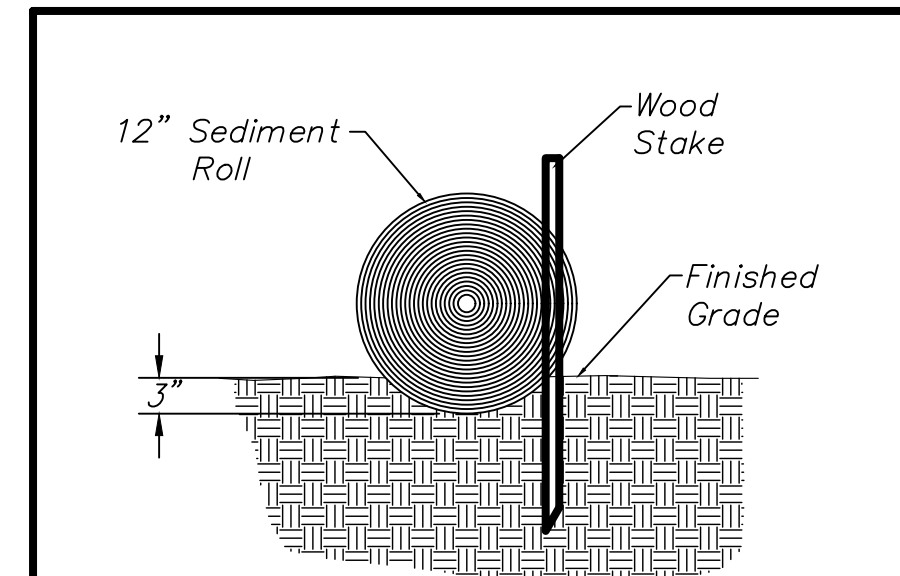

FIBER ROLL
Entrenchment Detail for Flat Area

NOTES:
Roll installation, trench 2-4 inches deep along proposed installation route and place fiber rolls in trench.
Stake both sides of roll within 6 ft. of each end.
Provide a tight joint where rolls abutt each other.
Aspen Wood Fibers or approved equal inside roll.

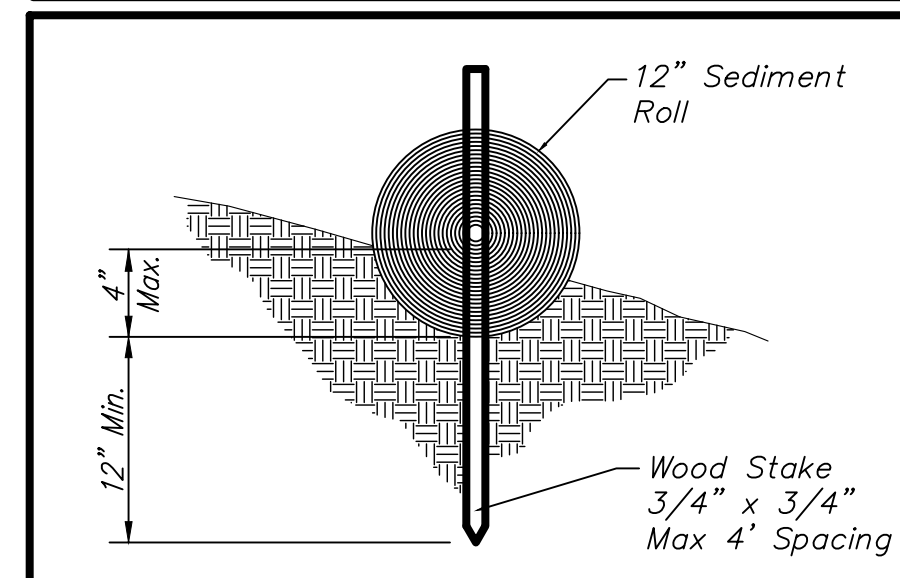

FIBER ROLL
Entrenchment Detail for Slope Area

NOTES:
Roll installation, trench 2-4 inches deep along proposed installation route and place fiber rolls in trench.
Stake both sides of roll within 6 ft. of each end.
Provide a tight joint where rolls abutt each other.
Aspen Wood Fibers or approved equal inside roll.

2 FIBER ROLL DETAIL

NOT TO SCALE

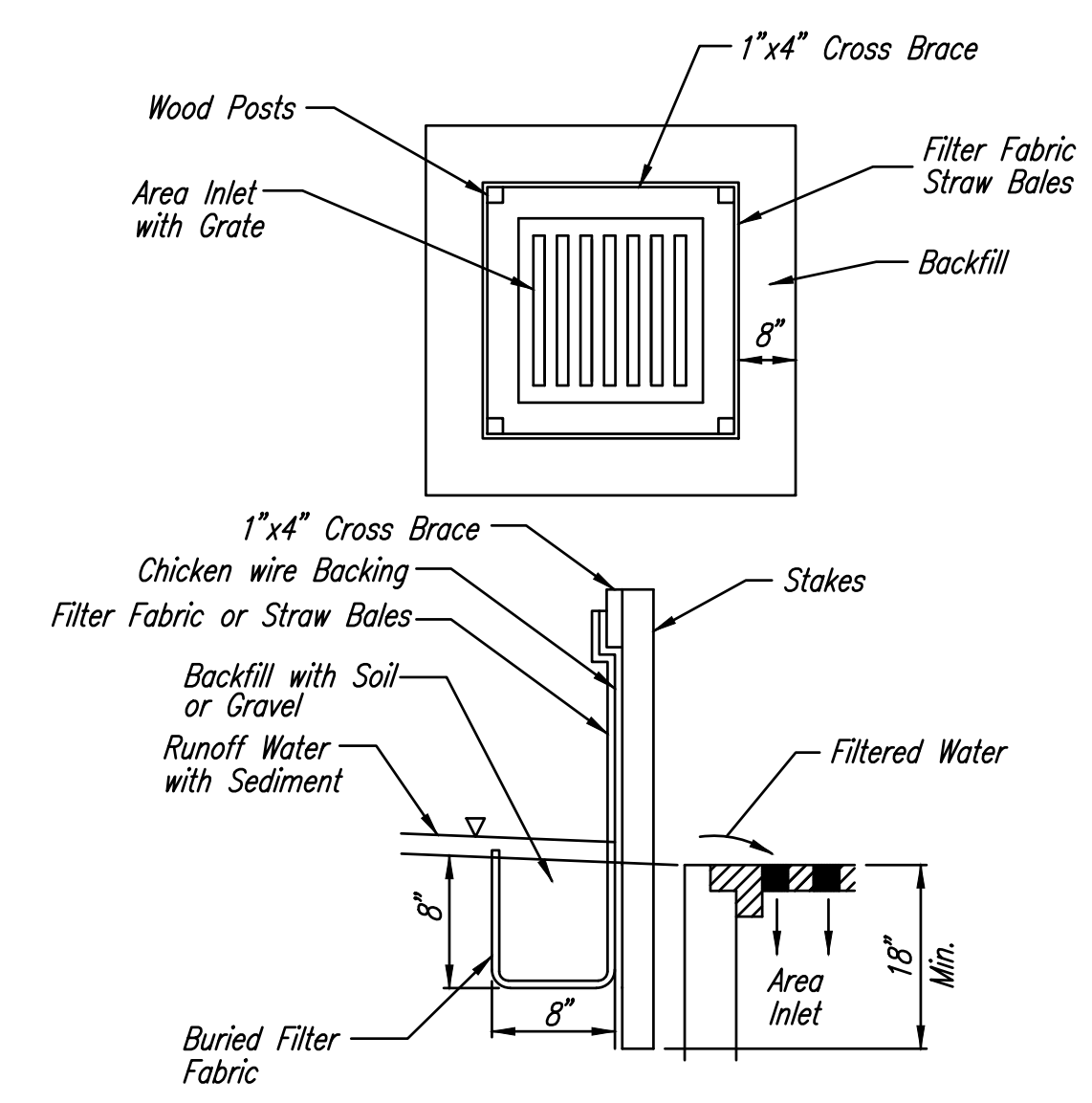

1 INLET PROTECTION FOR AREA INLETS

(INLET PROTECTION: SILT FENCE OR STRAW BALES)

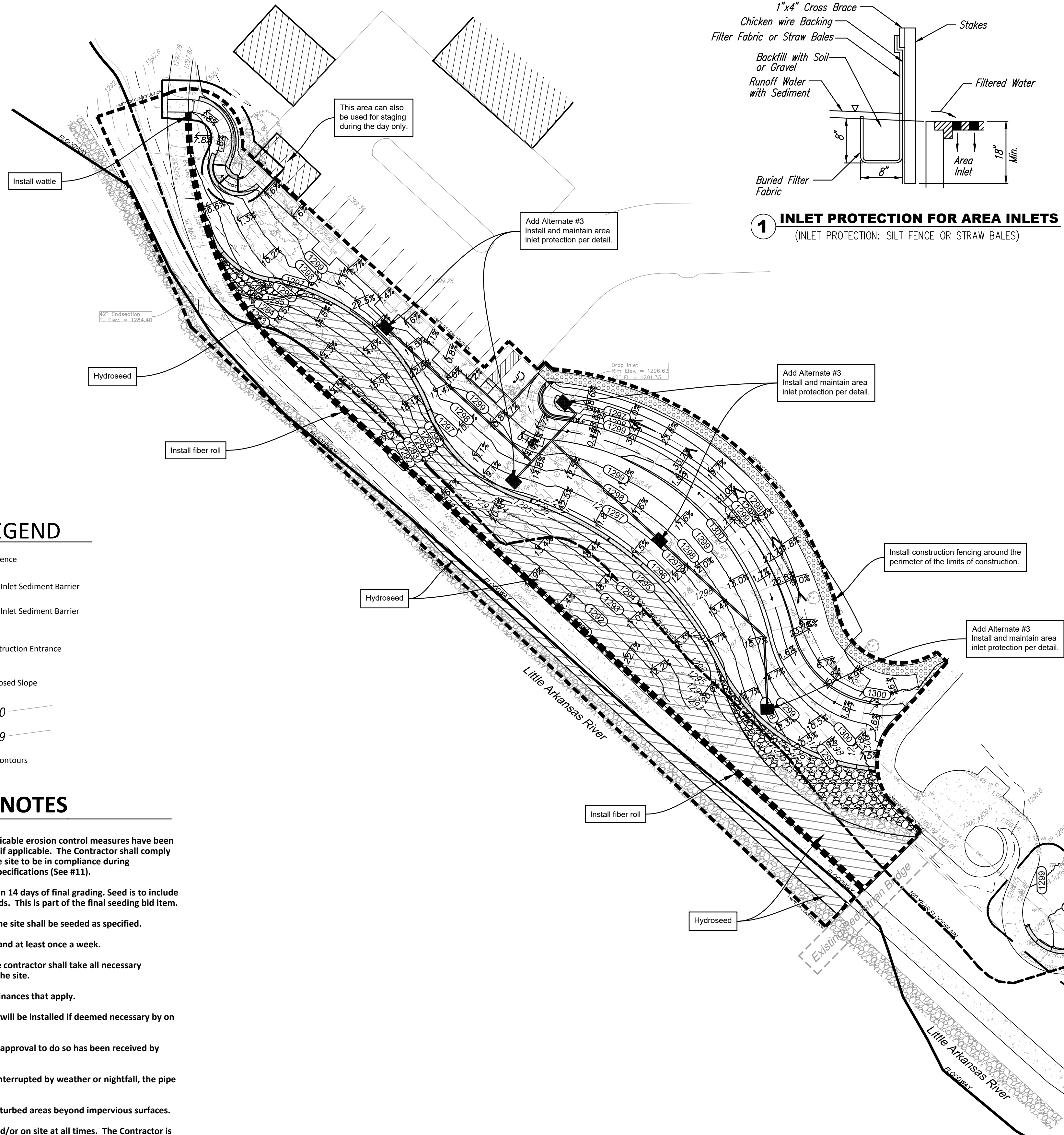

EROSION CONTROL LEGEND

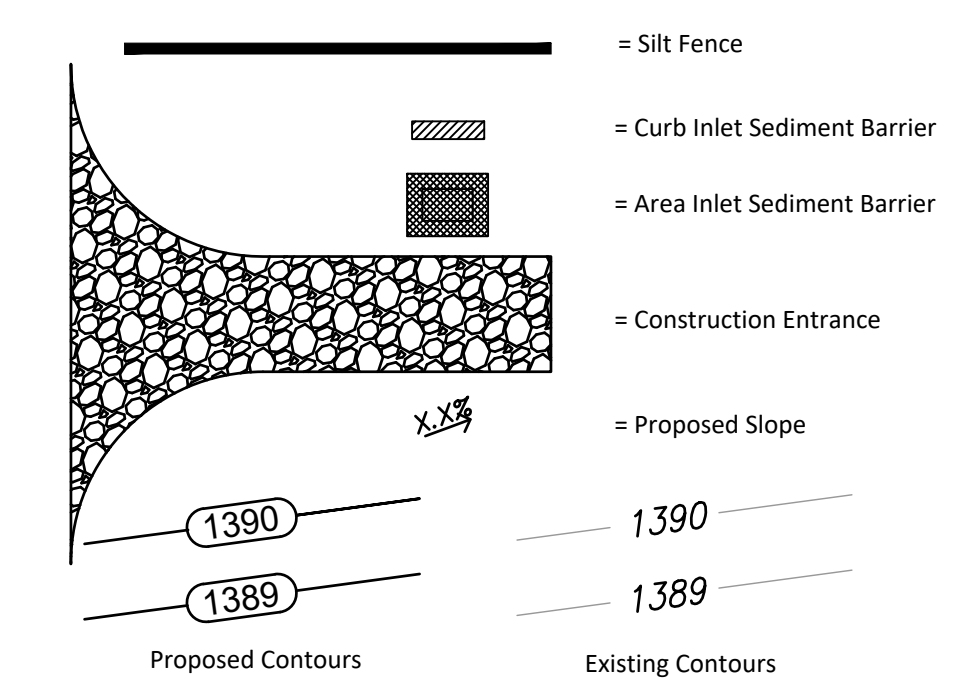

EROSION CONTROL NOTES

- No land clearing or grading shall begin until all applicable erosion control measures have been installed. This project is subject to this SWPP Plan, if applicable. The Contractor shall comply with any unusual requirements as necessary for the site to be in compliance during construction, per this plan and per City and State specifications (See #11).
- All exposed areas shall be seeded as specified within 14 days of final grading. Seed is to include straw mulch, crimped in place per industry standards. This is part of the final seeding bid item.
- Should construction stop for longer than 14 days, the site shall be seeded as specified.
- Maintain erosion control measures after each rain and at least once a week.
- This plan shall not be considered all inclusive as the contractor shall take all necessary precautions to prevent soil sediment from leaving the site.
- Contractor shall comply with all state and local ordinances that apply.
- Additional erosion and sediment control measures will be installed if deemed necessary by on site inspection.
- Land disturbing activities shall not commence until approval to do so has been received by governing authorities.
- If installation of storm drainage system should be interrupted by weather or nightfall, the pipe ends shall be covered with filter fabric.
- See Landscape Plan for ground treatments in all disturbed areas beyond impervious surfaces.
- This Erosion Control Plan should be in job trailer and/or on site at all times. The Contractor is responsible for any needed changes, updates or maintenance to BMP's on site. This plan may change and updates need to be recorded and documented on the plan. This plan is a flexible plan, due to changing site conditions and weather. Please inform Landscape Architect and/or Engineer of changes to plan.
- ANY substitutions for the sediment control devices shown, must be approved by the Landscape Architect and/or Engineer prior to any uses on site.
- If site disturbance is over 1 acre, an NPDES Permit Application has been submitted for this property and a copy of this application must be kept at the job site for the duration of the construction process.

EROSION CONTROL PLAN

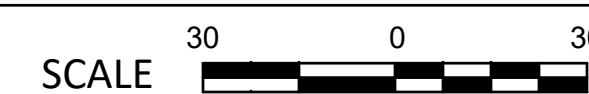

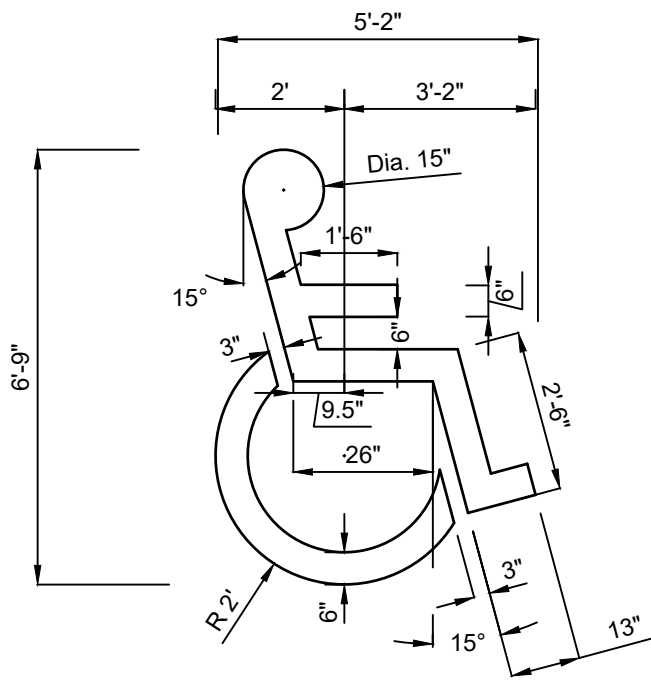

A1 HANDICAP PAV. MARKING DETAIL
NOT TO SCALE

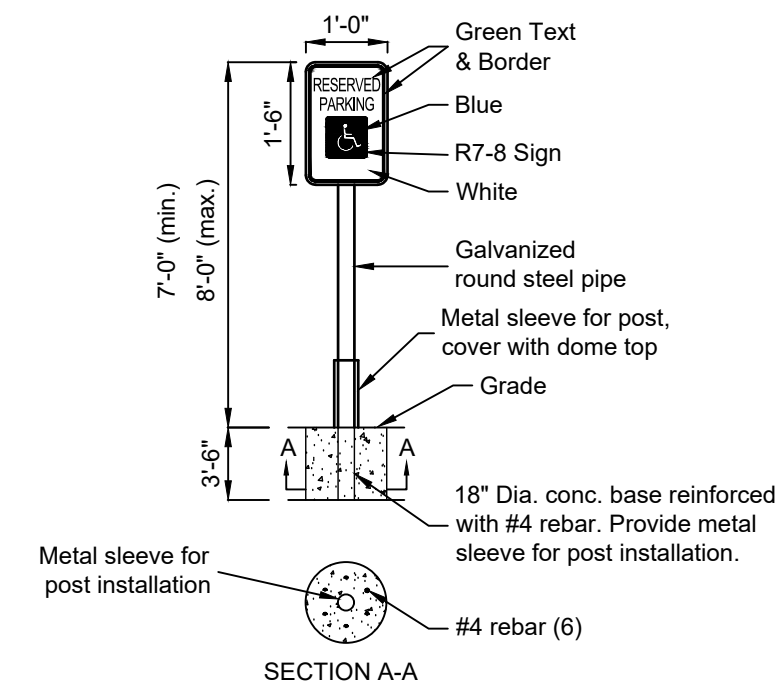

A2 HANDICAP PARKING SIGN DETAIL
NOT TO SCALE

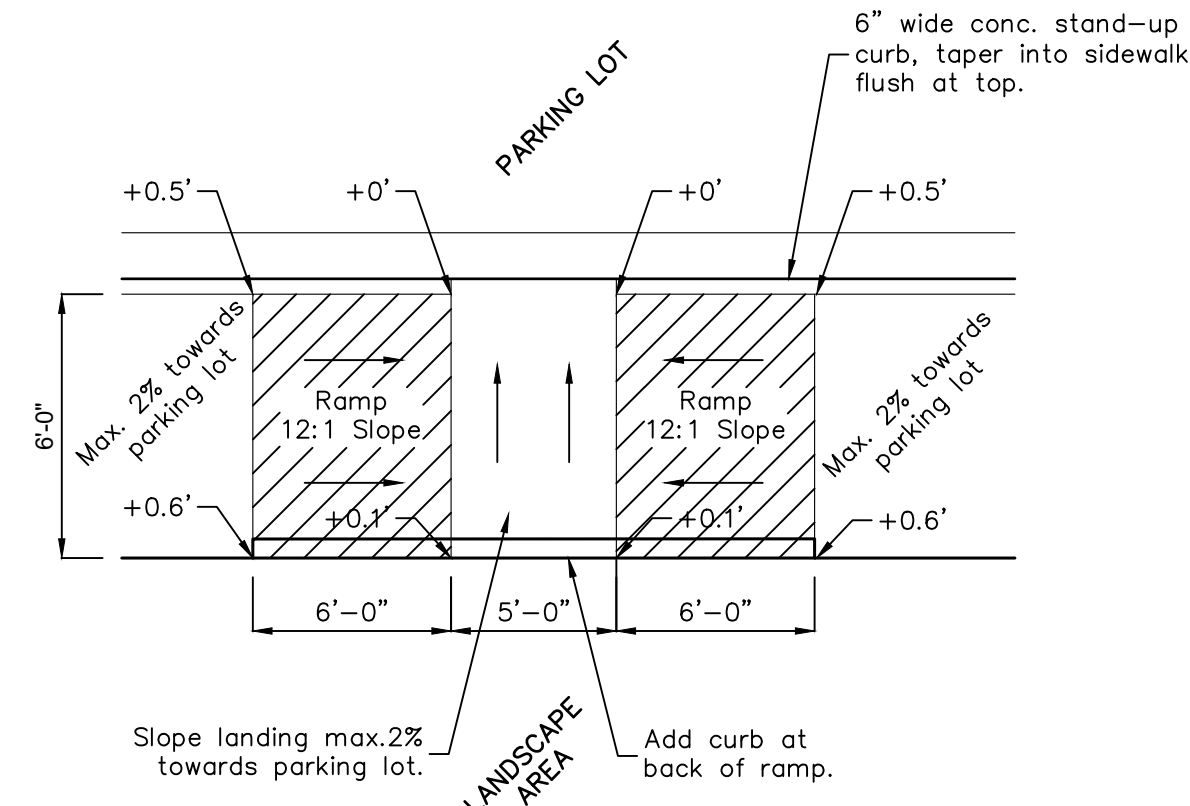

A3 TWO WAY WHEELCHAIR RAMP
NOT TO SCALE

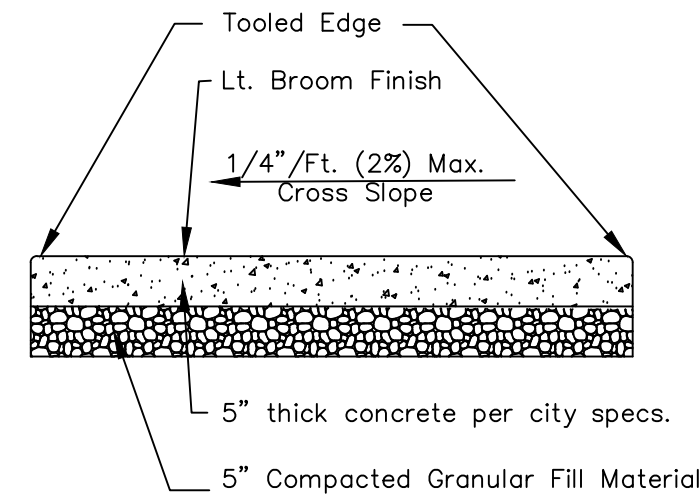

B2 5" CONCRETE SIDEWALK
NOT TO SCALE

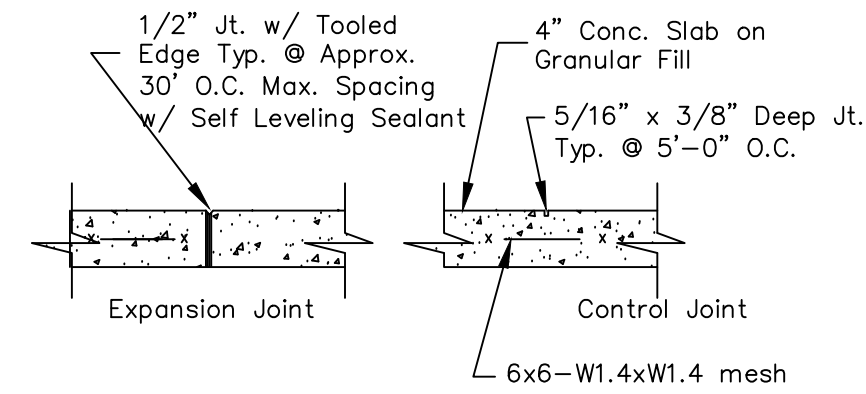

B3 SIDEWALK JOINTS
NOT TO SCALE

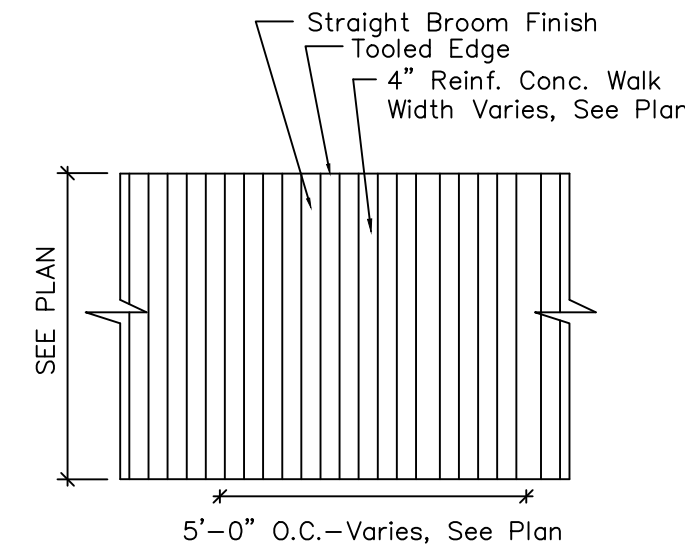

B4 TYP. PATTERN IN WALK
NOT TO SCALE

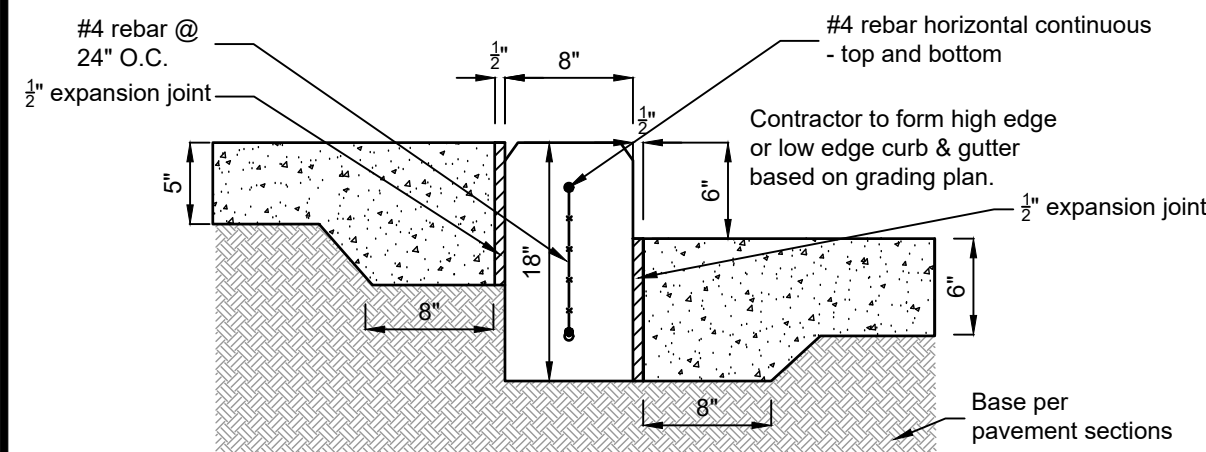

C1 STAND-UP CURB
NOT TO SCALE

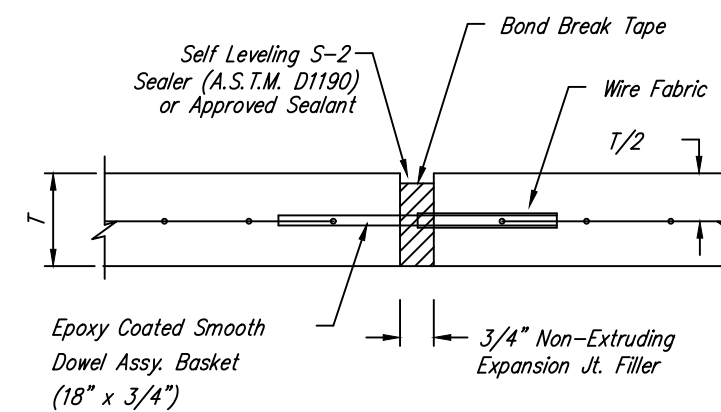

C2 EXPANSION JOINT (E.J.)
NOT TO SCALE

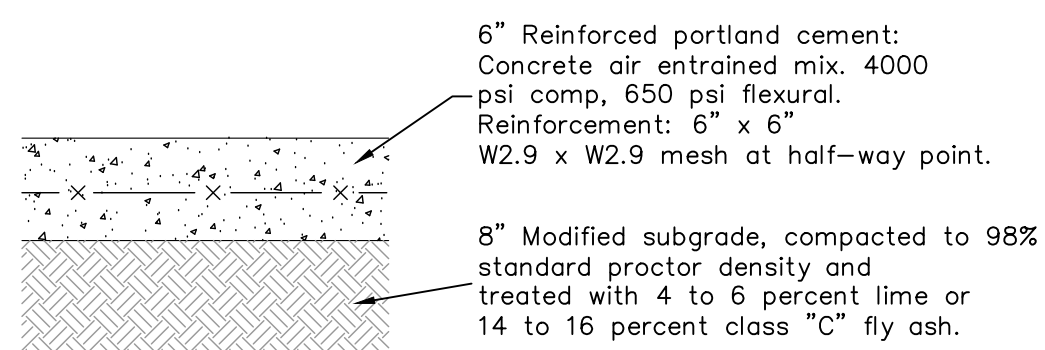

D1 6" CONCRETE PAVEMENT
NOT TO SCALE

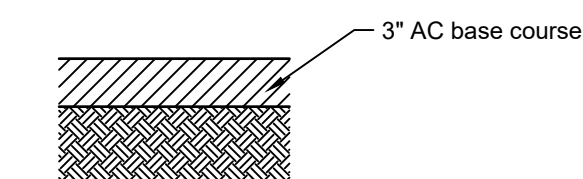

D2 3" TEMPORARY ASPHALT SIDEWALK
NOT TO SCALE

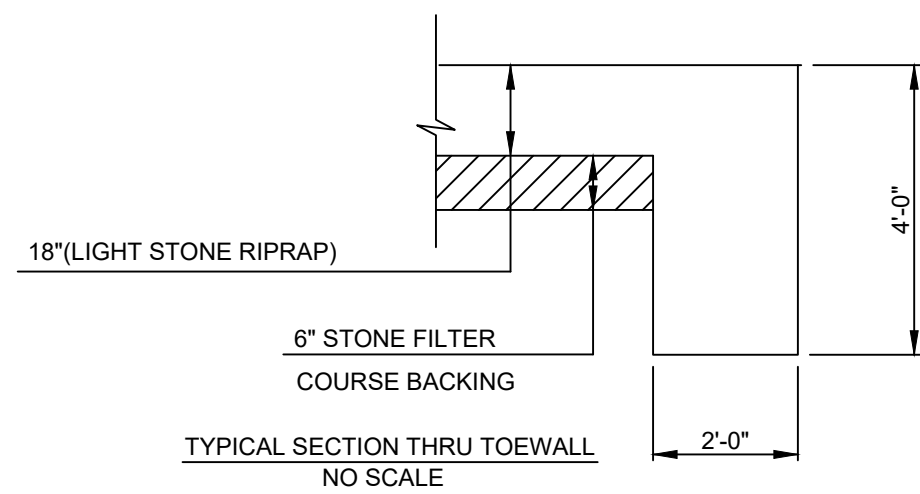

NOTES

- All riprap for this project shall be natural stone, or broken concrete with fabric envelope.
- Toewalls shall be installed along all unprotected edges of stone riprap.
- Grouting of the surface of the riprap shall not be performed, unless indicated otherwise. Grouting of the toewall shall be performed with slurry concrete mix.

E1 LIGHT STONE RIPRAP
NOT TO SCALE

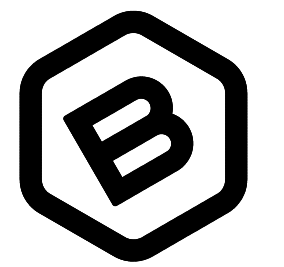

BAUGHMAN COMPANY

315 Ellis St.
Wichita, KS 67211
316-262-7271
BaughmanCo.com

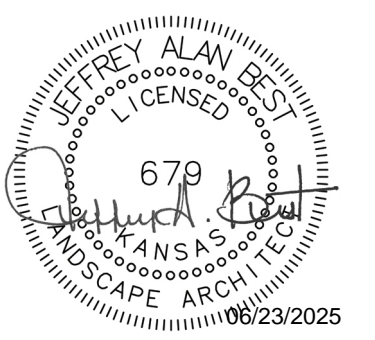

CITY OF WICHITA
ARKANSAS RIVER EAST BANK RESTORATION PROJECT
Wichita, KS 67202
PROJ. NO: 472-2024-482-11090

REVISION: DATE:

PROJECT NUMBER:
24-10-E916

DESIGN: JAB DRAWN: JSG

DATE: 06/23/2025

SITE DETAILS

SHEET **10** OF **13**

Stone:
Cottonwood limestone ledge
surface tolerance: 1" variation
face tolerance: 2" variation

Length: Depth:
Min: 36" Min: 24"
Max: 72" Max: 26"

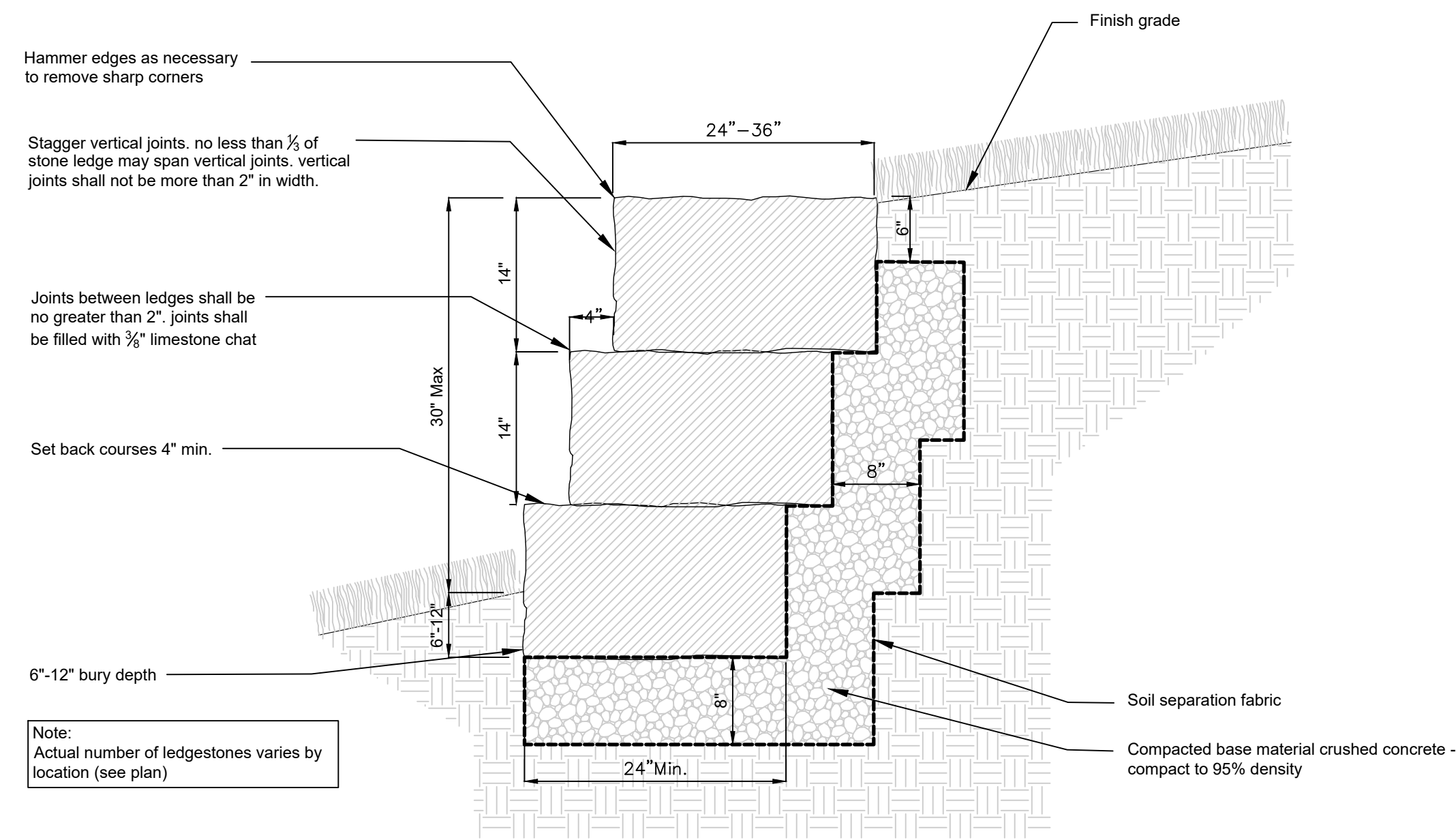

F1 LEDGESTONE DETAIL - BASE BID
NOT TO SCALE

Stone:
Cottonwood limestone ledge
surface tolerance: 1" variation
face tolerance: 2" variation

Length: Depth:
Min: 36" Min: 24"
Max: 72" Max: 26"

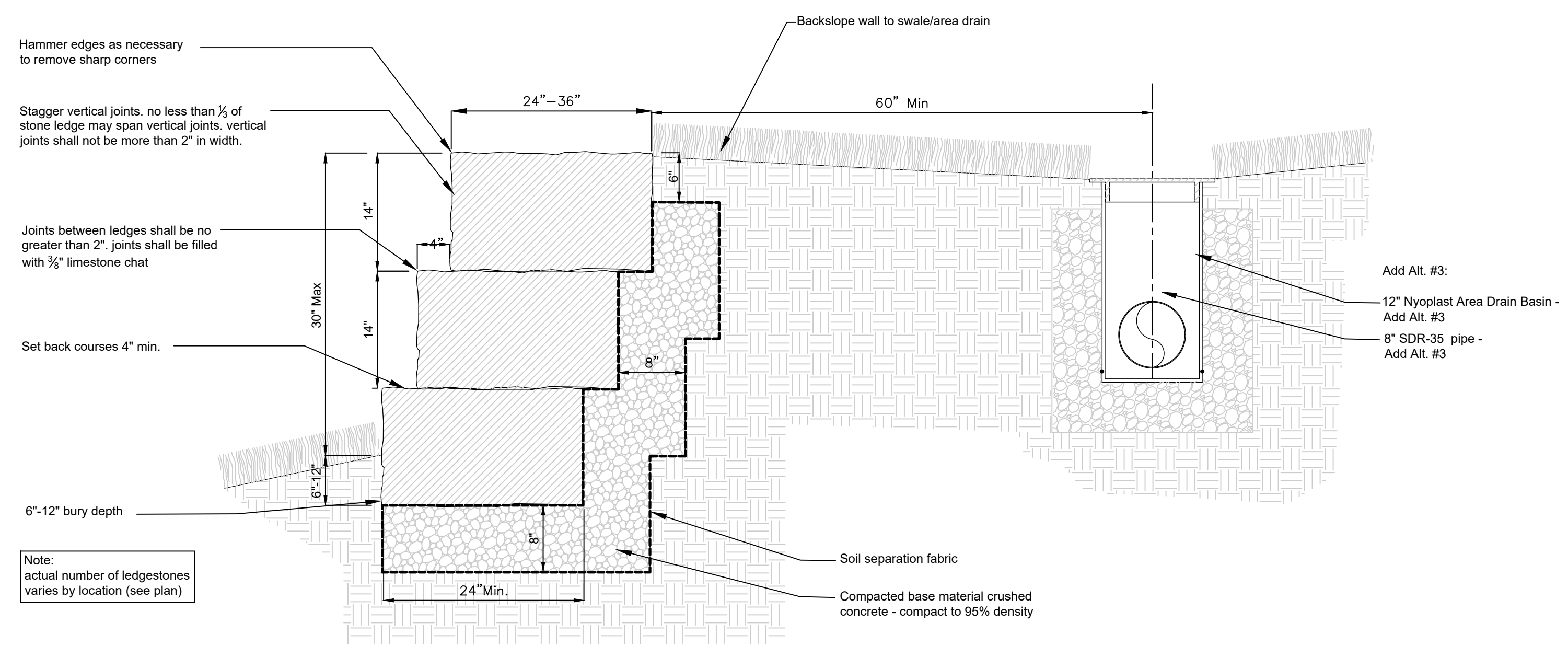

F1 LEDGESTONE DETAIL - ADD ALT. #3
NOT TO SCALE

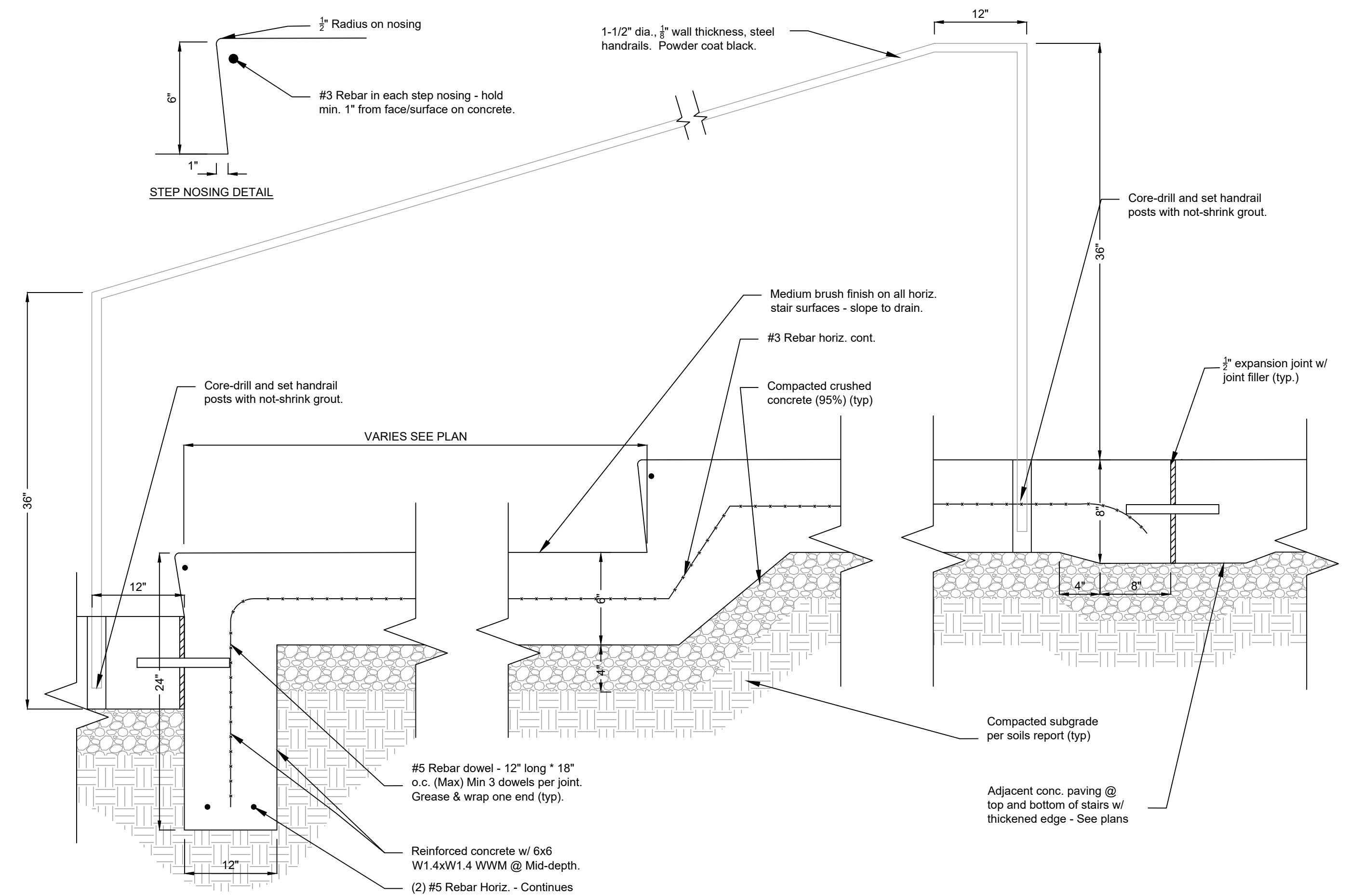
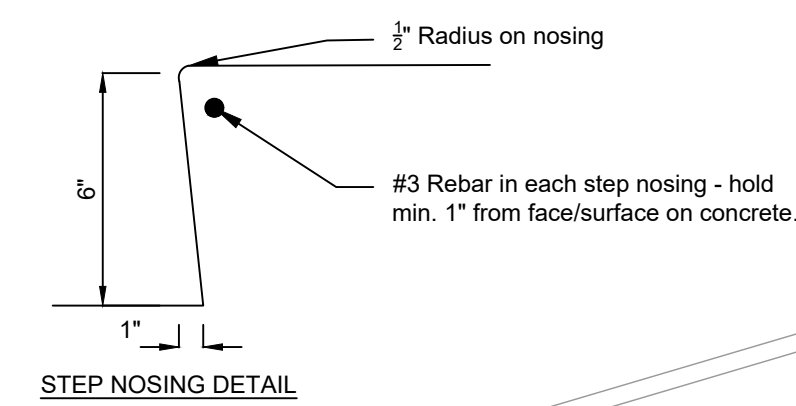

F3 PERRON STEPS - ADD ALT. #4
NOT TO SCALE

Submit handrail shop drawings for review.

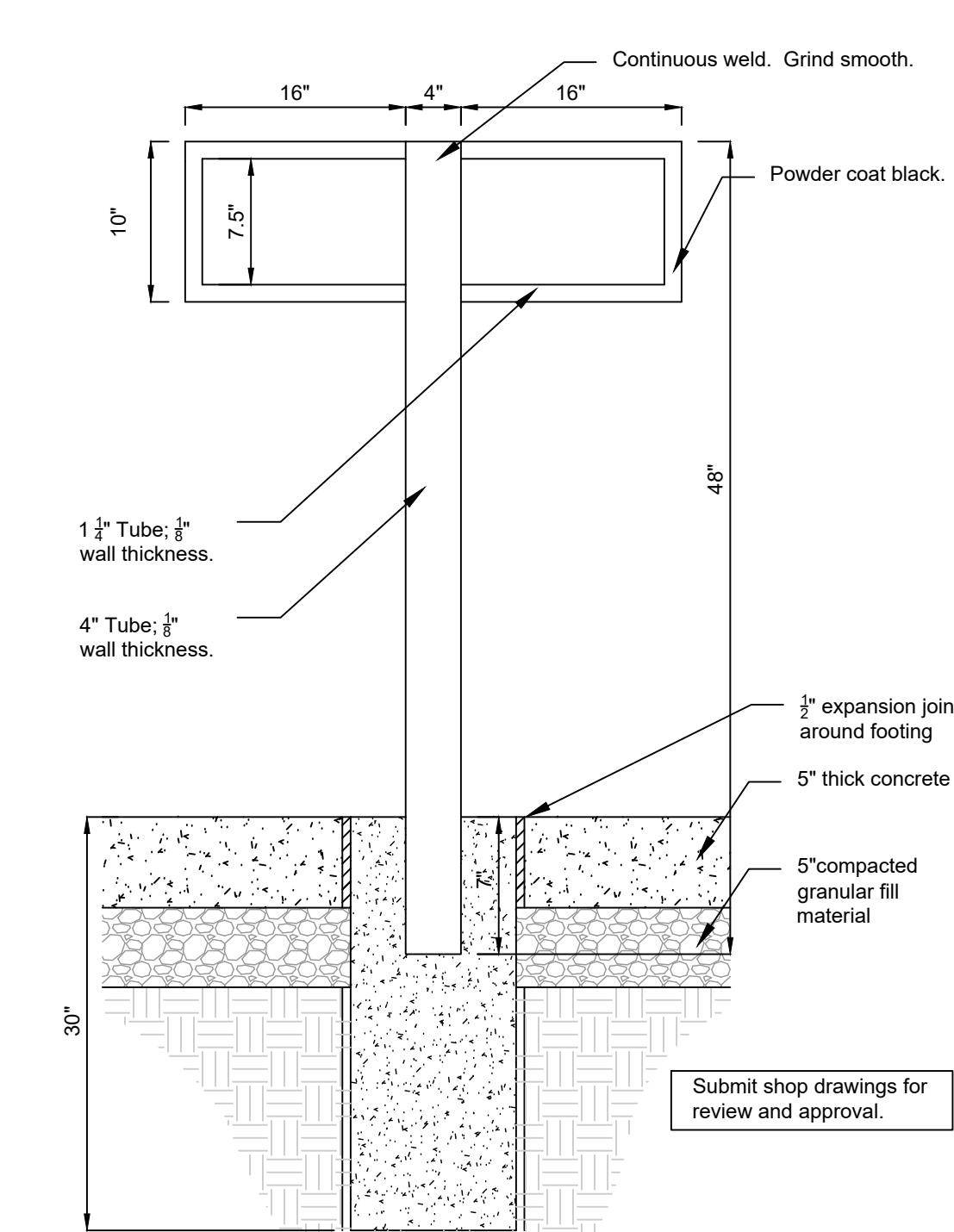
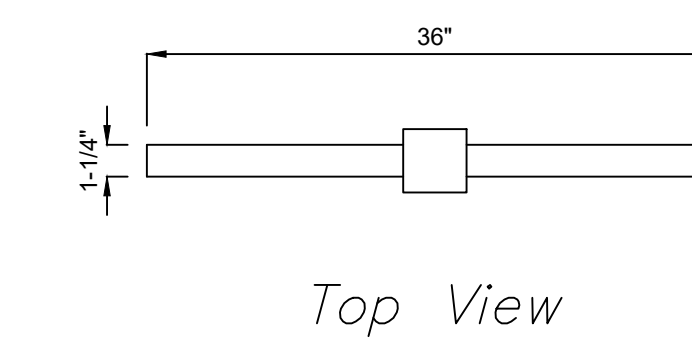

F2 TRASH RECEPTACLE STAND
NOT TO SCALE

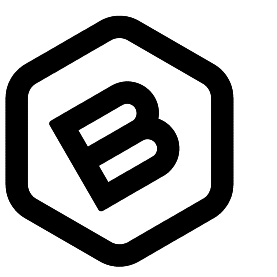

BAUGHMAN COMPANY

315 Ellis St.
Wichita, KS 67211
316-262-7271
BaughmanCo.com

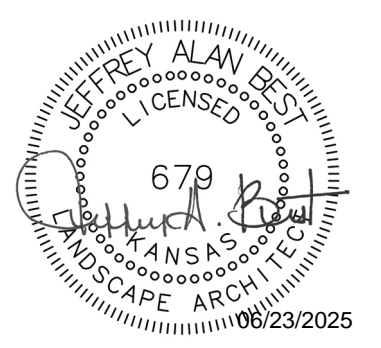

CITY OF WICHITA
ARKANSAS RIVER EAST BANK RESTORATION PROJECT
Wichita, KS 67202
PROJ. NO. 472-2024-482-11090

REVISION: DATE:

PROJECT NUMBER:
24-10-E916

DESIGN: JAB DRAWN: JSG
DATE: 06/23/2025

SITE DETAILS

SHEET **11** OF **13**

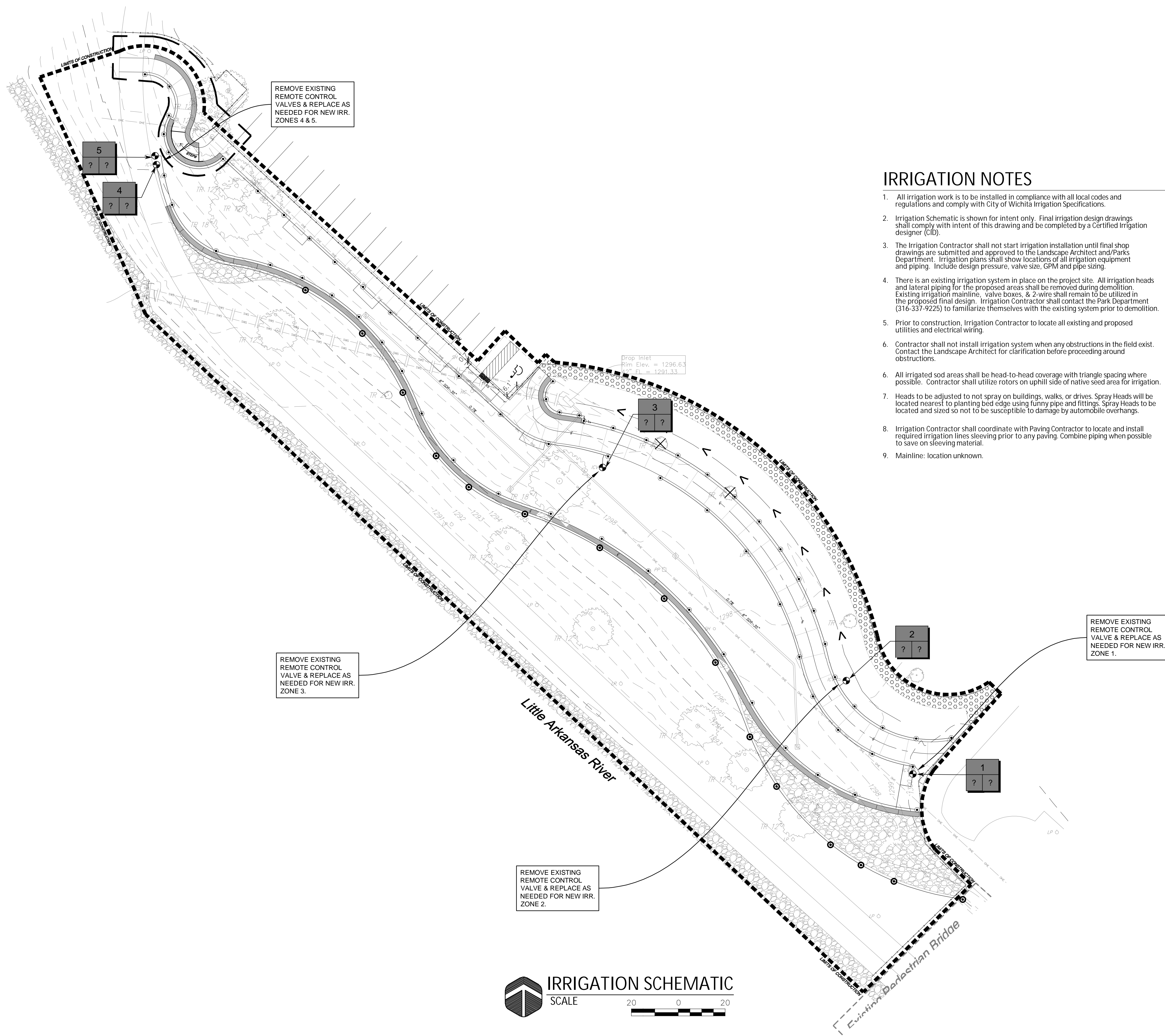

IRRIGATION NOTES

- All irrigation work is to be installed in compliance with all local codes and regulations and comply with City of Wichita Irrigation Specifications.
- Irrigation Schematic is shown for intent only. Final irrigation design drawings shall comply with intent of this drawing and be completed by a Certified Irrigation Designer (CID).
- The Irrigation Contractor shall not start irrigation installation until final shop drawings are submitted and approved to the Landscape Architect and Parks Department. Irrigation plans shall show locations of all irrigation equipment and piping. Include design pressure, valve size, GPM and pipe sizing.
- There is an existing irrigation system in place on the project site. All irrigation heads and lateral piping for the proposed areas shall be removed during demolition. Existing irrigation mainline, valve boxes, & 2-wire shall remain to be utilized in the proposed final design. Irrigation Contractor shall contact the Park Department (316-337-9225) to familiarize themselves with the existing system prior to demolition.
- Prior to construction, Irrigation Contractor to locate all existing and proposed utilities and electrical wiring.
- Contractor shall not install irrigation system when any obstructions in the field exist. Contact the Landscape Architect for clarification before proceeding around obstructions.
- All irrigated sod areas shall be head-to-head coverage with triangle spacing where possible. Contractor shall utilize rotors on uphill side of native seed area for irrigation.
- Heads to be adjusted to not spray on buildings, walks, or drives. Spray Heads will be located nearest to planting bed edge using funny pipe and fittings. Spray Heads to be located and sized so not to be susceptible to damage by automobile overhangs.
- Irrigation Contractor shall coordinate with Paving Contractor to locate and install required irrigation lines sleeving prior to any paving. Combine piping when possible to save on sleeving material.
- Mainline: location unknown.

LEGAL DESCRIPTION

A portion of Lot 1, Block 3, PARK PLAZA FIRST ADDITION, Wichita, Sedgwick County, Kansas.

SITE INFORMATION

Total Area:	±50,740.37 sq. ft. (1.16 acres)
Disturbed Area:	±43,560.00 sq. ft. (1.00 acres)
Impervious Area, pre-const:	± 6,833.52 sq. ft. (0.16 acres)
Impervious Area, post-const:	±10,078.21 sq. ft. (0.23 acres)

BENCHMARKS

Site Benchmark - 1
 "□" chiseled on top of NW edge of Power Pole Base
 Elevation = 1299.46 (NAVD 88)

KANSAS ONE CALL

Contractor shall be required to provide notice to Kansas One Call at 287-2470 a minimum of three (3) working days prior to any excavation or work adjacent to utilities.
 Kansas One Call 1-800-DIG-SAFE

UTILITY CONTACTS

The Contractor must notify the following in case of an emergency:

Kansas Gas Service (Gas)	1-888-482-4950
Black Hills Energy (Gas)	1-800-303-0357
Evergy (Electric)	383-8650
Cox Communications (Telecommunication)	262-4270
AT&T (Telecommunication)	268-2759
City of Wichita Water Dept. (Water)	268-4563 or 268-4908
City of Wichita Sewer Maint. (San. Sewer)	268-4024 or 262-6000
City of Wichita Storm Sewer Maint. (Storm Sewer)	268-4090
City of Wichita Traffic Maint. (Traf. Control)	268-4034 or 268-4203
Conoco Pipeline Co. (Petroleum)	1-800-231-2551
Williams Pipeline Co. (Petroleum)	529-6600 or 1-800-324-9696
Phillips Pipeline Co. (Petroleum)	1-800-766-8230

IRRIGATION SCHEMATIC
 SCALE 20 0 20

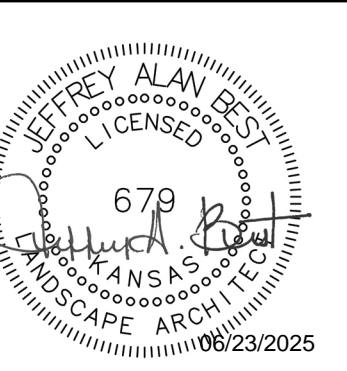

REVISION: DATE:

PROJECT NUMBER:
24-10-E916

DESIGN: JAB DRAWN: JSG
 DATE: 06/23/2025

IRRIGATION PLAN

SHEET 12 OF 13

File: E:\Projects\Country Acres 2nd Lot 4\Bk. 5_23-06-EZ\Engineering

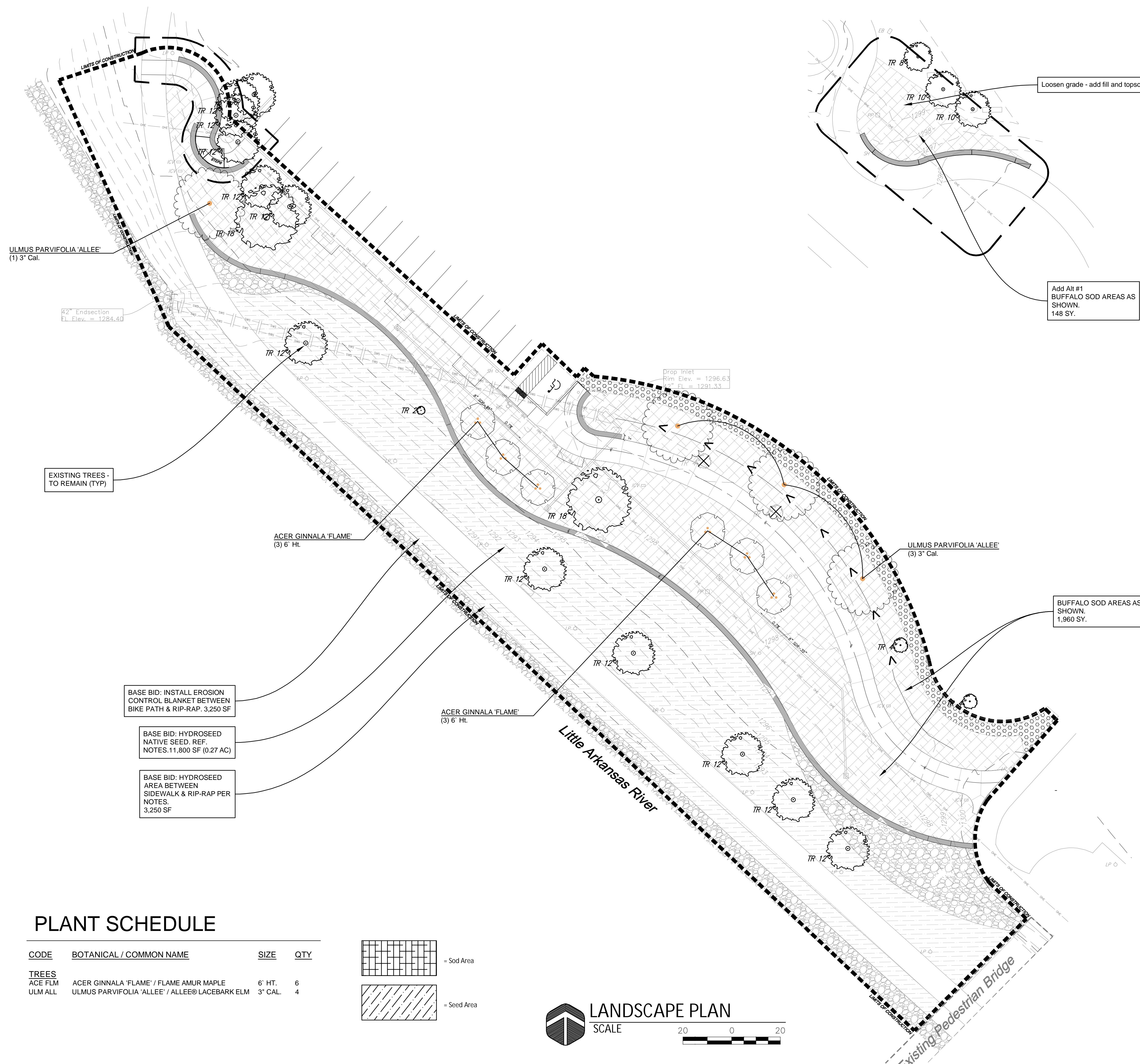

LANDSCAPE NOTES

- All landscape work shall be done in accordance with industry standards and City of Wichita Specification.
- General Contractor to supply and place at a depth of 4", all topsoil on site within the Limits of Construction unless otherwise noted.
- Trees with broken leaders or no central leader will not be accepted.
- Topsoil hauled onto site shall be fertile, friable, natural loam topsoil, of uniform quality characteristic of representative local soils which produce heavy growth of crops, grass, or other vegetation. It shall be free of trash, or other matter toxic to plant growth.
- Topsoil shall be delivered in an unfrozen and non-muddy condition and shall be subject to approval by the Landscape Architect.
- Prior to any excavation for landscaping purposes the location of underground utilities shall be determined by calling Kansas One Call at 687-2470/1-800-344-7233. Contractor shall be responsible for any damage done to existing utilities.
- Report any discrepancies in the planting plan to the Landscape Architect, prior to starting construction.
- The Landscape Contractor shall coordinate with the G.C. to gain site access to install the plants and maintain grounds, until final acceptance from owner. Upon final acceptance, the one (1) year guarantee period will begin.
- The Landscape Contractor shall coordinate with the G.C. to install the plants and maintain grounds, including mowing grass within the construction limits. Grass shall not be taller than 12" at any point. Maintenance shall continue until final acceptance from owner.
- The Landscape Contractor shall submit bid with unit prices for all plants, including mulch, installation, 1 year guarantee, bed preparation, fertilizer, etc.
- The Landscape Contractor is responsible for any damage done to the exterior of the building or any part of the parking lot when installing or maintaining the plantings before final acceptance.
- Fall planting season shall be September 1 thru October 31. Spring planting season shall be April 1 thru June 30. For grass seeding and hydroseeding, fall season shall be September 1 thru mid October. Spring season for seeding shall be from March 15 thru mid May. Sod planting season shall be May 15 thru Sept 15.
- Buffalo Sod: Submit selected species for review and approval by Parks Department at 316-268-4361.
- Native Seed: Kansas PF/QF CRP Mix #2 15 species mix achieves, 23.54 seeds per square foot and mix ratio is 75% grass to 25% forbs. Includes (#s/ac): Bluestem, Big (Kaw) (0.9), Sideoats grama (El Reno) (0.6), Switchgrass (Blackwell) (0.75), Bluestem, Little (VNS) (0.8), Indiangrass (local or vns) (0.9), Partridge Pea (0.15), Prairie Clover, White (0.09), Prairie Clover Purple, (0.09), Illinois Bundletflower (Prairie Mmossa) (0.25), Coreopsis, Lanceleaf (sand) (0.1), Plains (0.01), Indian blanket (0.15), Sunflower, Maximilian (0.18), Coneflower, Grayheaded (Yellow) (0.07), Susan, Black-eyed (0.01).
- Hydroseed/Hydromulch: All native seed areas shall be seeded with hydroseed/hydromulch. Contractor shall submit proposed hydromulch specification for review and approval. Specification shall include mulch type, application rate, and tackifier/stabilizer. Do not apply hydroseed to area until the seedbed has been fully prepared and reviewed by the Parks Department.
- Temporary Seed: If areas cannot be sodded or seeded due to seasonal planting limitations, all disturbed areas shall be temporarily seeded with Annual Ryegrass at 4lbs./1000 SF.

LEGAL DESCRIPTION

A portion of Lot 1, Block 3, PARK PLAZA FIRST ADDITION, Wichita, Sedgwick County, Kansas.

SITE INFORMATION

Total Area:	±50,740.37 sq. ft. (1.16 acres)
Disturbed Area:	±43,560.00 sq. ft. (1.00 acres)
Impervious Area, pre-const:	± 6,833.52 sq. ft. (0.16 acres)
Impervious Area, post-const:	±10,078.21 sq. ft. (0.23 acres)

BENCHMARKS

Site Benchmark - 1
 "□" chiseled on top of NW edge of Power Pole Base
 Elevation = 1299.46 (NAVD 88)

KANSAS ONE CALL

Contractor shall be required to provide notice to Kansas One Call at 287-2470 a minimum of three (3) working days prior to any excavation or work adjacent to utilities.
 Kansas One Call 1-800-DIG-SAFE

UTILITY CONTACTS

The Contractor must notify the following in case of an emergency:

Kansas Gas Service (Gas)	1-888-482-4950
Black Hills Energy (Gas)	1-800-303-0357
Energy (Electric)	383-8650
Cox Communications (Telecommunication)	262-4270
AT&T (Telecommunication)	268-2759
City of Wichita Water Dept. (Water)	268-4563 or 268-4908
City of Wichita Sewer Maint. (San. Sewer)	268-4024 or 262-6000
City of Wichita Storm Sewer Maint. (Storm Sewer)	268-4090
City of Wichita Traffic Maint. (Traf. Control)	268-4034 or 268-4203
Conoco Pipeline Co. (Petroleum)	1-800-231-2551
Williams Pipeline Co. (Petroleum)	529-6600 or 1-800-324-9696
Phillips Pipeline Co. (Petroleum)	1-800-766-8230

PLANT SCHEDULE

CODE	BOTANICAL / COMMON NAME	SIZE	QTY
TREES			
ACE FLM	ACER GINNALA 'FLAME' / FLAME AMUR MAPLE	6' HT.	6
ULM ALL	ULMUS PARVIFOLIA 'ALLEE' / ALLEE® LACEBARK ELM	3' CAL.	4

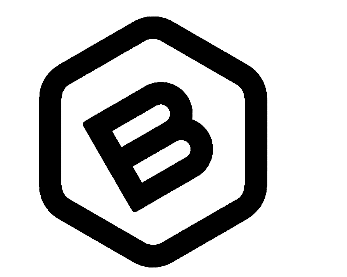
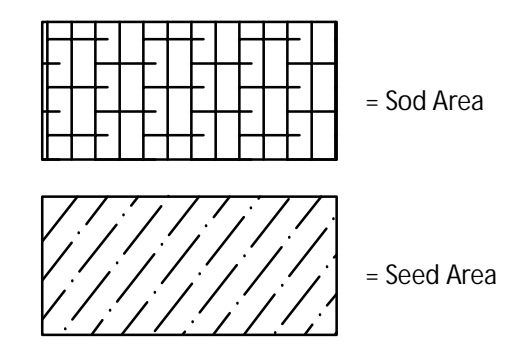

BAUGHMAN COMPANY

315 Ellis St.
 Wichita, KS 67211
 316-262-7271
 BaughmanCo.com

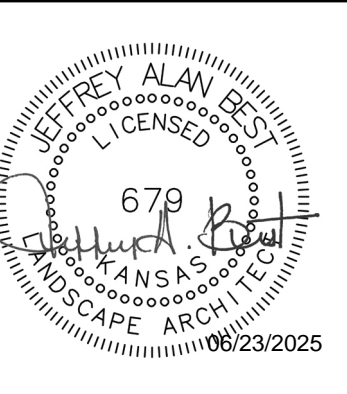

CITY OF WICHITA
 ARKANSAS RIVER EAST BANK RESTORATION PROJECT
 WICHITA, KS 67202
 PROJ. NO: 472-2024-482-11090

REVISION: DATE:

PROJECT NUMBER:
 24-10-E916

DESIGN: JAB DRAWN: JSG
 DATE: 06/23/2025

LANDSCAPE PLAN

SHEET 13 OF 13

File: E:\Projects\Country Acres 2nd Lot 4-Bk 5-23-08-EZ7\Engineering