

Curve #3  
Curve Data Based on Centerline  
Rad. = 141.74' Delta = 43°00'00" Tangent = 58.71'  
Arc = 111.32' L.C. = 108.48' Def. Ft. = 12.12720 Min.

Station	Arc	FACE CHORD LENGTHS		Defl.	T. Defl.
		8 Lt.	8 Rt.		
12+16.11	—	—	—	0'00"00"	0'00"00"
12+25.00	8.89'	7.26'	10.52'	1'47"48"	1'47"48"
12+50.00	25.00'	20.39'	29.55'	5'03"11"	6'50"59"
12+75.00	25.00'	20.39'	29.55'	5'03"11"	11'54"10"
13+00.00	25.00'	20.39'	29.55'	5'03"11"	16'57"21"
13+27.43	27.43'	22.36'	32.41'	5'32"39"	22'30"00"

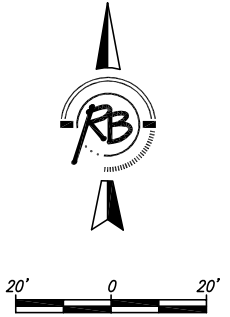

**Legacy 3rd Addition  
44th Street South  
WICHITA, KANSAS**

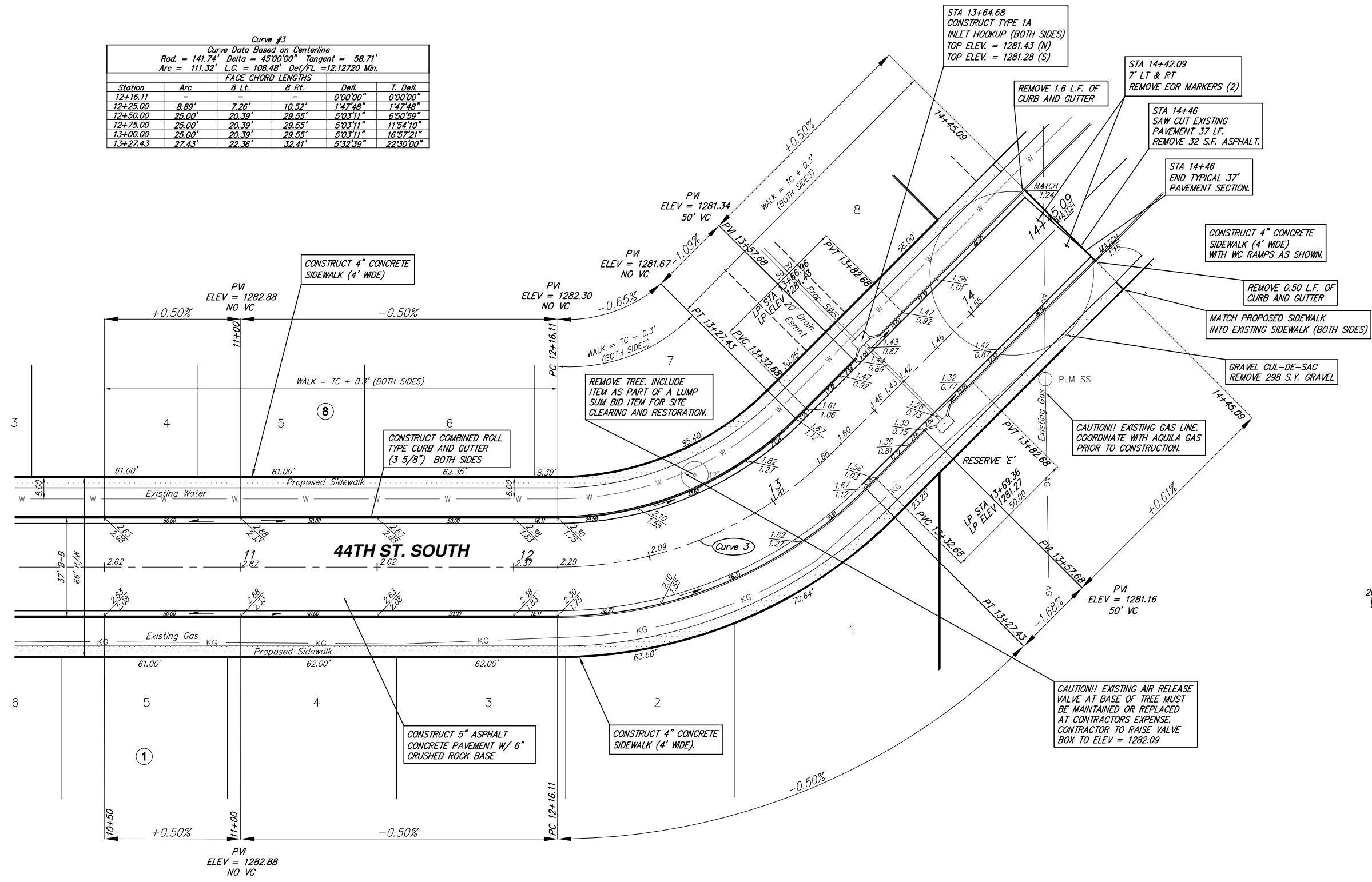

**Ruggles & Bohm, P.A.**  
Engineering, Surveying, Land Planning

924 North Main  
Wichita, Kansas 67203  
www.rbkansas.com

(316) 264-8008  
(316) 264-4621 fax  
E-mail: info@rbkansas.com

DESIGN: KWL  
DRAWN: RLS  
REVIEW: [Blank]  
UTILITY: [Blank]  
DATE: Feb. 9, 2007

PROJECT NUMBER: 472-84525

SHEET: 9 OF 43