

# FAIRVIEW AVE.

S. L. 34TH ST. TO S. L. 35TH ST.

B.M. 131.96 - "□" CUT N.E. COR. BRIDGE 55TH ST. W. OF FAIRVIEW.  
B.M. 128.31 - "□" CUT N.E. COR. INTER. W. SIDE FAIRVIEW @ 34TH ST.  
B.M. 131.14 - 60' STEP IN S.S. H.P. N.E. COR. FAIRVIEW @ 35TH ST.

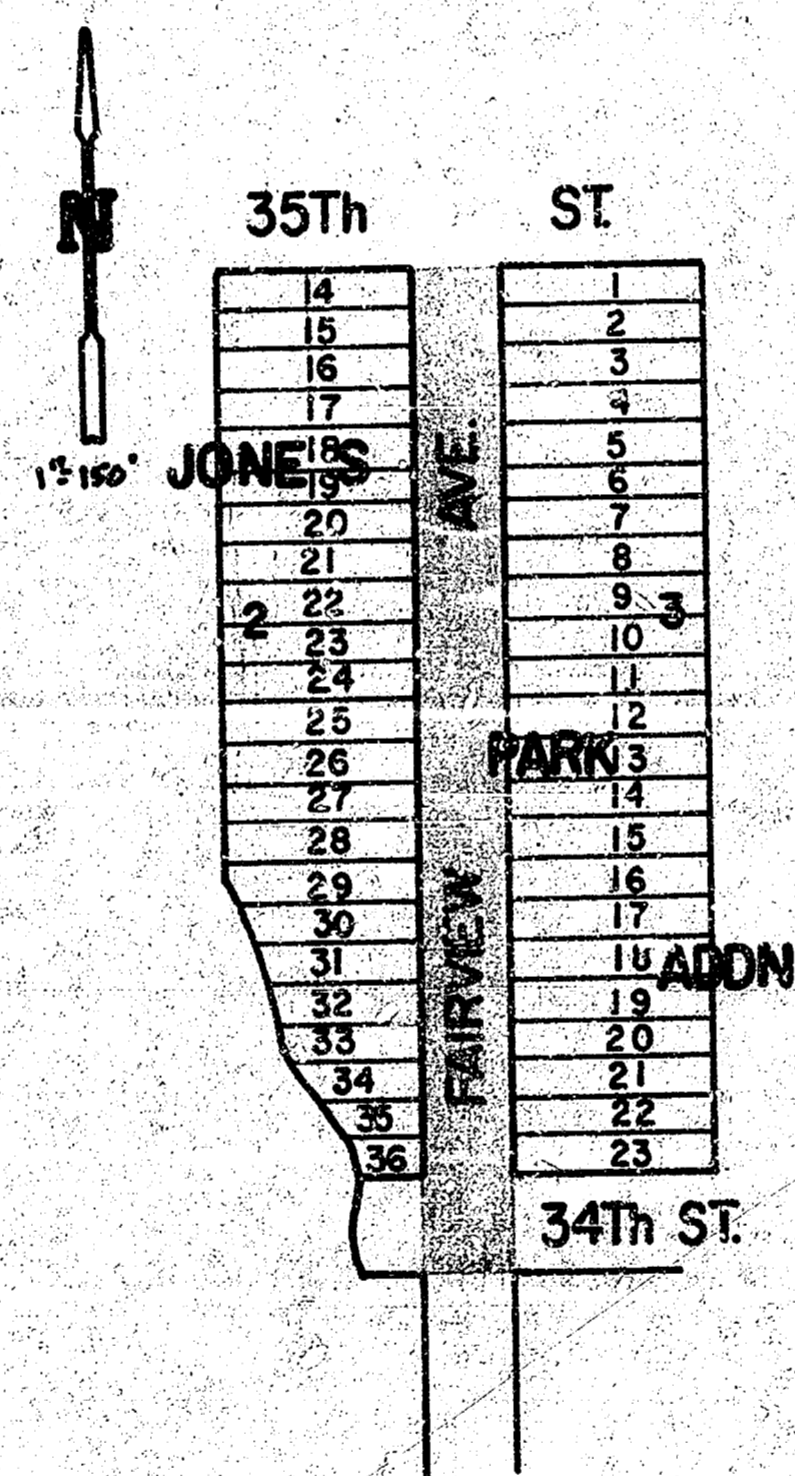

PROJECT DESCRIPTION		
PROJECT NUMBER 472 76 245 81253 000 000001		
BOOK NO. DWG 6	APPROVED BY	DATE
DRAWN BY KER		REVISED 1/5
CITY OF WICHITA DEPARTMENT OF ENGINEERING		
M. E. LINDEBAK CITY ENGINEER		SCALE 1" = 20'

FILMED FROM THE BEST AVAILABLE COPY

# TYPICAL 3' PAVEMENT DETAILS

## FAIRVIEW AVE.

### TRANSVERSE SECTION

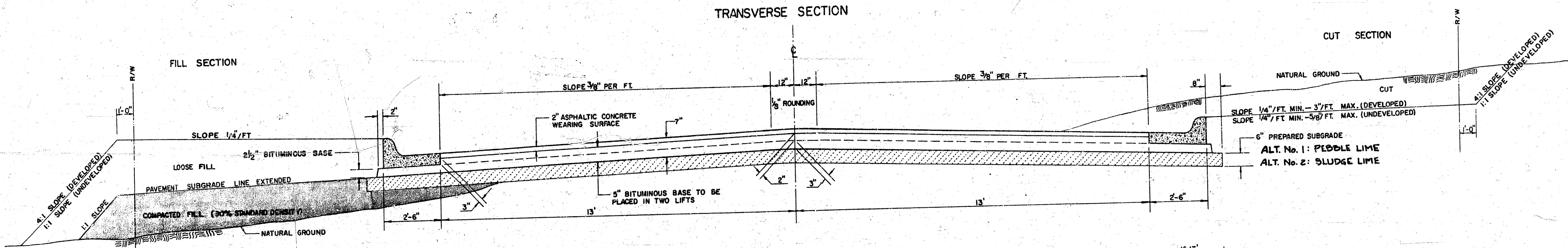

### ELEVATION OFFSETS

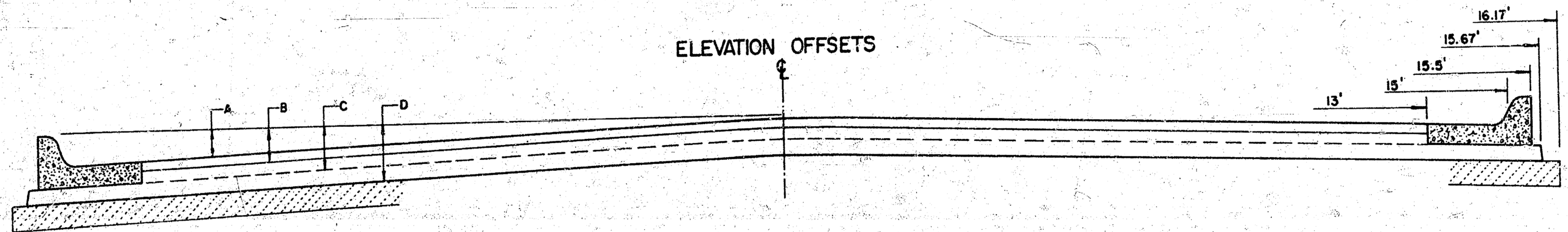

	DISTANCE FROM CENTERLINE (LT. & RT.)												
	0'	2'	4'	6'	7.5'	10'	12'	13'	15'	15.5'	15.67'	16.17'	
A: TOP OF CURBS TO TOP OF SURFACE LIFT	0.10	0.14	0.21	0.27	0.32	0.39	0.46	0.49	—	—	—	—	
B: TOP OF CURBS TO TOP OF UPPER BASE LIFT	0.27	0.31	0.38	0.44	0.49	0.56	0.63	0.66	—	—	—	—	
C: TOP OF CURBS TO TOP OF LOWER BASE LIFT	0.44	0.49	0.57	0.64	0.70	0.79	0.87	0.90	0.98	1.00	1.00	—	
D: TOP OF CURBS TO TOP OF SUBGRADE	0.69	0.73	0.80	0.87	0.93	1.01	1.08	1.12	1.19	1.21	1.21	1.23	

### COMBINED CURB & GUTTER

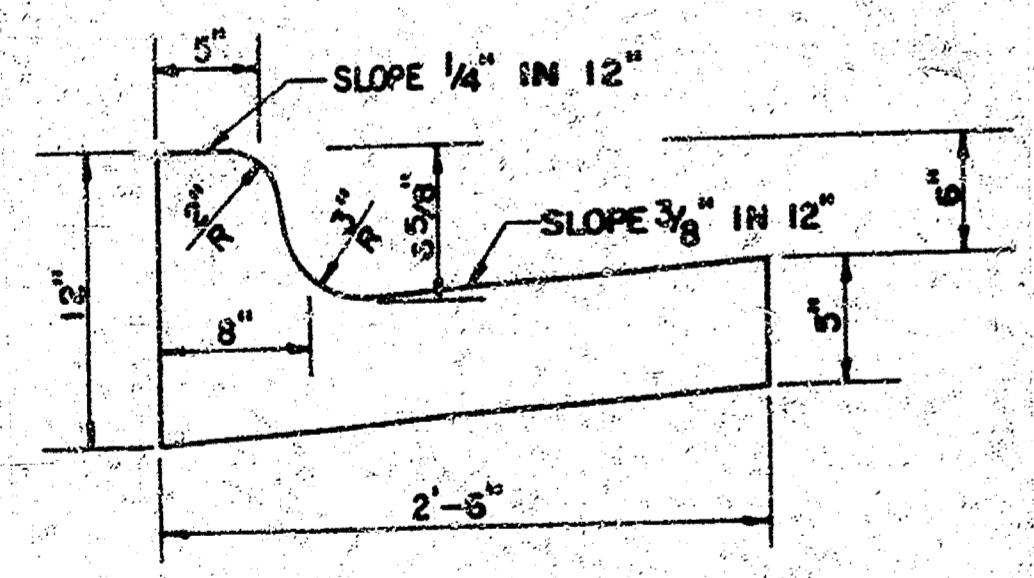

### ROLL TYPE COMBINED CURB & GUTTER

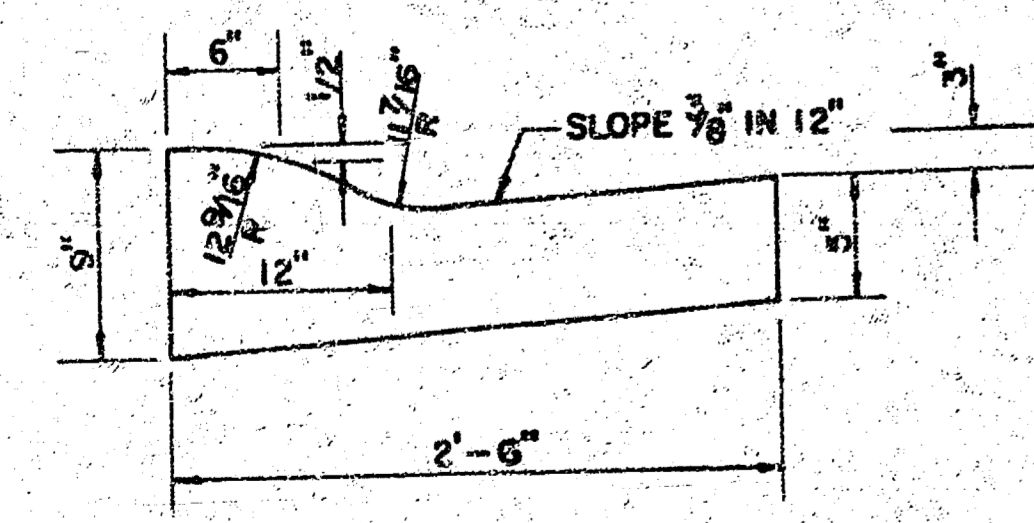

### TRANSVERSE CONSTRUCTION JOINTS

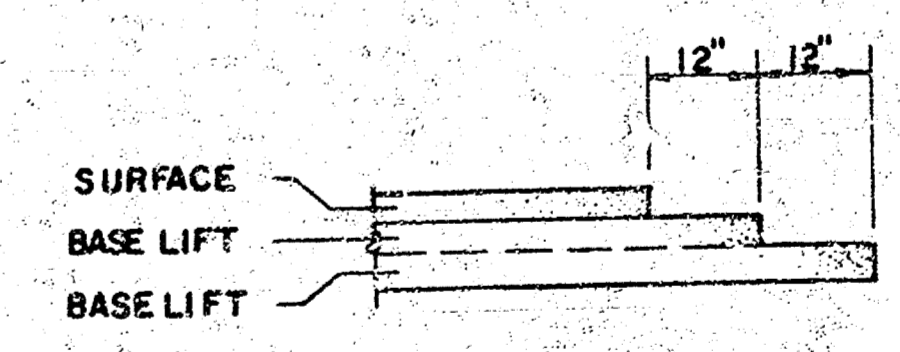

### GENERAL NOTES

- 1) THE ASPHALTIC CONCRETE PAVEMENT BETWEEN THE COMBINED CURB AND GUTTER SHALL BE PAID AS SQUARE YARDS OF 7" ASPHALTIC CONCRETE (5" BITUMINOUS BASE).
- 2) THE BITUMINOUS BASE UNDER AND BEHIND THE COMBINED CURB AND GUTTER SHALL BE PAID AS SQUARE YARDS OF 2 1/2" BITUMINOUS BASE.
- 3) A TACK COAT OF EMULSIFIED ASPHALT (SC-1H OR CSS-1H) SHALL BE APPLIED AT AN APPROXIMATE RATE OF 0.05 GALLONS PER SQUARE YARD BETWEEN EACH LIFT OF ASPHALTIC MATERIAL.
- 4) BITUMINOUS BASE AND ASPHALTIC CONCRETE WEARING SURFACE SHALL BE PLACED WITH A LAYDOWN MACHINE HAVING AUTOMATIC CONTROLS FOR LINE AND GRADE.
- 5) CONSTRUCTION JOINTS IN EACH LIFT SHALL BE STAGGERED A MINIMUM DISTANCE OF ONE (1) FOOT FROM JOINTS IN PRECEDING LIFTS AND PLACED SO THAT A JOINT WILL BE CONSTRUCTED ON THE CENTERLINE OF THE TOP LIFT.
- 6) CONTRACTOR TO BID ONLY ONE SUBGRADE TREATMENT ALTERNATE WHEN ALTERNATES ARE PROVIDED IN THE PROPOSAL AND CONTRACT. THE ALTERNATE CHOSEN BY THE SUCCESSFUL BIDDER SHALL BE USED IN CONSTRUCTING THIS PROJECT.

7 INCH RESIDENTIAL ASPHALTIC CONCRETE  
PAVEMENT WITH 5 INCH BITUMINOUS BASE  
CITY OF WICHITA, KANSAS  
PROJECT NUMBER  
472 76 245 81253 000 000 001

INTERSECTION QUANTITIES

—	S.Y.	—	"	Concrete Pavement
245.0	S.Y.	7	"	Asphaltic Conc. Pavement (5" Bituminous Base)
30.5	S.Y.	2 1/2	"	Bituminous Base
102.6	L.F.			Combined Curb & Gutter
—	L.F.			Integral Curb
—	S.F.	4"		Wheelchair Ramp
—	S.F.	4"		Walk
150.0	C.Y.			Excavation
—	C.Y.			Compacted Fill
—	Lbs.			Reinforcing Steel
281.2	S.Y.			Manipulation
—	Tons			Lime or Cement
—	S.Y.	V.G.	"	Concrete & Asphaltic Concrete Base

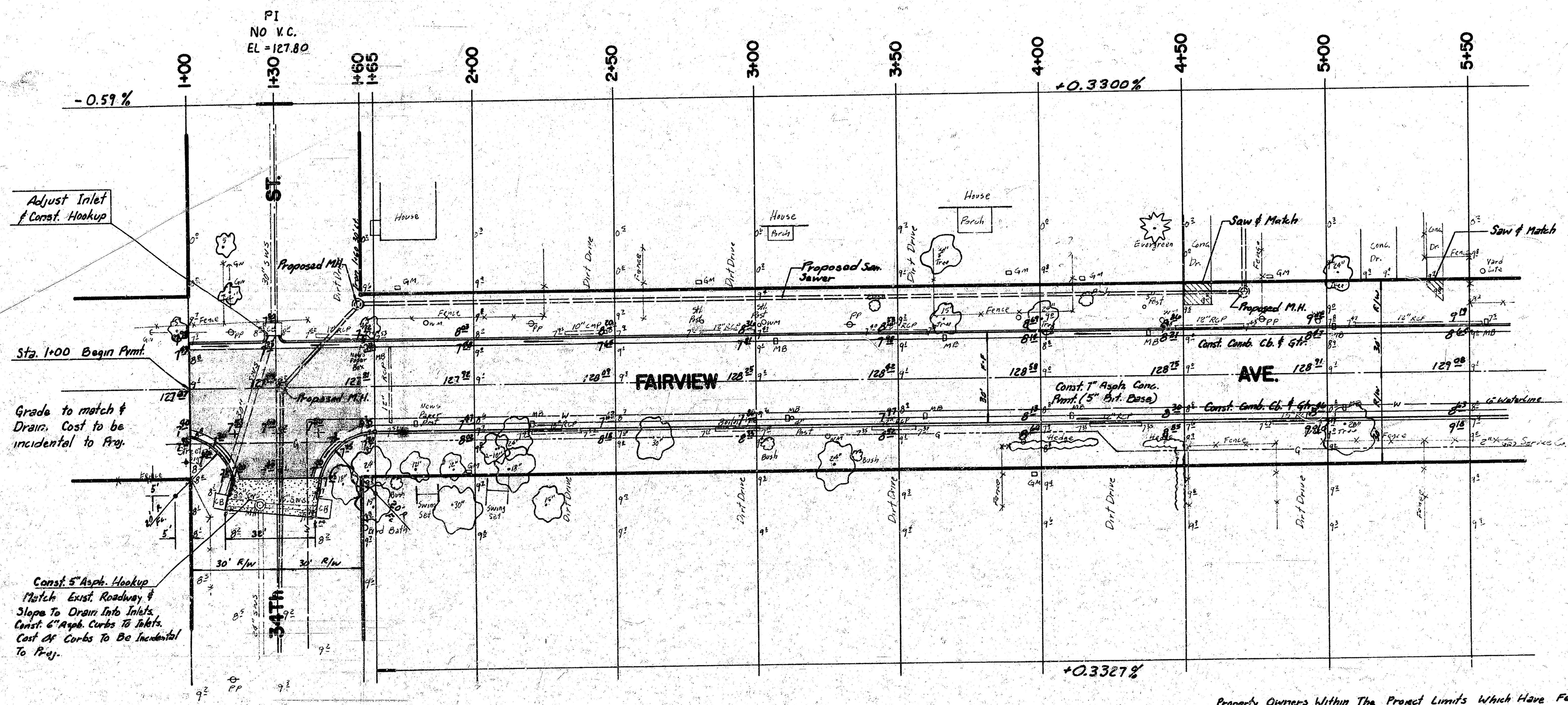
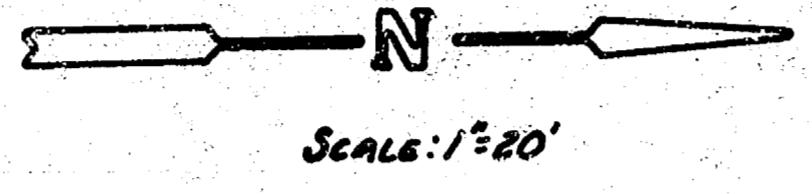

THE CONTRACTOR SHALL BE RESPONSIBLE FOR PRESERVING PROPERTY IRONS. THE CONTRACTOR SHALL BE REQUIRED TO RE-ESTABLISH ANY PROPERTY IRONS WHICH ARE DAMAGED OR DESTROYED BY HIS CONSTRUCTION OPERATIONS. SUCH IRONS SHALL BE RE-ESTABLISHED BY A LICENSED LAND SURVEYOR OR A LICENSED PROFESSIONAL ENGINEER IN ACCORDANCE WITH STATE LAWS.

Grade to match & Drain. Cost to be incidental to Proj.

Const. 5" Asphalt Hookup Match Exist Roadway & Slope To Drain Into Inlets. Const. 6" Asphalt Curbs to Inlets. Cost of Curbs to be incidental to Proj.

Note: Mailboxes Within The Project Limits Shall Be Removed And Replaced By The Contractor As Approved By The Engineer. Contractor Will Be Required To Make Satisfactory Provisions For Mail Delivery To Properties Affected By This Project During Construction.

Note: Paving Contractor To Coordinate Construction With Sanitary Sewer Contractor.

EARTHWORK  
EXCAVATION  
"X" SECTION : 1,178.0 C.Y.  
10% : 117.8 C.Y.  
TOTAL : 1,295.8 C.Y.

Manipulation = 2,370 S.Y.

Property Owners Within The Project Limits Which Have Fence In Public Right-Of-Way Have Been Notified To Remove Such Improvements. Contractor Will Be Required To Remove Such Improvements Should They Not Be Removed By Their Owner At The Time Of Construction. The Contractor Will Be Required To Salvage All Fencing Material And Give Such Material To Their Owners. In The Event The Property Owner Does Not Want The Fencing Material, The Contractor Shall Dispose Of Same In A Manner Acceptable To The Engineer.

PROJECT DESCRIPTION  
**FAIRVIEW AVE.**

PROJECT NUMBER  
472 76 245 81253 000 000001

FILMED FROM THE BEST AVAILABLE COPY

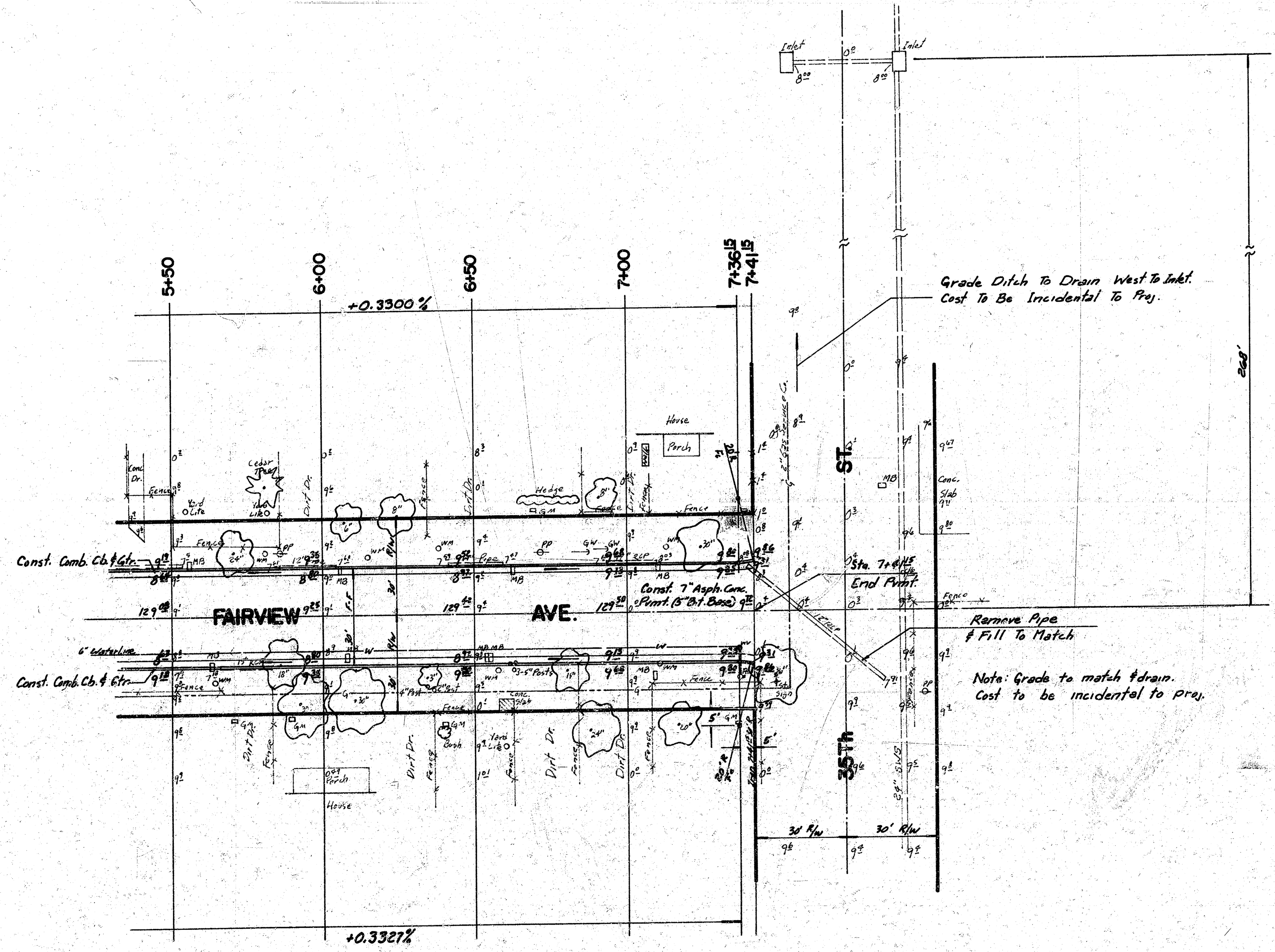
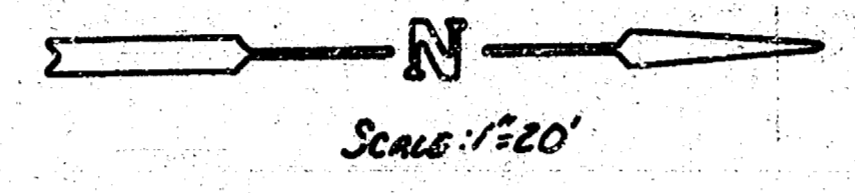

PROJECT DESCRIPTION	
FAIRVIEW AVE.	4/5
PROJECT NUMBER	
472 76 245 81253 000 000 001	

FILMED FROM THE BEST AVAILABLE COPY ...

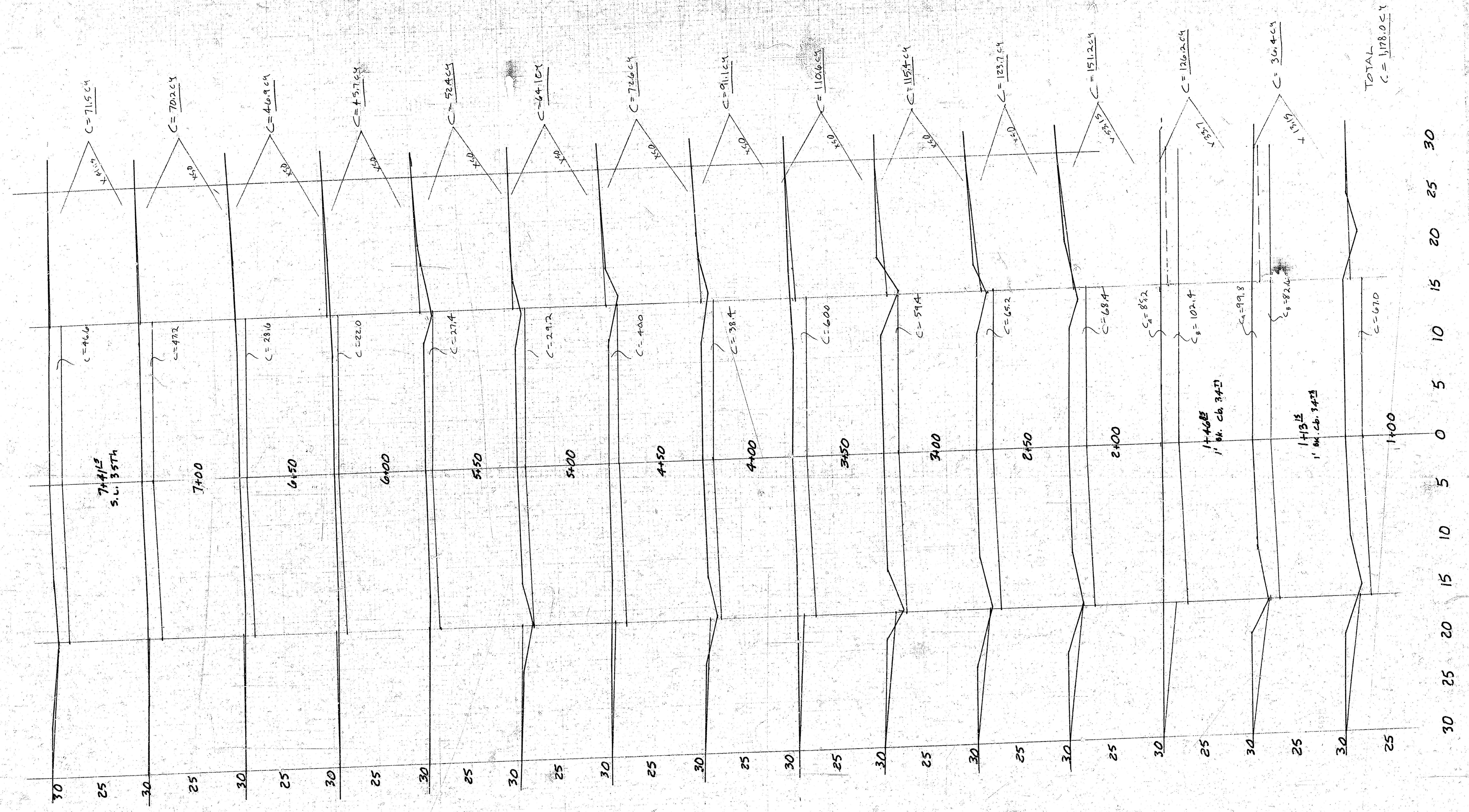

FAIRVIEW AVE.  
472 76 245 81253 000000 001 5/5

at 4 1 at

FILMED FROM THE BEST AVAILABLE COPY...