

B.M. 103.95' in Globe E. ch. Fern & N.L. Dora.

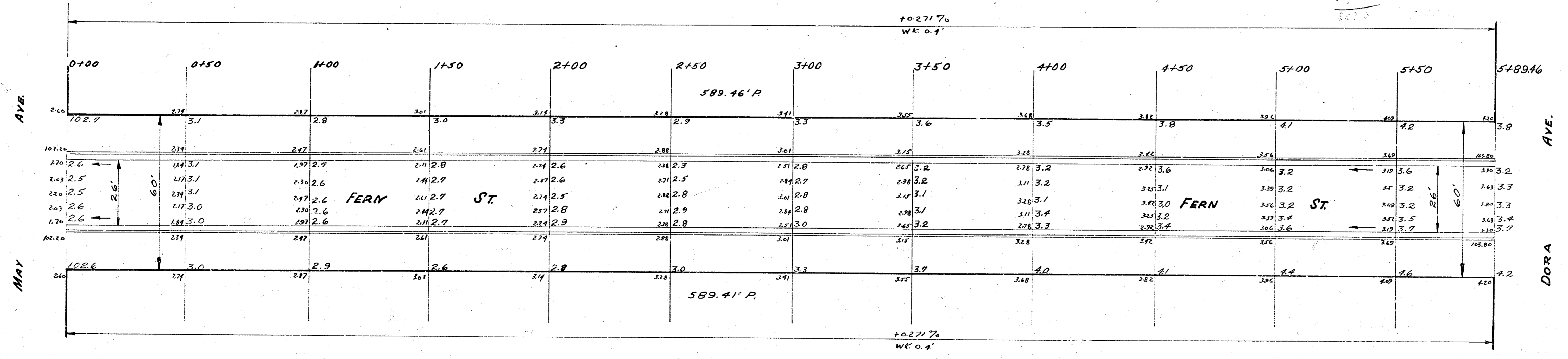
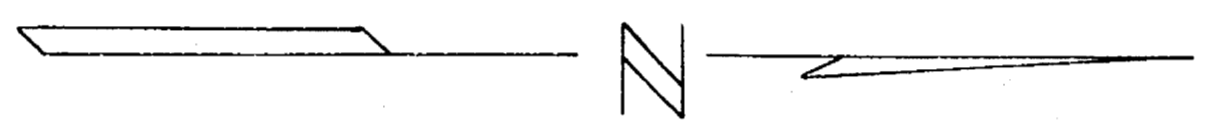

FERN ST.
 S.L. DORA AVE. TO N.L. MAY AVE.
 Comb. cb. & Gutter
 CITY OF WICHITA, KANSAS
 L. K. WHITE CITY ENGINEER
 APRIL 1950 PROJECT No. C10-15