

N
Scale: 1" = 20'

FIRE STATION NO. 1 SITE IMPROVEMENTS
City of Wichita
THE URBAN RENEWAL AGENCY OF THE
WICHITA KANSAS METROPOLITAN AREA
Kenneth H. Kitchen, Executive Director
R.W. Linn, City Engineer

Scope of Work.
Remove curb and gutter, driveways and sidewalk.
Construct comb. curb & gutter, driveways and sidewalk,
and surface alley with asphalt.

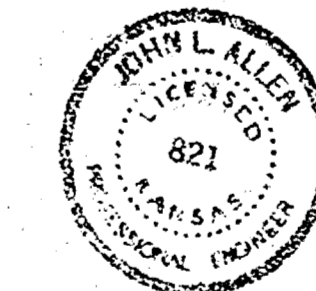

1/4

Scale: 1"=20'

B.M. 114.71 R.R. Spike S. Side P. Pole on N.E. corner Water & Murdock

B.M. 114.28 "d" cut top curb of radius N. side 2' x 2' catch basin on NW cor. Main & Murdock

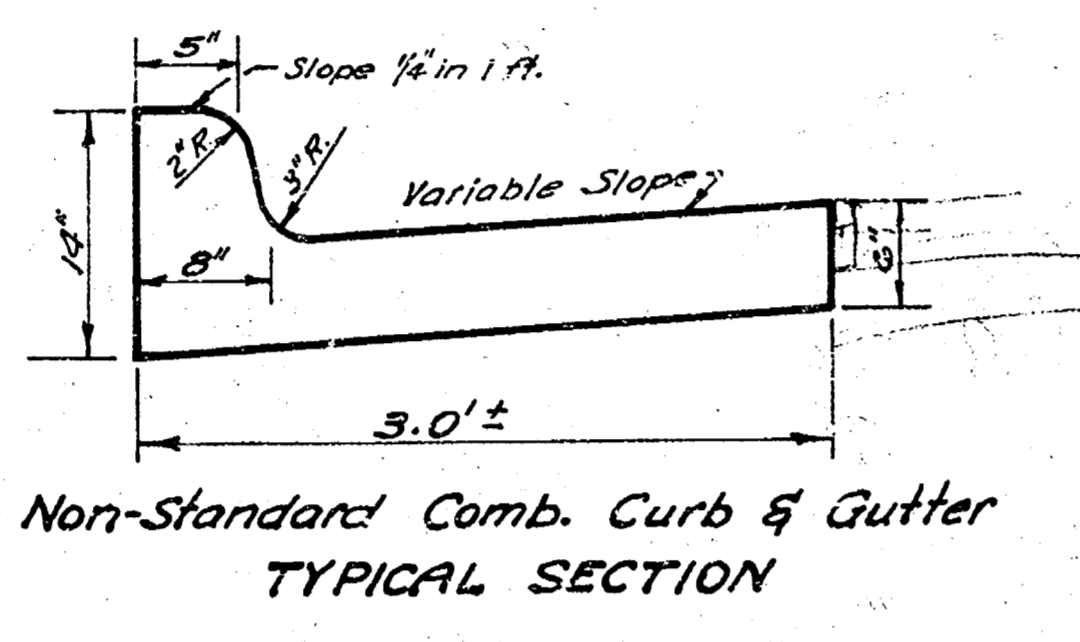

Non-Standard Comb. Curb & Gutter TYPICAL SECTION

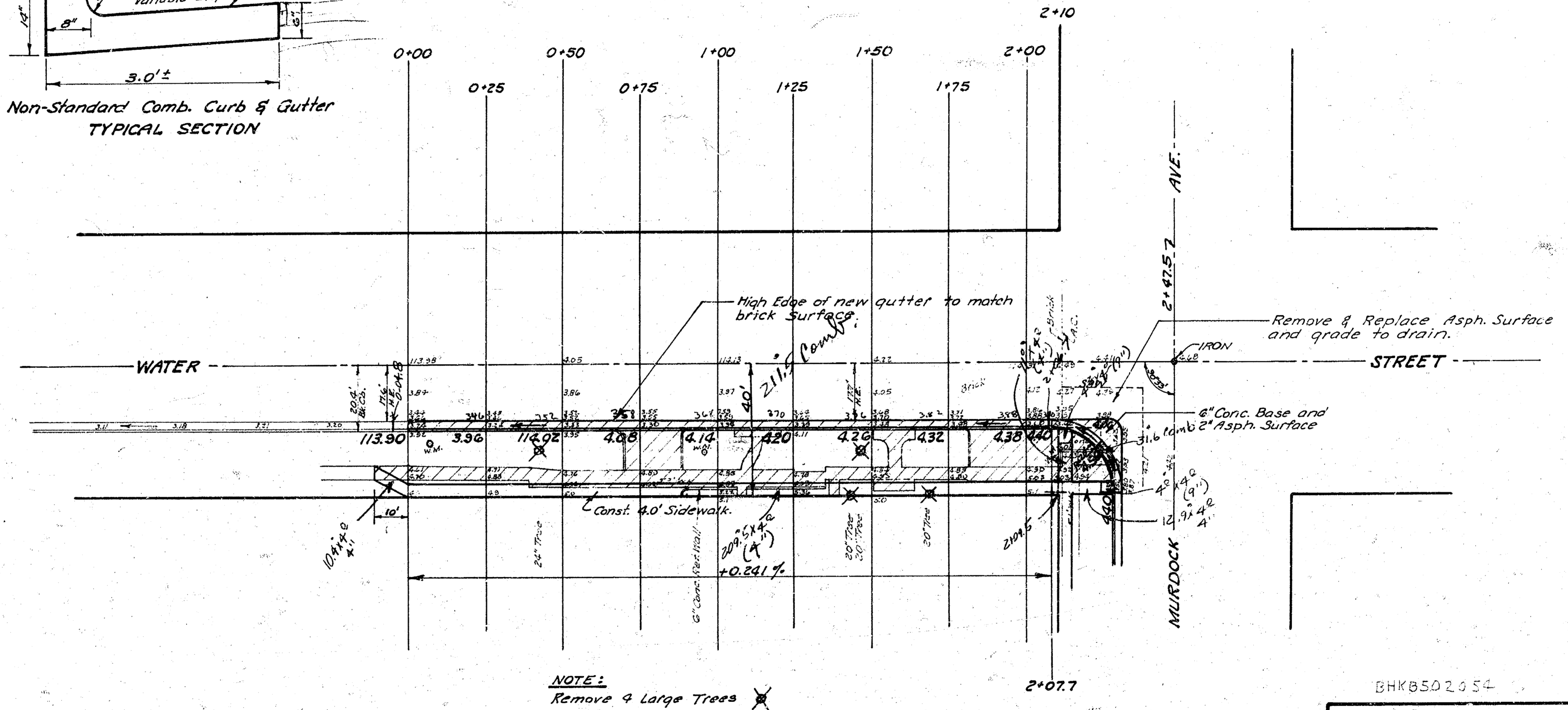

NOTE:
Remove 4 Large Trees

NOTE:
The cost for all excavation & comp. fill necessary to complete this work shall be considered incidental to the project.

BHK8502054
 FIRE STA. No. 1 SITE IMPROVEMENTS
 City of Wichita
 THE URBAN RENEWAL AGENCY
 OF THE WICHITA KANSAS
 METROPOLITAN AREA
 KENNETH H. KITCHEN EXECUTIVE DIRECTOR
 R.W. LINN CITY ENGINEER
 Date: _____

11/27/54
 W. J. G.
 W. J. G.
 W. J. G.

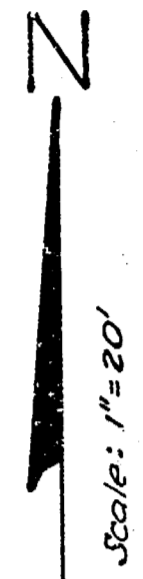

MURDOCK

WATER STREET - 0+00

MAIN STREET - 3+28.88 (1)

AVE.

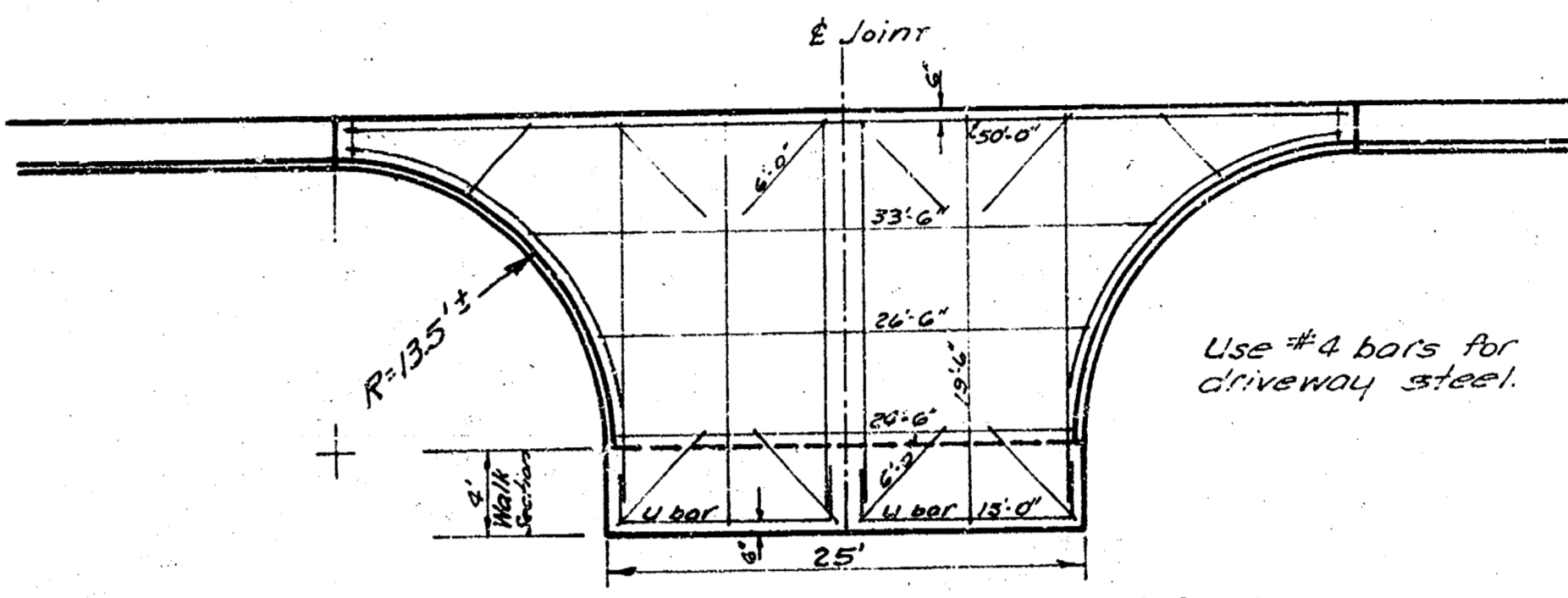
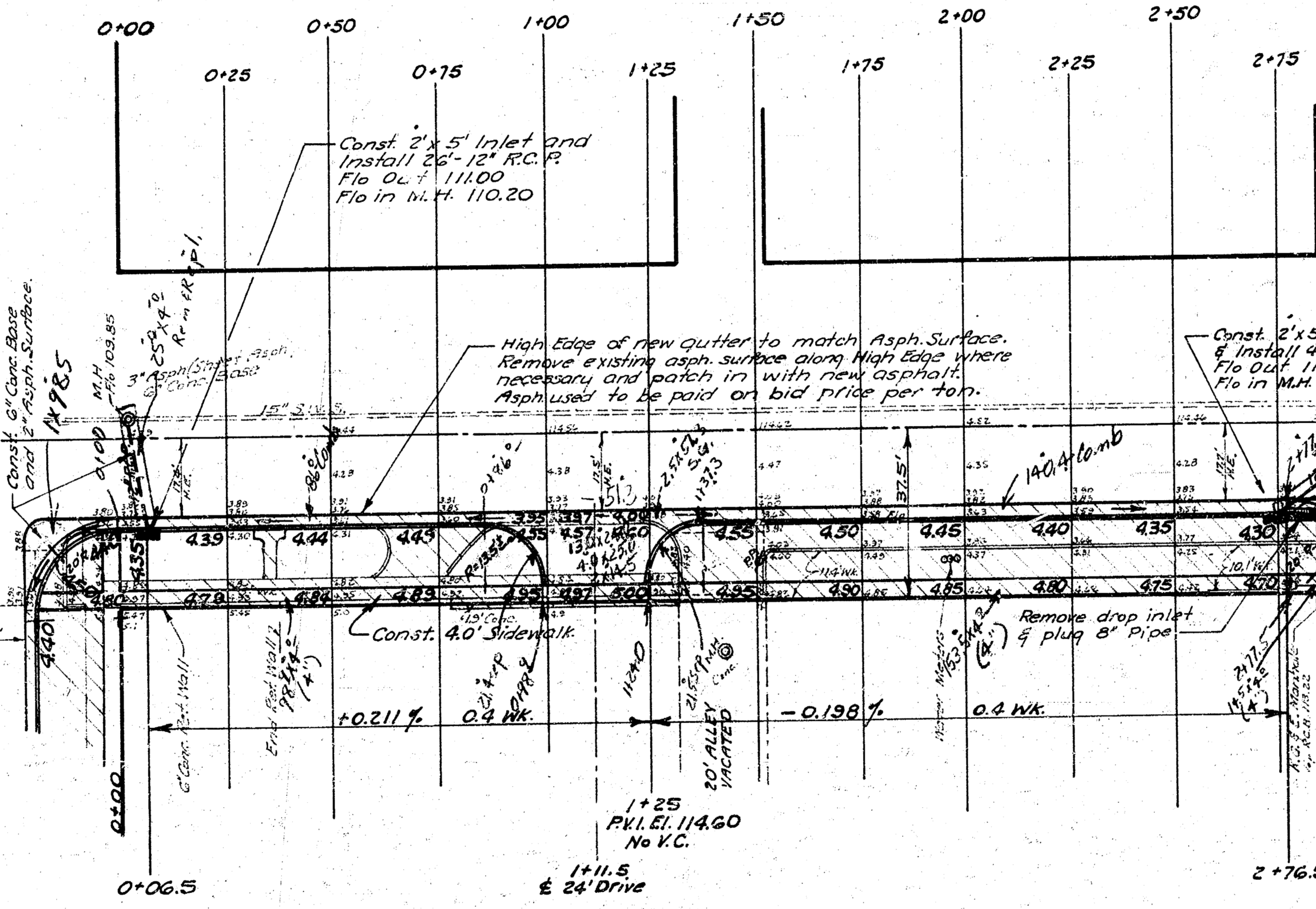

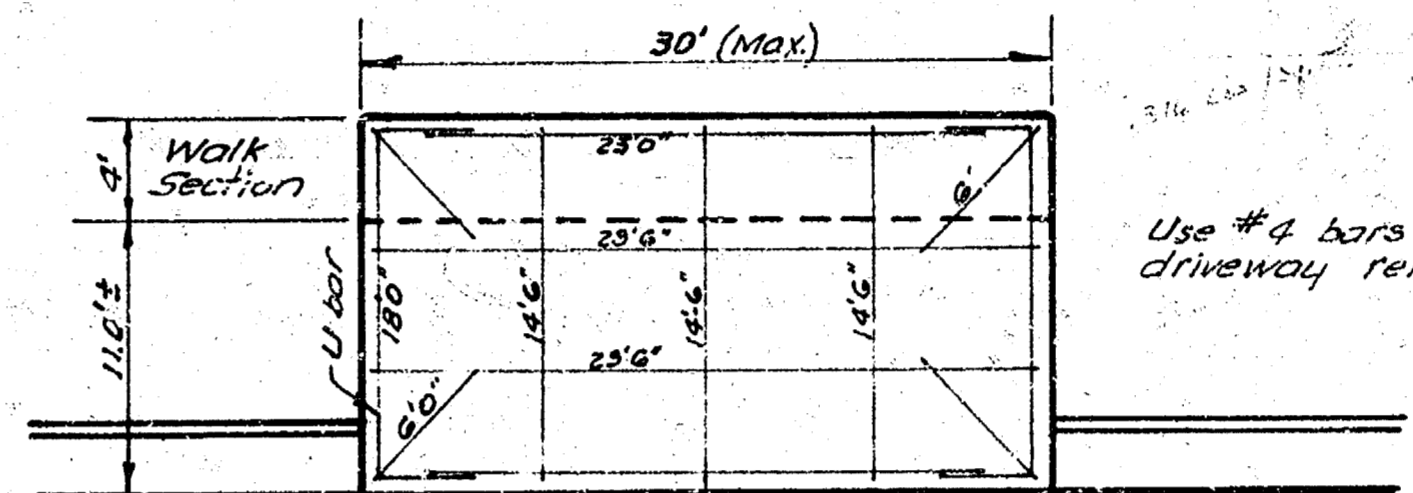
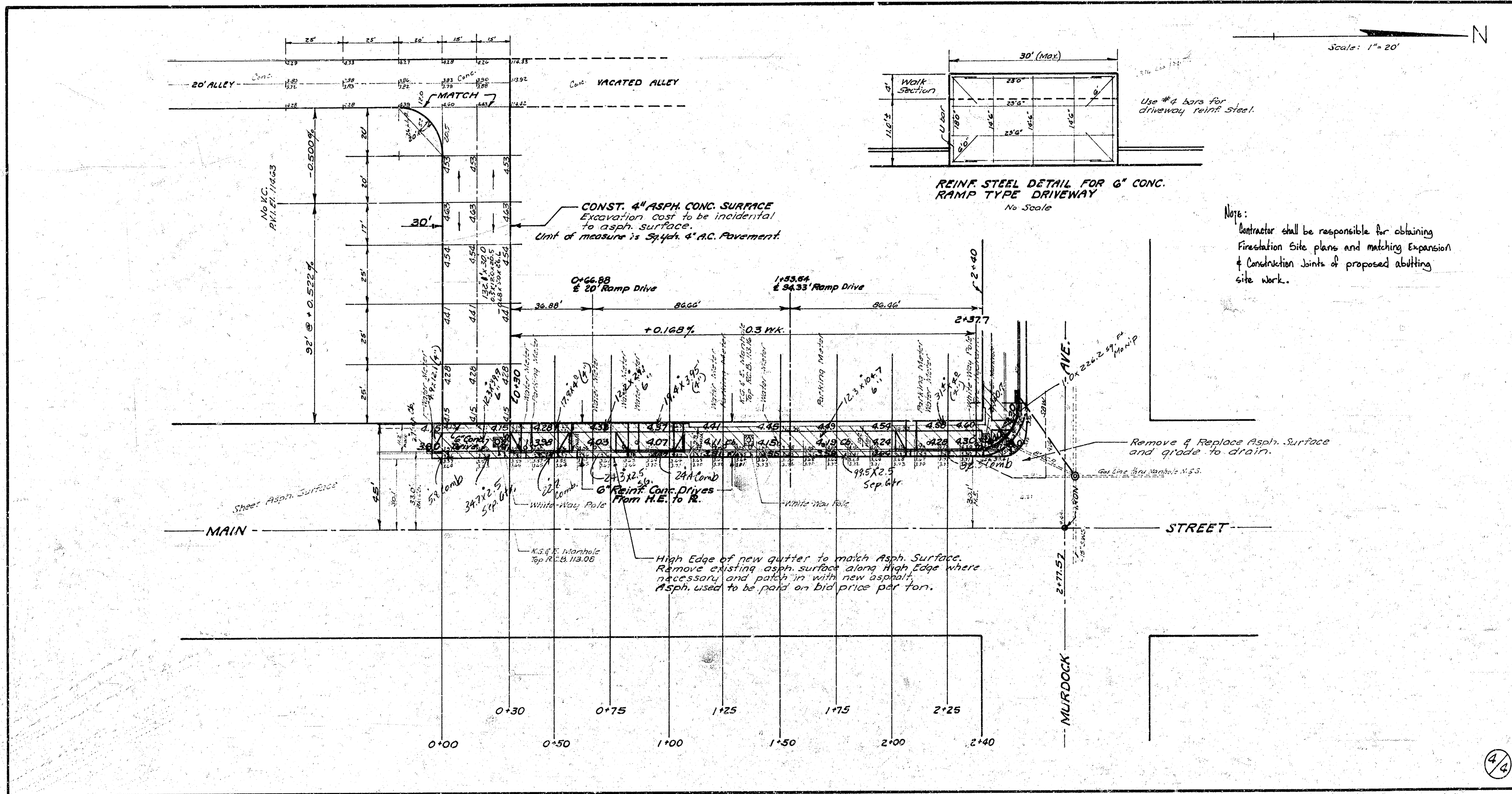

REINF. STEEL DETAIL FOR 6" CONC. RAMP TYPE DRIVEWAY
No Scale

Note:
Contractor shall be responsible for obtaining Firestation Site plans and matching Expansion & Constriction Joints of proposed abutting site work.

Scale: 1" = 20'

4/4