

NOTE:  
STA ON N.P.L.

Stationed on  
Plan  
Exc. 10  
Date 11/12

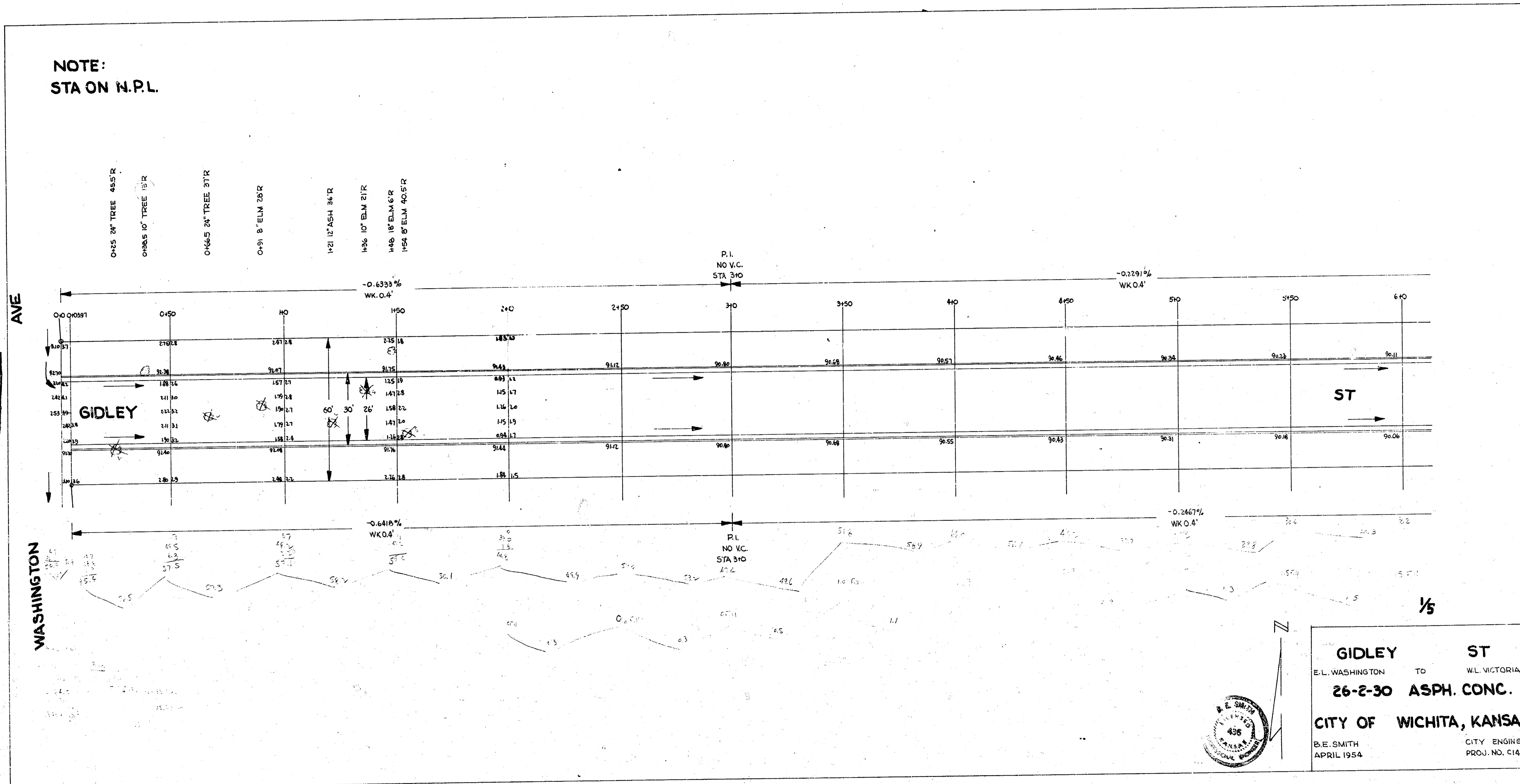

**GIDLEY ST**  
 E.L. WASHINGTON TO W.L. VICTORIA  
**26-2-30 ASPH. CONC.**  
**CITY OF WICHITA, KANSAS**  
 B.E. SMITH CITY ENGINEER  
 APRIL 1954 PROJ. NO. C14-11

**NOTE TO CONTRACTOR & INSPECTOR**

MATCH EXIST. DR'S SHOWN BET. STA 9+21.36 & STA 15+92.58

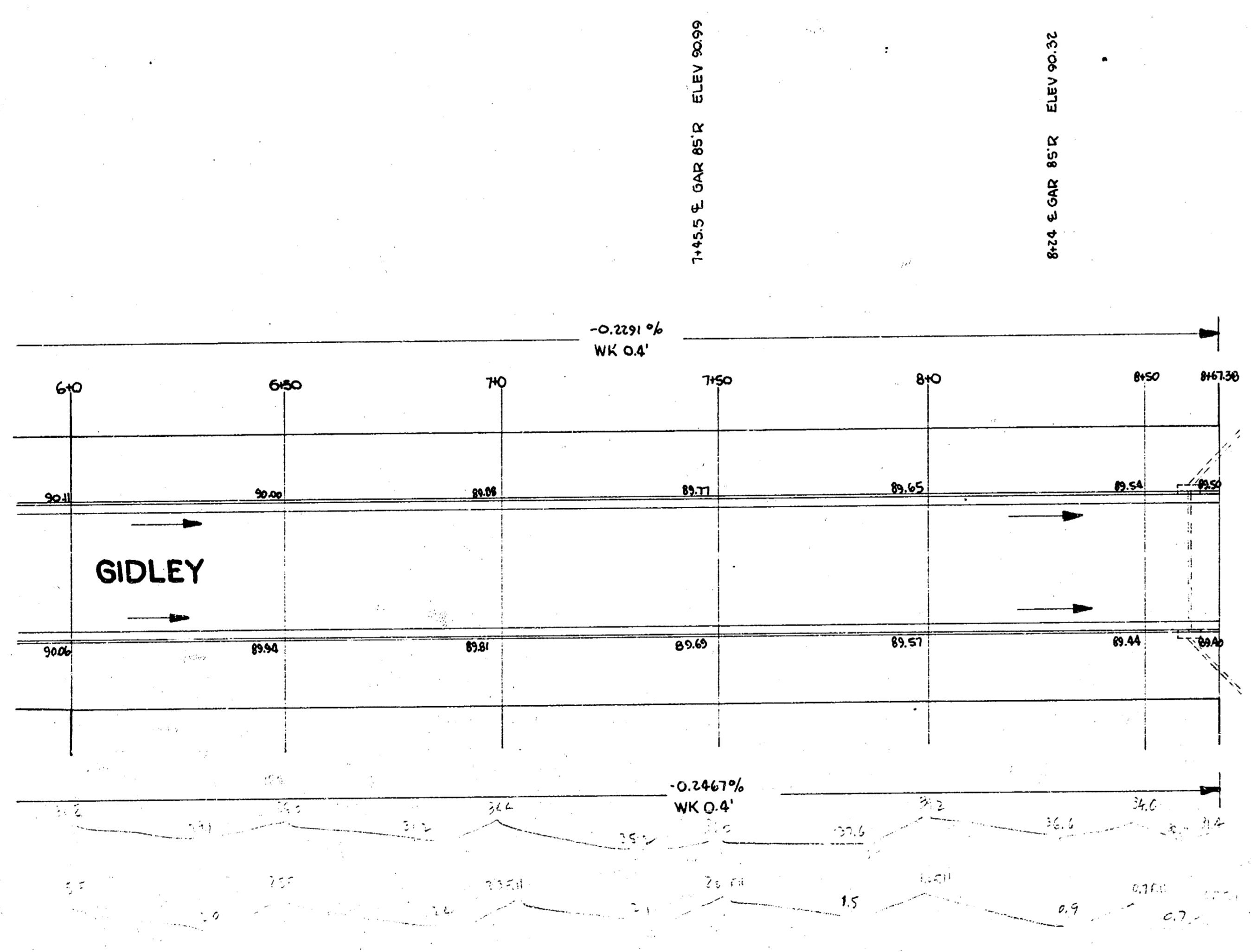

**AVE**

**NOTE**  
PATTIE INTERSECTION  
PAVED ON PROJ. NO. C14-16

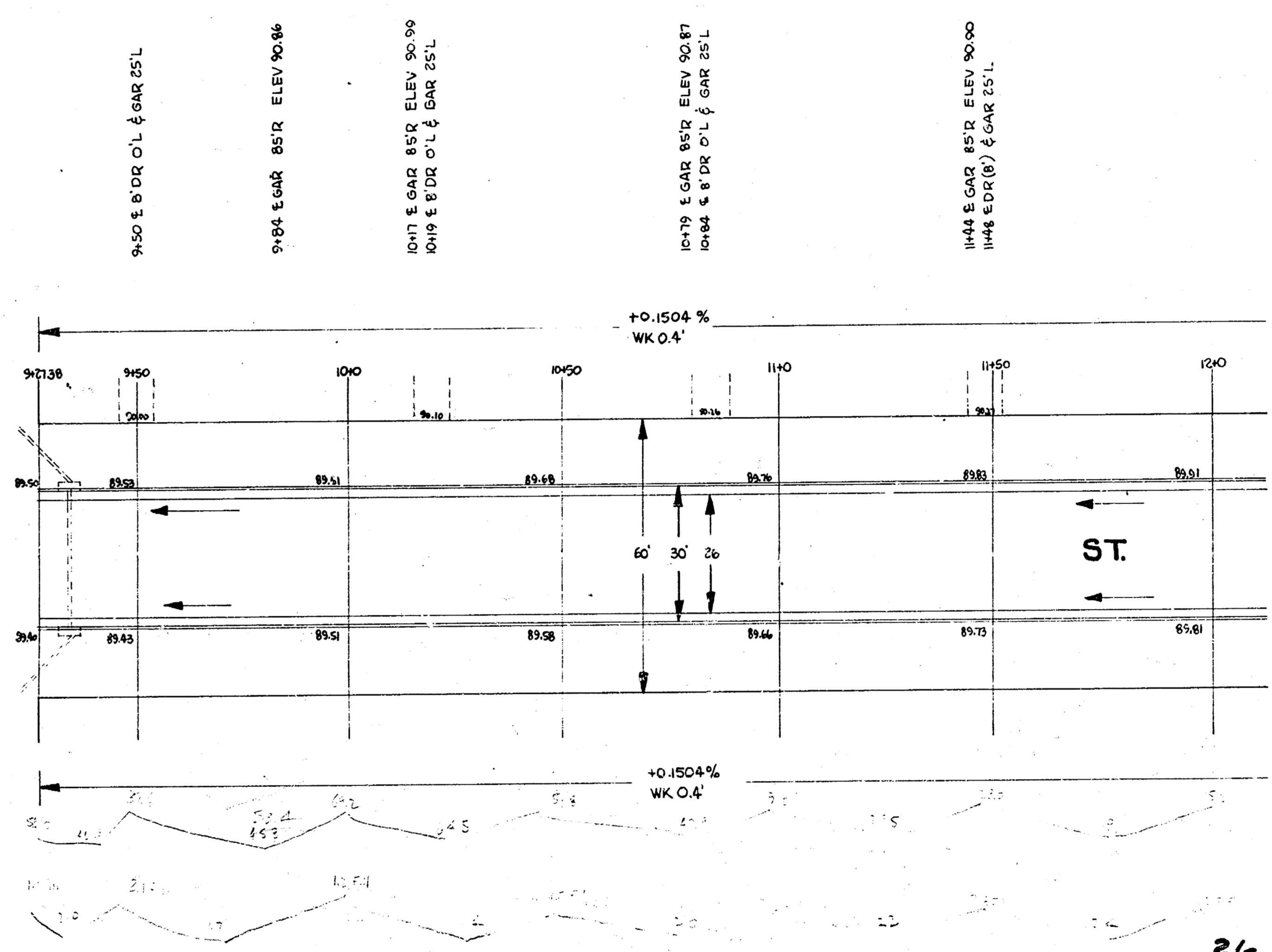

**PATTIE**

2/6

**GIDLEY ST**

PROJ. NO. C14-11

B.M. BOLT N.S.TEL. POLE 10' W OF WL. HYDRAULIC & S.L. GARDEN PARK ADDN ELEV. 93.11

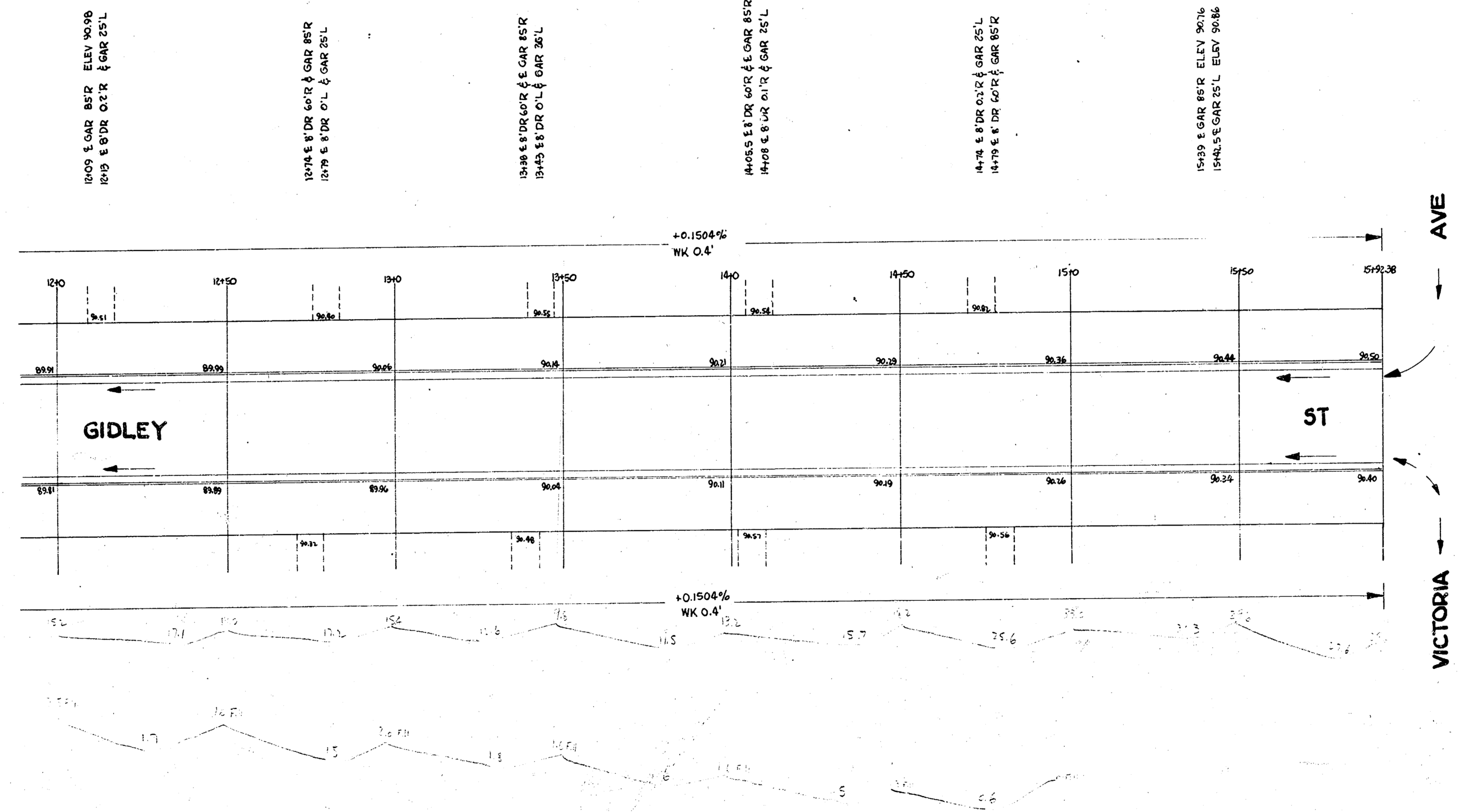

3/6

GIDLEY ST

PROJ. NO. C14-II