

Book 5  
J.V.

156.77  
T.M. 156.77 in Globe Nch. Gilbert 15'E. of E. 26' Yale  
B.M. 156.77 S.E. Cor. Lower Conc. step 697 30' Yale  
158.06

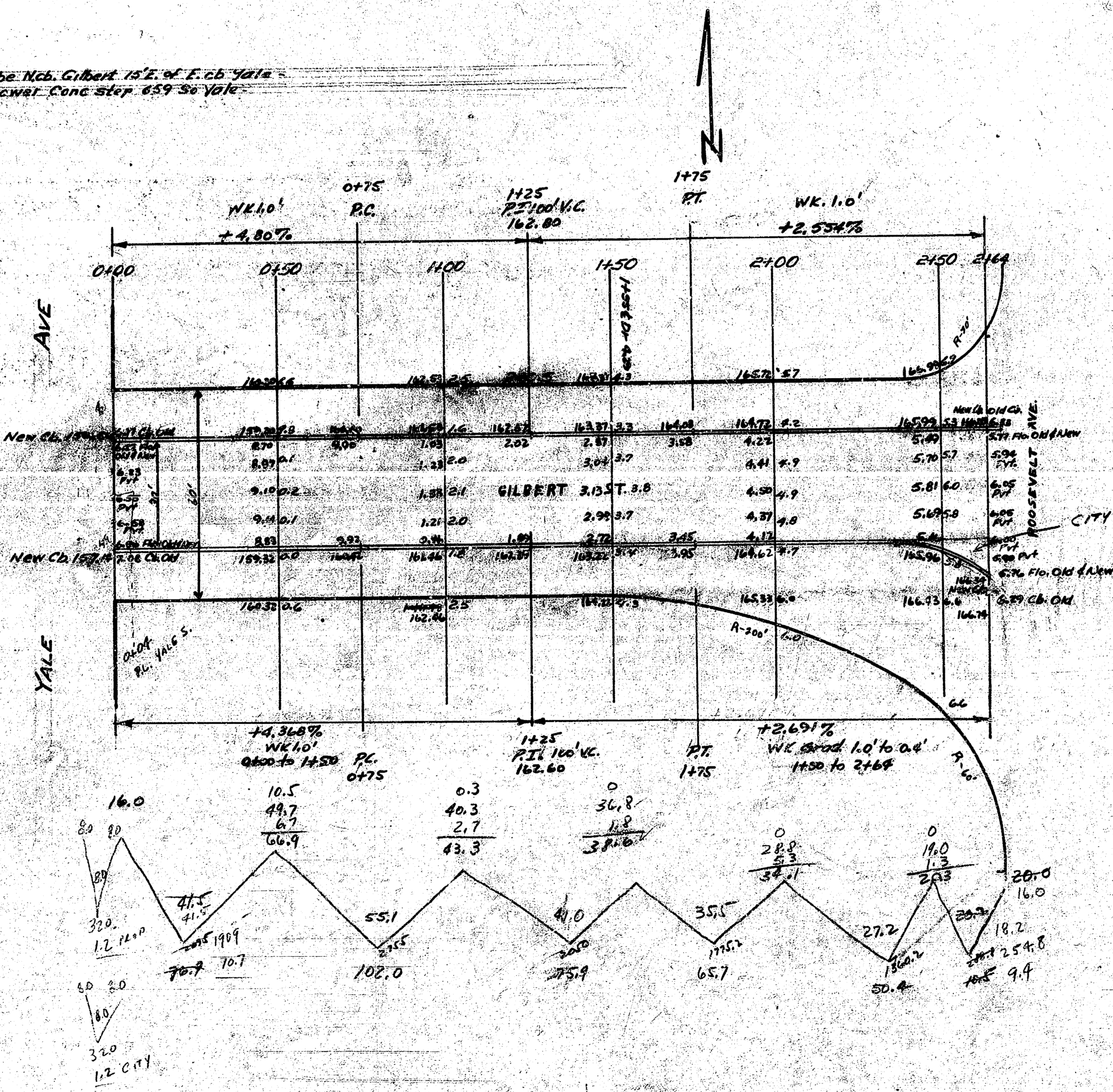

PROP.  
76.9  
102.0  
75.9  
65.7  
50.4  
10.5  
20.0  
401.4 Cu. Yds.  
+10% 40.1  
Total 441.5 Cu. Yds.

City  
0

CITY CHARGE  
0.14 x 35' x 5' = 27.5 = 4.5 cu. yds.

WILBUR ST.  
E.L. Yale W.L. Roosevelt  
Jr. Engr. - C.R.  
City of Wichita, Kansas  
L.M. White City Engineer  
September 1917

4 15 5 3