

B.M. 1448 6" in Globe N. Ch. Gilbert - E.L. Terrace Drive

B.M. 1427 7" in Tray Top Fire Hydr. N.W. Cor. Gilbert & Pershing

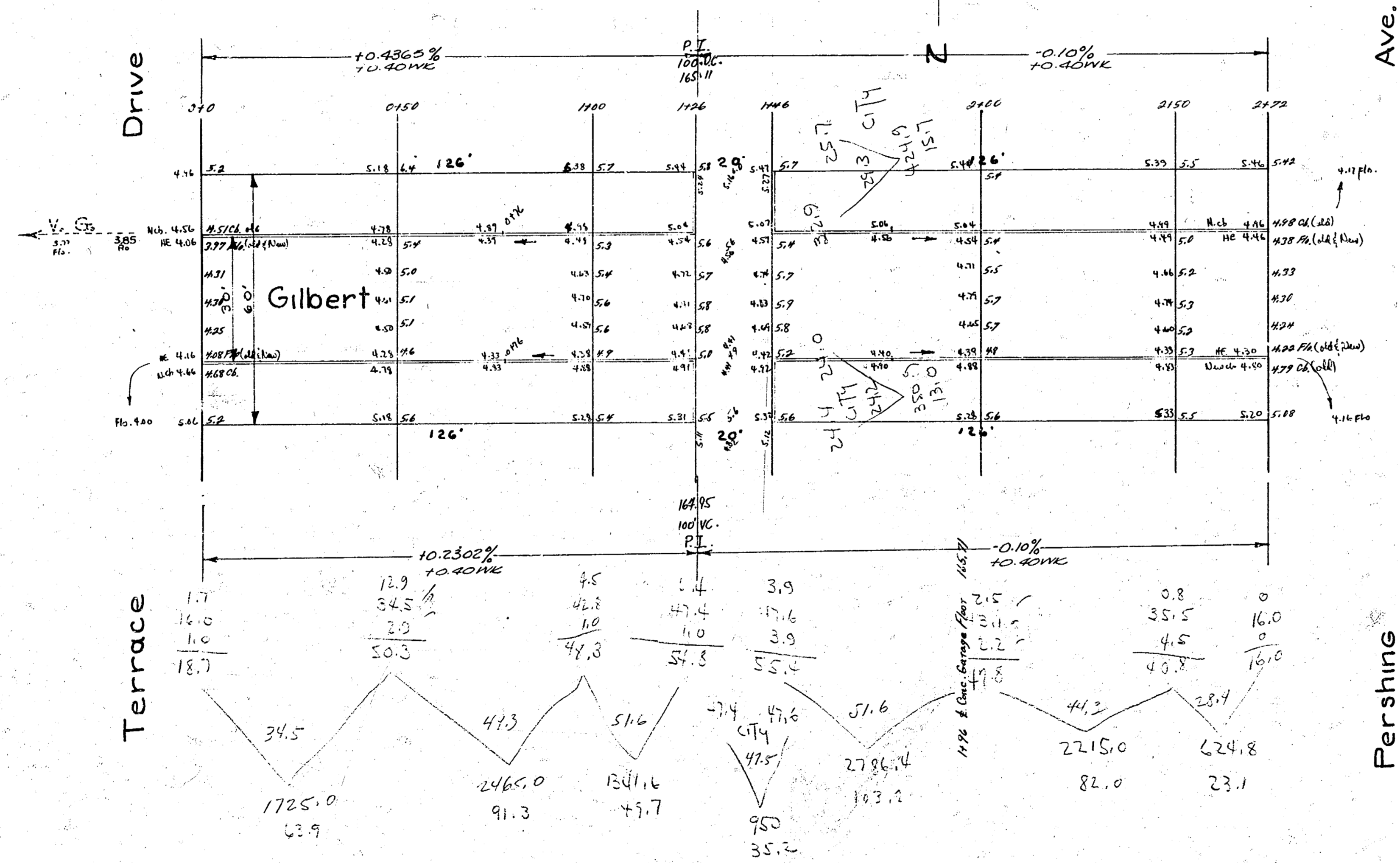

Handwritten calculations and notes:

$$\begin{array}{r} 12.0 \\ 2.0 \\ 22.0 \\ 4.0 \\ 48.0 \\ \hline 76.0 \end{array}$$
  

$$\begin{array}{r} 12.0 \\ 2.0 \\ 22.0 \\ 4.0 \\ 48.0 \\ \hline 76.0 \end{array}$$
  
 - 0.4%  
 76.0 - 0.304 = 75.696

Gilbert St.  
 W.L. Pershing ~ E.L. Terrace Dr.  
 30' Conc. & Curb  
 City of Wichita, Kansas  
 L.K. White ~ City Engineer  
 April 1949 Proj. C-19-43