

B.M. 150.64 "M" in Mueller, F. Hyd., N.E. Cor. Ellyco & Funston
 B.M. 146.01 "G" in Globe, Top W. ch. End Rd. on Glendale, near N.L. Funston W.
 B.M. 148.33 N.W. Cor. Conc. Porch No. 1662 S. Glendale
 B.M. 146.41 N.W. Cor. Wk. W. Side of Laundry Bldg. S. of S.L. Harry
 B.M. 141.37 S.W. Cor. N. Hubgard RCBC. 100' E. of Oliver on Harry
 Stationing on E.P.L.

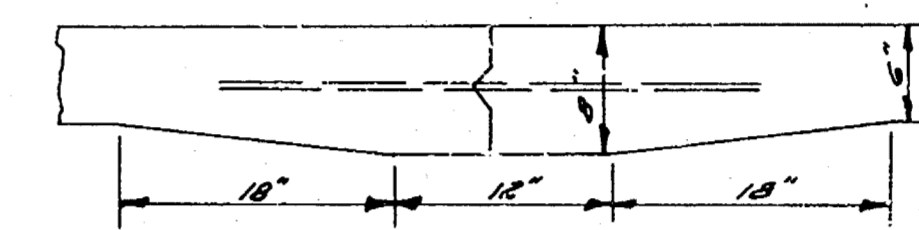

Use 1/2" # 2 Bars, 3' Long, on 2'-6" Ctrs.
 Mastic Joint Detail

PLAN 24
 BK 109
 EXC. FOR
 CONTRACTOR

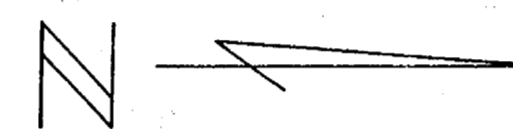
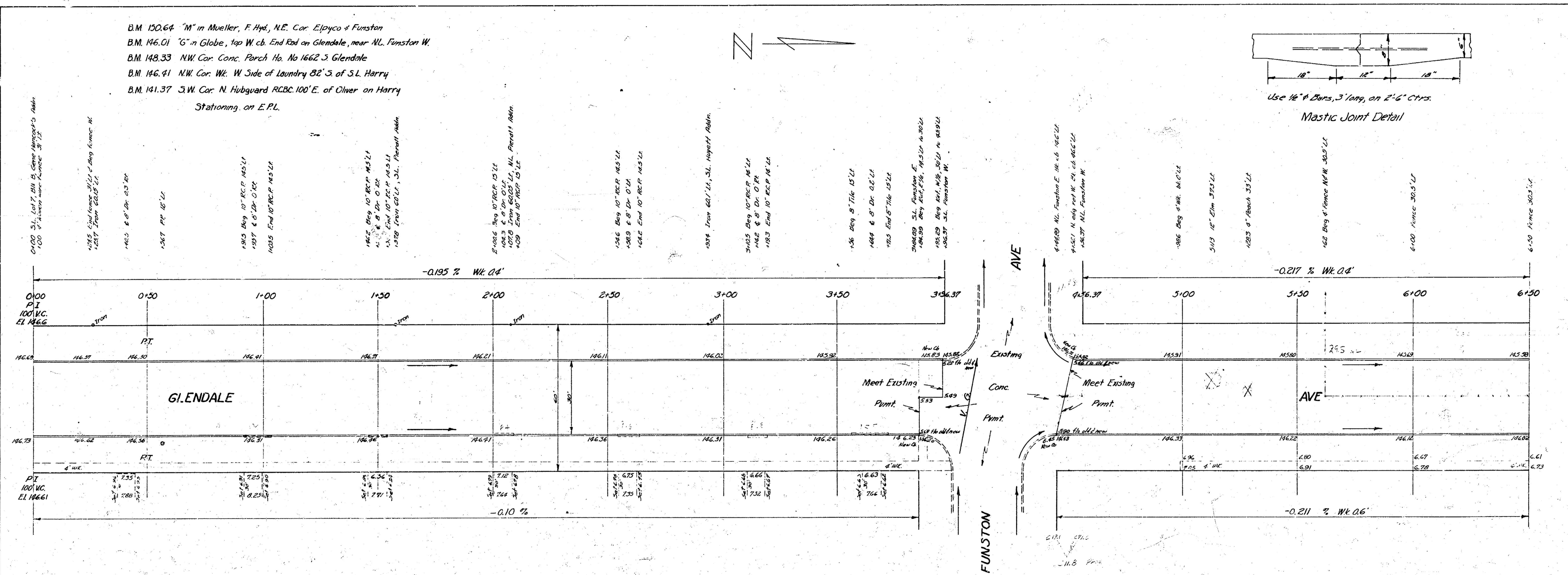

NOTE
 FIELD ENGINEER & CONTRACTOR: All R.C.P.'s are to be disposed of in accordance with dirt checkers instructions.

Prop.	City
507	517
548.7	518.5
485	518.5
7261 3252.3	7261 112.4



GLENDALE AVE
 S.L. Lot 7, Block B, GENE HANCOCK'S ADDN. TO S.L. HARRY 30' CONC. & CO.
 CITY OF WICHITA - KANSAS
 B.E. SMITH CITY ENGINEER
 MARCH 1934 PROJ. No. G12-160

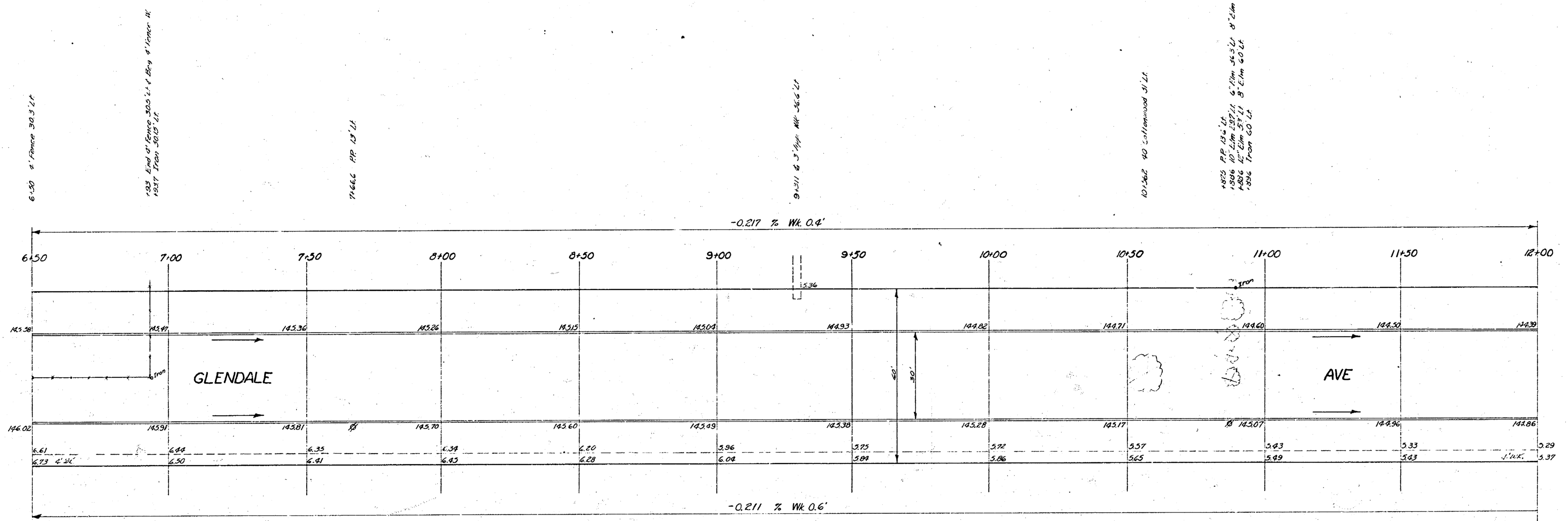
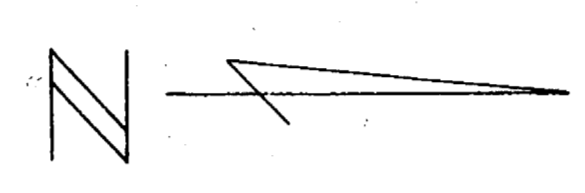

2/6

GLENDALE AVE
SL LOT 7, BLOCK B, GENE HANCOCK'S
ADDN. TO SL HARRY
Proj No. C12-160

