

2025 SYCAMORE WALKING PATHS
3637 W 15th St N, Wichita, KS 67203

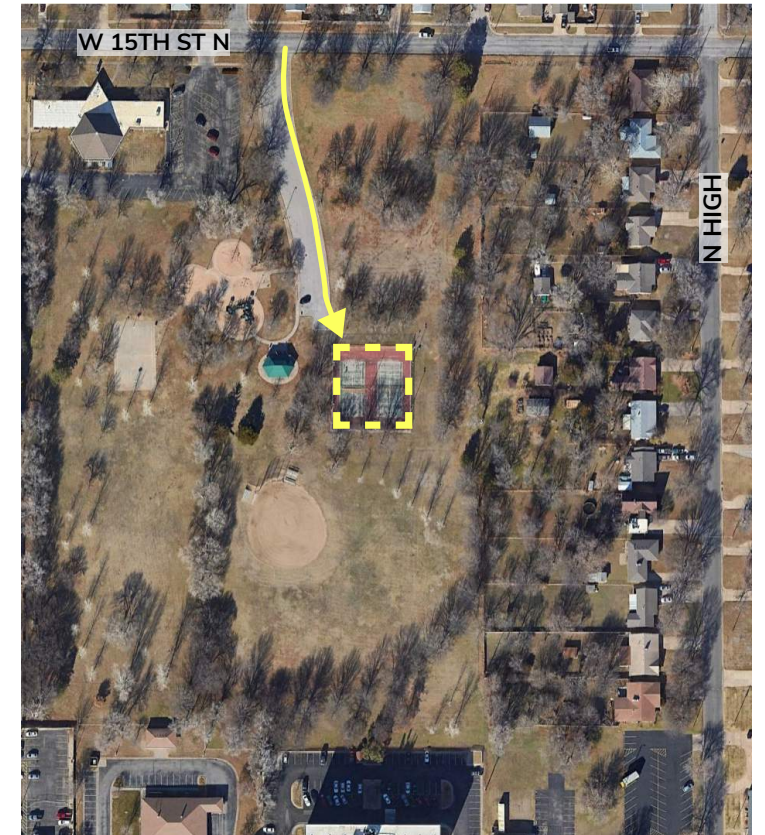
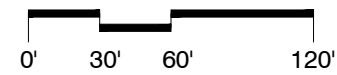
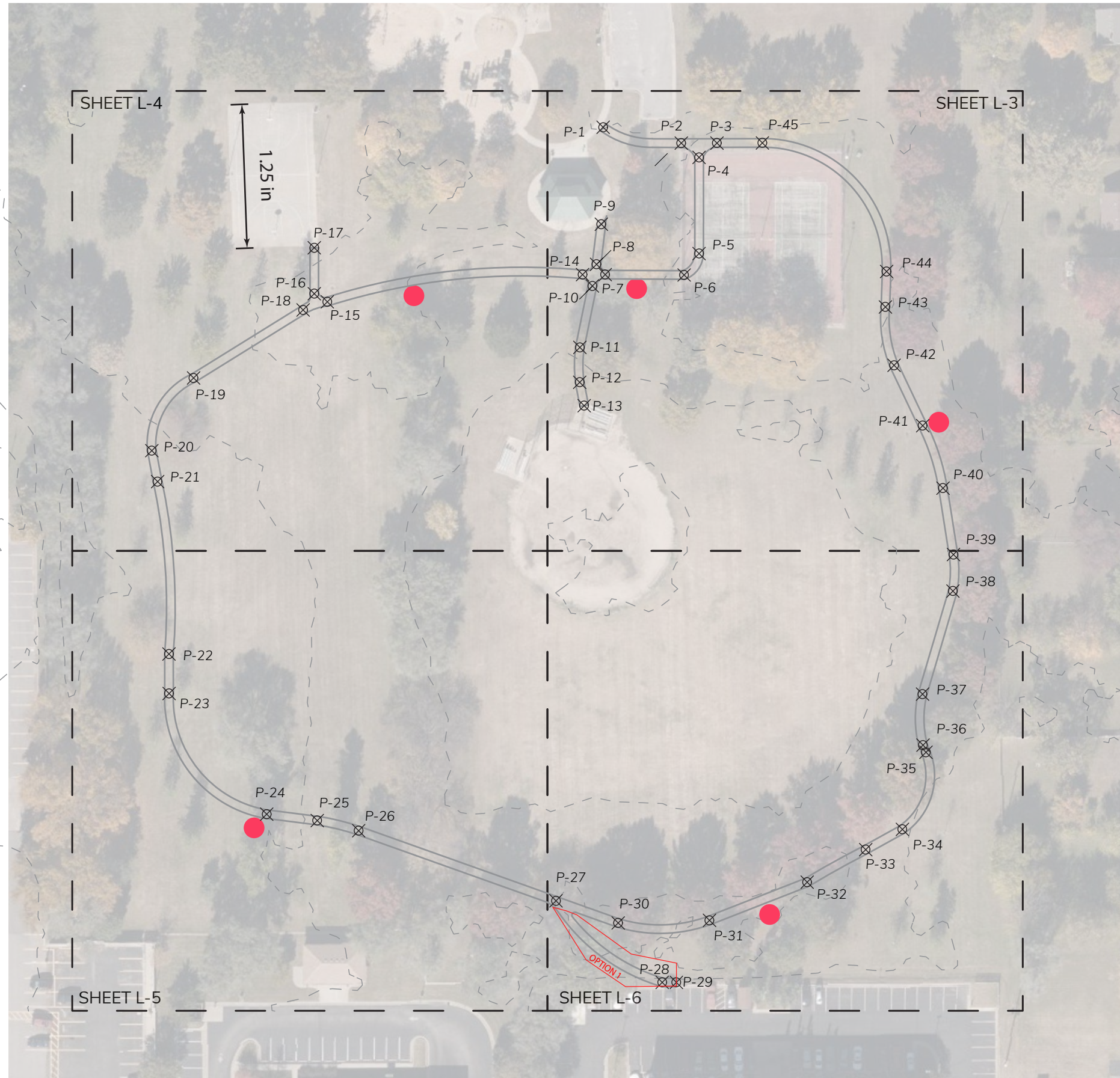

STAGING AREA

CONCRETE SIDEWALK 4" REINFORCED: 12,200 SF'
CONCRETE PAVEMENT 6" REINFORCED - COLORED: 144 SY
OPTION 1 CONCRETE SIDEWALK 4" REINFORCED: 230 SF'

● LOCATIONS FOR BENCHES AND THEIR 8'X4' SUPPORTING CONCRETE PLATFORMS. FINAL LOCATIONS TO BE DETERMINED ON SITE

TABLOID SCALE: 1"=80'



CITY OF WICHITA
PUBLIC WORKS & UTILITIES
ENGINEERING DIVISION

2025 SYCAMORE WALKING PATHS COVER		
CITY ENGINEER PAUL GUNZELMAN		
PROJECT NUMBER 482-11087	MUNIS NUMBER 44000425 - R5005	DATE 08/05/2025
CITY ENGINEER'S OFFICE CITY HALL - SEVENTH FLOOR 455 NORTH MAIN STREET WICHITA, KANSAS 67202-1620 (316) 268-4501		SHEET L-1

GENERAL NOTES

- THIS PROJECT IS LOCATED AT SYCAMORE PARK NEAR THE INTERSECTION OF WEST 15TH STREET NORTH AND N KESSLER AVE IN WICHITA, KANSAS.
- ALL CONSTRUCTION AND MATERIALS SHALL COMPLY WITH CITY OF WICHITA STANDARD CONSTRUCTION SPECIFICATIONS AND DETAILS, UNLESS OTHERWISE INCLUDED IN THE CONTRACT DOCUMENTS.
- EACH BIDDER IS ENCOURAGED TO VISIT THE SITE OF THE PROJECT BEFORE SUBMITTING THE PROPOSAL FOR THIS WORK SO THAT THEY WILL BE FULLY INFORMED OF THE EXISTING FIELD CONDITIONS AND THE OBSTACLES WHICH MIGHT BE ENCOUNTERED. UPON AWARD OF THE CONTRACT THE CONTRACTOR WILL NOT BE GRANTED ANY ADDITIONAL COMPENSATION WITH REGARDS TO TIME AND MONEY FOR CONDITIONS THAT MAY HAVE BEEN EVALUATED DURING ANY INSPECTION OF THE SITE.
- AT LEAST 72 HOURS PRIOR TO BEGINNING ANY EXCAVATION (EXCLUDING WEEKENDS AND HOLIDAYS), THE CONTRACTOR SHALL CONTACT THE KANSAS ONE-CALL SYSTEM, A UTILITY LOCATION SERVICE, AT (316)-687-2470 OR 811 TO REQUEST THE LOCAL UTILITY COMPANIES TO LOCATE ANY EXISTING LINES WITHIN THE PROJECT AREA. PARK UTILITIES SHALL BE LOCATED, AND FIELD VERIFIED BY PUBLIC WORKS AT (316)-268-4555. ALSO CONTACT PARK IRRIGATION AT (316)-350-3171 FOR IRRIGATION LOCATIONS.
- THE CONTRACTOR MUST NOTIFY THE FOLLOWING IN CASE OF AN EMERGENCY: EMERGENCY DISPATCH: 911 COX COMMUNICATIONS: 888-249-3530 EVERGY: 800-383-1183 AT&T: 800-286-8313 KANSAS GAS SERVICE: 888-482-4950 WICHITA WATER: 316-262-6000
- THE CONTRACTOR SHALL PROVIDE OWNER A MINIMUM OF SEVEN (7) DAYS ADVANCE NOTICE PRIOR TO THE START OF CONSTRUCTION.
- THE CONTRACTOR SHALL NOT START WORK ON THE PROJECT UNTIL THE PROJECT INSPECTOR IS ASSIGNED AND PRESENT ON THE SITE. ANY WORK DONE WITHOUT INSPECTION WILL BE REQUIRED TO BE UNCOVERED FOR INSPECTION AT THE CONTRACTOR'S EXPENSE.
- THE CONTRACTOR IS EXPECTED TO EXPOSE AND VERIFY THE VERTICAL AND HORIZONTAL LOCATION OF EXISTING UTILITIES THAT ARE IN POTENTIAL CONFLICT WITH THE PROPOSED IMPROVEMENTS. THE UTILITY LOCATES SHALL BE PERFORMED PRIOR TO THE START OF CONSTRUCTION AND ANY DISCREPANCIES SHALL BE REPORTED IMMEDIATELY TO THE ENGINEER.
- THE CONTRACTOR SHALL BE RESPONSIBLE FOR PRESERVING PROPERTY IRONS. THE CONTRACTOR SHALL BE REQUIRED TO RE-ESTABLISH ANY PROPERTY IRONS WHICH ARE DAMAGED OR DESTROYED BY CONSTRUCTION OPERATIONS. SUCH IRONS SHALL BE RE-ESTABLISHED BY A LICENSED LAND SURVEYOR IN ACCORDANCE WITH STATE LAWS.
- LOCATION AND AREA TO BE VERIFIED ON SITE PRIOR TO ANY CONSTRUCTION.
- THE CONTRACTOR SHALL RESTORE ALL DITCHES, SWALES, AND BANKS TO THEIR ORIGINAL SLOPES AND GRADES EXCEPT AS SHOWN OTHERWISE. WHERE EXISTING ENTRANCE PIPE, DRAINAGE PIPE, SIGNS, FENCES, LANDSCAPING, ETC., CONFLICT WITH THE PROPOSED WORK HEREIN, THEY SHALL BE REMOVED AND REPLACED OR RESET, UNLESS OTHERWISE NOTED ON THE DRAWINGS.
- IF VANDALISM OCCURS IT WILL BE THE RESPONSIBILITY OF THE CONTRACTOR TO REPLACEDAMAGED/NEW CONCRETE WORK.
- THE CONTRACTOR SHALL INSTALL AND/OR MAINTAIN EROSION CONTROL METHODS AS NEEDED TO ABATE EROSION. THE CONTRACTOR SHALL BE RESPONSIBLE FOR MAINTAINING EROSION CONTROL THROUGH THE COMPLETION OF THIS PROJECT. INSTALLATION OF THESE EROSION CONTROL DEVICES DOES NOT RELIEVE THE CONTRACTOR OF THE RESPONSIBILITY OF ABATING SOIL EROSION.
- THE CONTRACTOR SHALL TAKE CARE TO PREVENT SILT AND DEBRIS FROM ENTERING ANY STORM DRAINAGE SYSTEM DURING CONSTRUCTION. PIPES OR STRUCTURES WHICH CONTAIN MATERIALS FROM THE CONTRACTORS ACTIVITIES SHALL BE THOROUGHLY CLEANED BY THE CONTRACTOR, AT THEIR OWN EXPENSE, PRIOR TO THE FINAL INSPECTION.
- RECONSTRUCTION OF EROSION CONTROL MEASURES WHICH ARE DESTROYED BY WIND, FLOOD, FIRE, OR BY THE ACTIONS OF THE CONTRACTOR OR OTHERS SHALL BE PERFORMED BY THE CONTRACTOR AS DIRECTED BY THE ENGINEER AT NO ADDITIONAL COST. WHERE ADJUSTMENTS IN QUANTITIES ARE REQUIRED BY FIELD CONDITIONS, THERE SHALL BE NO ADJUSTMENT IN UNIT PRICE.
- ALL GRASSED AREAS DISTURBED BY CONSTRUCTION OF THE PROPOSED IMPROVEMENTS SHALL BE REPLANTED WITH GRASS AND FERTILIZED. EXISTING GRASSED AREAS DISTURBED BY CONSTRUCTION SHALL BE REPLANTED WITH THE SAME TYPE OF GRASS AS WAS REMOVED, UNLESS OTHERWISE SPECIFIED.
- THE TOP 6" OF ALL AREAS TO BE SEEDED SHALL RECEIVE TOPSOIL MATERIAL SUITABLE FOR GROWTH OF VEGETATION. OVEREXCAVATE 6" THRU AREAS OF CUT FOR PLACEMENT OF TOPSOIL. NO ADDITIONAL PAYMENT SHALL BE MADE FOR DOUBLE-HANDLING OF STOCKPILING.
- CONTRACTOR SHALL BE RESPONSIBLE FOR SURVEYING AND CONSTRUCTION STAKING. STAKING AND BENCH MARKS DESTROYED DURING CONSTRUCTION OPERATIONS SHALL BE REPLACED AT THE CONTRACTOR'S EXPENSE.
- CONTRACTOR SHALL MAINTAIN UNINTERRUPTED UTILITY SERVICE TO ADJACENT FACILITIES DURING CONSTRUCTION, UNLESS OTHERWISE APPROVED BY OWNER.
- THE CONTRACTOR SHALL BE RESPONSIBLE FOR LOCATING ALL PRIVATE EXISTING UTILITIES PRIOR TO CONSTRUCTION. THE CONTRACTOR SHALL VERIFY THE HORIZONTAL AND VERTICAL LOCATIONS PRIOR TO CONSTRUCTION. FINDINGS SHALL BE REPORTED TO THE OWNER'S REPRESENTATIVE. ANY DIMENSIONAL CONFLICTS SHALL BE RESOLVED PRIOR TO CONSTRUCTION.
- THE CONTRACTOR SHALL BE RESPONSIBLE FOR SECURING THE SITE DURING CONSTRUCTION WITH TEMPORARY FENCING OR OTHER APPROVED METHODS. CONTRACTOR IS RESPONSIBLE FOR PREVENTING DAMAGE TO EXISTING SIDEWALKS, TURF AREAS, SIGNS, POLES, OR ANY OTHER SITE AMENITY. ANY DAMAGE (CRACKED SIDEWALKS, RUTS IN TURF AREAS) IS TO BE REPAIRED BY CONTRACTOR.
- ANY EXISTING PAVING REMOVED OR DAMAGED DURING CONSTRUCTION THAT IS NOT SHOWN TO BE REMOVED, SHALL BE REPLACED TO MATCH EXISTING OR BETTER CONDITION AT NO ADDITIONAL COST TO THE PROJECT.
- SITE RESTORATION SHALL INCLUDE ESTABLISHMENT OF PROPER GRADES FOR ALL AREAS DISTURBED BY CONSTRUCTION AND SEEDING TO A BUFFALO GRASS/RYE GRASS MIX (2.0) POUNDS PURE LIVE SEED BUFFALO AND 1.0 POUNDS PURE LIVE SEED RYE GRASS PER 1,000 SQUARE FEET) AS DIRECTED BY CITY.
- THIS IS A TAX EXEMPT PROJECT. A SALES TAX EXEMPTION CERTIFICATE FROM THE STATE OF KANSAS WILL BE PROVIDED.

ADA NOTES

- ALL PAVEMENT SHALL MEET ADA STANDARDS.
- MATCH EXISTING TO REMAIN PATHWAY. SIDEWALKS SHALL HAVE RUNNING SLOPE NOT STEEPER THAN 1:20 (5%). THE CROSS SLOPE OF WALKING SURFACES SHALL BE BETWEEN 1:50-1:100 (1-2%).
- CONTRACTOR SHALL ADHERE TO THE LATEST ADA REGULATIONS AND REPORT ANY DISCREPANCIES TO THE ENGINEER FOR RESOLUTION PRIOR TO CONSTRUCTION.

SITE GRADING NOTES

- ALL FILL MATERIAL BLADED SMOOTH AND SLOPED TO DRAIN.
- THE CONTRACTOR SHALL SATISFY THEMSELVES WITH THE EARTHWORK QUANTITIES AND NO CHANGE ORDER FOR EARTHWORK WILL BE APPROVED.
- ALL FILL AND EARTHWORK GREATER THAN 6" IN DEPTH SHALL REQUIRE 95% COMPACTION IN LIFT LAYERS OF 6" IN DEPTH.
- FINISHED GRADES SHOWN ON PLANS ARE TO BE THE FINAL ELEVATIONS OF ALL WORK, INCLUDING PAVEMENT.

PAVEMENT NOTES

- PATHS TO BE CONSTRUCTED TO CITY OF WICHITA SPECIFICATIONS, USING CONCRETE (CITY APPROVED SIX SACK MIX).
- PAVEMENT SHALL BE 4" DEPTH WITH REINFORCEMENT AND BROOM FINISH. PAVEMENT AREAS IDENTIFIED AS CROSSING AREA ON PLANS SHALL BE 6" IN DEPTH, REINFORCED WITH 6" X 6" WELDED WIRE FABRIC, BROOM FINISH, AND COLORED MOCHA BROWN (OR APPROVED EQUAL). CONTINUOUS WIRE CHAIRS BARS OF 2" HEIGHT (OR APPROVED EQUAL) SHALL BE USED ON 2' CENTERS. FIBER MAY BE USED IN-LIEU OF WELDED WIRE. FIBER SHALL BE ADDED AT THE RATE OF 2-3 LBS/CY, AND SHALL BE ONE OF THE PRODUCTS FOUND ON THE CITY OF WICHITA, DEPARTMENT OF PUBLIC WORKS & UTILITIES APPROVED MATERIALS LIST (PART 400-PAVEMENT) DATED 3/17/17.
- NEWLY CONSTRUCTED PATHWAYS SHALL BE 6' IN WIDTH, UNLESS NOTED OR SHOWN OTHERWISE ON THE PLANS.
- FORMS TO BE 2X4 OR YELLOW PINE OR SIMILAR MATERIAL TO ALLOW FOR SMOOTH CURVES THROUGHOUT AND TO ASSURE A MINIMUM OF 4" THICKNESS. NO STRAIGHT STEEL FORMS WILL BE ALLOWED, EXCEPT ON STRAIGHT RUNS, AS APPROVED BY ENGINEERING OR PARK REPRESENTATIVE. BOARDS WILL NOT BE USED ONCE THE MATERIAL HAS WARPED. ANY FORMS EXPOSED TO THE WEATHER (RAIN, SNOW) BEFORE CONCRETE IS POURED MUST BE APPROVED BY ENGINEERING REPRESENTATIVE BEFORE CONCRETE IS POURED. THE CONCRETE PATH MUST BE, AT A MINIMUM HAND FORMED IN AREAS THAT ARE CONNECTING TO ANY EXISTING CONCRETE.
- CONTRACTOR WILL BE REQUIRED TO NOTIFY THE CITY ENGINEER WHEN CONCRETE FORMS ARE SUBSTANTIALLY SET, ALLOWING TIME FOR INSPECTION OF FORMS AND ANY NECESSARY ADJUSTMENTS PRIOR TO POURING CONCRETE.
- PAVEMENT SHALL SHED WATER IN THE NATURAL DIRECTION OF THE EXISTING GRADE WITH THE GOAL OF PREVENTING COLLECTION OR POOLING OF WATER ON THE PAVEMENT SURFACE.
- EXPANSION JOINTS SHALL BE CAULKED AND SEALED WITH A GRAY COLORED BASF MASTERSEAL NP2 SEALANT OR APPROVED EQUAL. EXPANSION JOINTS SHALL BE USED A MINIMUM OF EVERY 50' AND WHEN CONNECTING TO EXISTING PAVEMENT. TOOLED JOINTS SHALL BE PLACED EVERY 6' WHERE POSSIBLE. NO SAWCUT JOINTS SHALL BE PERFORMED. EXPANSION JOINTS SHALL BE INSTALLED EVERY 50' AND WHENEVER THE NEWLY CONSTRUCTED PATHWAY IS CONNECTED TO EXISTING CONCRETE.
- ALL CONCRETE POURS PRIOR TO HARDENING SHOULD BE STAMPED WITH CONTRACTOR NAME AND YEAR OF CONSTRUCTION.

DEMOLITION NOTES

- PRIOR TO BID, THE CONTRACTOR IS ENCOURAGED TO PERFORM A SITE REVIEW AND ACCOUNT FOR ANY DEMOLITION ITEMS. ALL DEMOLITION IS SUBSIDIARY TO THE PROJECT.
- THE CONTRACTOR IS RESPONSIBLE FOR ALL COSTS TO REPAIR DAMAGE TO EXISTING UTILITY SERVICE LINES OR MAIN LINES, BUILDINGS, PAVEMENT ON OR ADJACENT TO THE SITE THAT ARE TO REMAIN IN SERVICE AND ARE NOT CALLED TO BE DEMOLISHED ON THIS PLAN, INCLUDING SERVICE LINES THAT ARE NOT SHOWN IN THE PLANS.
- THE CONTRACTOR IS RESPONSIBLE FOR DEMOLITION PERMIT FEES, DISPOSAL FEES, ANY OTHER FEES ASSOCIATED WITH ANY DEMOLITION ITEMS.
- IF CONTAMINATED MATERIAL IS ENCOUNTERED, THE CONTRACTOR SHALL NOTIFY KDHE AND FOLLOW THE PROCEDURES FOR HANDLING AND DISPOSAL OF THE CONTAMINATED MATERIALS.
- RUBBLE FROM THE REMOVAL OF MISCELLANEOUS STRUCTURES INCLUDING ANY TREES REMOVED, TREE TRIMMINGS, AND EXCESS EXCAVATION WHICH IS TO BE WASTED SHALL BE DISPOSED OF ON SITES PROVIDED BY THE CONTRACTOR. THESE SITES SHALL ALSO BE APPROVED BY THE ENGINEER AS TO SUITABILITY, APPEARANCE, AND SITE LOCATION. LOCATIONS THAT, IN THE OPINION OF THE ENGINEER, WILL LEAVE AN UNSIGHTLY APPEARANCE WILL NOT BE APPROVED. ALL DISPOSAL SITES MUST BE APPROVED BY THE KANSAS DEPARTMENT OF HEALTH AND ENVIRONMENT. MATERIAL EITHER STOCKPILED OR DISPOSED OF IN A FLOOD PLAIN WILL REQUIRE A KANSAS STATE BOARD OF AGRICULTURE PERMIT. ANY MATERIAL DUMPED IN WATERS OF THE UNITED STATES, FLOODWAYS, OR WETLANDS IS SUBJECT TO U.S. CORPS OF ENGINEERS PERMITTING REGULATIONS. ANY MATERIAL BURIED OR STOCKPILED BEYOND APPROVED CONSTRUCTION LIMITS MAY REQUIRE ARCHAEOLOGICAL INVESTIGATIONS UNLESS BURIED IN A PREVIOUSLY APPROVED DISPOSAL LOCATION.
- A FULL DEPTH SAW CUT OR A SAW CUT UP TO 12 INCHES (MAX.) THE EXISTING CONCRETE PAVEMENT SHALL BE PROVIDED AT LOCATIONS WHERE PARTIAL REMOVAL OF THAT PAVEMENT IS REQUIRED. SAWED JOINT TO FACILITATE REMOVAL WITHIN THREE FEET OF EXISTING JOINTS WILL NOT BE PERMITTED AND FOR SUCH INSTANCES THE LIMITS OF REMOVAL SHALL EXTEND TO THE EXISTING JOINT.
- ALL TREE REMOVAL, CLEARING, STRIPPING, GRUBBING, TREE AND SHRUB REMOVAL NECESSARY TO COMPLETE THE WORK SHALL BE THE RESPONSIBILITY OF THE CONTRACTOR. TREES LARGER THEN 3" MEASURED AT 2' ABOVE GRADE SHALL BE INSPECTED BY THE CITY OF WICHITA'S ARBORIST OR THEIR DESIGNATED REPRESENTATIVE BEFORE REMOVAL. IF A TREE OR TREES ARE SELECTED FOR RETENTION, IT/THEY WILL BE TAGGED BY THE CITY OF WICHITA AND ALL APPROPRIATE TREE PRESERVATION STRATEGIES WILL BE IMPLEMENTED BY THE CONTRACTOR.

SITE FURNISHING NOTES

- BENCHES SHALL BE 6" PARK BENCH WITH BACK SUPERIOR INTERNATIONAL PRODUCTS (FORMERLY WEBCOAT) MODEL B6WBINNPERFS-POLY
 - SEAT AND BACK SURFACES TO BE 11GA PUNCHED STEEL (EXPANDED METAL IS NOT ACCEPTABLE), 15" WIDE, WITH 3" RADIUS CORNERS
 - FRAMING TO BE ½" X 2" X 1/8" T
 - BACK AND SEAT CENTER SUPPORTS AND MOUNTING BRACKETS TO BE ¼" X 1-1/2" STEEL
 - SEAT AND BACK FINISH ASSEMBLIES TO BE FINISHED WITH A 1/8" THICK TEXTURED MATTE POLYETHYLENE (POWDER)
 - PLASTISOL/PVC COATINGS ARE NOT ACCEPTABLE
 - COLOR TO BE GREEN
 - FRAMES TO BE 2-3/8" DIAMETER X 11GA STRUCTURAL STEEL TUBING
 - INGROUND MOUNT
 - MINIMUM 1/4" X 1-1/2" FLAT BAR STEEL SEAT BOLT PLATES
 - FRAME FINISH ASSEMBLIES ARE TO BE FINISHED WITH A POWDER COAT, ELECTRO-STATICALLY APPLIED AND OVEN CURED ACCORDING TO POWDER MANUFACTURER'S SPECIFICATIONS
 - COLOR TO BE BLACK
 - ALL HARDWARE TO BE STAINLESS STEEL

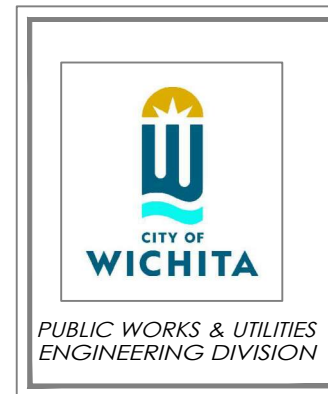

2025 SYCAMORE WALKING PATHS NOTES		
CITY ENGINEER PAUL GUNZELMAN		
PROJECT NUMBER 482-11087	MUNIS NUMBER 44000425 - R5005	DATE 08/05/2025
<i>CITY ENGINEER'S OFFICE</i> CITY HALL - SEVENTH FLOOR 455 NORTH MAIN STREET WICHITA, KANSAS 67202-1620 (316) 268-4501		SHEET L-2

DEMO 15' OF EXISTING CURB AND REPLACE WITH TYPE 2 CURB (SEE SHEET L-9). LOCATION TO BE FIELD VERIFIED

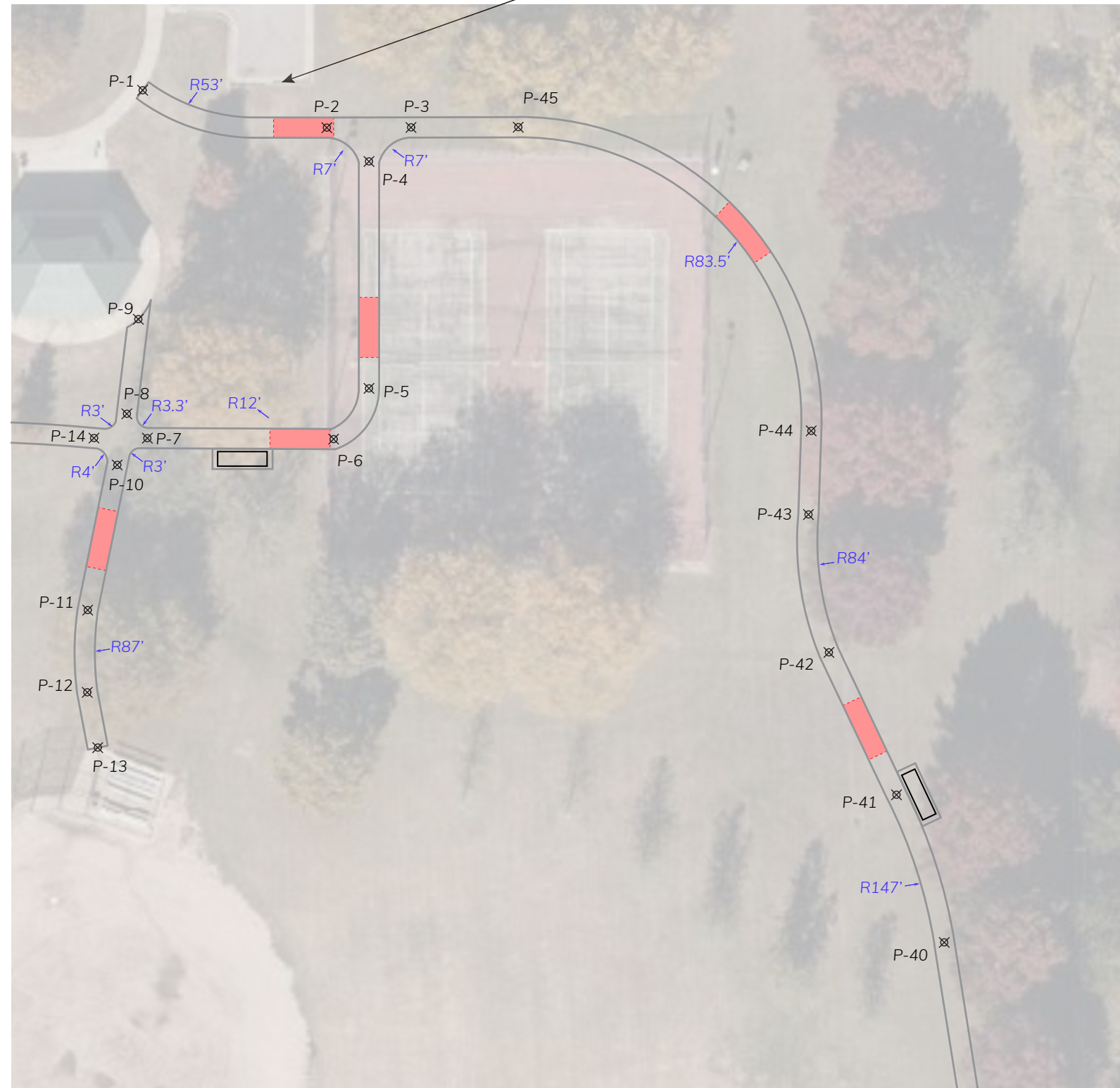

Point Table			
Point #	Raw Description	Northing	Easting
1	P-1	1634671.1035	1694486.6206
2	P-2	1634660.0444	1694541.1224
3	P-3	1634660.1044	1694566.0398
4	P-4	1634650.0403	1694553.5936
5	P-5	1634582.9201	1694553.5936
6	P-6	1634567.9208	1694543.1351
7	P-7	1634568.1924	1694488.0114
8	P-8	1634575.3897	1694481.9574
9	P-9	1634603.3711	1694485.3317
10	P-10	1634560.2665	1694479.1097
11	P-11	1634517.3316	1694470.3628
12	P-12	1634493.0103	1694470.2331
13	P-13	1634476.6467	1694473.3370
14	P-14	1634568.2190	1694472.2252
40	P-40	1634419.0285	1694723.8198
41	P-41	1634462.6989	1694709.6858
42	P-42	1634504.8161	1694689.6986
43	P-43	1634545.6064	1694683.6397
44	P-44	1634570.3486	1694684.4707
45	P-45	1634660.1862	1694597.7704

TABLOID SCALE: 1"=40'

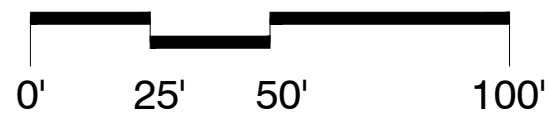

CITY OF WICHITA
PUBLIC WORKS & UTILITIES
ENGINEERING DIVISION

2025 SYCAMORE WALKING PATHS LAYOUT PLAN

CITY ENGINEER
PAUL GUNZELMAN

PROJECT NUMBER 482-11087	MUNIS NUMBER 44000425 - R5005	DATE 08/05/2025
-----------------------------	----------------------------------	--------------------

CITY ENGINEER'S OFFICE
CITY HALL - SEVENTH FLOOR
455 NORTH MAIN STREET
WICHITA, KANSAS 67202-1620
(316) 268-4501

SHEET
L-3

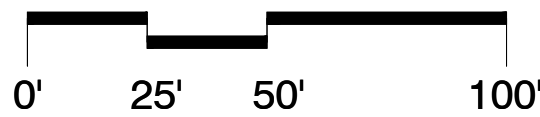
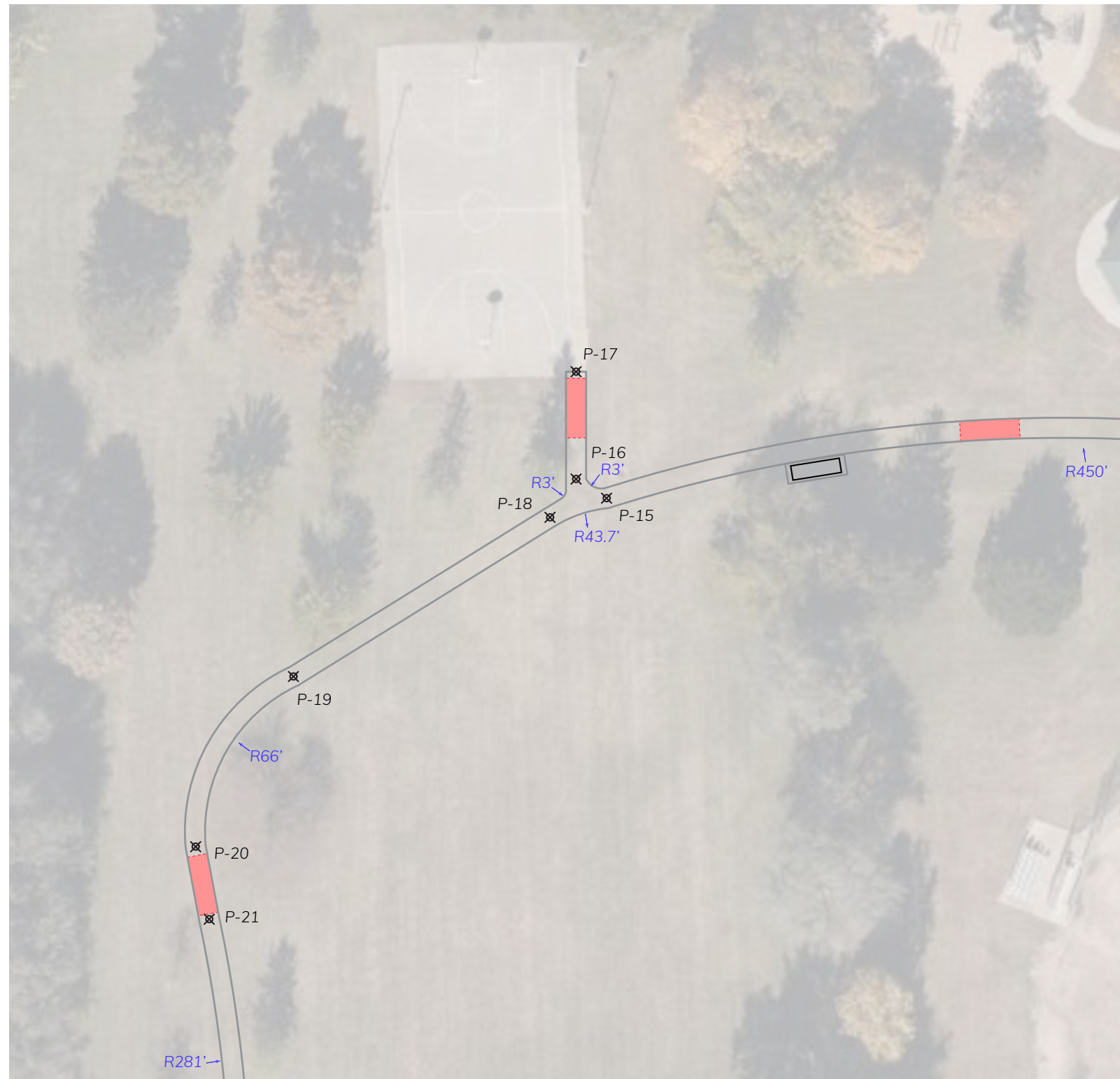

Point Table			
Point #	Raw Description	Northing	Easting
15	P-15	1634549.1771	1694294.0334
16	P-16	1634554.8924	1694284.9424
17	P-17	1634586.9118	1694284.9424
18	P-18	1634543.4628	1694277.1569
19	P-19	1634495.9799	1694200.6464
20	P-20	1634445.2096	1694171.4843
21	P-21	1634423.5776	1694175.5350

TABLOID SCALE: 1"=40'



2025 SYCAMORE WALKING PATHS LAYOUT PLAN <small>CITY ENGINEER</small> PAUL GUNZELMAN		
<small>PROJECT NUMBER</small> 482-11087	<small>MUNIS NUMBER</small> 44000425 - R5005	<small>DATE</small> 08/05/2025
<small>CITY ENGINEER'S OFFICE</small> CITY HALL - SEVENTH FLOOR 455 NORTH MAIN STREET WICHITA, KANSAS 67202-1620 (316) 268-4501		<small>SHEET</small> L-4

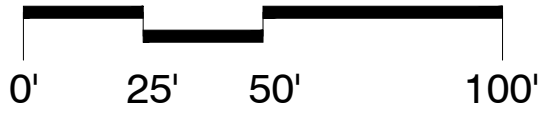
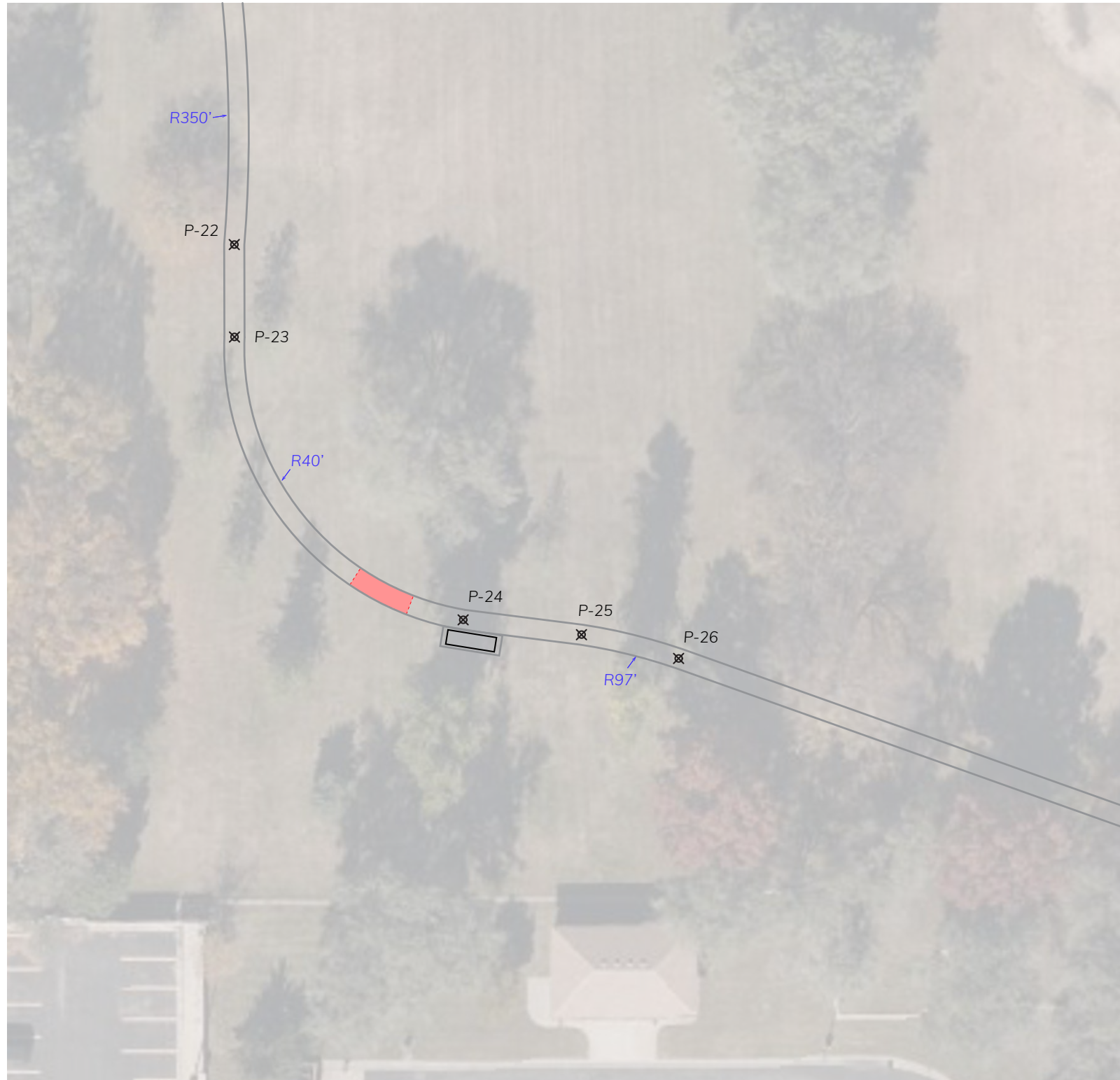

Point Table			
Point #	Raw Description	Northing	Easting
22	P-22	1634303.1417	1694183.4800
23	P-23	1634275.5846	1694183.5321
24	P-24	1634191.2678	1694251.7030
25	P-25	1634186.8414	1694286.9684
26	P-26	1634179.7468	1694315.9194

TABLOID SCALE: 1"=40'



CITY OF WICHITA
PUBLIC WORKS & UTILITIES
ENGINEERING DIVISION

2025 SYCAMORE WALKING PATHS LAYOUT PLAN
CITY ENGINEER
PAUL GUNZELMAN

PROJECT NUMBER 482-11087	MUNIS NUMBER 44000425 - R5005	DATE 08/05/2025
-----------------------------	----------------------------------	--------------------

CITY ENGINEER'S OFFICE
CITY HALL - SEVENTH FLOOR
455 NORTH MAIN STREET
WICHITA, KANSAS 67202-1620
(316) 268-4501

SHEET
L-5

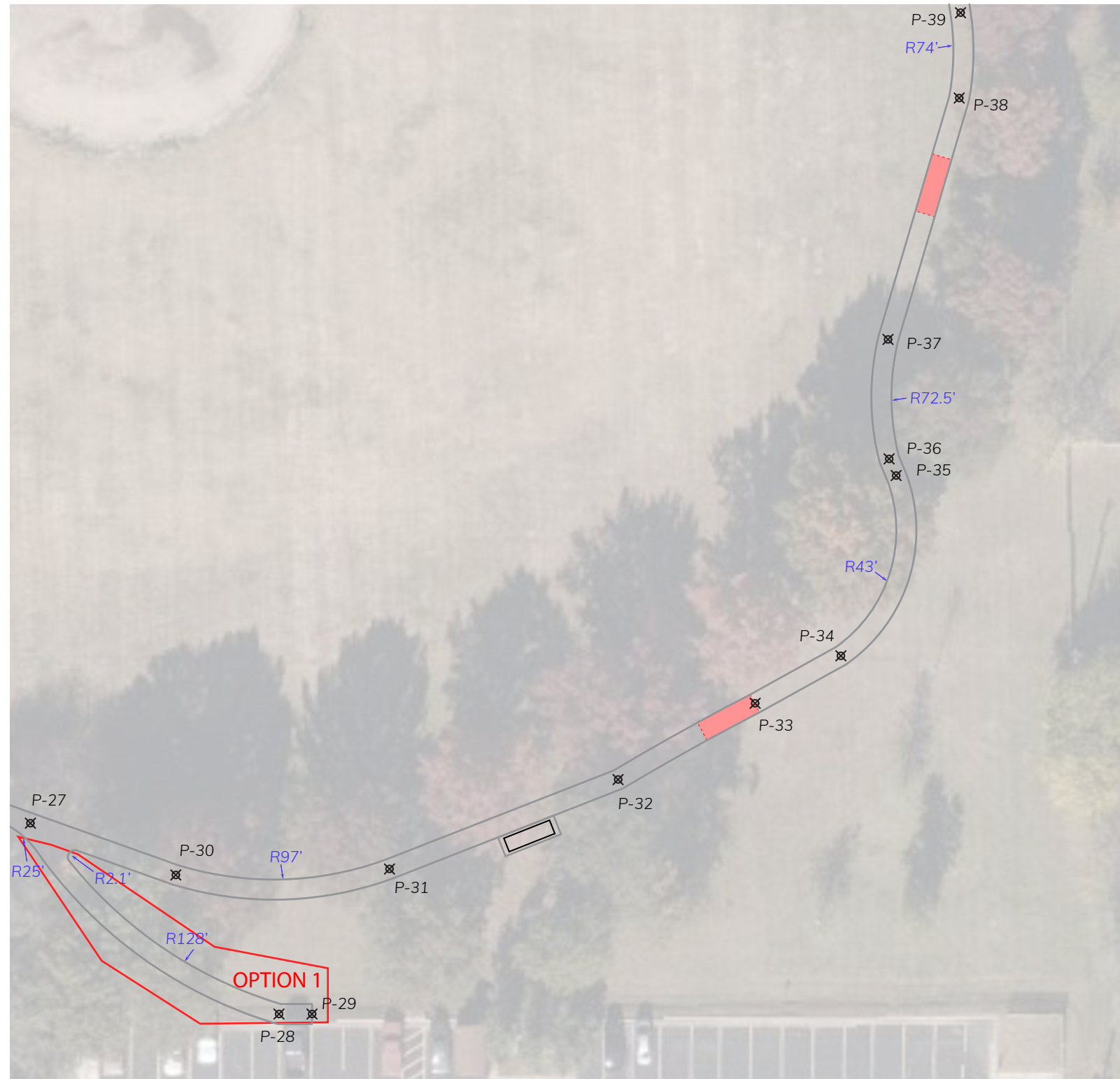



Point Table			
Point #	Raw Description	Northing	Easting
27	P-27	1634130.7228	1694453.6754
28	P-28	1634073.7770	1694527.8559
29	P-29	1634073.7770	1694537.7036
30	P-30	1634115.2814	1694497.0652
31	P-31	1634117.0660	1694560.8100
32	P-32	1634143.7671	1694629.0240
33	P-33	1634166.5156	1694669.8982
34	P-34	1634180.6826	1694695.4865
35	P-35	1634234.5072	1694711.9704
36	P-36	1634239.4688	1694709.8822
37	P-37	1634275.1235	1694709.5565
38	P-38	1634347.1664	1694730.7909
39	P-39	1634372.6265	1694731.1959

TABLOID SCALE: 1"=40'

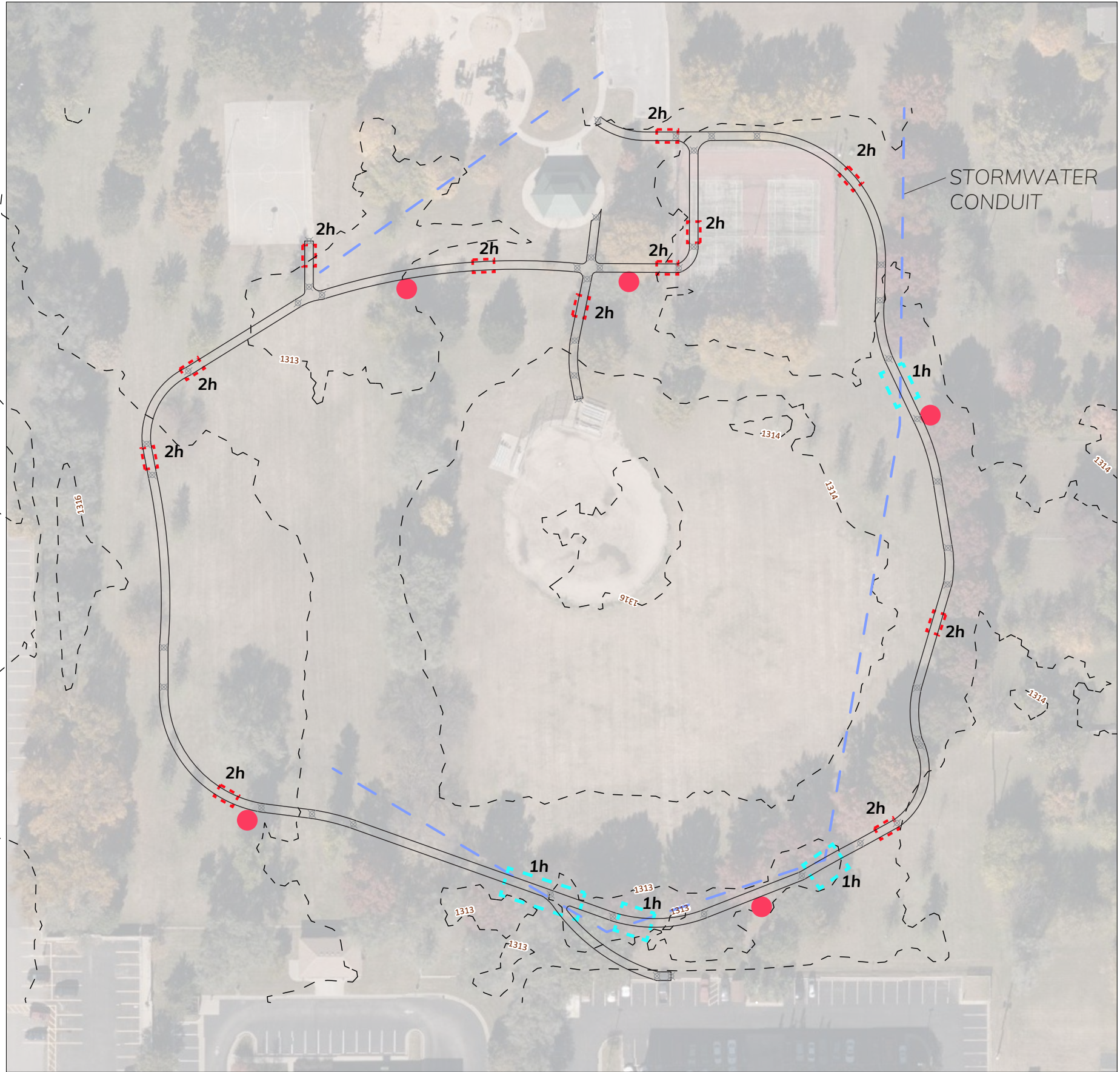

2025 SYCAMORE WALKING PATHS LAYOUT PLAN <small>CITY ENGINEER PAUL GUNZELMAN</small>		
<small>PROJECT NUMBER</small> 482-11087	<small>MUNIS NUMBER</small> 44000425 - R5005	<small>DATE</small> 08/05/2025
<small>CITY ENGINEER'S OFFICE CITY HALL - SEVENTH FLOOR 455 NORTH MAIN STREET WICHITA, KANSAS 67202-1620 (316) 268-4501</small>		<small>SHEET</small> L-6



 1h. SECTIONS TO BE HAND DUG DUE TO BEING OVER STORMWATER CONDUITS

 2h. SECTIONS OF PATH ARE TO BE COLORED DIFFERENT AND BE REINFORCED CONCRETE FOR MAINTENANCE MOWER AND TRUCK CROSSINGS. ALL INDICATED REINFORCED CONCRETE SECTIONS TO BE 6'X18' IN AREA. CROSSING LOCATIONS TO BE FIELD VERIFIED PRIOR TO CONCRETE POURING.

 LOCATIONS FOR BENCHES AND THEIR 8'X4' SUPPORTING CONCRETE PLATFORMS. FINAL LOCATIONS TO BE DETERMINED ON SITE

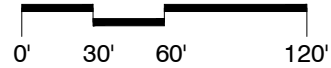

TABLOID SCALE: 1"=80'



 CITY OF WICHITA PUBLIC WORKS & UTILITIES ENGINEERING DIVISION			2025 SYCAMORE WALKING PATHS CROSSINGS PLAN	
			CITY ENGINEER PAUL GUNZELMAN	
PROJECT NUMBER 482-11087	MUNIS NUMBER 44000425 - R5005	DATE 08/05/2025	SHEET L-7	
CITY ENGINEER'S OFFICE CITY HALL - SEVENTH FLOOR 455 NORTH MAIN STREET WICHITA, KANSAS 67202-1620 (316) 268-4501				

OPTION 1: SOUTH CONNECTION

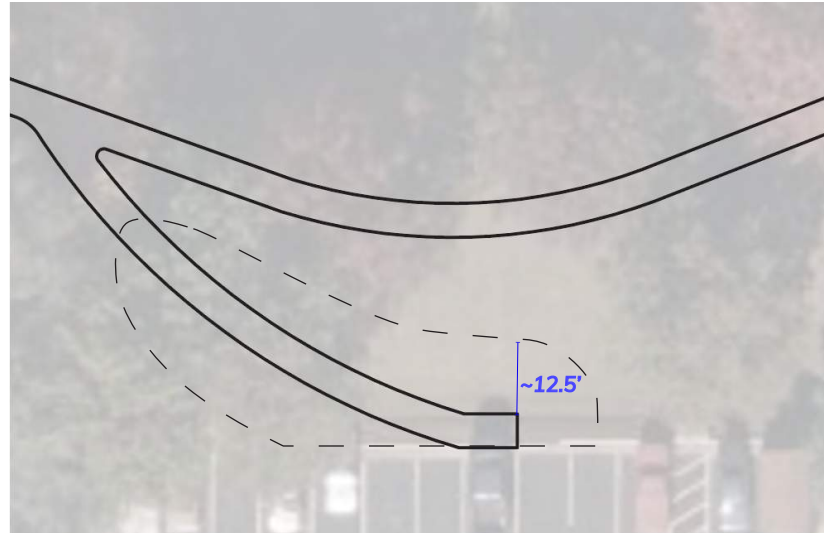

1:20 PATH WITH A 1:4 SLOPED ADJACENT EARTH, REPRESENTATION NOT TO BE USED FOR SCALE

LOCATION OF SLOPED PATH AND HOW IT CONNECTS TO THE OVERALL CIRCULATION TO BE FIELD VERIFIED.



2025 SYCAMORE WALKING PATHS OPTION 1 CITY ENGINEER PAUL GUNZELMAN		
PROJECT NUMBER	MUNIS NUMBER	DATE
482-11087	44000425 - R5005	08/05/2025
CITY ENGINEER'S OFFICE CITY HALL - SEVENTH FLOOR 455 NORTH MAIN STREET WICHITA, KANSAS 67202-1620 (316) 268-4501		SHEET L-8

TYPE 2
(Roll curb)

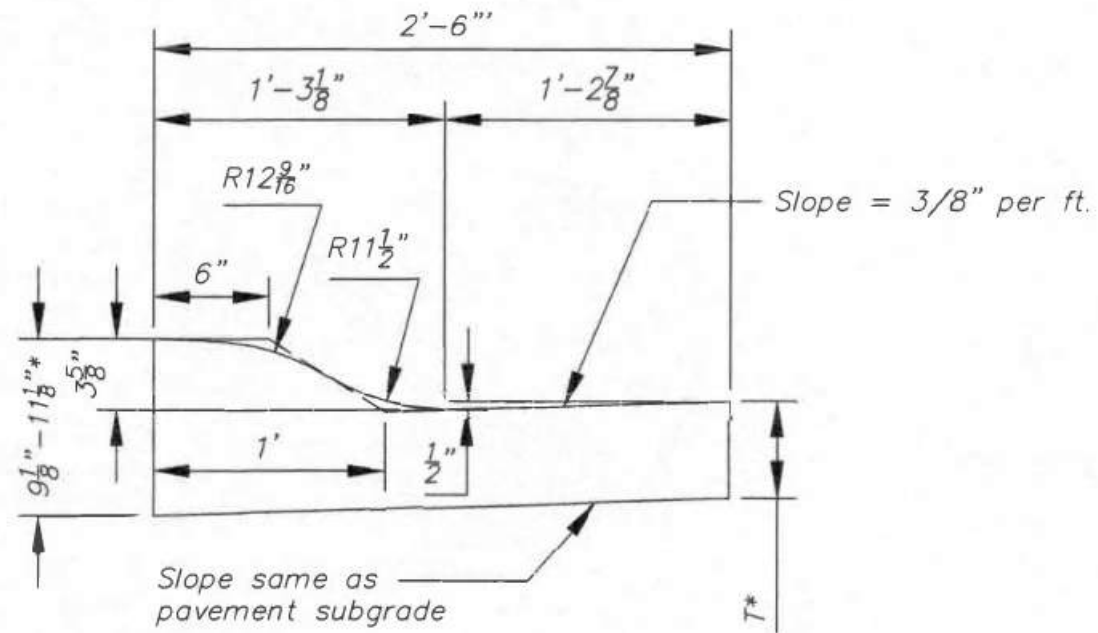

Combined Curb & Gutter (3 5/8")

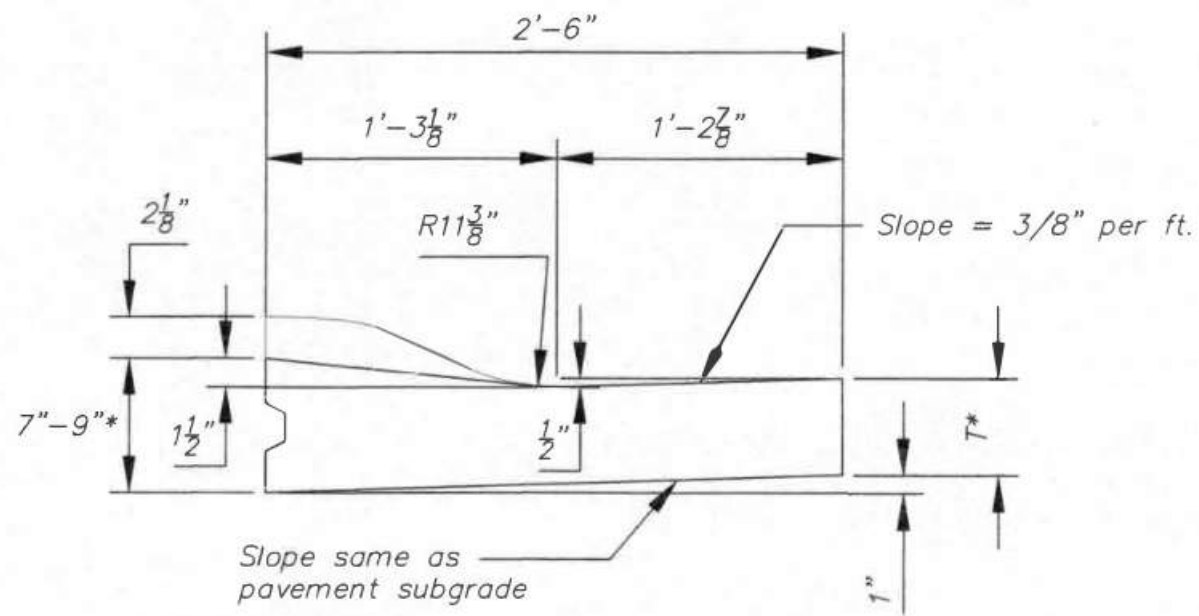

Combined Curb & Gutter (1 1/2")

GENERAL NOTES

1. Expansion (isolation) joints shall be constructed a maximum of 300' apart and at all PIs, PCs, cul-de-sac quadrants, and ends of returns.
2. Contraction joints shall be constructed a minimum of 12' apart.
3. Joint sealer shall be required at all joints on arterial and industrial streets and at intersections on residential streets.

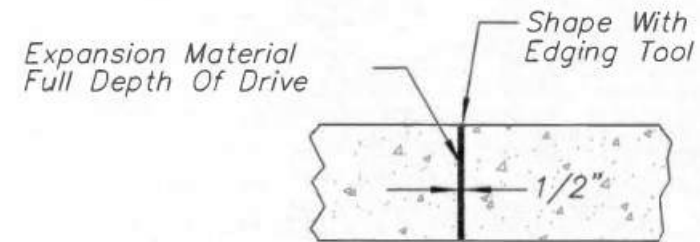

EXPANSION JOINT (E.J.)

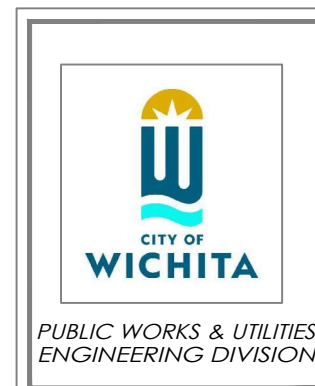

2025 SYCAMORE WALKING PATHS CURB DETAILS		
CITY ENGINEER PAUL GUNZELMAN		
PROJECT NUMBER 482-11087	MUNIS NUMBER 44000425 - R5005	DATE 08/05/2025
CITY ENGINEER'S OFFICE CITY HALL - SEVENTH FLOOR 455 NORTH MAIN STREET WICHITA, KANSAS 67202-1620 (316) 268-4501		SHEET L-9