

PLOTTED: Friday, August 01, 2025 @ 11:07AM

J:\PROJECTS\2023\230431_COW_WDC_BRIDGE REPLACEMENT AT 15TH STREET\00_230431_CAD\SHETS\10_BLDG MEP/ELECTRICAL BRIDGE PLAN.DWG

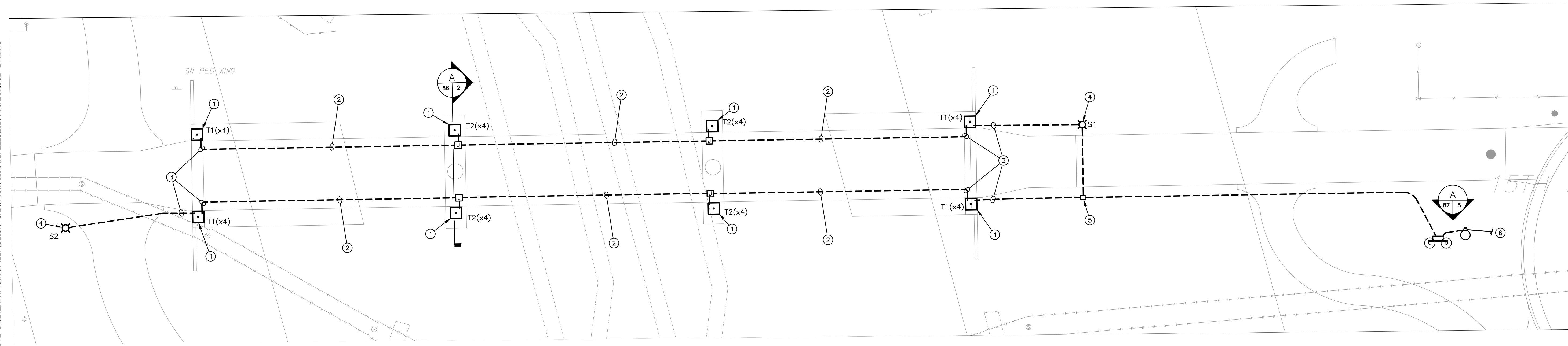

ELECTRICAL BRIDGE PLAN
 SCALE: 1"=10'
 0 10 20



- KEYED NOTES**
1. LIGHT TOWER, SEE DETAIL 1 ON SHEET 86.
 2. 3/4" FIBERGLASS CONDUIT MOUNTED UNDER BRIDGE. USE SLEEVES AT SUPPORTS AND COUPLER TRANSITION TO PVC CONDUIT IN CONCRETE AT ABUTMENT. FIBERGLASS CONDUIT TO BE EQUAL TO CHAMPION XW (EXTRA HEAVY WALL) EPOXY FIBERGLASS CONDUIT.
 3. 3/4" PVC CONDUIT MOUNTED WITHIN CONCRETE AND BELOW GRADE.
 4. POLE MOUNTED LIGHT FIXTURE. INSTALL BLACK 12'-0" STERNBERG #4SW-ML900-12FT-.88-VD BKT POLE AND POLE BASE PER DETAIL 1 ON SHEET 87. PROVIDE POLE WITH BASE COVER AND VIBRATION DAMPENER.
 5. QUAZITE SPLICE/PULL BOX MOUNTED IN GRADE.
 6. OVERHEAD FEED TO UTILITY TRANSFORMER. COORDINATE ALL REQUIREMENTS WITH EVERGY.



IMPROVEMENT PLANS FOR
15TH STREET BRIDGE OVER THE WICHITA DRAINAGE CANAL
 WICHITA, KS

ELECTRICAL BRIDGE PLAN

PROJECT NO.
472-2023-085864

SCALE
AS NOTED

DRAWN	DESIGNED	CHECKED
NAS	SW	SW

NO.	REVISION	DATE

SHEET NO.
85 OF 114

©2025 MKEC ENGINEERING, INC. ALL RIGHTS RESERVED WWW.MKEC.COM THESE DRAWINGS AND THEIR CONTENTS, INCLUDING, BUT NOT LIMITED TO, ALL CONCEPTS, DESIGNS, & DETAILS ARE THE EXCLUSIVE PROPERTY OF MKEC ENGINEERING, INC. (MKEC), AND MAY NOT BE USED OR REPRODUCED IN ANY WAY WITHOUT THE EXPRESS CONSENT OF MKEC.