

B.M. 158.48 'R' in Ritchie S.Curb Grail  
W.L. Annamae Garvie Addn.

B.M. 165.03 'R' in Ritchie Top N.W. Rad.  
Rosalie & Zimmerly

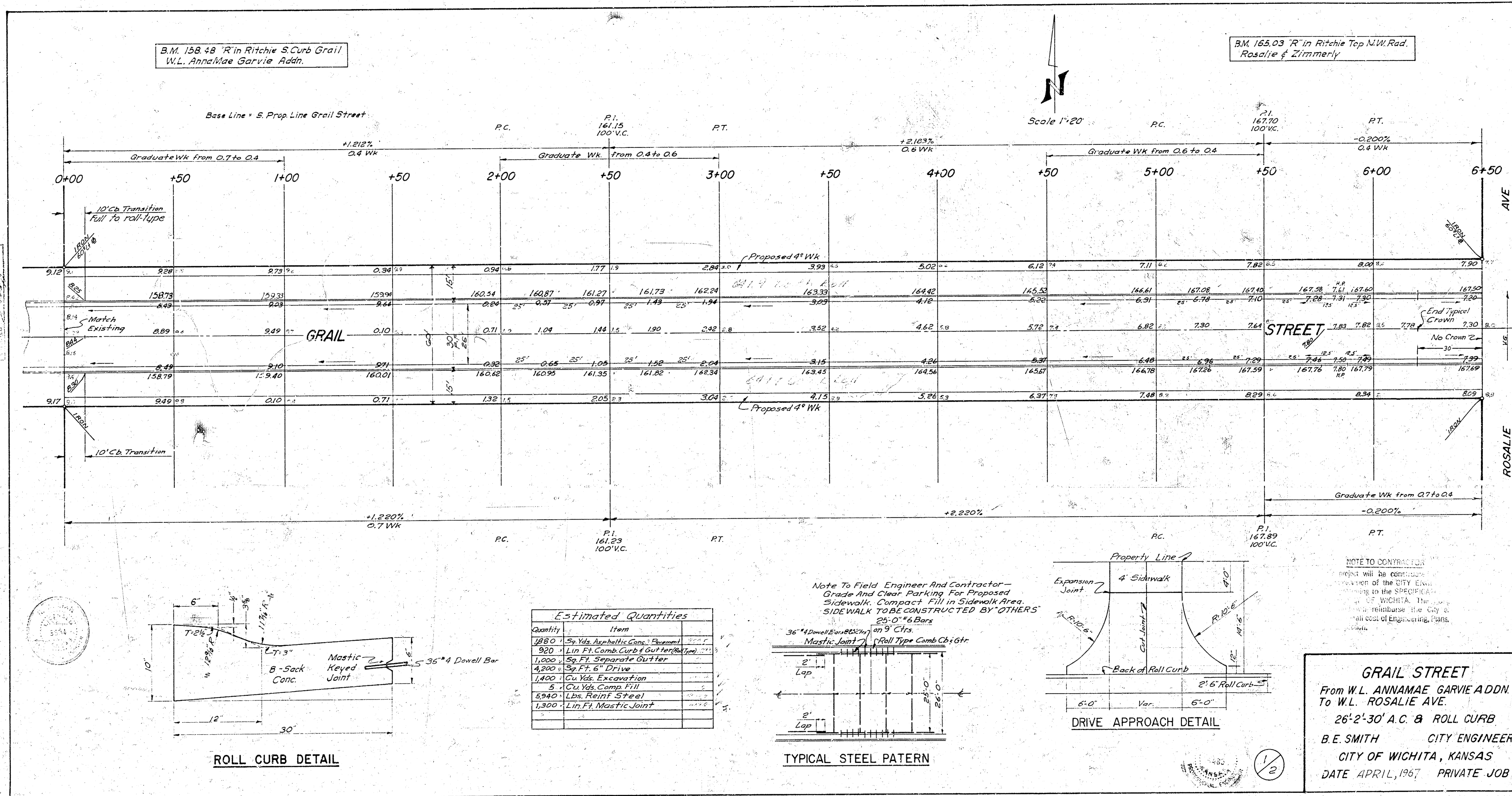

158.48  
 158.79  
 159.40  
 160.01  
 160.62  
 160.95  
 161.35  
 161.82  
 162.34  
 162.84  
 163.33  
 163.81  
 164.28  
 164.74  
 165.19  
 165.63  
 166.06  
 166.48  
 166.89  
 167.29  
 167.68  
 168.06  
 168.43  
 168.79  
 169.14  
 169.48  
 169.81  
 170.13  
 170.44  
 170.74  
 171.03  
 171.31  
 171.58  
 171.84  
 172.09  
 172.33  
 172.56  
 172.78  
 173.00  
 173.21  
 173.41  
 173.60  
 173.78  
 173.95  
 174.11  
 174.26  
 174.40  
 174.53  
 174.65  
 174.76  
 174.86  
 174.95  
 175.03  
 175.10  
 175.16  
 175.21  
 175.25  
 175.28  
 175.30  
 175.31  
 175.31  
 175.30  
 175.28  
 175.25  
 175.21  
 175.16  
 175.10  
 175.03  
 174.95  
 174.86  
 174.76  
 174.65  
 174.53  
 174.40  
 174.26  
 174.11  
 173.95  
 173.78  
 173.60  
 173.41  
 173.21  
 173.00  
 172.78  
 172.56  
 172.33  
 172.09  
 171.84  
 171.58  
 171.31  
 171.03  
 170.74  
 170.44  
 170.13  
 169.81  
 169.48  
 169.14  
 168.79  
 168.43  
 168.06  
 167.68  
 167.29  
 166.89  
 166.48  
 166.06  
 165.63  
 165.19  
 164.74  
 164.28  
 163.81  
 163.33  
 162.84  
 162.34  
 161.82  
 161.35  
 160.95  
 160.62  
 160.34  
 160.01  
 159.79  
 159.40  
 158.79  
 158.48

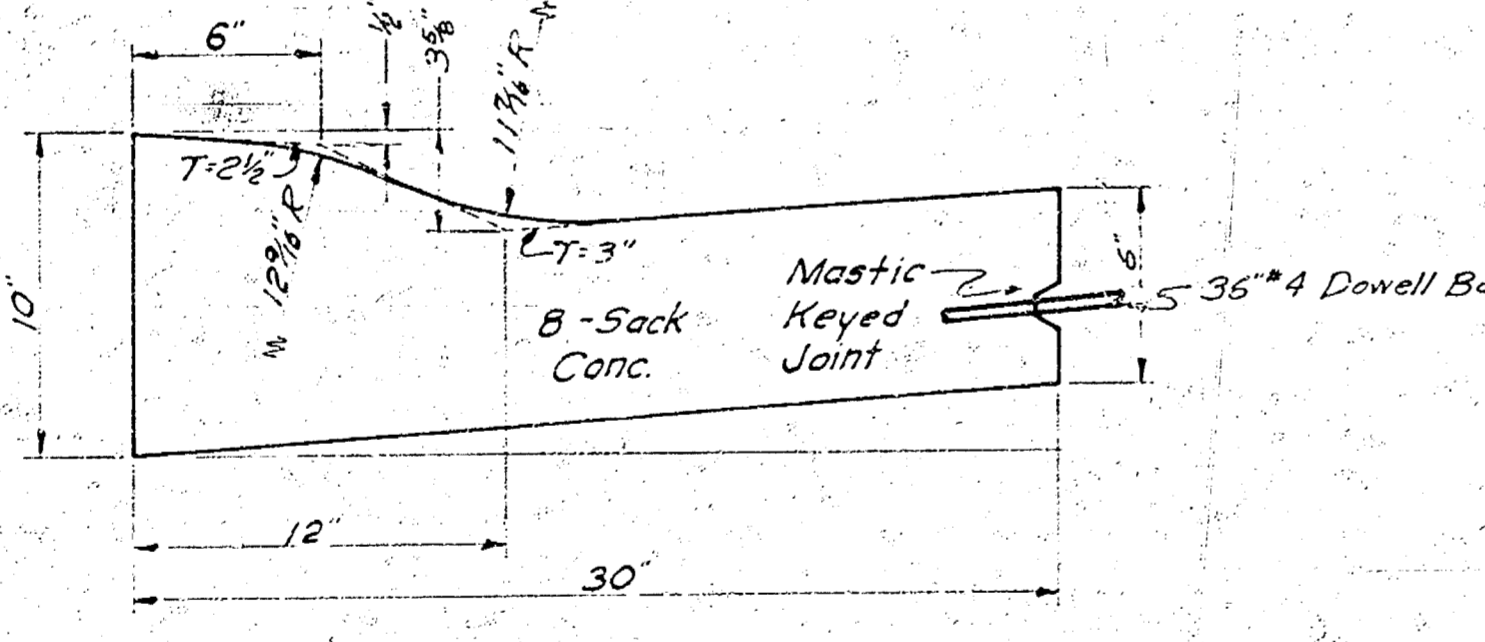

ROLL CURB DETAIL

Estimated Quantities	
Quantity	Item
1880	Sq. Yds. Asphaltic Conc. Pavement
920	Lin. Ft. Comb. Curb & Gutter (Total)
1,000	Sq. Ft. Separate Gutter
4,200	Sq. Ft. 6" Drive
1,400	Cu. Yds. Excavation
5	Cu. Yds. Comp. Fill
6,940	Lbs. Reinf. Steel
1,300	Lin. Ft. Mastic Joint

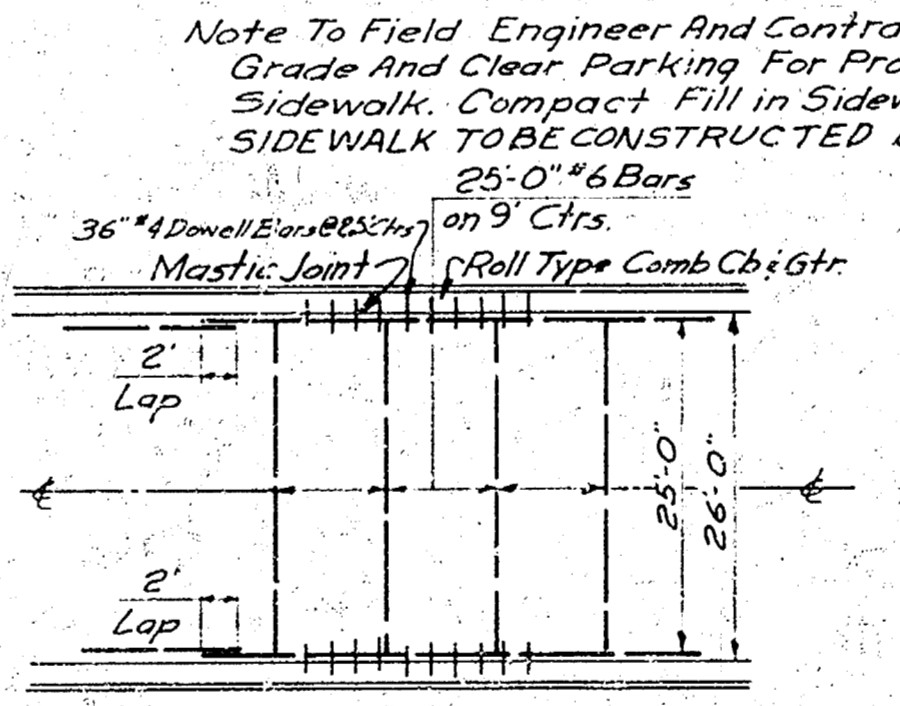

TYPICAL STEEL PATTERN

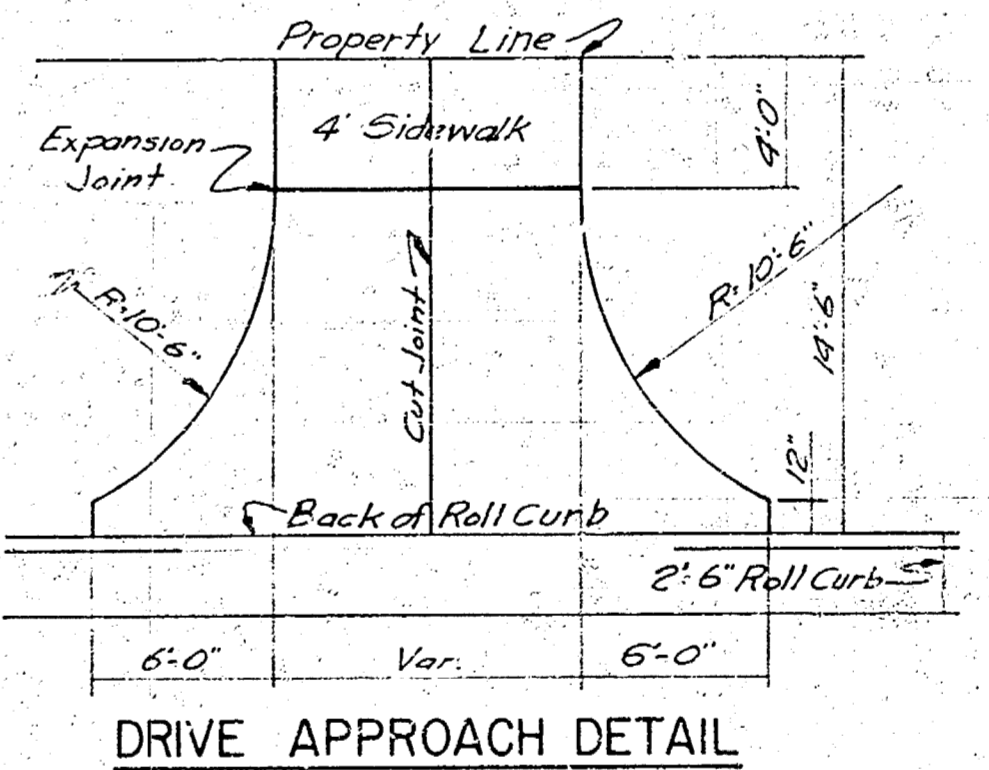

DRIVE APPROACH DETAIL

NOTE TO CONTRACTOR  
 Project will be constructed  
 in accordance with the  
 specifications of the CITY ENGINEER  
 and the SPECIFICATIONS  
 of the CITY OF WICHITA. The  
 contractor shall reimburse the City of  
 Wichita for all cost of Engineering, Plans,  
 etc.

**GRAIL STREET**  
 From W.L. ANNAMAE GARVIE ADDN.  
 To W.L. ROSALIE AVE.  
 26'-2'-30" A.C. & ROLL CURB  
 B.E. SMITH CITY ENGINEER  
 CITY OF WICHITA, KANSAS  
 DATE APRIL, 1967 PRIVATE JOB

1/2