

B. M. 104.50 S.W. cor. conc. Po Ho NE cor. Figg & Handley.
 B. M. 103.68 S.W. cor. conc. Po Ho SE cor. Handley & Dooley
 Base line & Sta. on \pm 30' R/W, chain N.

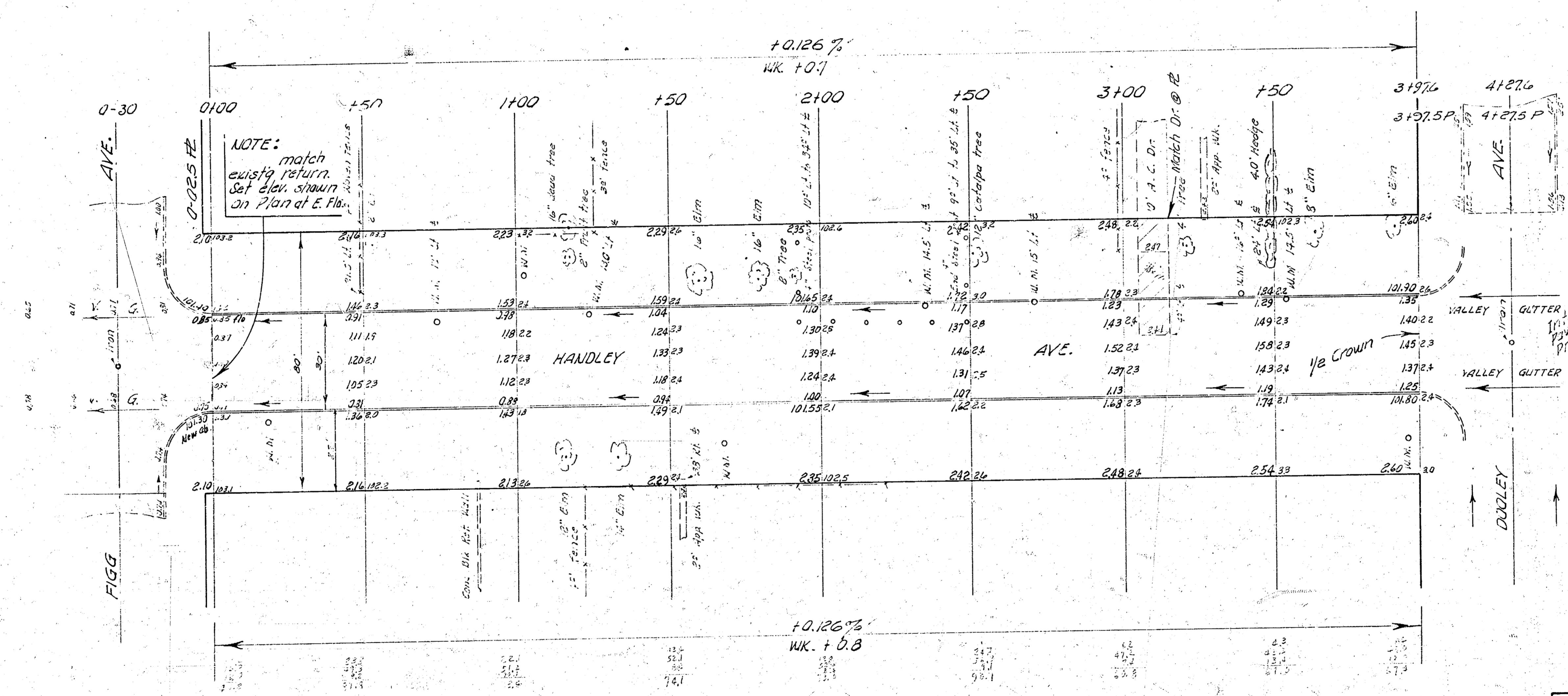
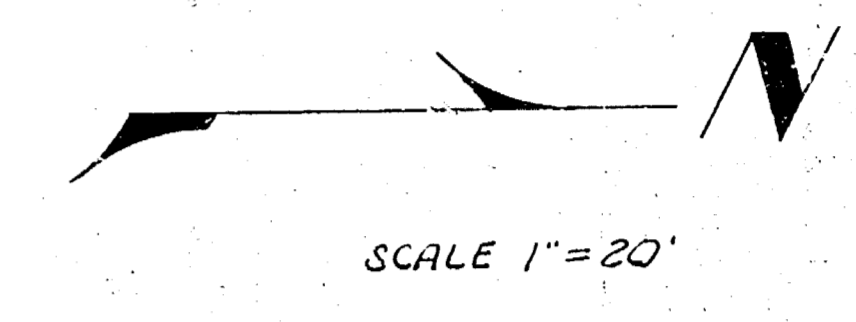

EARTHWORK
Excavation

CITY	PROP.
2.0	1,065.8
+10%	106.6
	<u>1,172.4</u> Cu. Yds.

HANDLEY AVE.
 SL DOOLEY TO SL FIGG
 30' CONC. & CB
 CITY OF WICHITA, KANSAS
 B. E. SMITH CITY ENGINEER
 APRIL 1939 PROJ. NO. C13-163

