

B.M. 102.62 SE cor. conc. Wk. S.S. Bldg. NE cor. Dooley & Walnut
 B.M. 103.63 SW cor. conc. Po. Ho. SE cor. Handley & Dooley.
 B.M. 102.95 NE cor. conc. slab in E. door brick Bldg. S.W. cor. Handley & Walker.
 Sta. of base line on E 80' R.T. way, chain A.

SCALE 1" = 20'

NOTE:
 Take ties to existing iron and replace same.

NOTE: Intersection to be paved on Walker project. No city elevations when constructing this project.

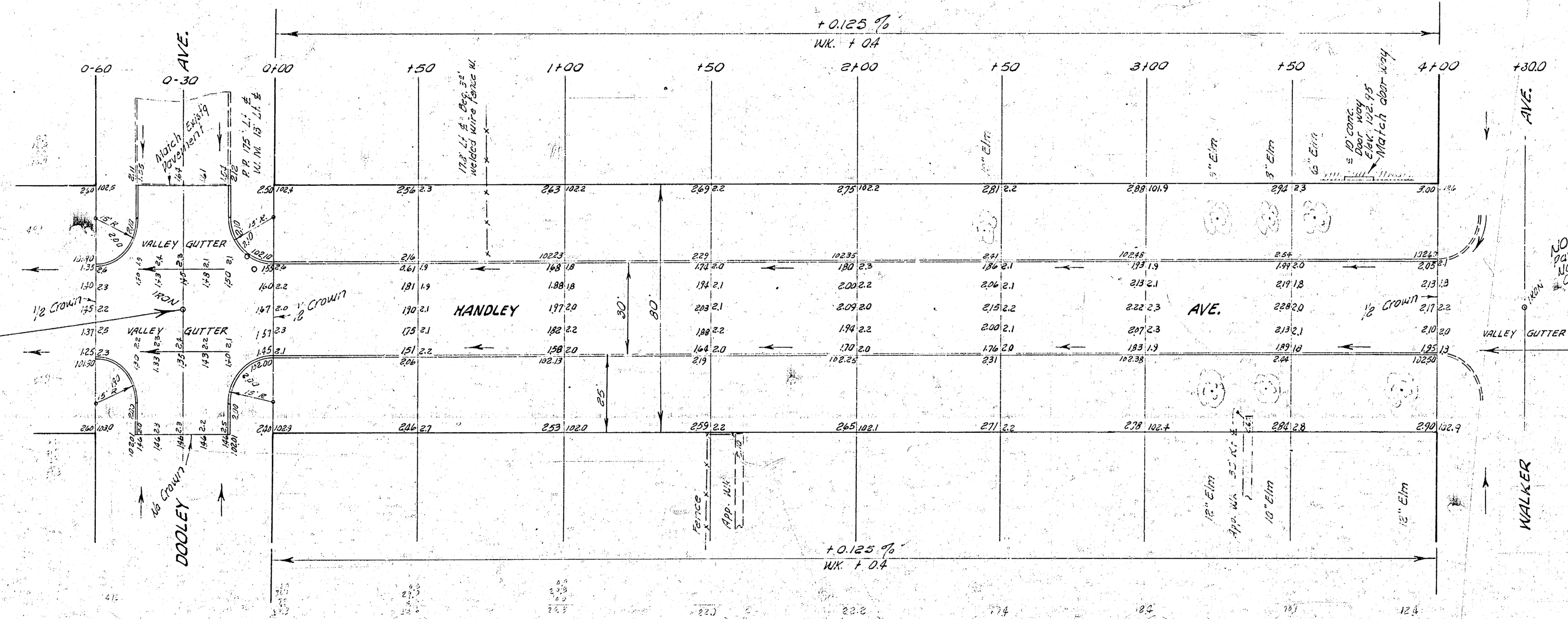

| EARTH WORK | |
|----------------|----------------|
| Excavation | |
| CITY | PROP. |
| 170.1 | 330.7 |
| 17.0 | 33.1 |
| 187.1 cu. yds. | 363.8 cu. yds. |

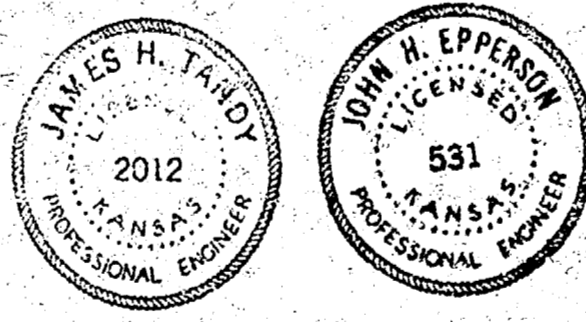

HANDLEY AVE.
 SL DOOLEY TO SL WALKER
 30' CONC. & CB.
 CITY OF WICHITA, KANSAS
 B. E. SMITH CITY ENGINEER
 APRIL 1959, PROJ. NO C18-144

10 2 5 13 11