

CURVE DATA
 $\Delta = 9^{\circ}05'52''$
 $T = 37.75'$
 $R = 471.75'$
 $L = 75.34'$
 $LC = 75.34'$
 Defl. per ft. of Curve = 30.41 mins.

$\Delta = 9^{\circ}05'52''$ $T = 37.75'$ $R = 471.75'$ $L = 75.34'$ $LC = 75.34'$

ST.	ARC.	CH.	OFF.	DEFLECTION	REFLECTION
27+55	P.C.	-	-	0'-00'-00"	0'-00'-00"
30+00	45.5'	42.27'	-	1'-45'-07"	1'-46'-41"
30+30	29.82'	30.25'	-	1'-33'-53"	1'-35'-05"
30+50	20.34'	20.00'	-	1'-14'-01"	1'-14'-01"
31+00	49.98'	47.13'	-	3'-02'-02"	4'-16'-13"
P.T.	31+05	05.0'	04.92'	0'-18'-13"	4'-34'-22"

HARRY STREET (NS) 8" Concrete Widening
 DAKM 571021

$\Delta = 9^{\circ}08'52''$ $R = 471.75'$ $T = 37.55'$ $L = 75.34'$ $LC = 75.24'$

CURVE DATA BASED ON C.B. CURVES RAD. $\Delta = 9^{\circ}08'52''$					
STA	ARC	CHORD	DEFLECTION	TOTAL DEFLECTION	TOTAL CHORD
21+07.81	PC	-	-	0'-00'-00"	0'-00'-00"
21+80	42.69'	41.97'	-	2'-45'-33"	2'-35'-33"
22+00	32.63'	32.06'	-	1'-38'-73"	1'-38'-73"
22+160	18.03'	18.34'	-	1'-05'-48"	1'-05'-48"
22+50	49.98'	50.83'	-	3'-02'-02"	4'-07'-48"
PT. 22+57.31	07.31'	07.49'	-	0'-26'-18"	4'-34'-22"

CURVE DATA

$\Delta = 9^{\circ}08'52''$
 $L = 57.5'$
 $R = 471.75'$
 $L = 75.34'$
 $LC = 75.24'$
 Defl. per ft. curve = 3.43 G/mhs.

BM. 151.936 "x" cut on S. Rim K.G.E. Manhole - 13' So. of St. Harry St.
 @ W.L. Bluffview Dr. R.

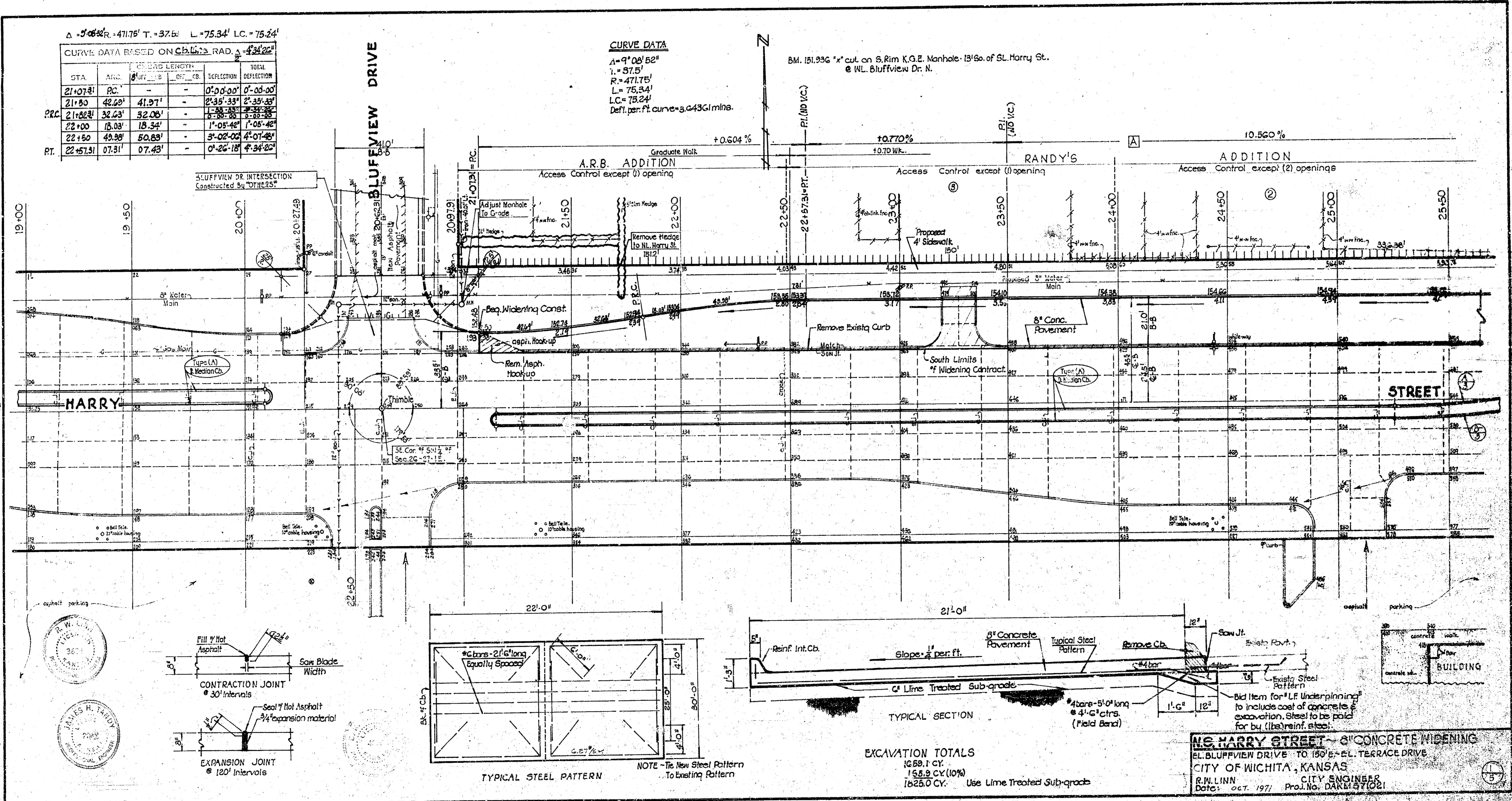

Survey Clontz
Plan Book
Checked

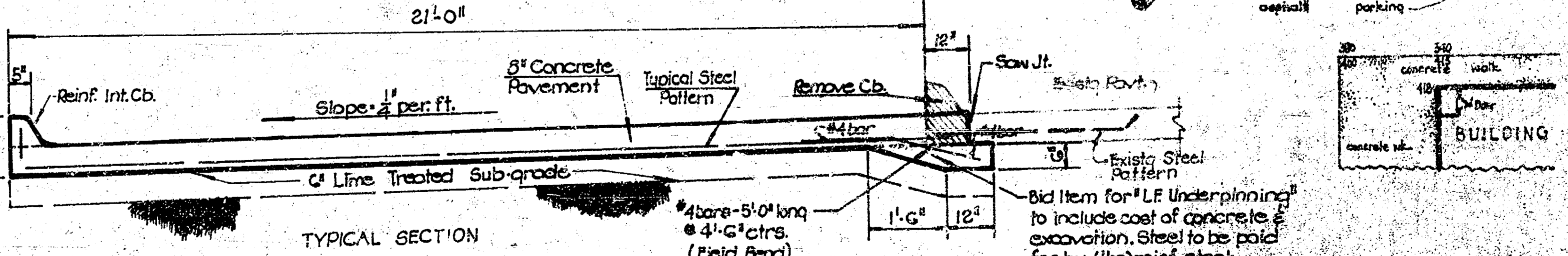
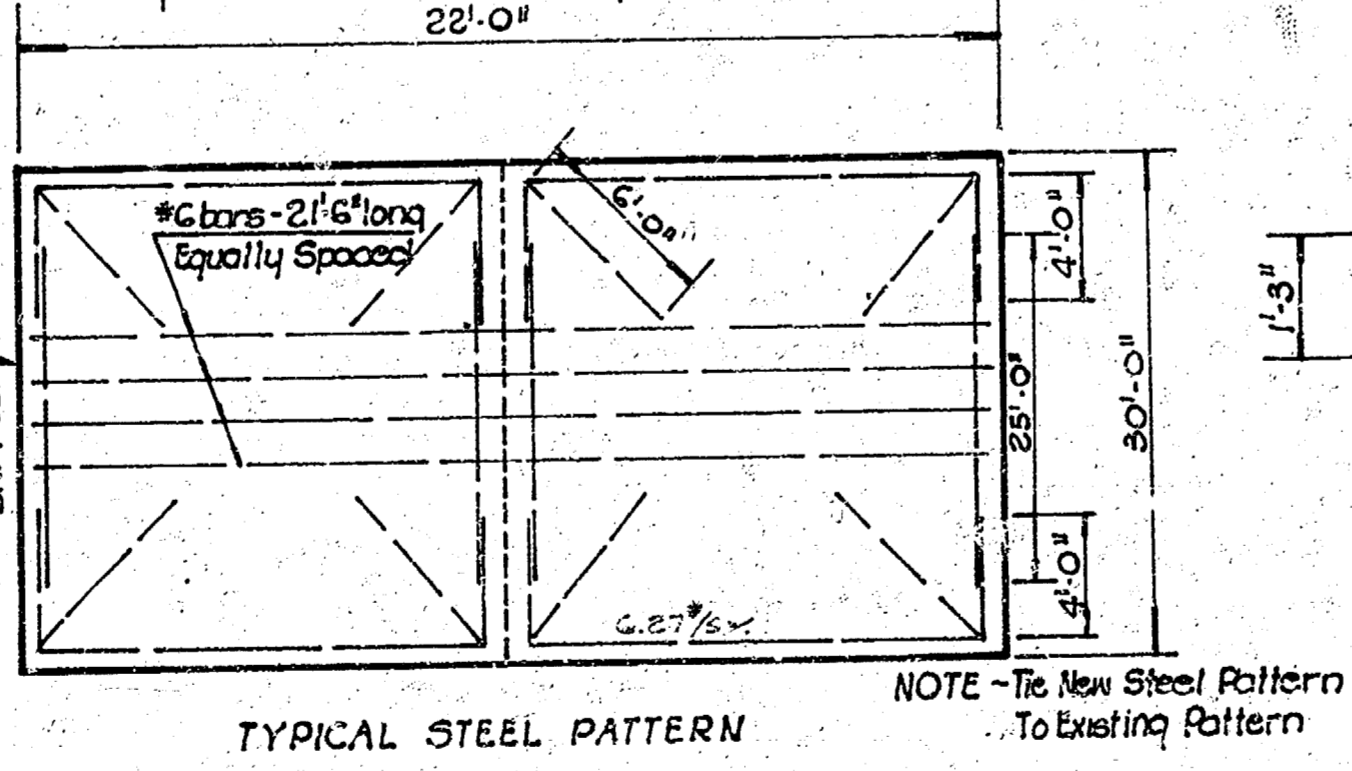
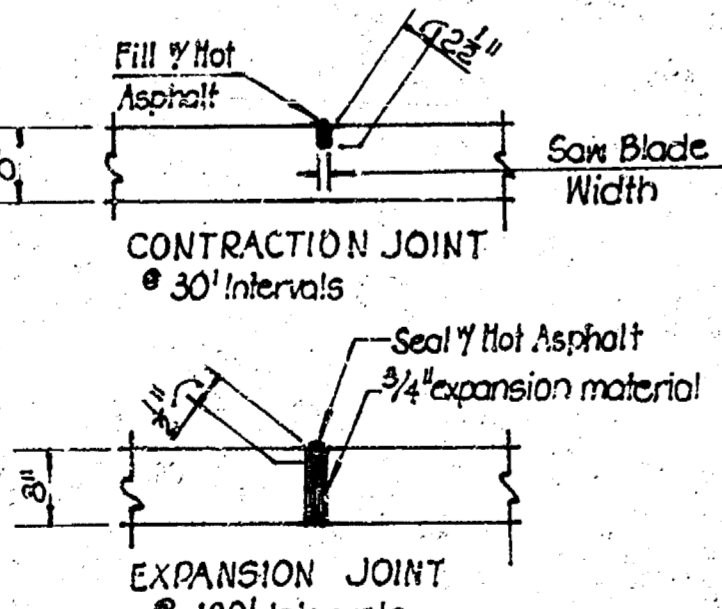
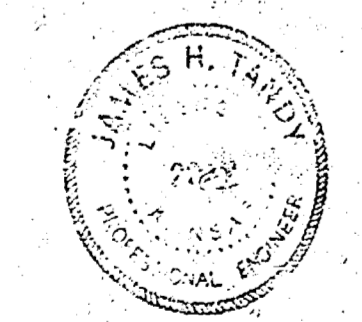

EXCAVATION TOTALS
 1689.1 cy.
 155.2 cy. (10%)
 1844.3 cy. Use Lime Treated Sub-grade

NE HARRY STREET - 8" CONCRETE WIDENING
 EL. BLUFFVIEW DRIVE TO 150' E. EL. TERRACE DRIVE
 CITY OF WICHITA, KANSAS
 R.W. LINN CITY ENGINEER
 Date: OCT. 1977 Proj. No. DAKM 37021