

Surveying
 with
 Engineer
 Checked

NOTE: CONTRACTOR TO CLEAR RIGHT-OF-WAY, GRADE PARKING, AND COMPACT FILL IN SIDEWALK AREAS. SIGNALS TO BE CONSTRUCTED BY OTHERS.
 NOTE: FIELD ENGINEER TO DETERMINE WHICH PORTIONS ARE TO HAVE LIME TREATED SUBGRADE AND WHICH PORTIONS ARE TO BE SUBGRADE MODIFIED.
 NOTE: ALL EXCESS EXCAVATED MATERIAL FROM THIS PROJECT IS TO BE STOCKPILED AT LOCATIONS DETERMINED BY THE ENGINEER IN WESTLINK VILLAGE TENTH ADDN.

B. M. 168.69 "A" TOP CB. E. SIDE CHIPPER LANE @ N. L. HARVEST LANE.

SCALE: 1"=20'

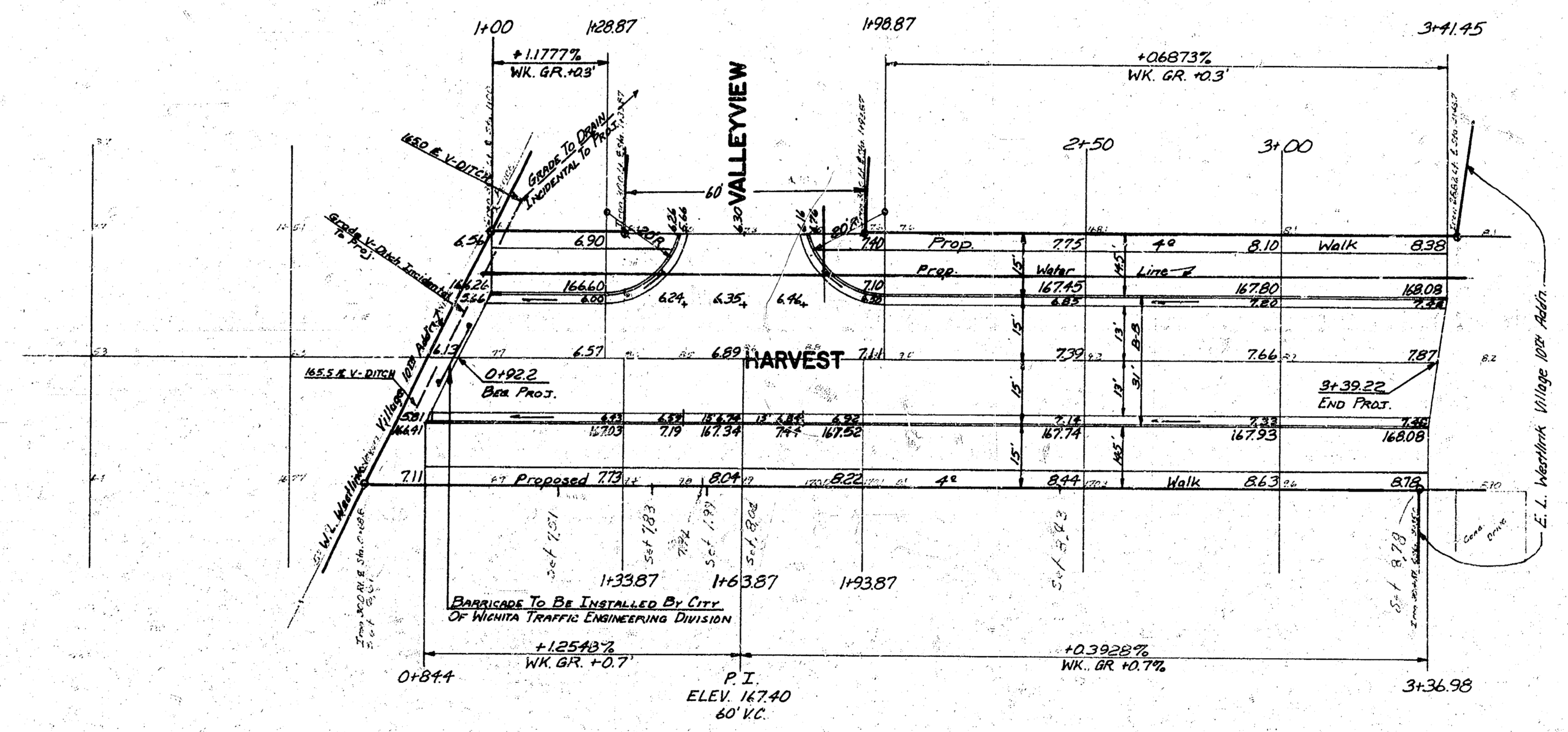

Note to Field Engineer: The flow elevation of the existing combination curb and gutter at ca. 3+41.45 and Sta. 3+36.98 must be verified prior to staking this project.

PROPERTY	EARTHWORK	CITY
EXCAVATION = 784.2 CU YDS.	EXCAVATION = 125.8 CU YDS.	
+10% = 784.2 CU YDS.	+10% = 125.8 CU YDS.	
TOTAL = 862.6 CU YDS.	TOTAL = 138.4 CU YDS.	

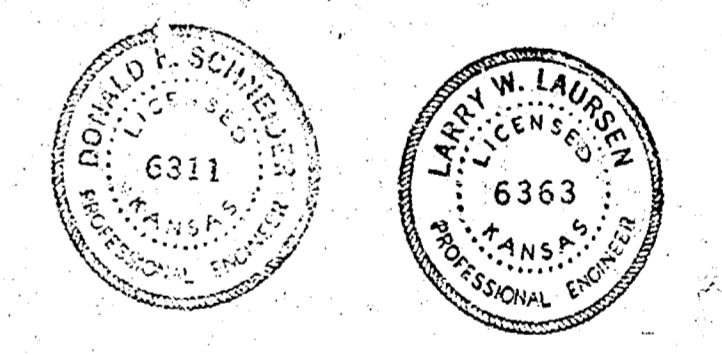

HARVEST
 W. L. WESTLINK VILLAGE 10TH ADDN.
 TO
 E. L. WESTLINK VILLAGE 10TH ADDN.
 ASPHALTIC CONCRETE PAVEMENT
 3' B-B WITH COMB. CB. & GTR.
 CITY OF WICHITA, KANSAS
 R. W. LINN CITY ENGINEER
 PROJ. NO. DAKS 572037
 DATE: MAR. 1973