

B.M. 100.62 N.W. cor. conc. perch no. 2547 Heufft.

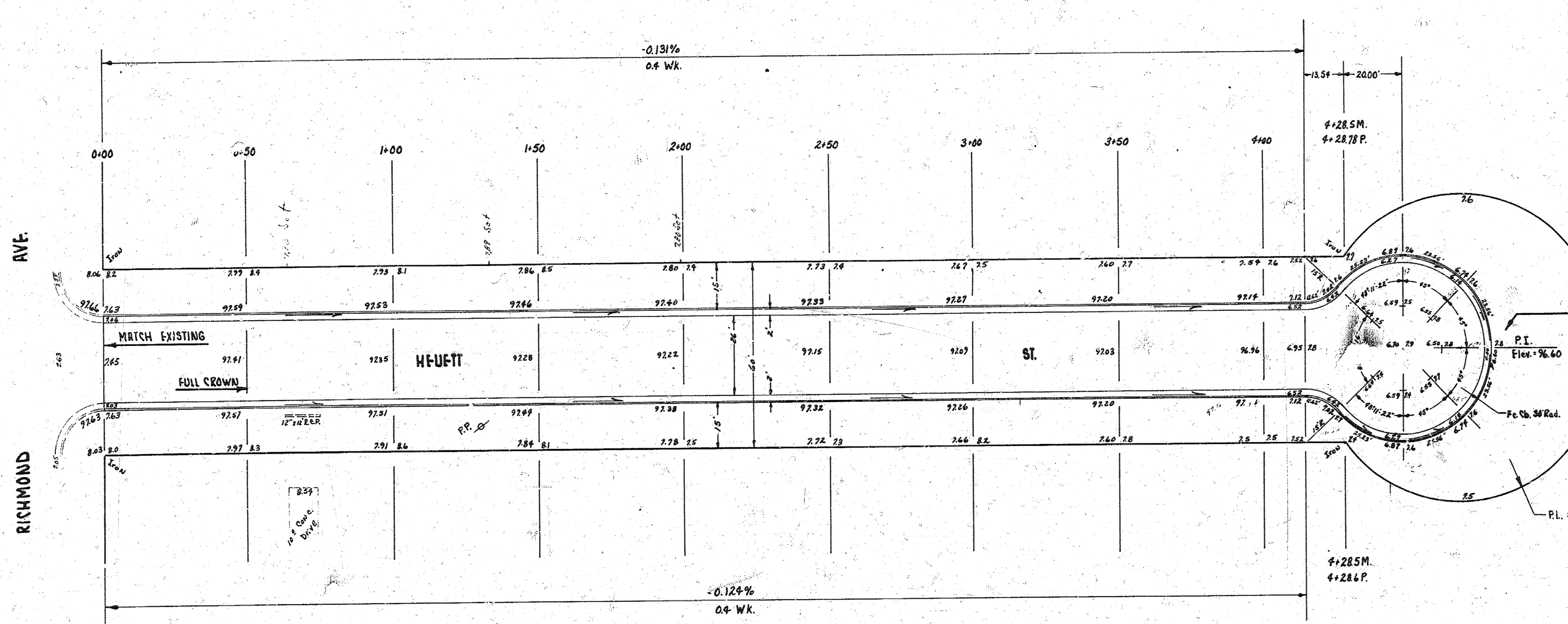

NOTE:
 Leave 5 foot opening in curb
 for drainage east to ditch.
 Concrete rip-rap ditching to be
 incidental to project.

NOTE:
 Grade parking @
 cul-de-sac to
 match property line.

PROPERTY EARTHWORK TOTALS

992.1 Cu Yds. Cut
 10% 92.5
 1094.6 Cu Yds. Cut
 +- Cu Yds. Fill



HEUETT ST.
 E.L. RICHMOND to E.L. BLKS. 9 & 10
 SW VILLAGE 3RD.
 26-2-30 AC.
CITY OF WICHITA, KANSAS
 B.E. SMITH CITY ENGINEER
 DATE: APRIL 1959, PROJ. NO. C18-74

1
2

Surveyed under 9781, I.A. 99
 City of Wichita, Kansas
 License No. 436
 Date: April 1959