

B.M. STD. MERIDIAN & MAY, 6' NO. & 2'E. OF S.E. COR. ELEV. 104.85
 T.P. R.R. SPIKE E.S. PP. E.S. MERIDIAN & S.L. JEWELL ELEV. 104.275

NOTE
 TWO 12" R.C.P. 50' LONG, TO BE INSTALLED
 IN DITCH ON MERIDIAN & A DIRT &
 SAND HOOKUP WILL BE CONSTR.

AVE

0+450

0+465

0+477

0+0

0+150

1+0

1+50

2+0

2+50

3+0

3+50

4+0

4+50

5+0

5+50

6+0

0+0

ST. CLAIR AVE

EL. MERIDIAN
 39
 38
 35
 34
 33
 32
 31

MERIDIAN

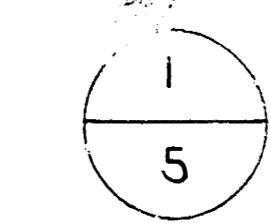
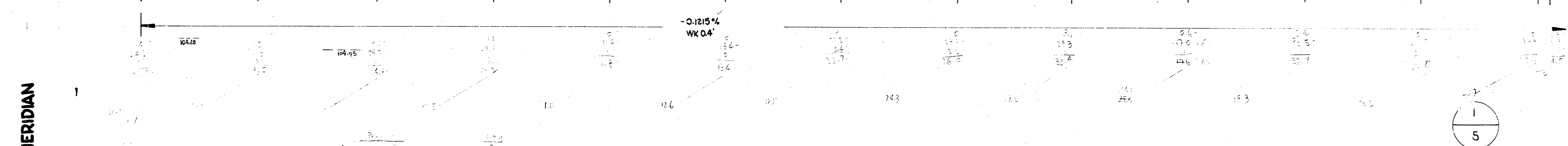
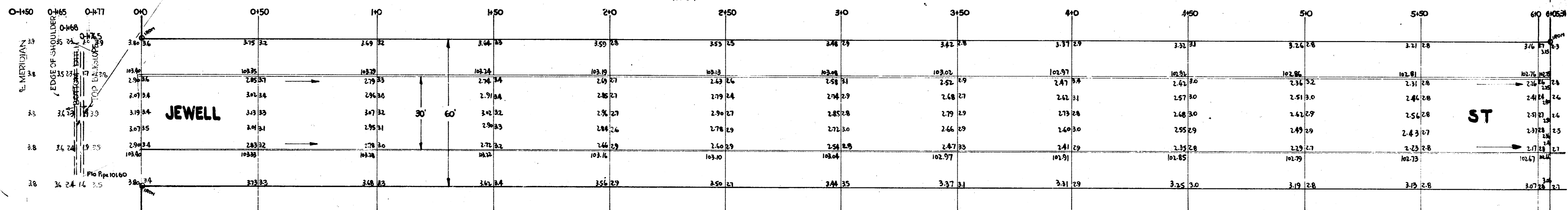

JEWELL TO **ST.**
 EL. MERIDIAN TO EL. VINE
30' CONC. & CURB
CITY OF WICHITA, KANSAS
 B.E. SMITH CITY ENGINEER
 JULY 1955 PROJ. NO. C13-301

TP NE COR CONC PORCH HD ON NW COR JEWELL & EVERETT ELEV. 104.265

TP SE COR CONC PORCH HD #2065 BONN ELEV. 104.70

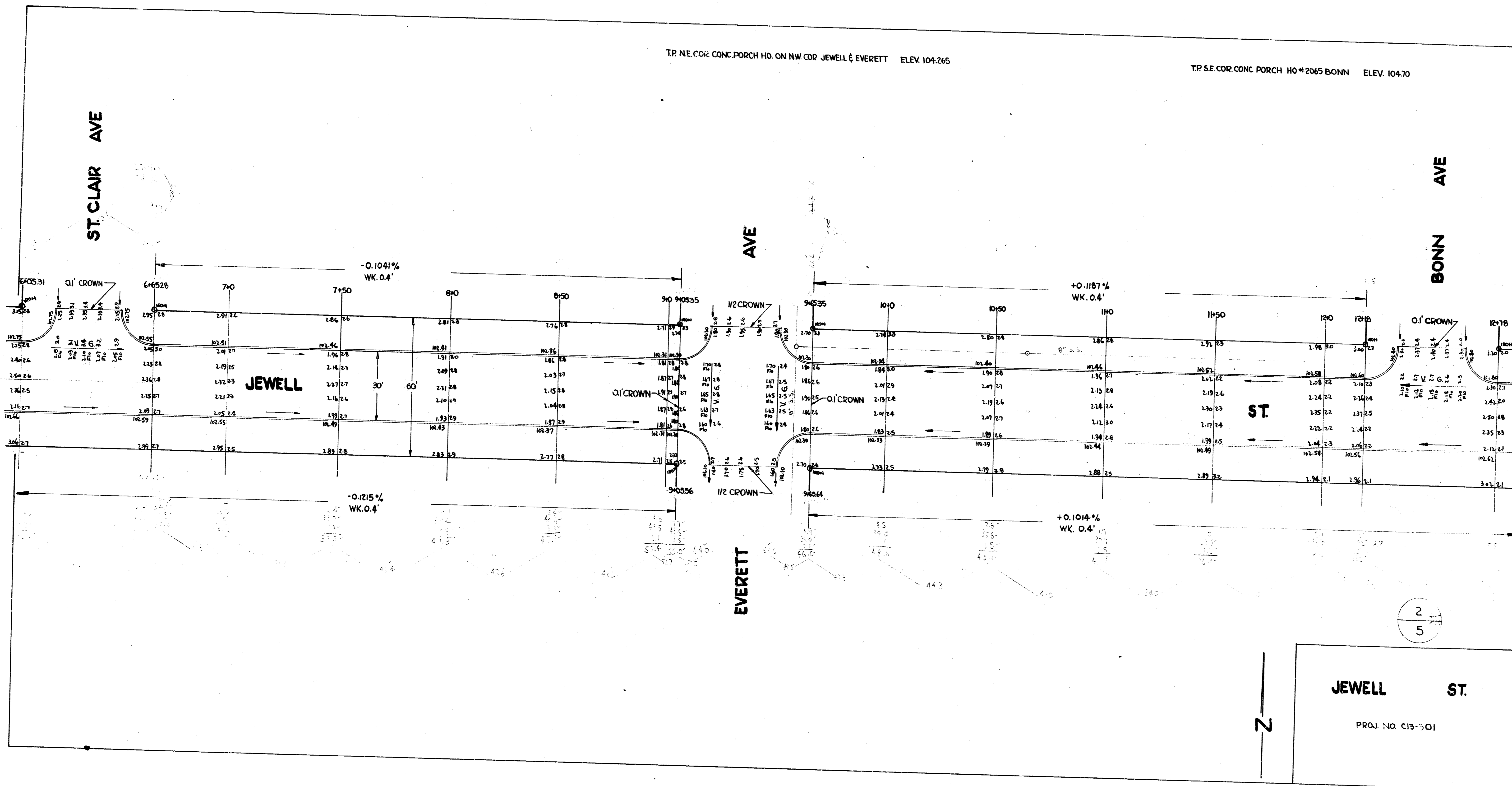

B.M. STD. SE COR. MAY & GLENN ELEV. 104.112
 B.M. N.W. COR. CONC. PORCH HO# 2058 GLENN ELEV. 105.46

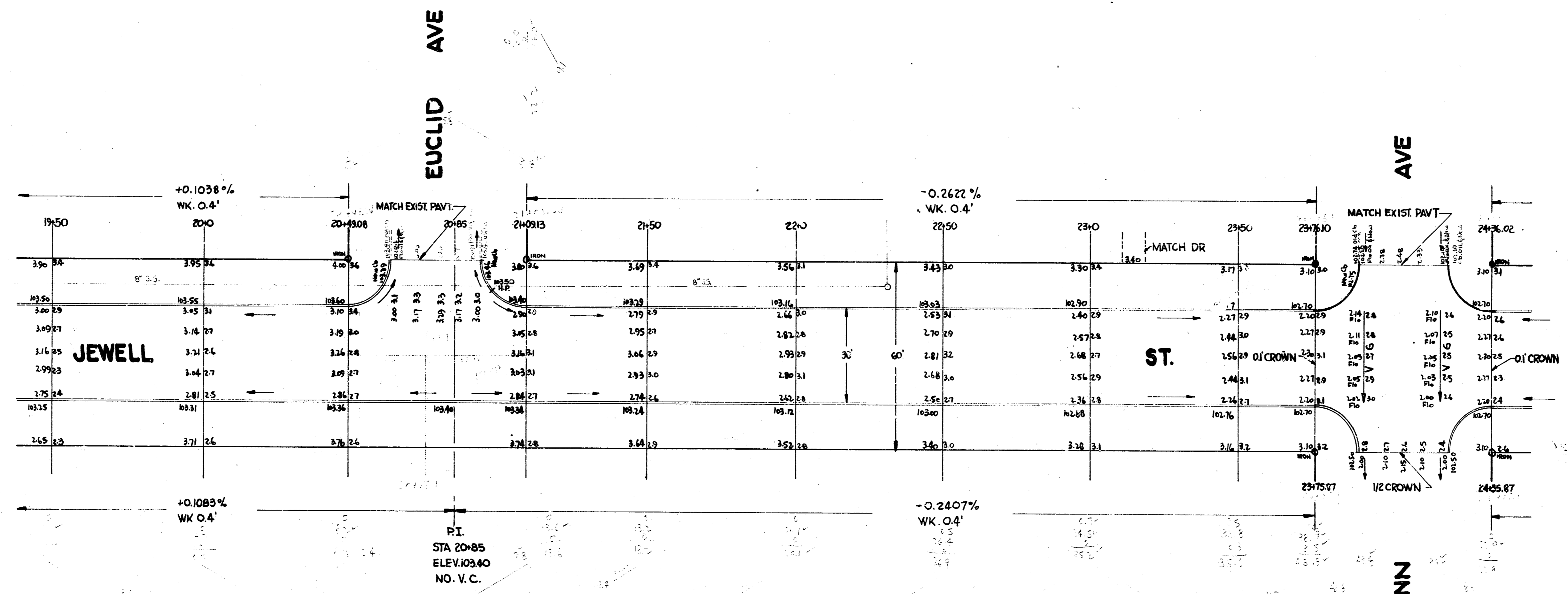

4
5

JEWELL ST
 PROJ. NO. C13-301

BONN AVE

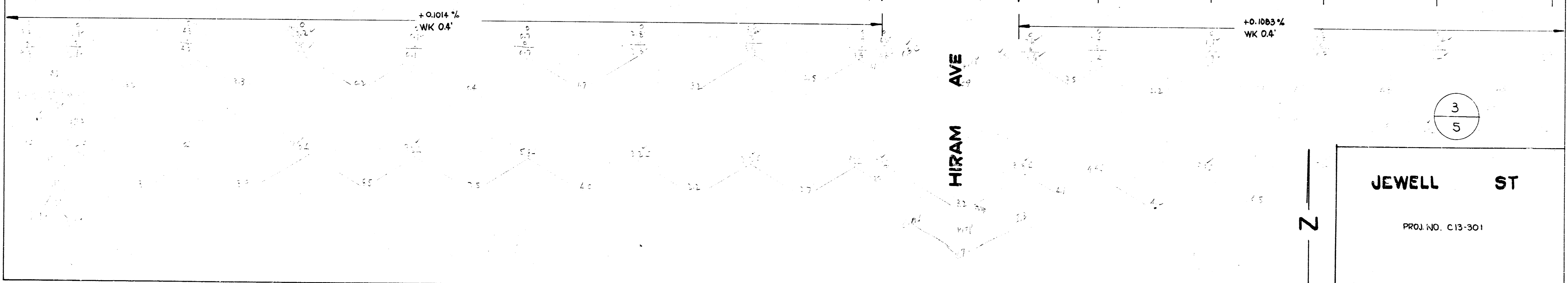
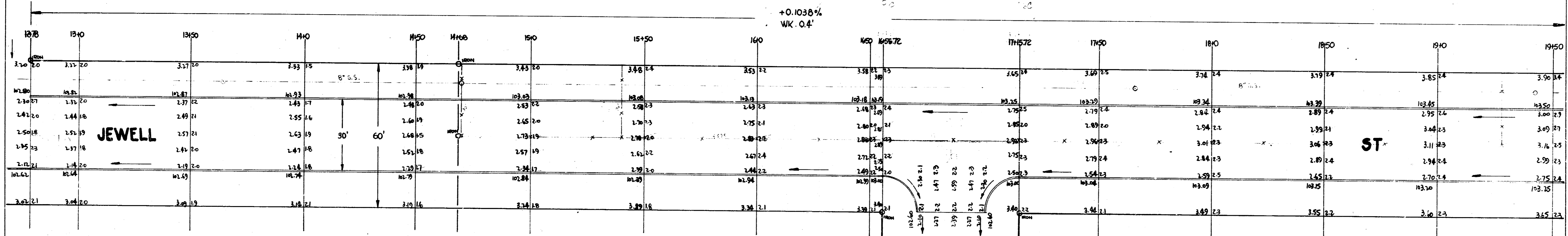

JEWELL ST

PROJ. NO. C13-301

B.M. S.E. COR. CONC. PORCH HO#205 VINE ELEV. 105.19

25+00.3' IRONS 5936R L.CORR
25+00.5' IRONS 5936R R.CORR

P.I.
STA. 25+81.03
ELEV. 103.05
NO V.C.

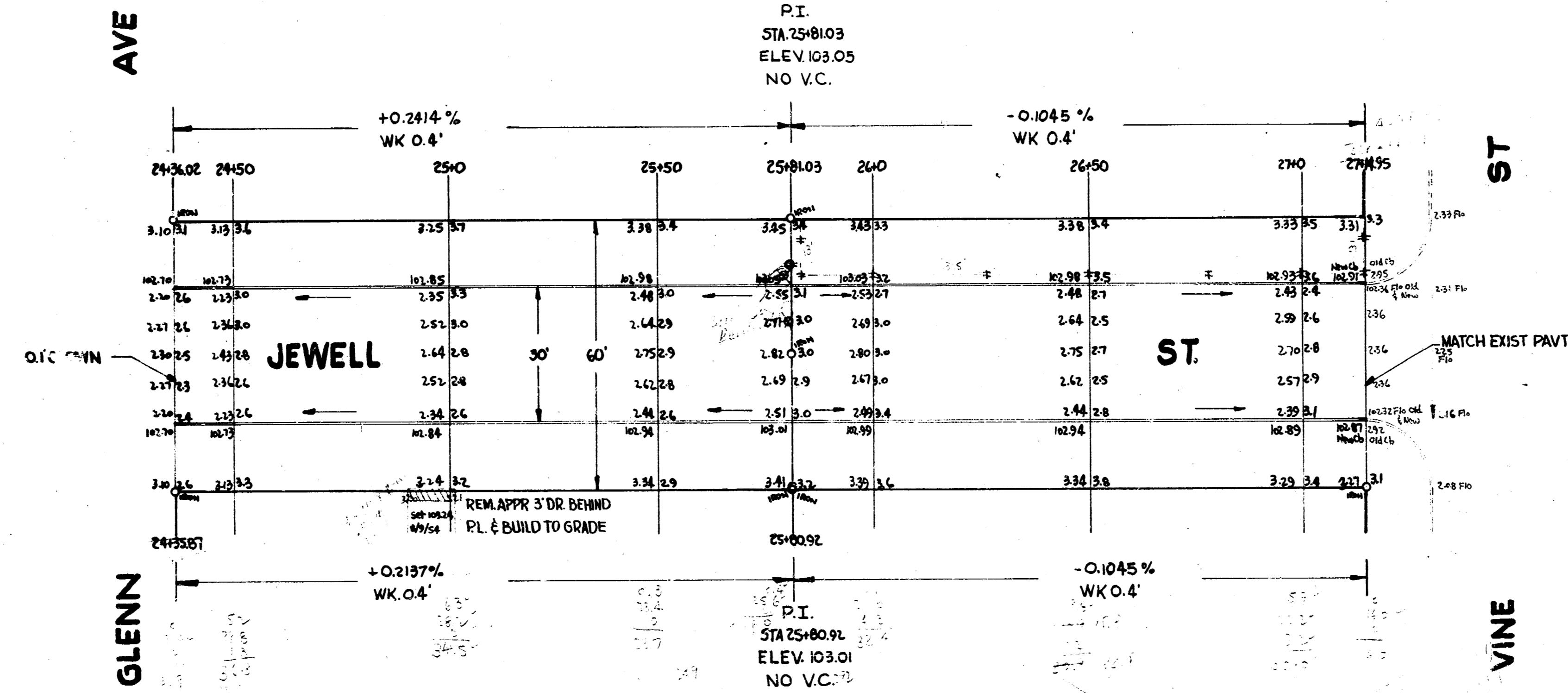

5/5

JEWELL ST

PROJ. NO. C13-301

2

1 15 1 10