

CURVE DATA

RADIUS 900.16 L=348.51 FT Δ=22°12'30"

STATION	PC	PT	CHORD BEARING	TOTAL DEFLECTION
0+47.63			0°00'00"	0°00'00"
0+47.63	51.87	49.44	1°39'04"	1°39'04"
175892	59.39	56.62	1°53'26"	3°32'30"
2+00	41.07	39.15	0°47'44"	4°20'14"
2+25	24.99	23.82	0°47'44"	5°38'40"
2+75	24.99	23.82	0°47'44"	6°26'28"
3+00	24.99	23.82	0°47'44"	7°14'08"
3+25	24.99	23.82	0°47'44"	8°01'52"
3+50	24.99	23.82	0°47'44"	8°49'36"
3+75	24.99	23.82	0°47'44"	9°37'20"
3+96.54	24.99	23.82	0°47'44"	10°25'04"

B.M. 102.12 IN RITCHIE W Co. E ARMOUR Dr 97 Ft. SOUTH EDGE HOLLIDAY INN HOTEL PARKING LOT
 B.M. 59.04 5/8" SPIKE IN DRIVE IN THEATER FLOOD LIGHT POLE 100 FT. S OF S/E CORNE 241/2 OF E/2 LONGFELLOW (S.W. COR OF DRIVE IN PARKING AREA)
 STA. ON 9 FT. OFFSET S OF ME

199.4
 186.5
 195.7

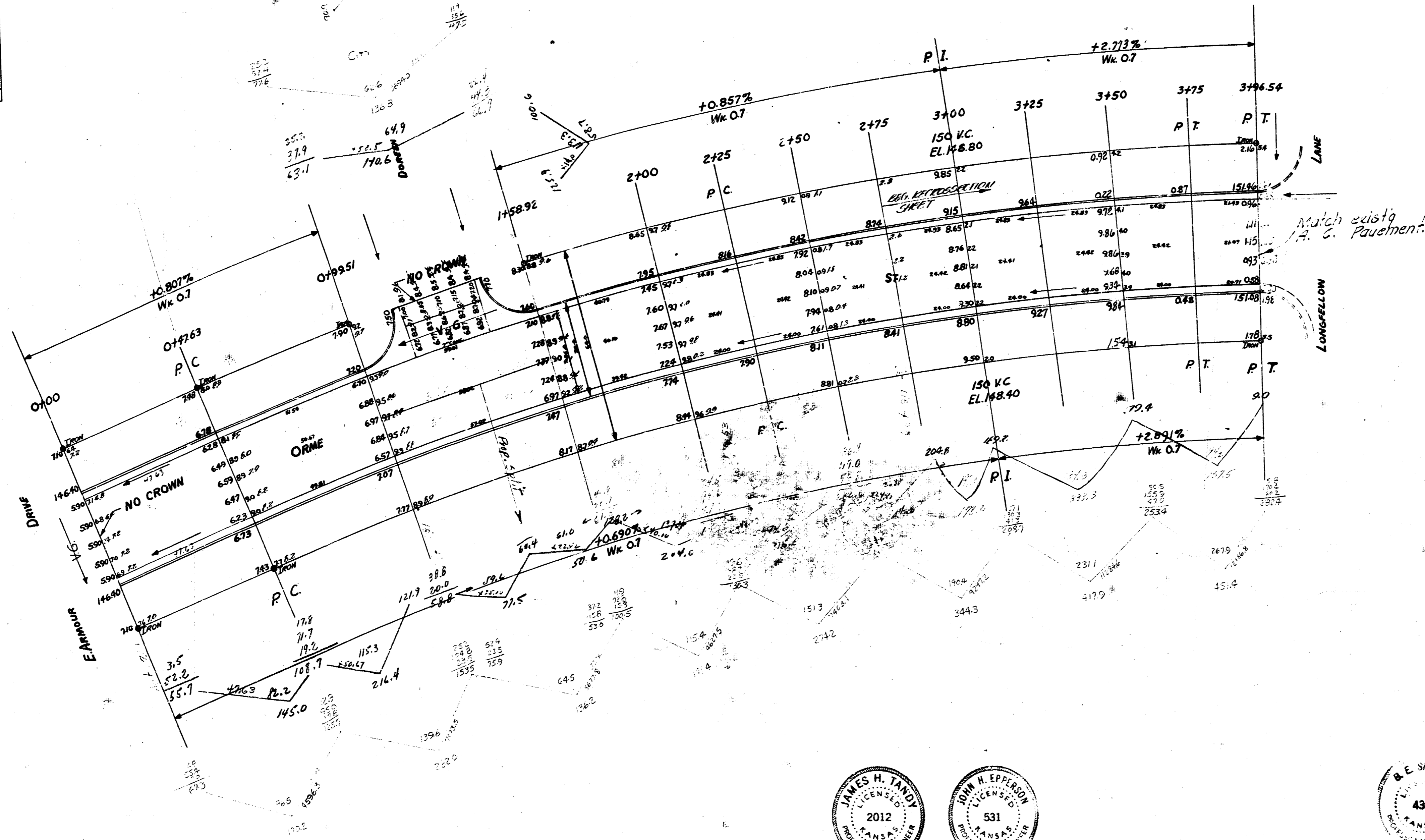

ORME ST.
 E.L.E. ARMOUR To W.L. LONGFELLOW
 26-2-30 AC.
 CITY OF WICHITA, KANSAS
 B.E. SMITH CITY ENGINEER
 JUNE, 1958 PROJ. No. C14-169

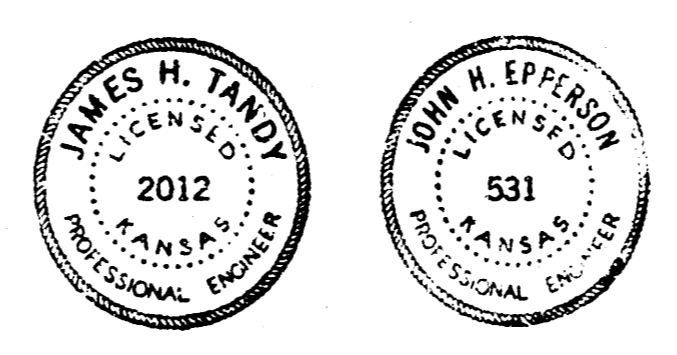

Surveyed by: B. JAKMA
 Date: 1/22/58
 City: Wichita, Kansas