

BM - 103.447 Standard 6" W x 2" N of NE cor. Pawnee & Seneca.
 BM - 100.05 SW cor conc. porch House NE cor. Osage & Pawnee.
 BM - 99.77 1/2" spike in E face H.L.P. @ Sta 6+77.75.
 Chaining N on West Property Line.

CURVE DATA: Sta 0+00 to Sta 0+63.11 on 6" offset from W curb.
 E = 173.37 Δ = 22° Defl = 991446 min/ft arc. Stationing on W 1/2.

STATION	Arc Length 6" offset Wcb	Deflection Angle	Total Deflection	Chord Length 6" offset Wcb	Chord Length 6" offset Ecb
0+00					
+25	24.37	4° 21' 27"	4° 21' 27"	24.35	30.73
+50	24.37	4° 21' 27"	8° 42' 54"	24.35	30.73
+63.11	13.83	2° 17' 06"	11° 00' 00"	13.82	17.17

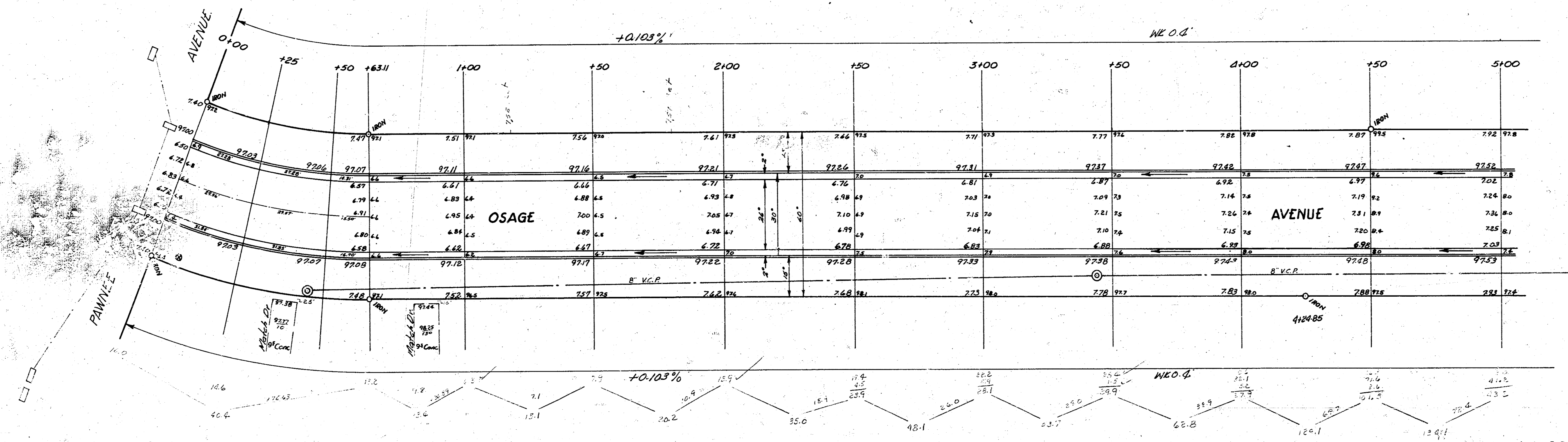

DRAWN BY: JAK
 CHECKED BY: M.S.
 DATE: 6/15/57

Elevation
 Property - CH
 777.6
 718
 11/6 - 855.0 Co. As

Sheet 1 of 2.



OSAGE AVENUE
 NL Pawnee to NL Midland Villa Addn.
 26-2-30A.C.
CITY OF WICHITA, KANSAS
 B.E. SMITH CITY ENGINEER
 JUNE 1957 PROJ. NO. C15-157

