

TYPICAL SECTION

3" ASPHALTIC CONCRETE PAVEMENT WITH BITUMINOUS BASE

A TACK COAT OF EMULSIFIED ASPHALT (SS-1H) SHALL BE APPLIED AT AN APPROXIMATE RATE OF 0.05 GALLONS PER SQ. YD. BETWEEN LIFTS OF ASPHALTIC MATERIALS WHEN ORDERED BY THE ENGINEER. TACK COAT WILL NOT BE PAID FOR DIRECTLY AND SHALL BE CONSIDERED AS SUBSIDIARY TO PRICE BID FOR ASPHALTIC PAVEMENT. BITUMINOUS BASE AND ASPHALTIC CONCRETE WEARING SURFACE SHALL BE PLACED WITH A LAYDOWN MACHINE HAVING AUTOMATIC ELECTRONIC CONTROLS FOR CROWN AND GRADE. CONSTRUCTION JOINTS IN EACH LIFT SHALL BE STAGGERED A MINIMUM DISTANCE OF 1' WITH JOINTS IN PRECEDING LIFTS AND SUCH THAT A JOINT WILL BE CONSTRUCTED ON THE PAVEMENT CENTERLINE IN THE TOP LIFT.

The A.C. pavement between the Comb Curb & Gutter shall be paid as 3/8" A.C. Pavement (6 Bituminous Base). The Bituminous Base under the Comb Curb & Gutter shall be paid as 3" Bituminous Base.

COMBINED CURB & GUTTER

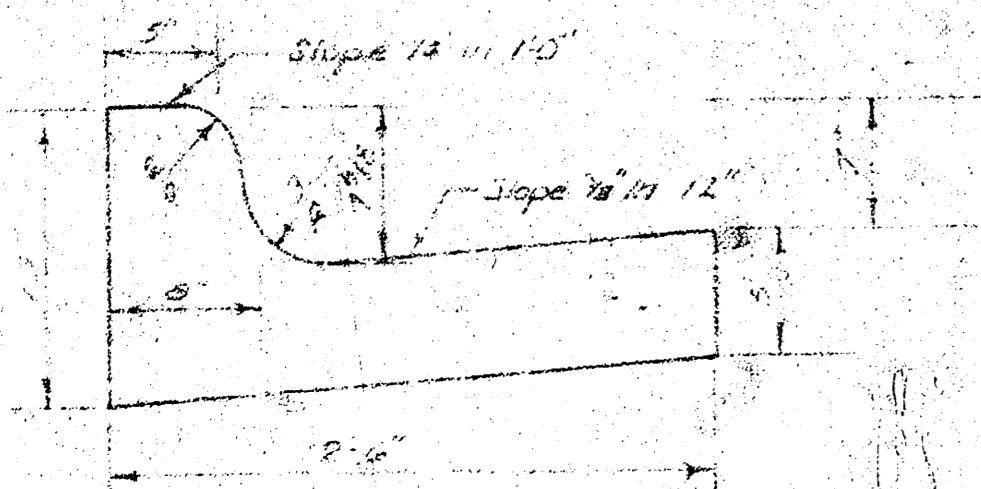

ROLL TYPE CURB & GUTTER

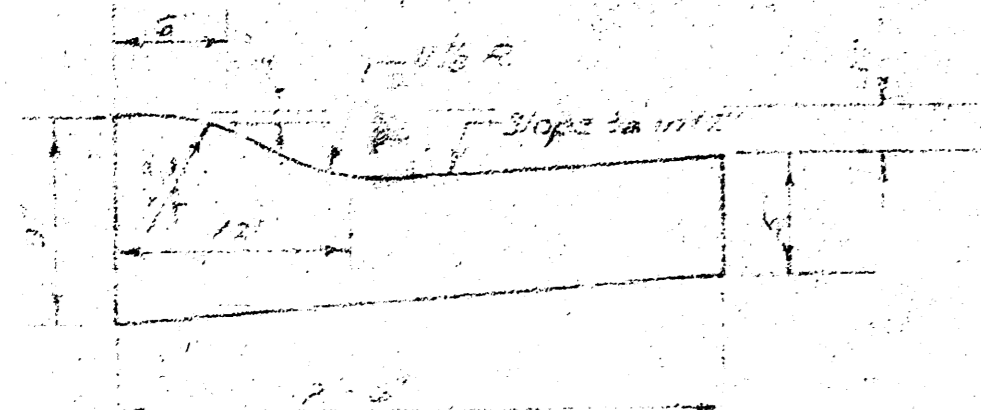

DETAIL OF TRANSVERSE CONSTRUCTION JOINTS

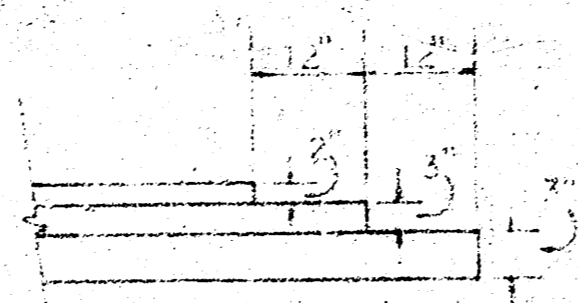

TRANSVERSE CONSTRUCTION JOINTS SHALL BE CONSTRUCTED IN FLEXIBLE BASE PAVEMENTS AT LOCATIONS WHERE PAVEMENT TEMPORARILY ENDS TO FACILITATE FUTURE PAVEMENT CONSTRUCTION AS SHOWN BY DETAIL. THE COST OF CONSTRUCTING THE TRANSVERSE CONSTRUCTION JOINTS SHALL NOT BE MEASURED OR PAID FOR DIRECTLY BUT SHALL BE INCLUDED IN THE BID PRICE FOR SQUARE YARDS OF ASPHALTIC CONCRETE PAVEMENT.

OTT ST.
E.L. HARLAN TO E.L. WOMERS
WEST LYNN 5TH ADDITION.
26 - 2 - 30.

CITY OF WICHITA, KANSAS

DEPARTMENT OF PUBLIC WORKS — ENGINEERING

R. W. LINN CITY ENGINEER

DATE _____ PROJ. NO. **DAKS 574027.** 1/2

B.M. 128-53 - R.R. SPIKE N. SIDE P. POLE
ON S.E. COR. WEST LYNN & OTT.

SCALE: 1" = 20'

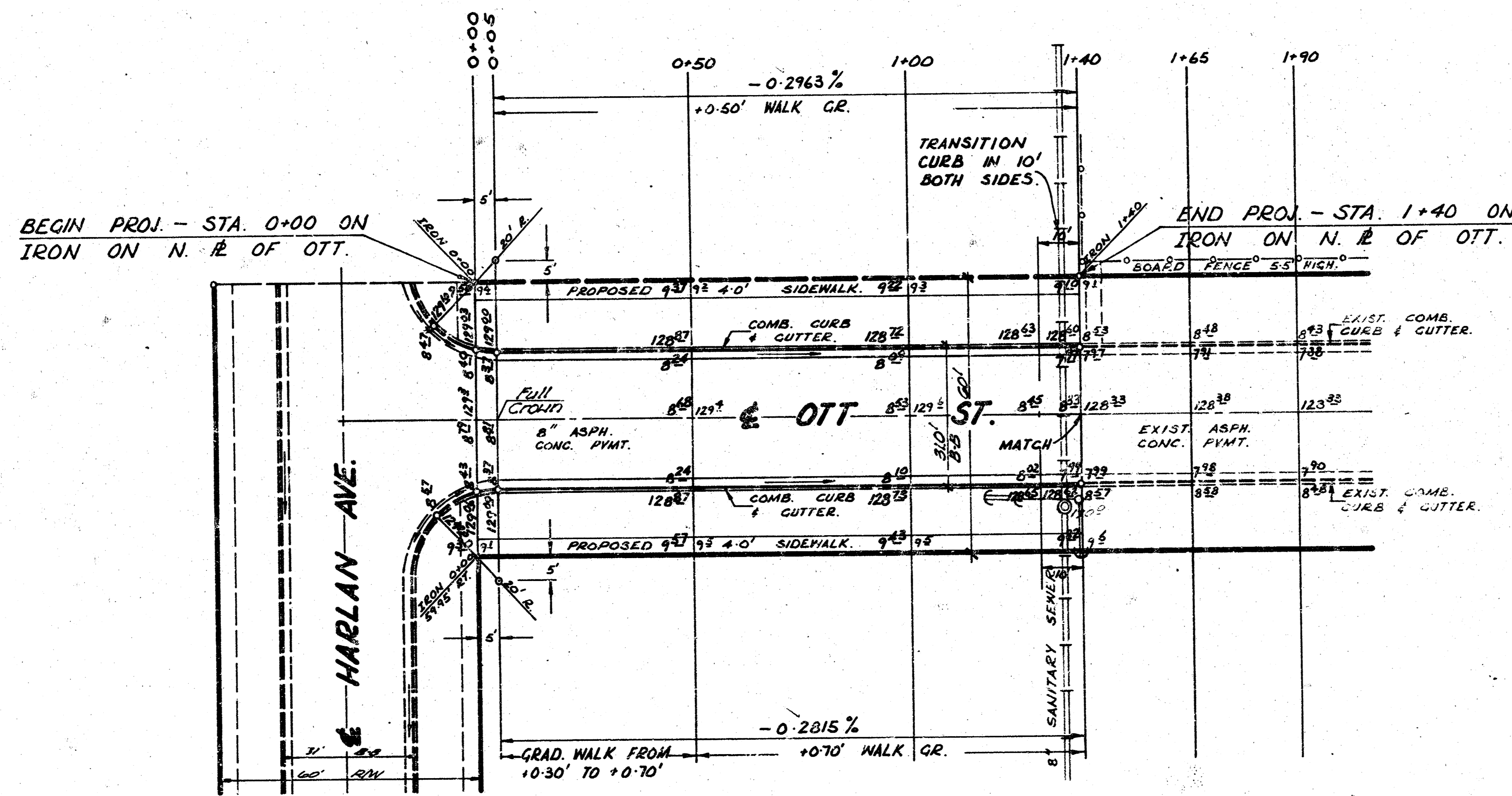

BASE LINE IS N. R. OF OTT.

NOTE: FIELD ENGINEER TO DETERMINE TYPE OF SUBGRADE TREATMENT. SUBGRADE TREATMENT MAY CONSIST OF LIME TREATMENT, CEMENT TREATMENT, SUBGRADE MODIFICATION OR ANY COMBINATION OF THESE. LIME SLUDGE, WHICH IS A BY-PRODUCT OF ACETYLENE GAS PRODUCTION, MAY BE USED AS A STABILIZING AGENT IN PLACE OF HYDRATED LIME OR QUICK LIME WITH THE APPROVAL OF THE ENGINEER. COMPLETED CONSTRUCTION MUST BE EQUAL TO THAT WHICH COULD BE ACCOMPLISHED IF HYDRATED LIME OR QUICK LIME HAD BEEN USED. CONTRACTOR TO CLEAR RIGHT-OF-WAY AND GRADE PARKING FOR SIDEWALK. COMPACT FILL IN WALK AREAS. SIDEWALK BY "OTHERS".

EARTHWORK

PROPERTY	CITY
EXCAVATION: 248.3 CY	NIL
+10%: 26.8 CY	
TOTAL: 275.1 CY	

Manipulation 5137 SY

OTT ST.
E.L. HARLAN TO E.L. WOMERS
WEST LYNN 5TH ADDITION.
26 - 2 - 30.
CITY OF WICHITA, KANSAS.
R.W. LINN - CITY ENGINEER.
DATE: PROJ. NO. DAKS 574027. 2/2

FILMED FROM THE BEST AVAILABLE COPY.....