

B.M. 147.16 F.R. Sph. N.W. Side of Cottonwood Tree Rt. Sta. 0+78.5

NOTE: Field Engr. & Contractor

Bring E. Parking to NE Cr. prior to building West Parking. If fill dirt is not available for W. Parking, breakbill enough to protect C&G. dir.

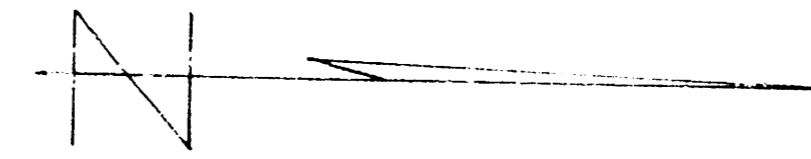

NOTE TO Field Engr. & Contractor

From Sta 0+50 to 1+85 & 2+40 to 2+65 to be bid as C.M. Ft. of Hops Removed.

NOTE:

Extend exist. 18" RCP 28' Match No exist. pipe. Fl. @ West end new pipe 145.00. Slove drainage West by cleaning ditch between exist. pipes.

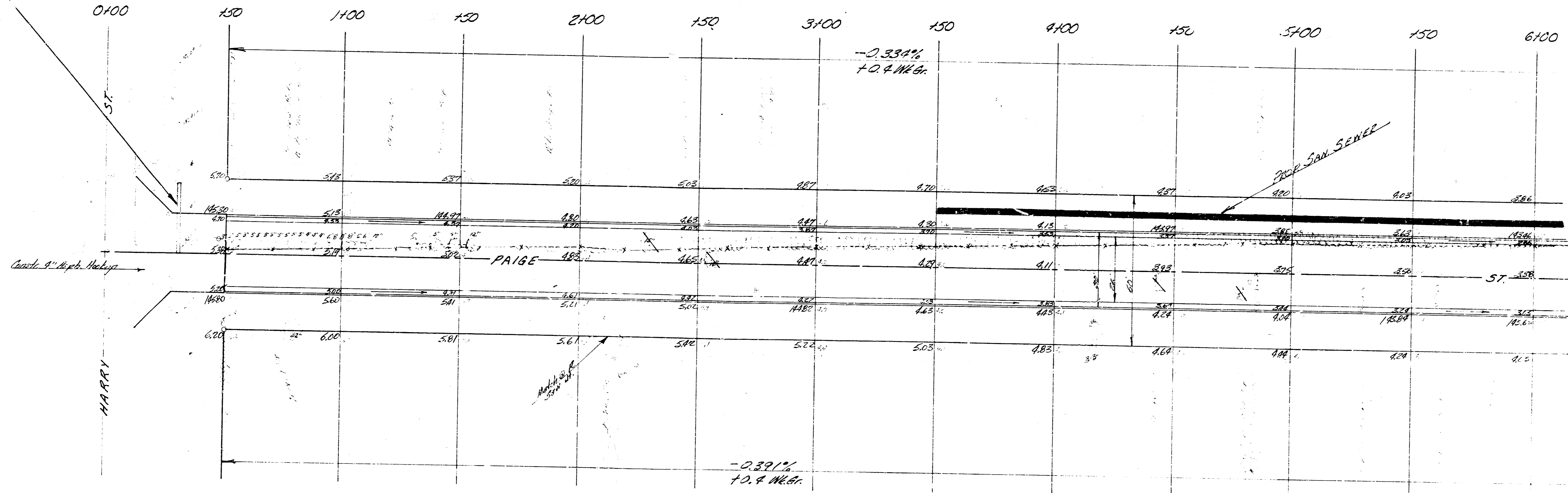

Baseline 50 West of E.R. Paige

NOTE TO CONTR.

Paving Contractor is to remove hedge & fence to allow installation of San. Sewer in West parking Sta 3+25 to 4+65. Prior to excavating & paving.

Excavation	
Prop	City
1314.1 CY	115.1 CY
131.9 +10%	11.5 +10%
1445.5 CY Total	126.6 CY Total

Comp. Fill	
Prop	City
78.2 CY	24.8
7.2 +10%	2.5 +10%
77.9 CY Total	27.3 CY Total

PAIGE ST
NW Harry St. To SE Garh St
26'-2" 30" AC.

CITY OF WICHITA KANSAS
B.E. SMITH CITY ENGINEER
DATE Aug 1965 PROJ NO C-172

1/4

Checked
Date

B.M. 199.87 S.W. Cor. Conc. Pavent Ho. # 1106 Peipe

Field Engrg. NOTE
Drive Detail of Location 6148.75

P.V.I.
Elev 19320
30' K.C.
61775

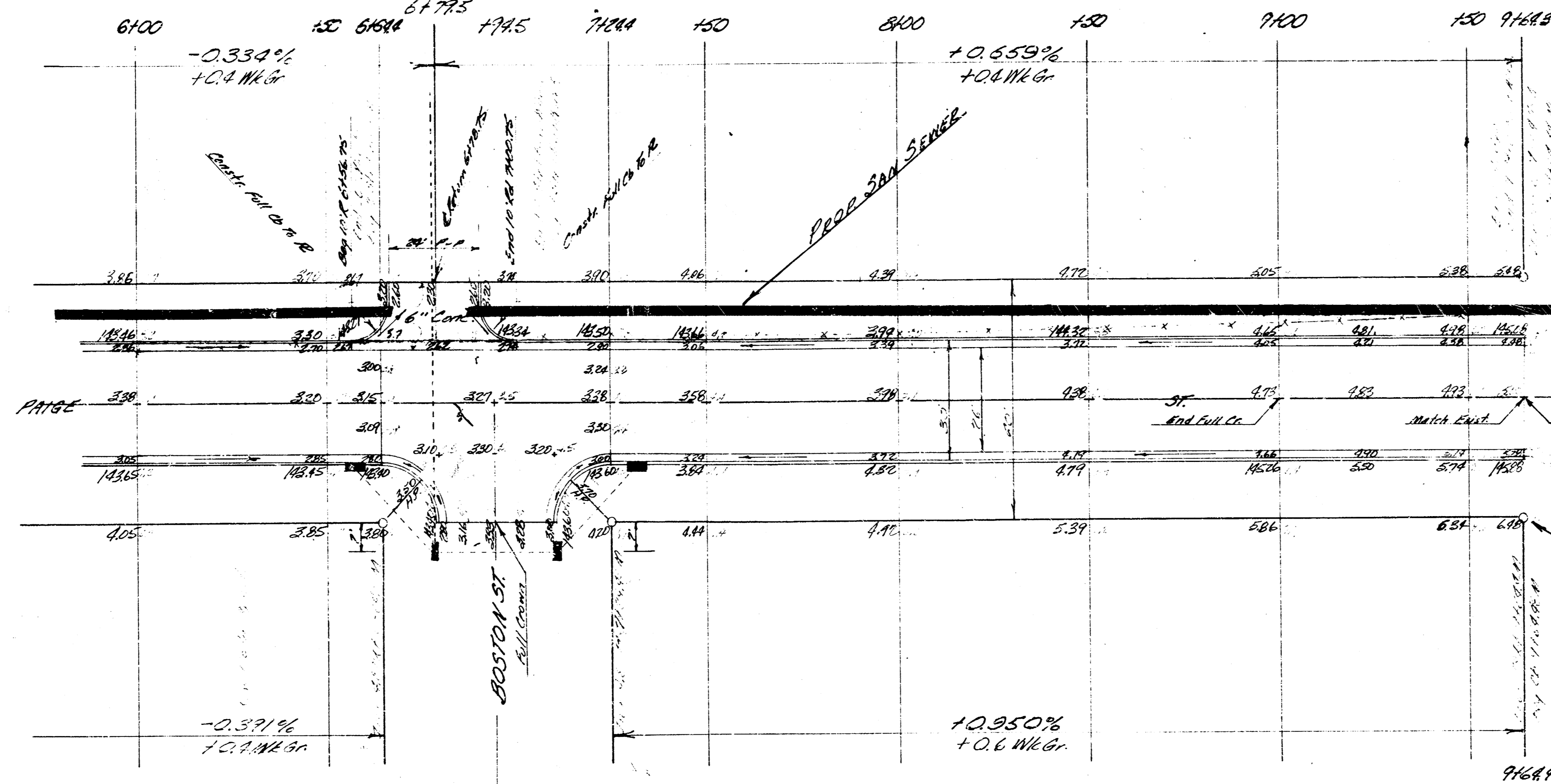

2/4

PROJ No C18-176

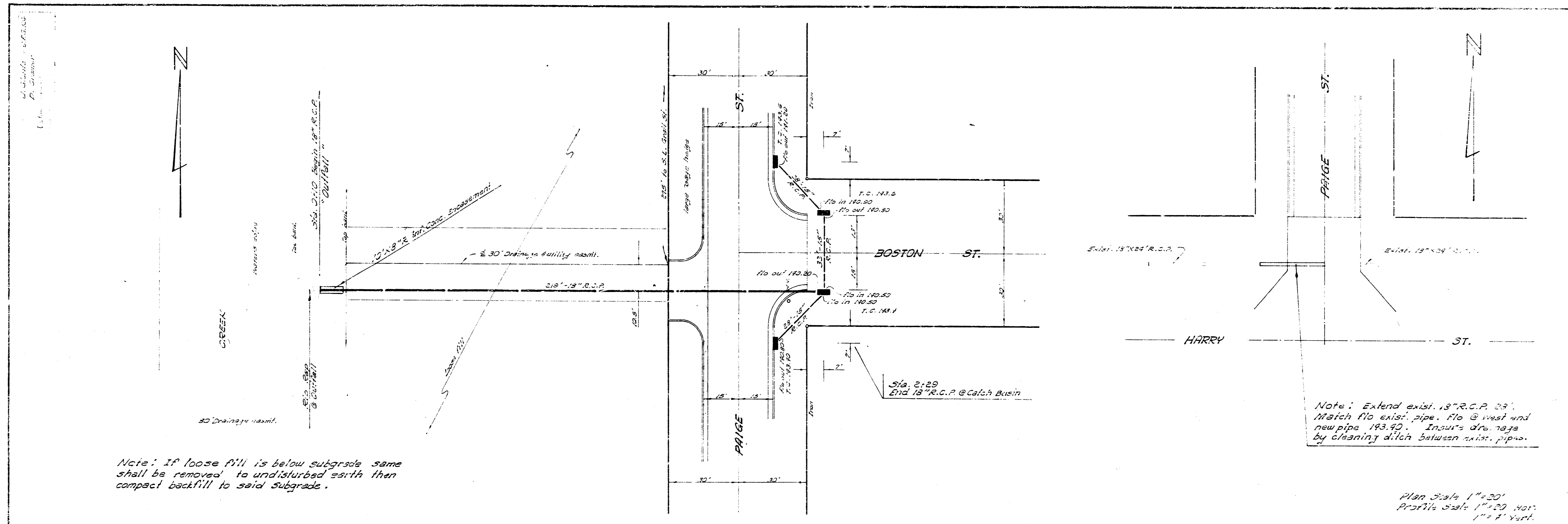

S. 11. 149.87 S.W. Cor. Conc. Porch Ho. # 1106 Paige

S. 17. 147.16 R.R. Spike N.W. side E. Cottonwood 30' N. of N.E. Cor. Harry & Paige

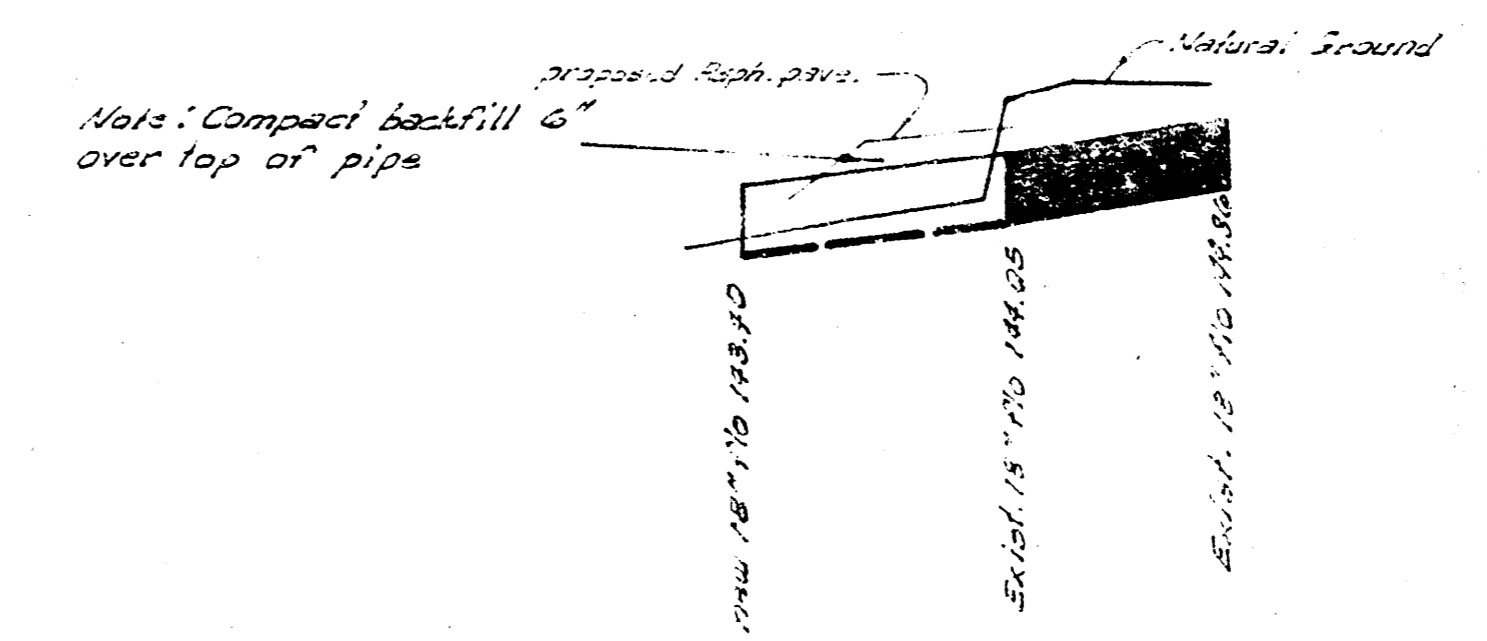
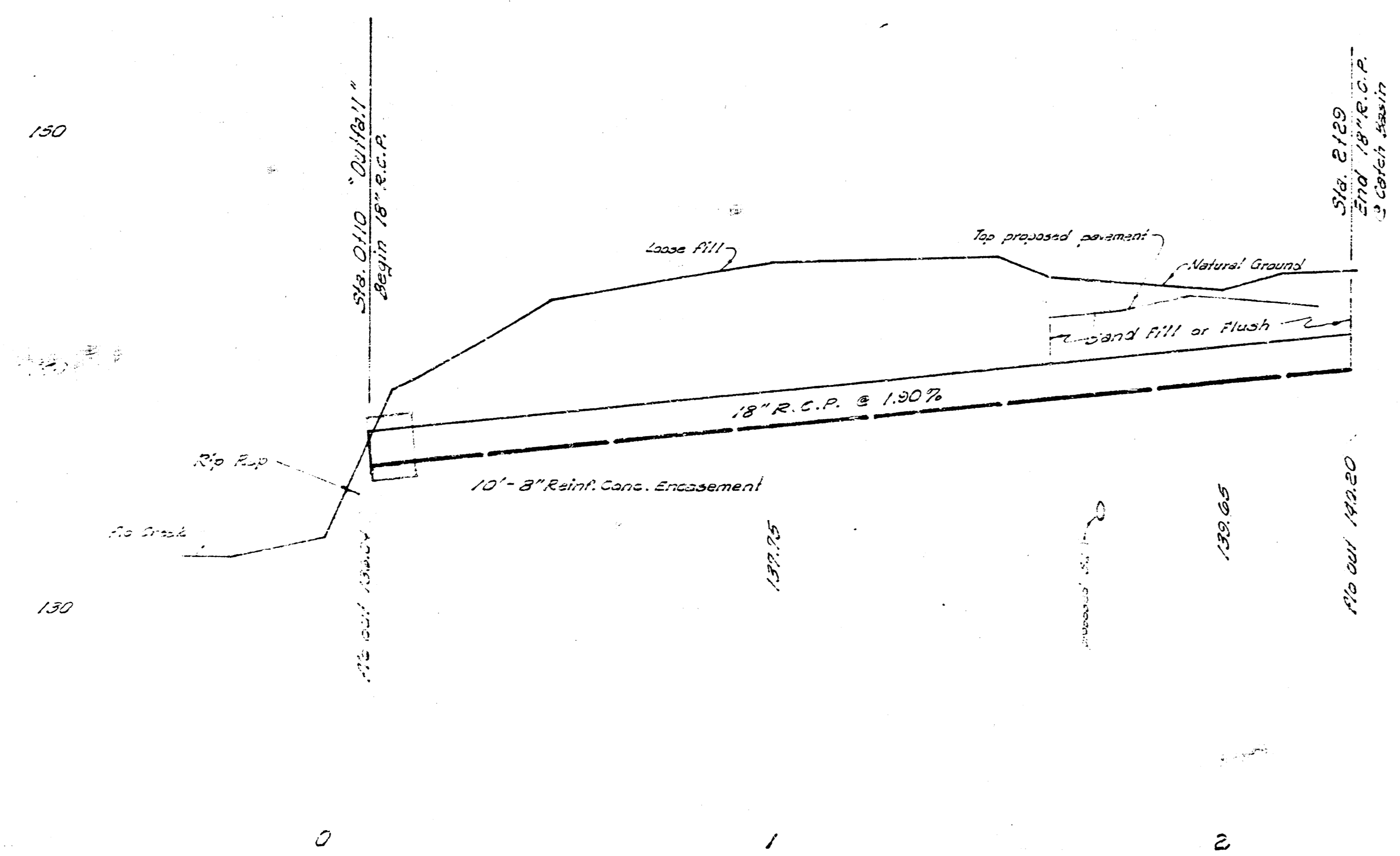

INCIDENTAL DRAINAGE
PAIGE STREET
N.E. HARRY ST. TO N.E. GERALD ST.
CITY OF NICHITA, KANSAS
B. E. SMITH, CITY ENGINEER
PROJ. NO. C18-1-6
DATE: Aug. 1965