

B.M. 14892 SW cor Curt Forch House on NE Cor Zimmerly & Paige

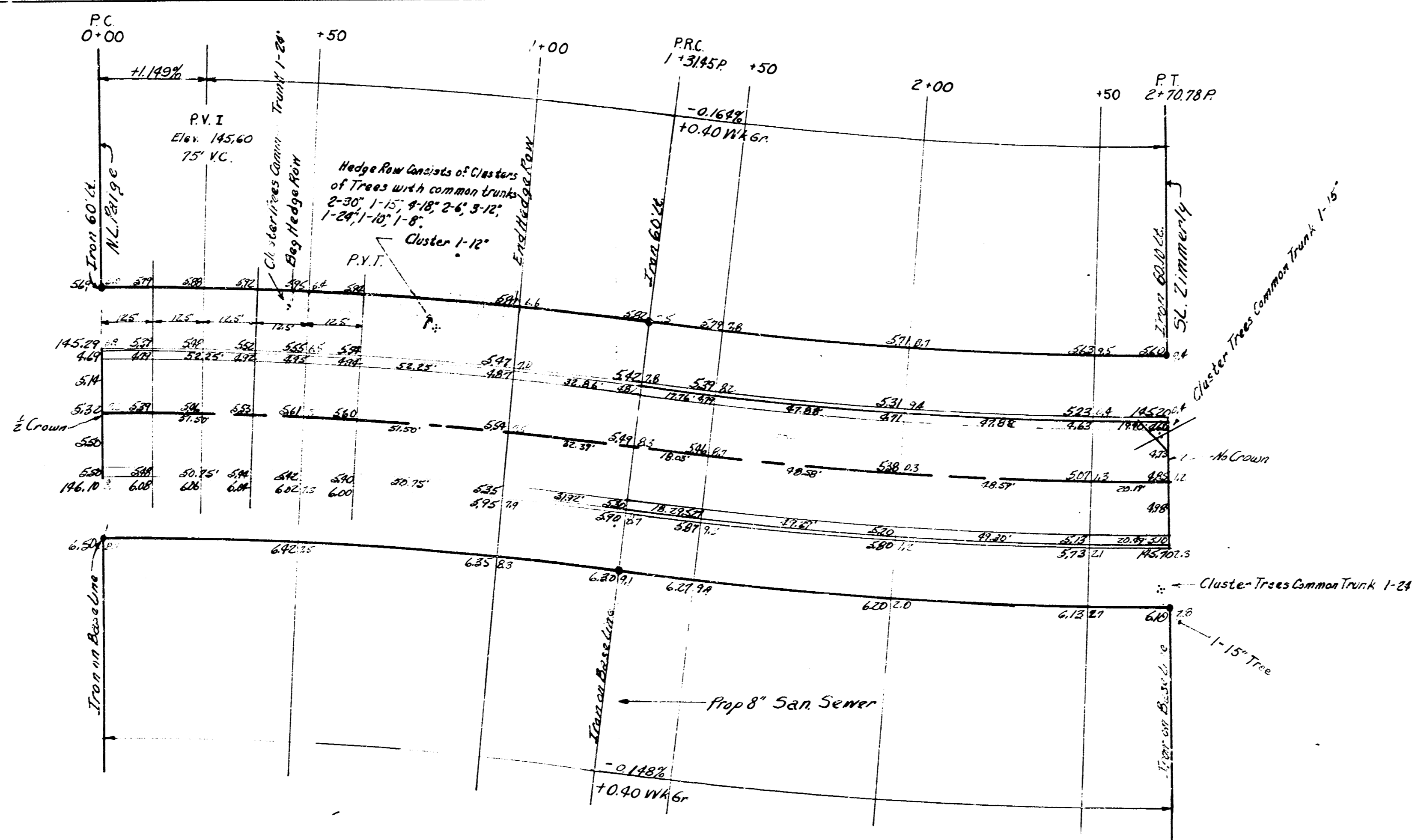

Base Line E. R.

Curve Data Based on E. R. Radius 1000.98' Δ 73°30'					
Sta	Arc	Chord Length 8'S E. Curve	Chord Length 8' @ M. Curve	Deflection	Total Deflection
PC 0+00					0° 00' 00"
+50	50'	50.95'	50.45'	1° 25' 52"	1° 25' 52"
+100	50'	50.35'	52.15'	1° 25' 58"	2° 51' 50"
PRC 1+31.45	31.45'	31.67'	33.12'	0° 52' 01"	3° 43' 51"
Curve Data Based on C. R. Radius 1060.98' Δ 73°31'30"					
PR 1+31.45					0° 20' 12"
+50	18.55'	18.93'	17.62'	0° 30' 03"	0° 30' 03"
+100	50'	49.67'	49.50'	1° 21' 01"	1° 51' 04"
+150	50'	49.67'	49.51'	1° 21' 01"	3° 12' 05"
PT 2+78.78	28.78'	28.68'	19.79'	0° 23' 40"	3° 45' 45"

Def'n 1/2 17719 mins.

Def'n 1/2 16208 mins.

Excavation
20426 C.Y.
2043 ± 10%
2246.0 Total C.Y.



1/2

PAIGE ST.
N.L. Grail to S.L. Zimmerly
26'-2'-30" A.C.
City of Wichita, Kansas
B.E. SMITH City Engineer
Date May 2nd 1917 No C18-177