

D.M. 1041F S.E. Cor. Lower Deep E.S. No. 2167 Palisade
 D.M. 9977 "2" in 1942 S. End Ch. W.S. Palisade S.L. Brookings Addn
 D.M. 9757 Neil in Cor. Fence Post N.W. Cor. Trailer Camp

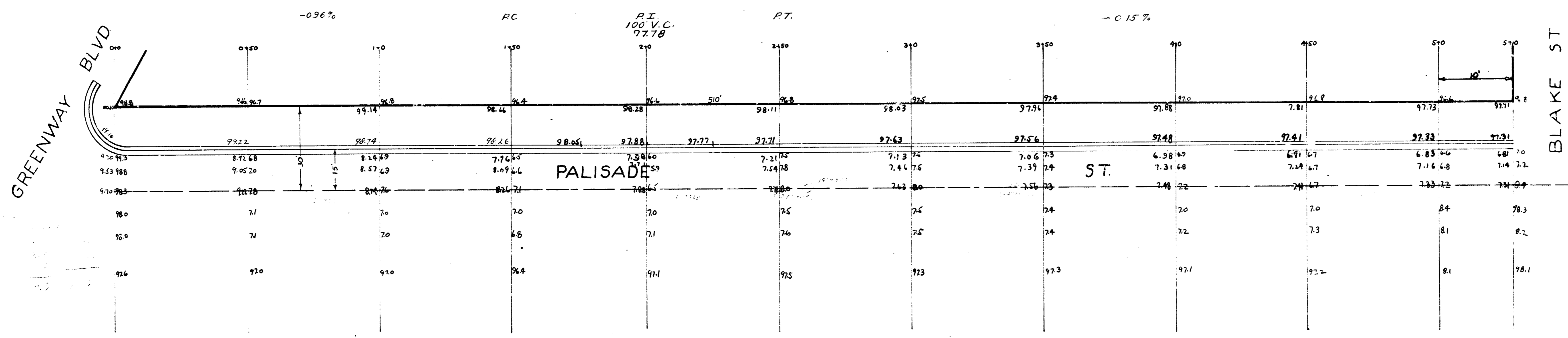

1
2

PALISADE ST.
 WEST HALF
 N.L. GREENWAY TO 150' N. OF N.L. BLAKE
CURB & GUTTER
 CITY OF WICHITA, KANSAS
 L.K. WHITE CITY ENGINEER
 SEPTEMBER 1946

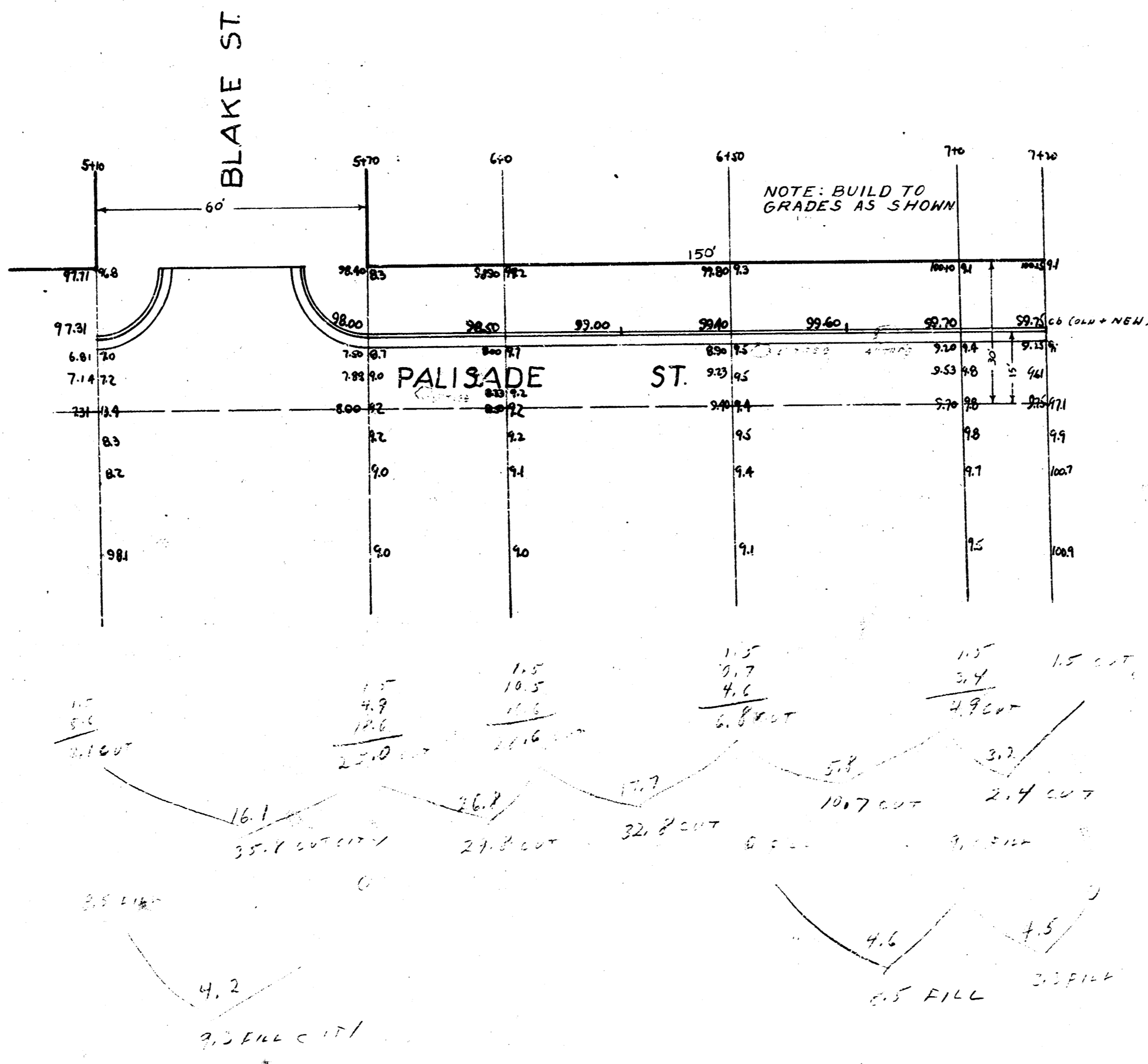

CUT		FILL	
15.5	2.5	1.5	2.5
24.8	1.5	2.5	9.3
22.8		2.2	
19.7	2.5	1.2	9.2
2.4			
75.7	2.4	1.2	10.2
		1.2	