

**PARK PLACE**  
 S.L. 28TH STREET TO S.L. 29TH STREET  
 CITY OF WICHITA, KANSAS  
 B.E. SMITH CITY ENGINEER  
 PROJECT No. C18-124

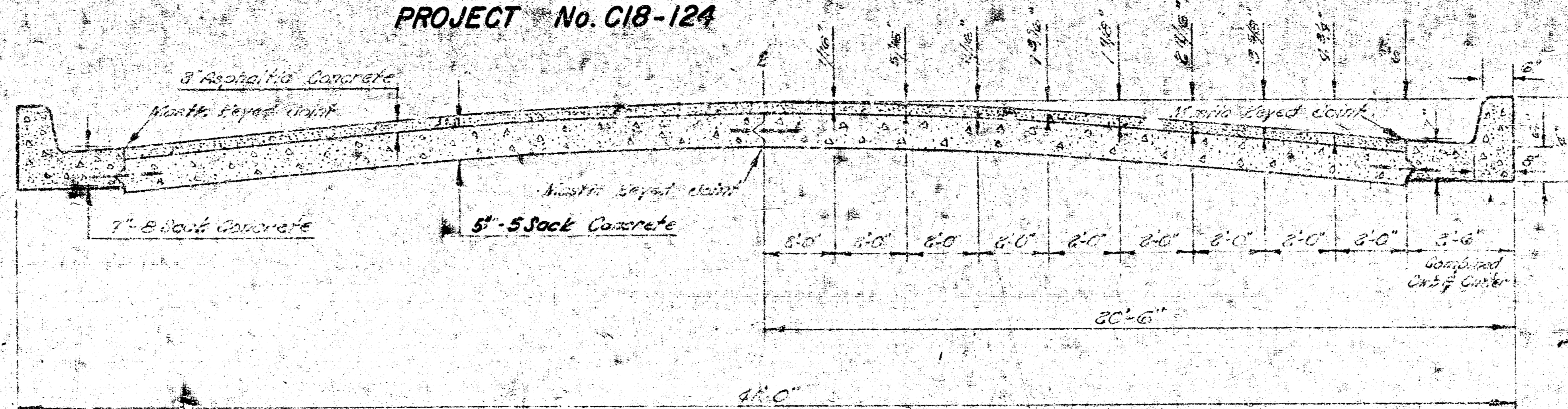

**TYPICAL SECTION**  
 NOT TO SCALE

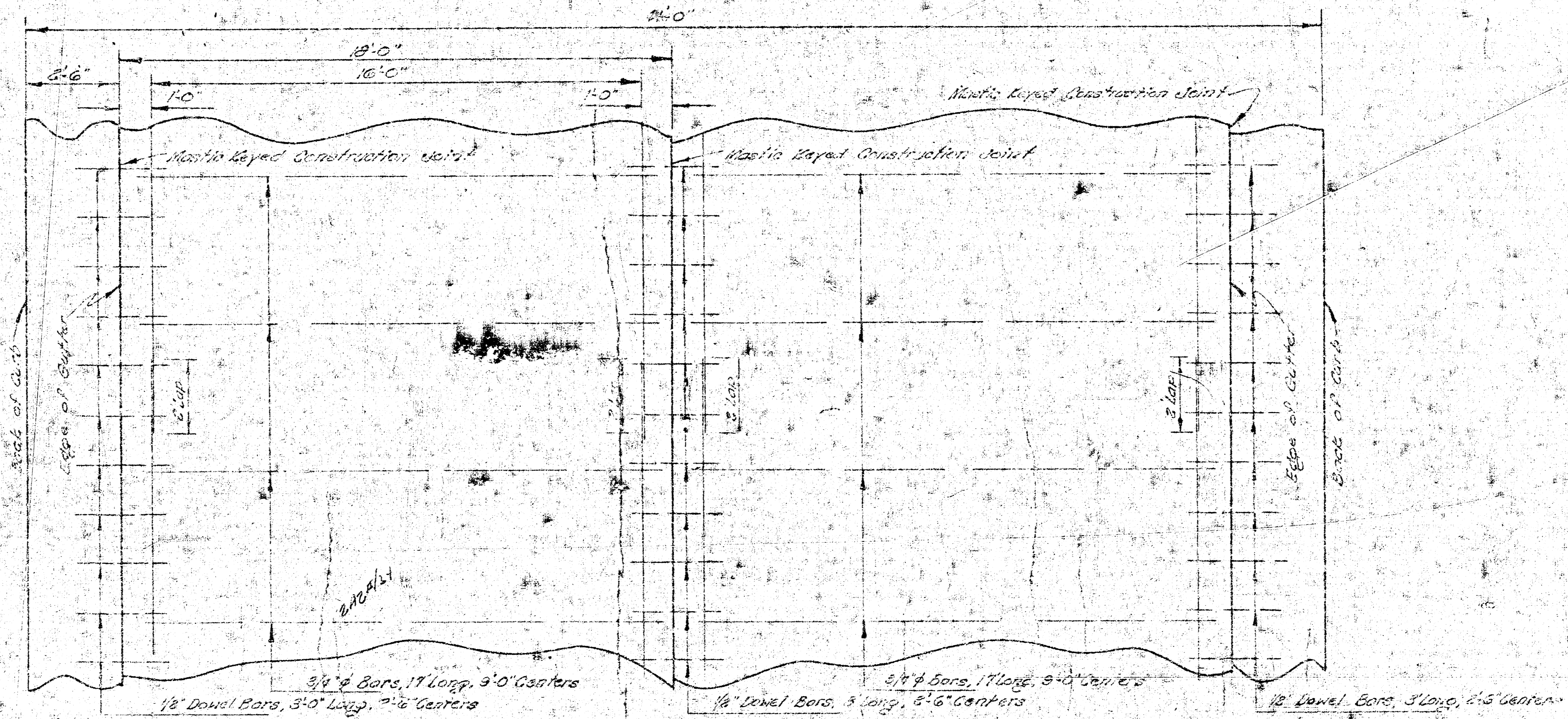

**STEEL PATTERN**  
 USE 3/4" Ø BARS EXCEPT WHERE NOTED  
 NOT TO SCALE

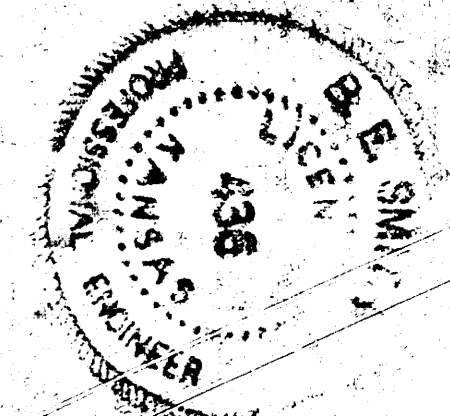
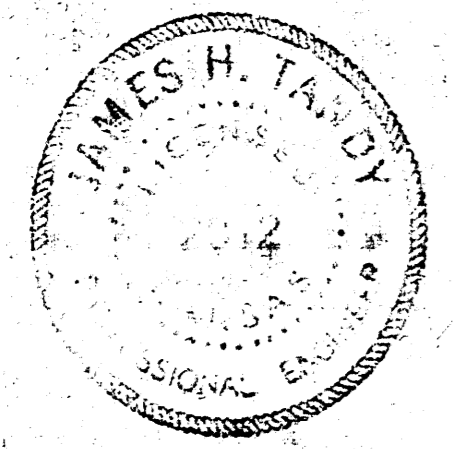

1/8

1-6-12

B.M. 12543 "B" in GLOBE. West End South Curb. E.L. PARK PLACE @ 28TH ST.  
 B.M. 13000 "T" in TROY. Fire Hydrant. N.W. 28TH ST. AND MARKET ST.  
 B.M. 12645 "X" on S.E. Cor Conc Base. S.W. Cor PARK PLACE AND 28TH ST.  
 B.M. 12820 "M" in MUELLER. Fire Hydrant S.W. 28TH ST AND MARKET ST.  
 Base Line is on Center Line



Scale 1" = 20'

NOTE TO CONTRACTOR:  
 Grade ditches to match new  
 pavl elevations and drain  
 West. Incidental to project.

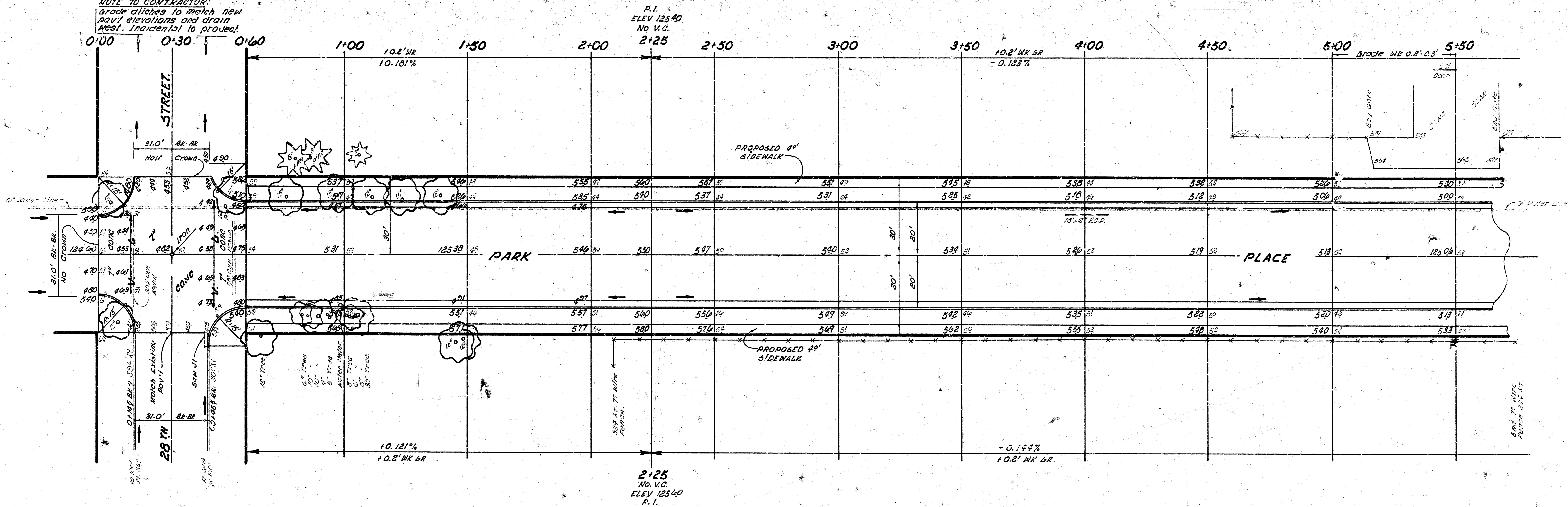

••SIDEWALK••  
 GRADE PARKING AND CLEAR RIGHT OF WAY FOR  
 PROPOSED SIDEWALK. COMPACT BACKFILL IN  
 SIDEWALK AREA. SIDEWALK BY OTHERS"

•EARTHWORK•

PROPERTY		CITY	
EXCAVATION	COMP FILL	EXCAVATION	COMP FILL
924.8 CU YDS	167.6 CU YDS	143.0 CU YDS	1.2 CU YDS
110% 42.5	110% 16.8	110% 13.1	10% 1.1
967.3 CU YDS.	184.4 CU YDS	143.9 CU YDS	1.3 CU YDS
317.4 CU YDS S.B.M		58.6 CU YDS S.B.M	

**PARK PLACE**  
 S.L. 28TH STREET TO S.L. 29TH STREET.  
**36'-2'-40' ASPHALTIC CONC**  
 CITY OF WICHITA, KANSAS  
 B. E. SMITH CITY ENGINEER  
 DATE: DEC 1967 PROJ No. C18-124

2/4

