

B 7 96.74 N.W. Cor. Porch Ho 301 W. 33rd St. So  
 Chaming on N R

Excels Grand Total

Prop	City
1821.8	218.3
+10% 182.2	+1% 21.8
Total 2004.0	Total 251.0

Excels	City
1354.7	51.4
	222.3

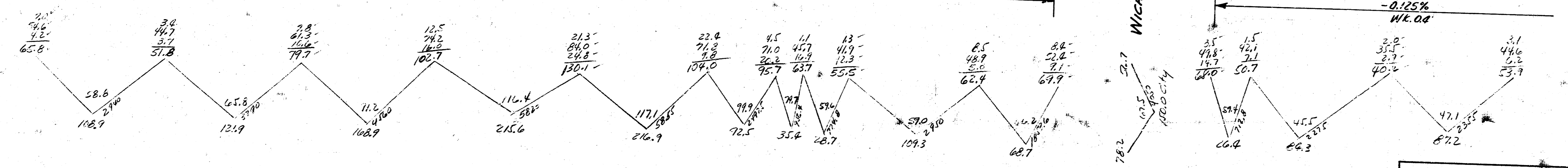
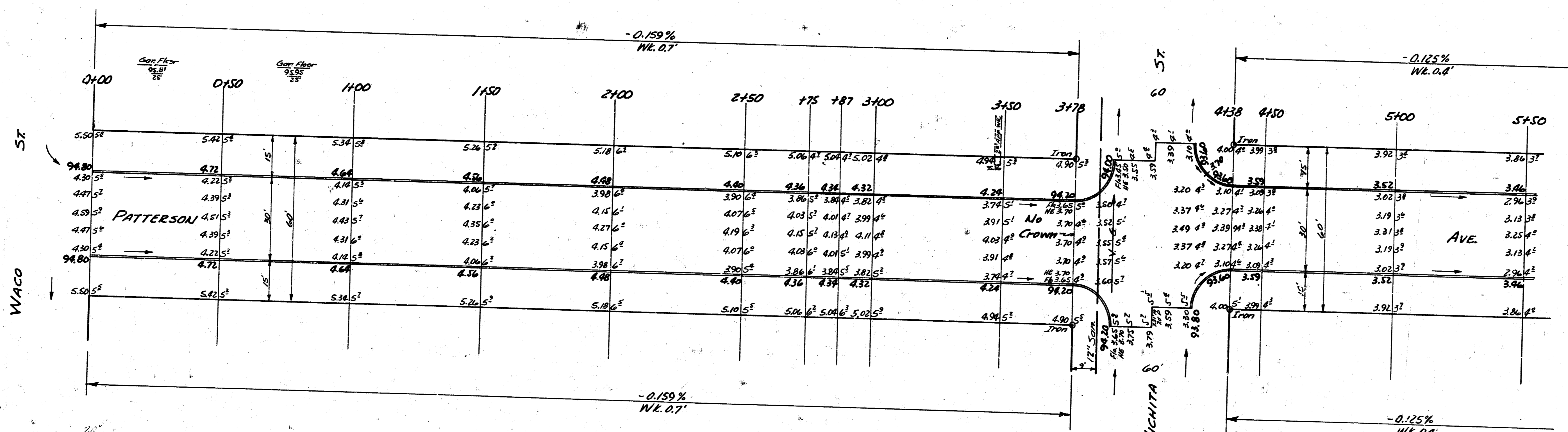

**PATTERSON AVE.**  
 EL. WACO TO EL. HENRY JONES ADD.  
 30' CONC. C.B.  
 CITY OF WICHITA, KANSAS  
 B.E. SMITH CITY ENGINEER  
 JULY, 1956 Proj. No. C15-25



Surveyed by  
 Checked by  
 Date

Prop  
 STA 1 2 3 4  
 City  
 0

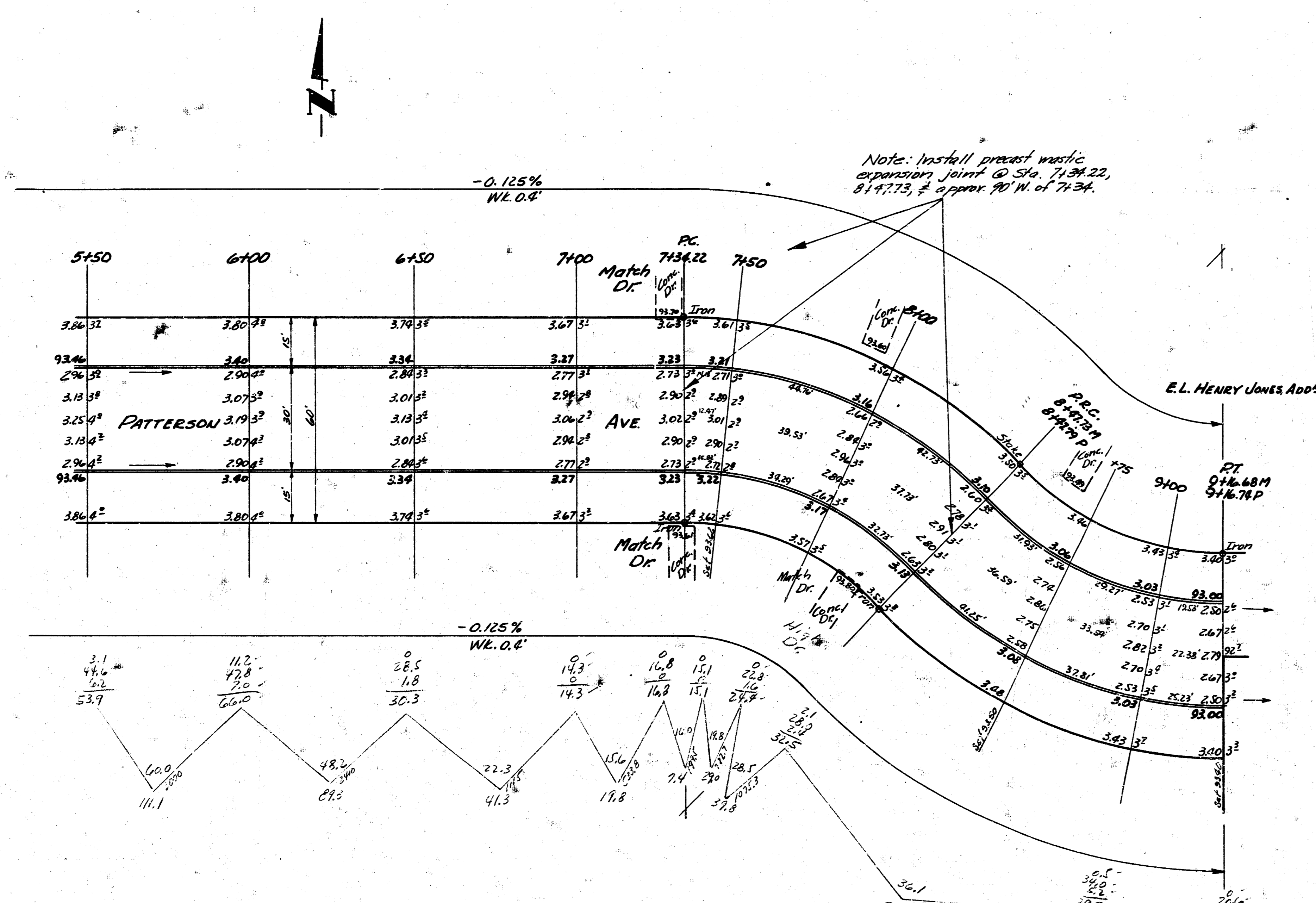

CURVE DATA - STA 7+34.22 TO STA 8+47.73  
 6' OFFSET FROM SO. CB - STA ON N. R.  
 Δ = 45° 25' L = 73.08' C = 71.15'

STA	CHORD OFFSET	CHORD OFFSET	DEFLECT ANGLE	TOTAL DEFLECT
7+34.22 PC				
7+50	10.6'	10.78'	3° 09' 25"	3° 09' 25"
8+100	32.03'	46.62'	10° 00' 40"	13° 19' 35"
8+47.73 RC	30.59'	44.52'	9° 32' 55"	22° 42' 30"

CURVE DATA - STA 8+47.73 TO STA 9+16.68  
 6' OFFSET FROM SO. CB - STA ON N. R.  
 Δ = 45° L = 109.01' C = 106.25'

STA	CHORD OFFSET	CHORD OFFSET	DEFLECT ANGLE	TOTAL DEFLECT
8+47.73 RC				
8+75	42.94'	29.95'	8° 53' 56"	8° 53' 56"
9+100	59.39'	27.47'	8° 09' 29"	17° 03' 25"
9+16.68 RT	26.33'	18.36'	5° 26' 35"	22° 30' 00"