

B.M. 121.40 "X" Bk. MK East, S.E. Cor. 18th & Salina  
 B.M. 122.42 "E" in Ritchie top Cb. S. end Rad. S.E. Cor. 18th & Payne  
 B.M. 121.52 "R" in Ritchie top Cb. W.S. Payne - S.L. 17th St.

NOTE: Remove & replace all exist. wk. on E. Side & W. Side Payne, except wk. across alley, which is to be removed only. New wk. grades on plan.

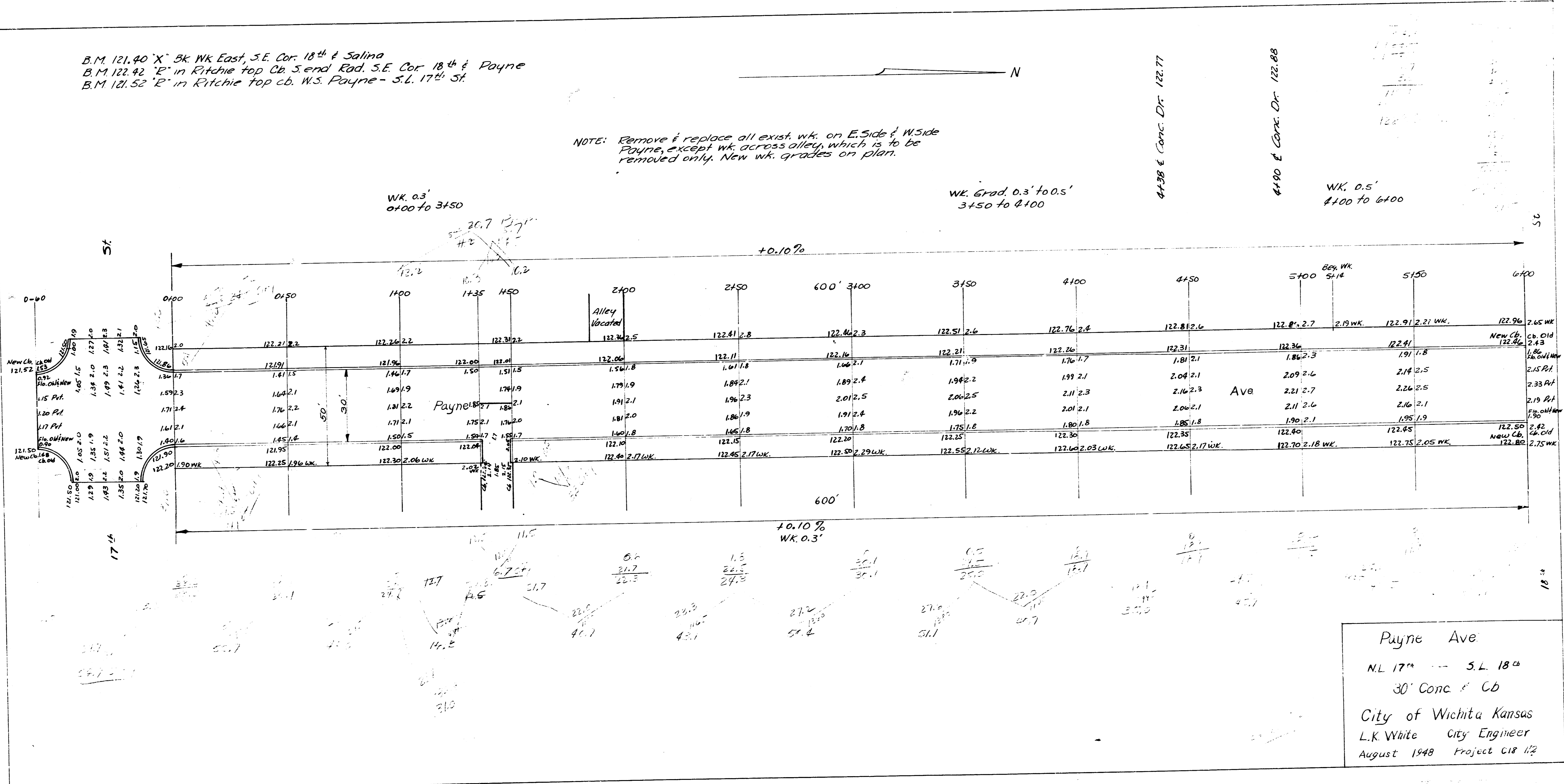

Payne Ave  
 N.L. 17th - S.L. 18th  
 30' Conc. & Cb  
 City of Wichita Kansas  
 L.K. White City Engineer  
 August 1948 Project C18 112