

1941
 E.S. PERRY AVE - NL 14TH TO SL 16TH
 CB + GTR ONLY

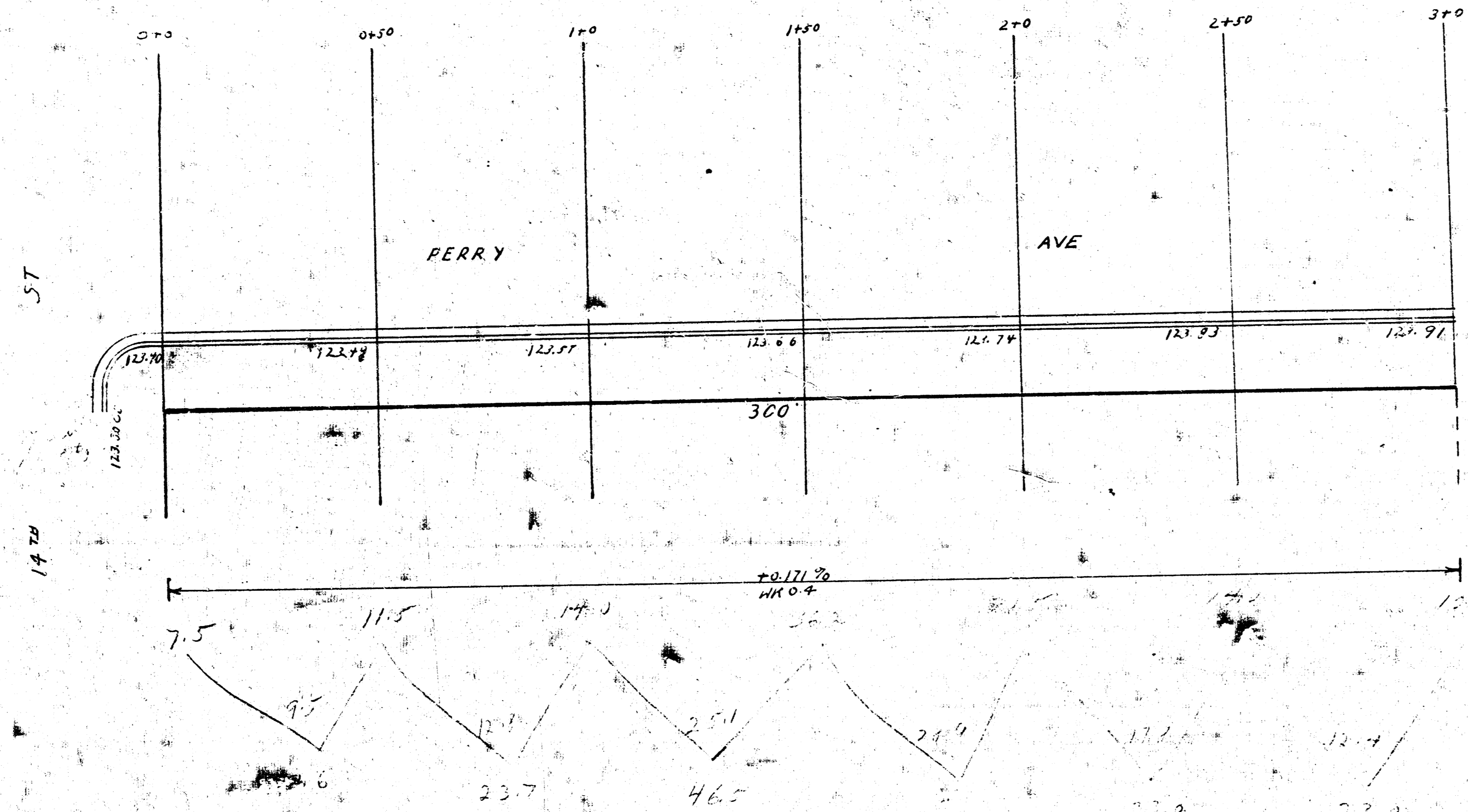

BM 122.42 IRON IN THIR C. OF 14TH + COOLIDGE
 BM 123.90 "X" S. CO. 14TH E.L. PERRY

11.5	17.0
1.7	46.5
	23.0
	21.0
	117.5
	11.7
	217.0

B.M. 122.43 iron in thumb & Coolidge of 14th

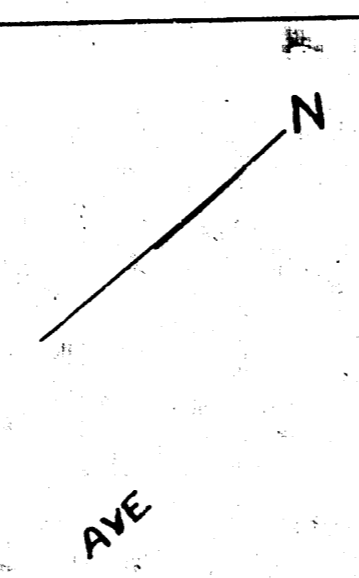

All Sta. are on existing South curb line on Perry

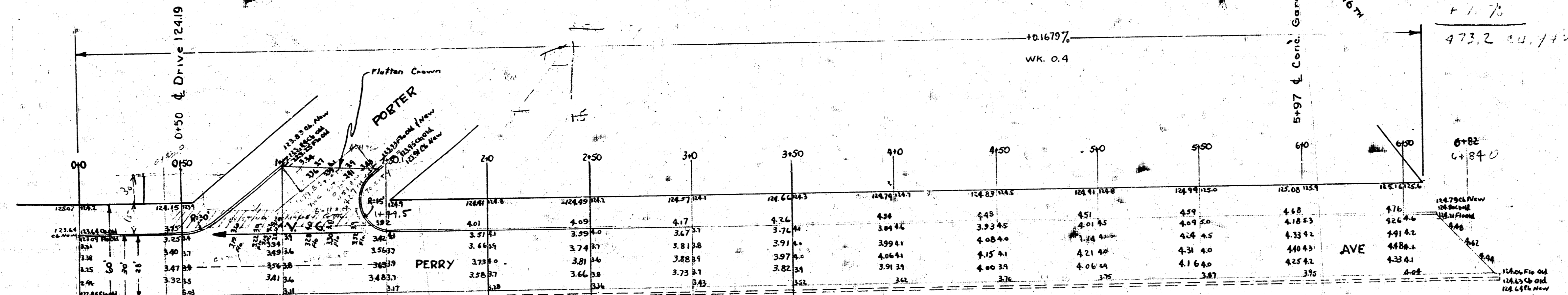

Note: Remove & replace sufficient int curb at S.E. radius of 14th St to allow flg. to South.

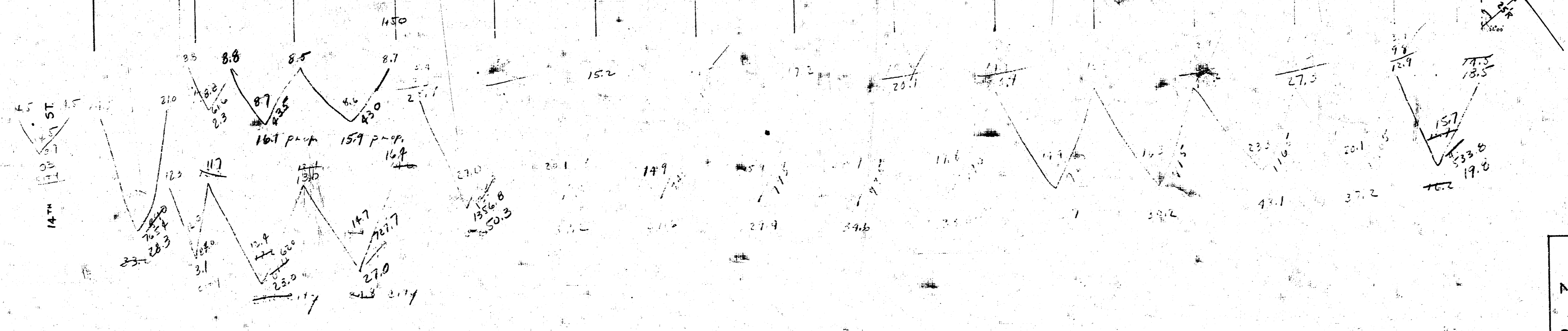

122.43
122.45
122.47
122.49
122.51
122.53
122.55
122.57
122.59
122.61
122.63
122.65
122.67

93.0
+ 7.75
97.2

PERRY AVE
 N.L. 14th S.L. 16th
 28' CONC & INT. CB.
 CITY OF WICHITA, KANS.
 L.K. WHITE CITY ENGINEER
 MAR. 1948 PROJ. NO. C-18-128

B.M. 122.43 Iron Intimble & Coolidge of 14th



All Sta. are on existing South curbline on Perry

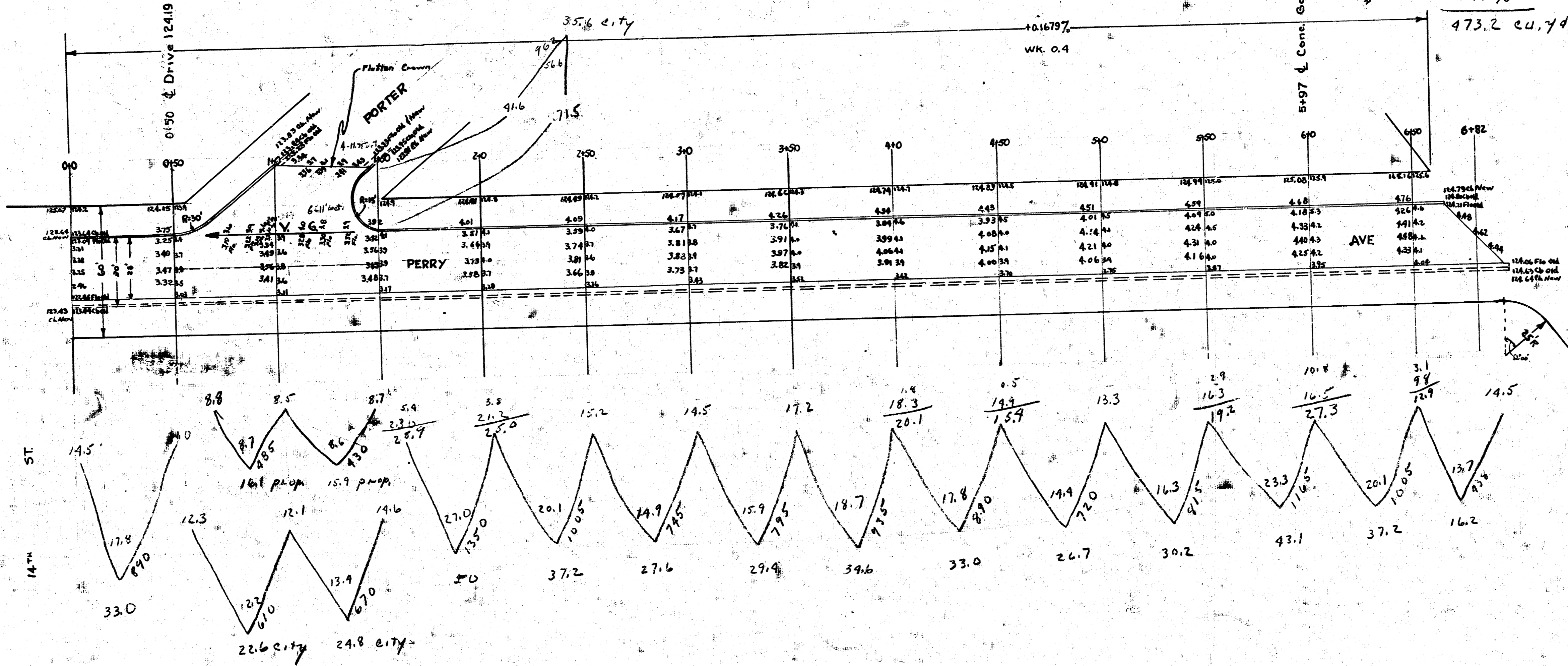

Prop.	21.7
33.0	22.6
14.1	29.8
15.9	35.6
50.0	83.0
27.2	
27.6	
29.8	
34.6	
33.0	
26.7	
30.2	
43.1	
37.2	
14.2	
<hr/>	
430.2	
+ 10%	
473.2 cu. yds.	

PERRY AVE
 N. L. 14th S. L. 16th
 28' CONC. & INT. CB.
 CITY OF WICHITA, KANS.
 L.K. WHITE CITY ENGINEER
 MAR. 1948 PROJ. NO. C-18-128

4 12 5