

B.M. 175.13 Extreme SW cor. Stone Slab on Woodlawn Village Monument on NW cor. Central & Tallyrand.

CURVE DATA  
Sta. 14+30.0 TO Sta. 17+06.05  
Stationing on North Property line  
Min. Per. Lin. Ft. = 5.05546

| STATIONS | Exc. length North # | Chord length<br>of face of No. cb | Chord length<br>of face of So. cb | DEFLECTION | TOTAL<br>DEFLECTION |
|----------|---------------------|-----------------------------------|-----------------------------------|------------|---------------------|
| 14+30.00 |                     |                                   |                                   |            |                     |
| +50      | 20.00'              | 18.29'                            | 16.88'                            | 4° 41' 27" | 13° 41' 07"         |
| +50      | 50.00'              | 44.92'                            | 38.17'                            | 4° 12' 46" | 5° 53' 53"          |
| +50      | 50.00'              | 44.92'                            | 38.17'                            | 4° 12' 46" | 10° 06' 39"         |
| +50      | 50.00'              | 44.92'                            | 38.17'                            | 4° 12' 47" | 14° 19' 26"         |
| +50      | 50.00'              | 44.92'                            | 38.17'                            | 4° 12' 46" | 18° 32' 12"         |
| +50      | 50.00'              | 44.92'                            | 38.17'                            | 4° 12' 46" | 22° 44' 58"         |
| +50      | 50.00'              | 44.92'                            | 38.17'                            | 4° 12' 47" | 26° 57' 45"         |
| 17+06.05 | 36.05'              | 33.29'                            | 30.42'                            | 3° 32' 15" | 30° 00' 00"         |

EARTHWORK

| EXCAVATION     |                | COMPACTED FILL |                  |
|----------------|----------------|----------------|------------------|
| CITY           | PROP.          | CITY           | PROP.            |
| 115.4          | 474.9          | 0              | 919.6            |
| 11.5           | 47.3           | 0              | 92.0             |
| 126.9 Cu. yds. | 522.4 Cu. yds. | 0              | 1,011.6 Cu. yds. |

**PLAZA LANE**  
EL TALLYRAND RD. TO SL TANGLEWOOD LN.  
26' - 2' - 30" A. C.  
CITY OF WICHITA, KANSAS  
B. E. SMITH CITY ENGINEER  
OCT. 1962 PROJ. NO. C12-33

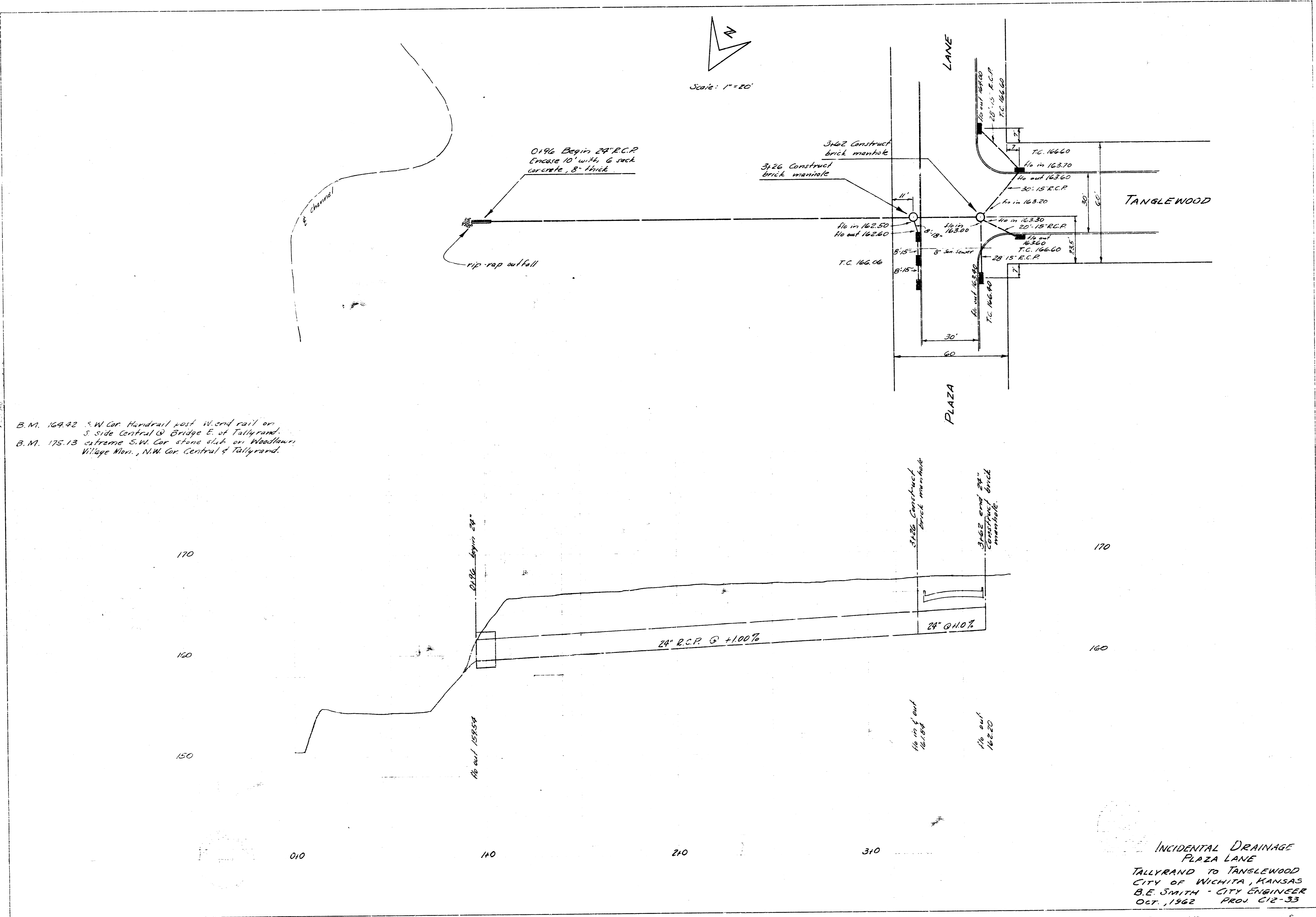

Scale: 1"=20'

B.M. 169.92 S.W. Cor. Handrail post W. end rail on S. Side Central @ Bridge E. of Tallyrand.  
 B.M. 175.13 extreme S.W. Cor. stone slab on Woodlawn Village Mon., N.W. Cor. Central @ Tallyrand.

INCIDENTAL DRAINAGE  
 PLAZA LANE  
 TALLYRAND TO TANGLEWOOD  
 CITY OF WICHITA, KANSAS  
 B.E. SMITH - CITY ENGINEER  
 OCT. 1962 PROJ. C12-33

10 15 9 3