

B.M. 17144 6" IN GLOBE H. CB. PINECREST S.L. CENTRAL.
 B.M. 18312 6" IN GLOBE N. CB. PLAZA LANE EL. PINECREST

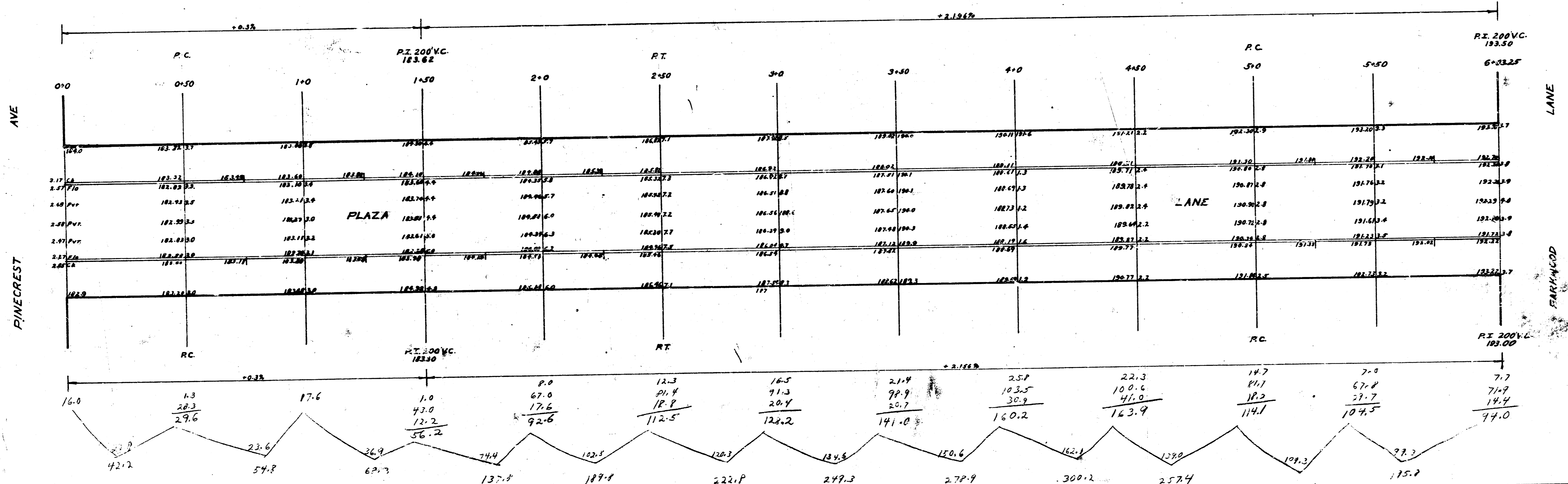

1149.0
 2199.7
 220.0
 2419.7

PLAZA LANE
 EL. PINECREST TO W.L. PARKWOOD LANE
 30" CONCRETE + INT. CURB
 L.K. WHITE, CITY ENGINEER
 APRIL 1946

455 15