

B.M. 20135 12" in BITCHIE 100 curb MS Parkwood, N.W. Pk
 B.M. 20136 12" in BITCHIE 100 curb MS Parkwood, N.W. Pk
 B.M. 20138 12" in BITCHIE, Near Return, N.W. Cor. Eggenwood Pk
 Stationing on N.E.

NOTE:
 From N.W. Cor. Parkwood & Eggenwood was marked
 South approximately 0.21 miles preliminary was
 taken. New location should check Curve Data on
 Proposed Plan (C-2-55). Field Engineer is to check.

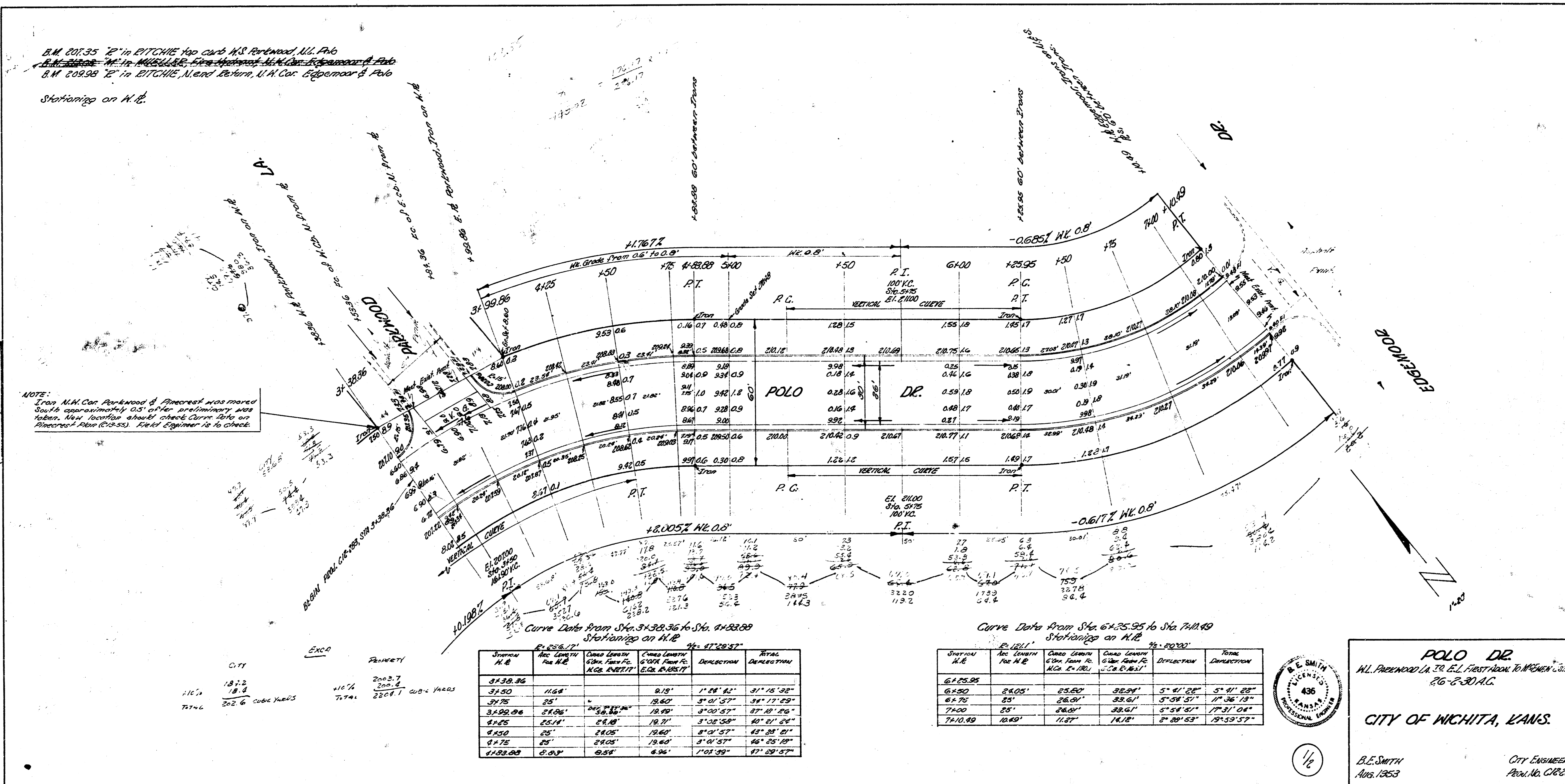

Curve Data from Sta. 3130.36 to Sta. 3183.00
 Stationing on N.E.

Station N.E.	Curve Length Sta. from P.C. N.C. 2-1957	Curve Length Sta. from P.T. N.C. 2-1957	Direction	Angle
3130.36	116.8'	9.18'	1° 08' 12"	31° 15' 28"
3130	25'	18.60'	3° 01' 37"	34° 17' 28"
3130.36	240.8'	19.40'	3° 00' 57"	37° 12' 26"
3135	25.18'	19.71'	3° 32' 58"	40° 21' 26"
3150	25'	19.60'	3° 01' 37"	43° 25' 21"
3175	25'	19.60'	3° 01' 37"	46° 25' 19"
3183.00	25'	19.60'	3° 01' 37"	49° 25' 17"

Curve Data from Sta. 6125.95 to Sta. 7110.00
 Stationing on N.E.

Station N.E.	Curve Length Sta. from P.C. N.C. 2-1957	Curve Length Sta. from P.T. N.C. 2-1957	Direction	Angle
6125.95	240.8'	25.60'	32.91'	5° 41' 28"
6170	25'	26.01'	33.61'	5° 58' 57"
7100	25'	26.01'	33.61'	5° 58' 57"
7110.00	24.60'	11.87'	14.12'	8° 20' 53"

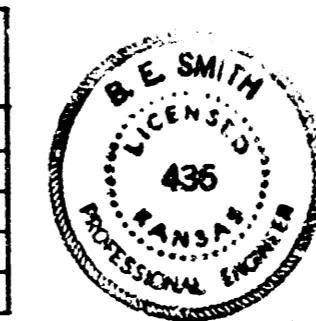

POLO DR
 N.W. PARKWOOD LA. 100 E.L. FIRST AVE. 10. N.W. COR. EGGENWOOD
 100-5-30.H.C.
CITY OF WICHITA, KANSAS.
 B.E. SMITH
 Aug. 1953
 CITY ENGINEER
 Prof. No. C-2-283

